

NOTE: THE CONSTRUCTION OF A DROP INLET W/GRATE 45'± LEFT OF STA 55+03± AND THE GRADE OF THE NEW 18" PIPE SHALL BE ADJUSTED AS DIRECTED BY THE ENGINEER TO FIT THE FIELD CONDITIONS.

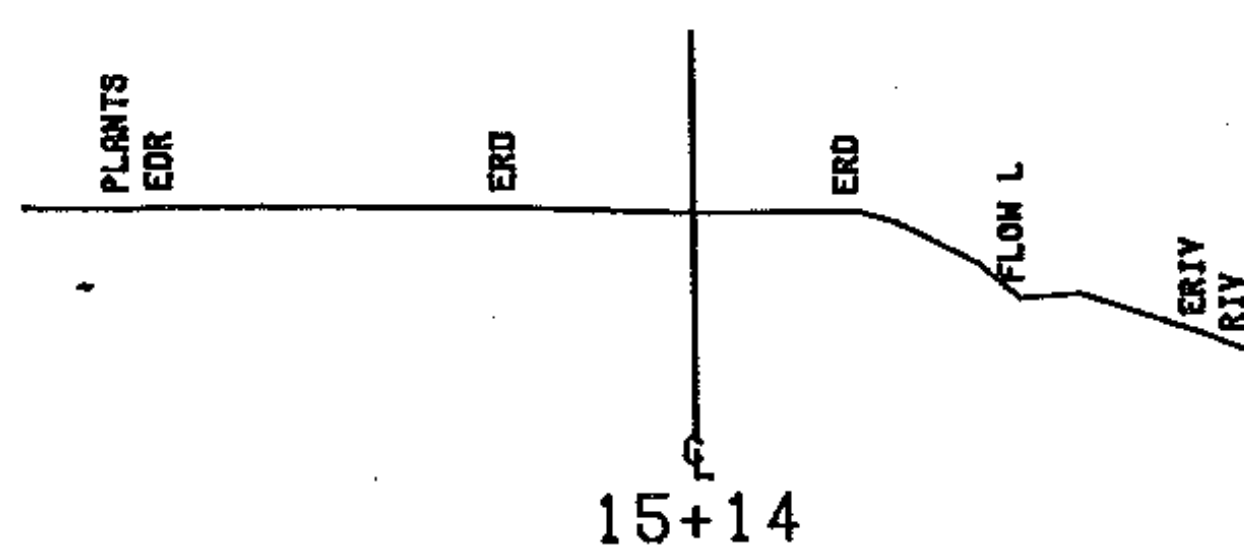

500

STA. 55+03 CONSTRUCT NEW 18" CONC. PIPE, 0.004" THICKNESS, ASKEW 90° RT. NOTE: REMOVE EXISTING 15" CONC.

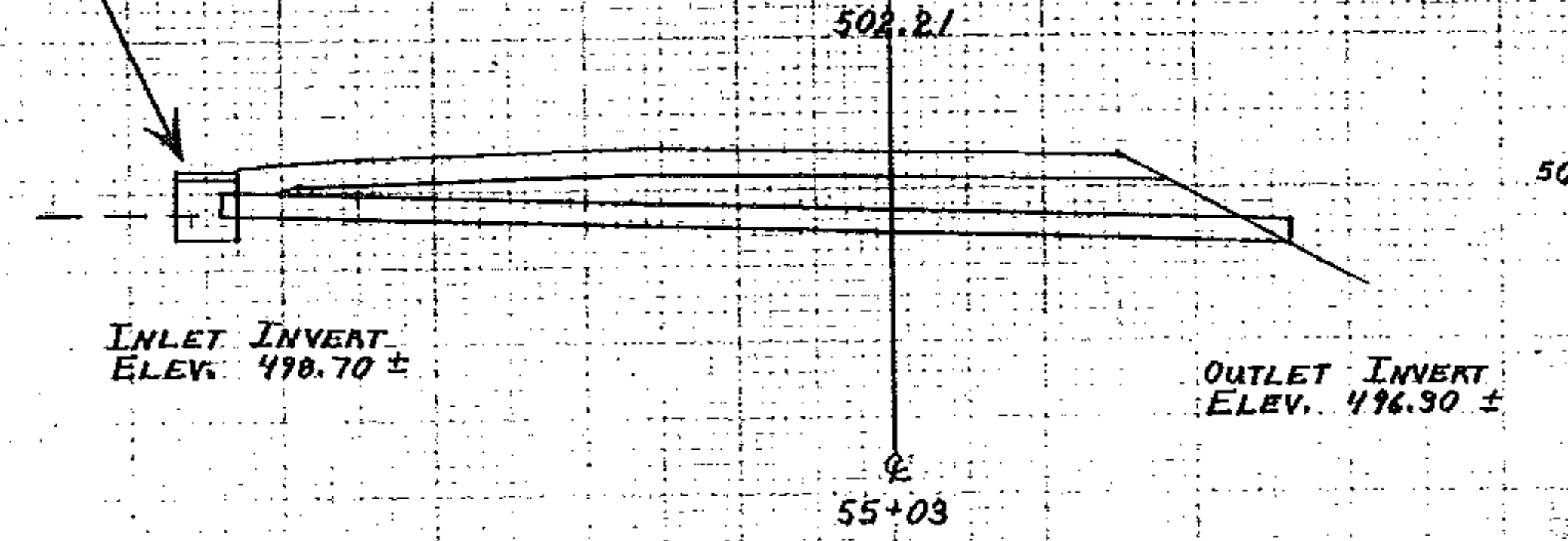
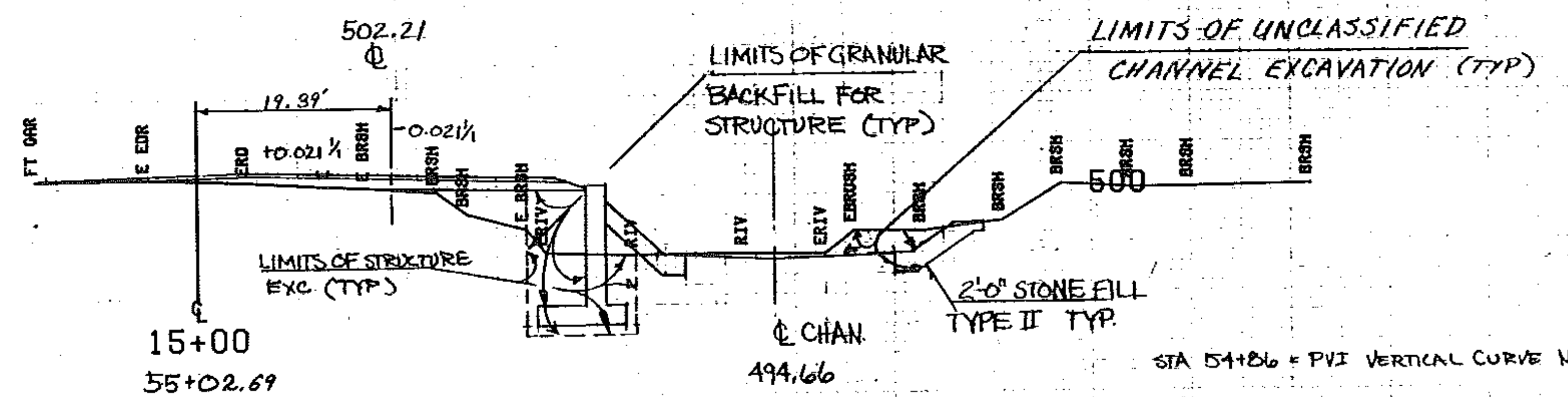

STA 55+00 LT. CONSTRUCT DRIVE, GRADE TO EXISTING CONDITIONS IN FRONT OF GARAGE, IN FRONT OF GARAGE, GRADE TO DRAIN TO CULVERT. SEE SHEET 3

STA. 54+86 = PVI VERTICAL CURVE No 1  
STA. 54+78 RT. BEGIN HEAVY DUTY GUARD RAIL W/WOOD POSTS, TYPE II.

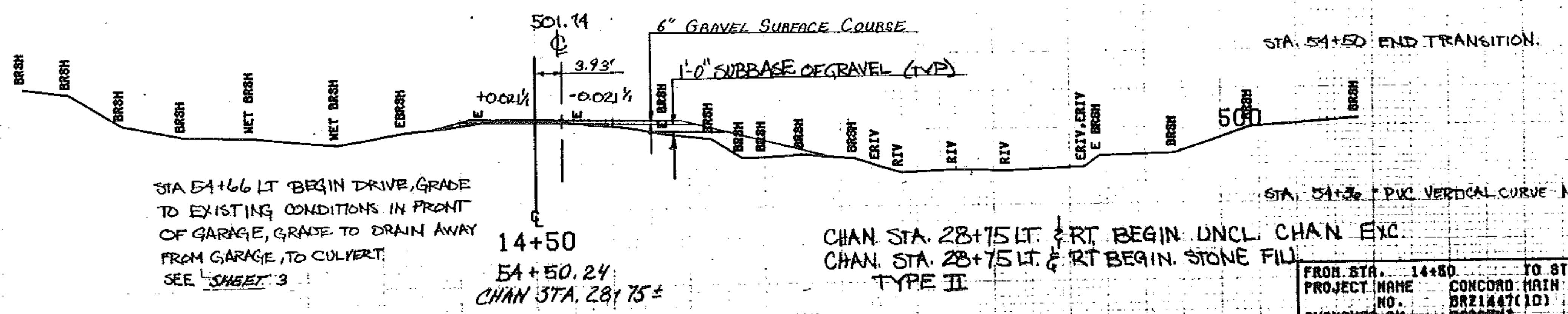

STA 54+66 LT. BEGIN DRIVE, GRADE TO EXISTING CONDITIONS IN FRONT OF GARAGE, GRADE TO DRAIN AWAY FROM GARAGE, TO CULVERT. SEE SHEET 3

CHAN STA. 28+75 LT. & RT. BEGIN UNCL. CHAN EXC.  
CHAN STA. 28+75 LT. & RT. BEGIN. STONE FILL TYPE II

STA. 54+50 END TRANSITION.

STA. 54+36 = PVI VERTICAL CURVE No 1

FROM STA.	14+50	TO STA.	15+14
PROJECT NAME	CONCORD MAIN		
NO.	BR21447(10)		
SURVEYED BY	BARGENT		
SHEET NO.	23	SHEET	23
PLOTTED 11/16/80			
JANUARY 1982			

SCALE: 1" = 40'