

- INDEX OF SHEETS**
1. TITLE SHEET
 2. QUANTITY SHEET
 3. PLAN AND PROFILE
 4. TEMPORARY DETOUR DETAILS
 5. R.O.W. DETAIL SHEET
 6. R.O.W. PLAN AND PROFILE
 7. BORING LOGS
 8. PRELIMINARY INFORMATION
 9. SLAB DETAILS
 10. ABUTMENT No. 1 DETAILS
 11. WINGWALL No. 1 & No. 2 DETAILS
 12. ABUTMENT No. 2 DETAILS
 13. REINFORCING STEEL SCHEDULE
 - 14-20. MAINLINE CROSS SECTIONS
 - 21-29. CHANNEL CROSS SECTIONS

LIST OF STANDARDS

A-21	6-17-82
E-3	12-15-78R
E-6	4-1-80R
E-7	2-1-83R
E-7A	1-3-85R
G-11	12-21-84R
SB-R6-82	12-13-84R
SCB-DI-75	7-17-81R
D-6	7-4-73R
D-11	8-24-81R

GENERAL NOTES

1. PAYMENT FOR SEEDING, MULCHING AND FERTILIZING SHALL BE SUBSIDIARY TO ALL OTHER ITEMS. SEE SHEET 4 FOR SEEDING MIX AND APPLICATION RATES.
2. CONSTRUCTION IN THE STREAM IS LIMITED TO JUNE 1ST TO OCTOBER 1ST.
3. GENERAL NOTES 4, 6, 7, 13, 14, 15 AND 16 FROM STANDARD SCB-DI-76 APPLY TO THIS PROJECT.
4. ALL EXPOSED CONCRETE SURFACES, EXCEPT THE UNDER SIDE OF SLAB BETWEEN DRIP BEADS, SHALL HAVE WATER REPELLENT APPLIED TO THEM.
5. A FINISHING MACHINE, IN ACCORDANCE WITH STANDARD SPECIFICATION SECTION 501.14 (b) SHALL BE USED TO PLACE THIS CONCRETE SLAB.

**STATE OF VERMONT
AGENCY OF TRANSPORTATION**

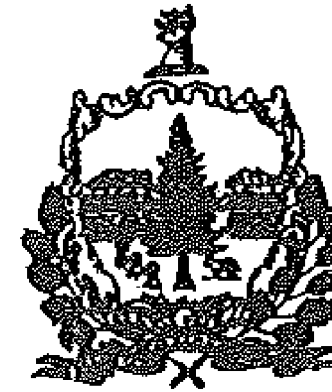

Date AUG 1 1985

Winterest Inc
Contractor

Gerald Bailey
Signature

president
Title

Jana C. Camp
Transportation Secretary's Signature

**PROPOSED IMPROVEMENT
BRIDGE PROJECT**

TOWN OF CONCORD
COUNTY OF ESSEX

ROUTE NO: TH.11 CL3 BRIDGE NO: 20

PROJECT LOCATION: BEGINNING AT A POINT APPROXIMATELY 0.20 MILES SOUTH OF THE INTERSECTION OF TOWN HIGHWAYS 4 AND 11, AND CONTINUING APPROXIMATELY 300 FT. SOUTHERLY ON TH. 11

PROJECT DESCRIPTION: THE PROJECT SHALL CONSIST OF REMOVAL OF THE EXISTING STRUCTURE, CONSTRUCTION OF A NEW CONCRETE SLAB BRIDGE, AND ALL NECESSARY ROAD AND CHANNEL WORK.

CONTRACT PLANS
THESE PLANS DO NOT REFLECT
CHANGES MADE ON THE PROJECT.

LENGTH OF STRUCTURE: 45.16 FEET
LENGTH OF PARTICIPATION ROADWAY: 254.84 FEET
LENGTH OF NON-PARTICIPATION ROADWAY: FEET
LENGTH OF PROJECT: 300.00 FEET

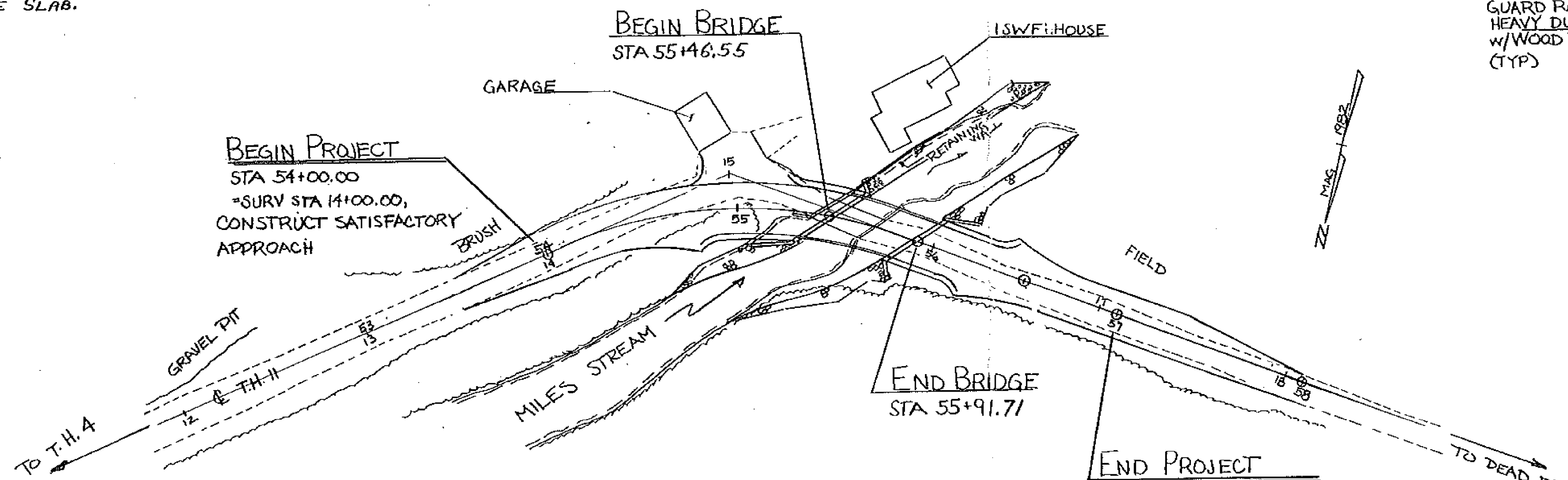
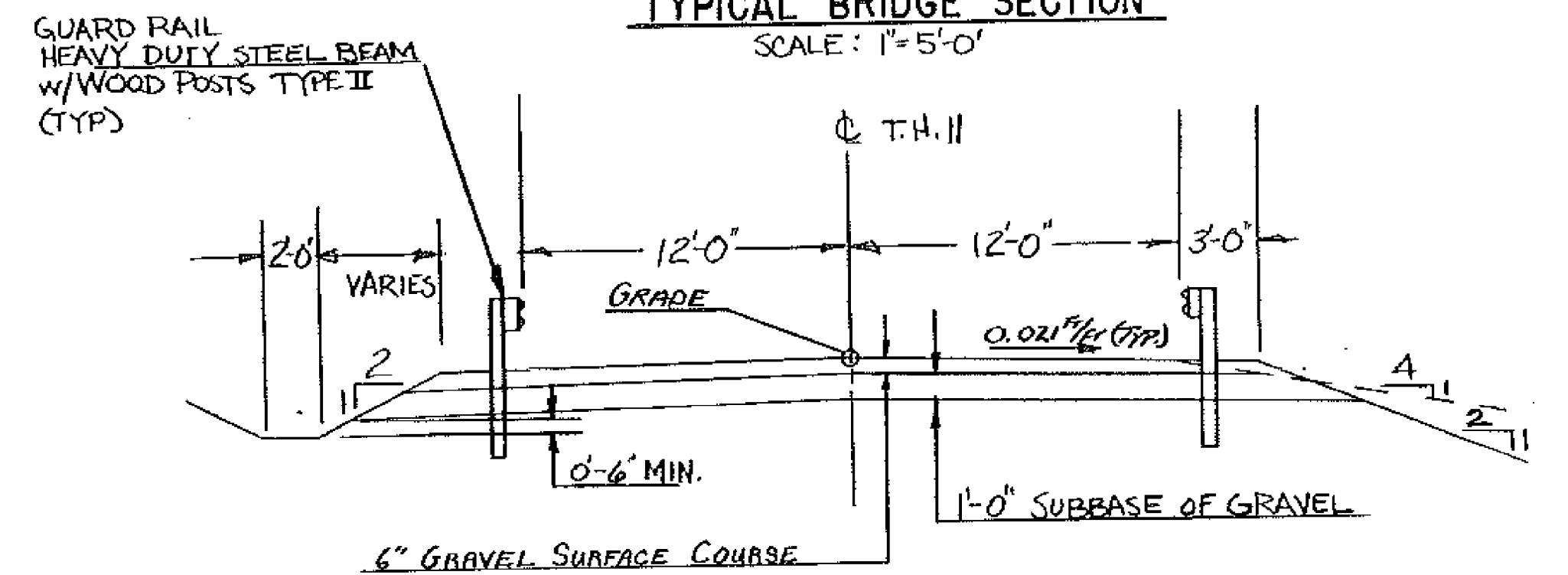
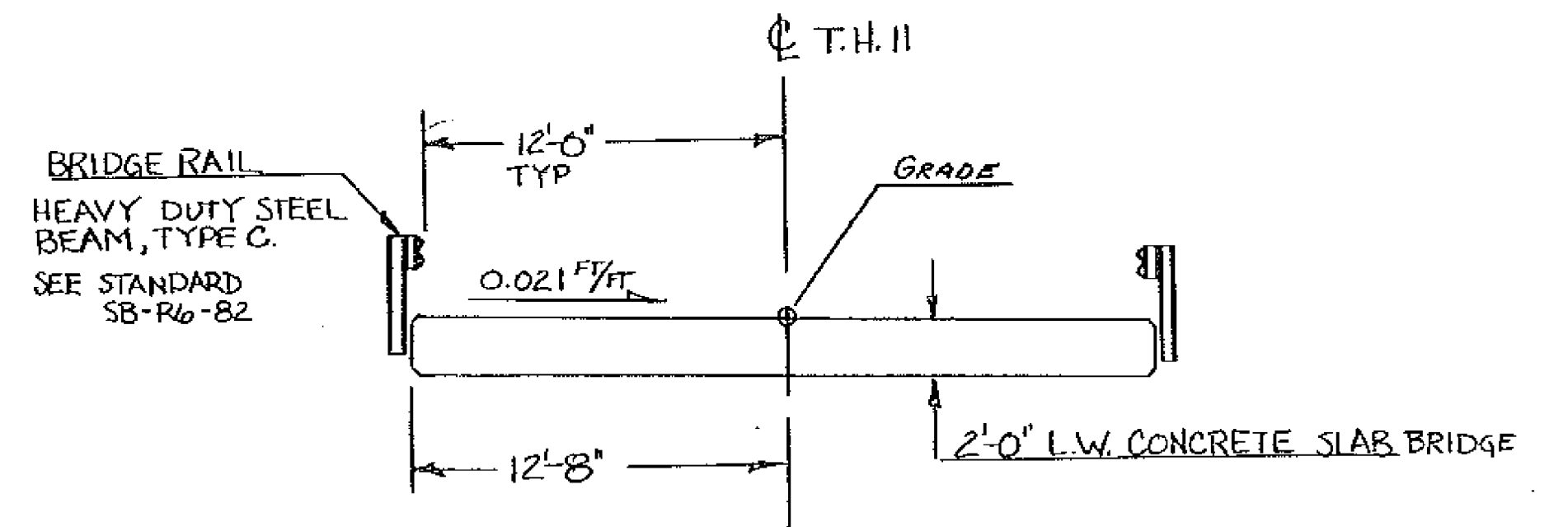
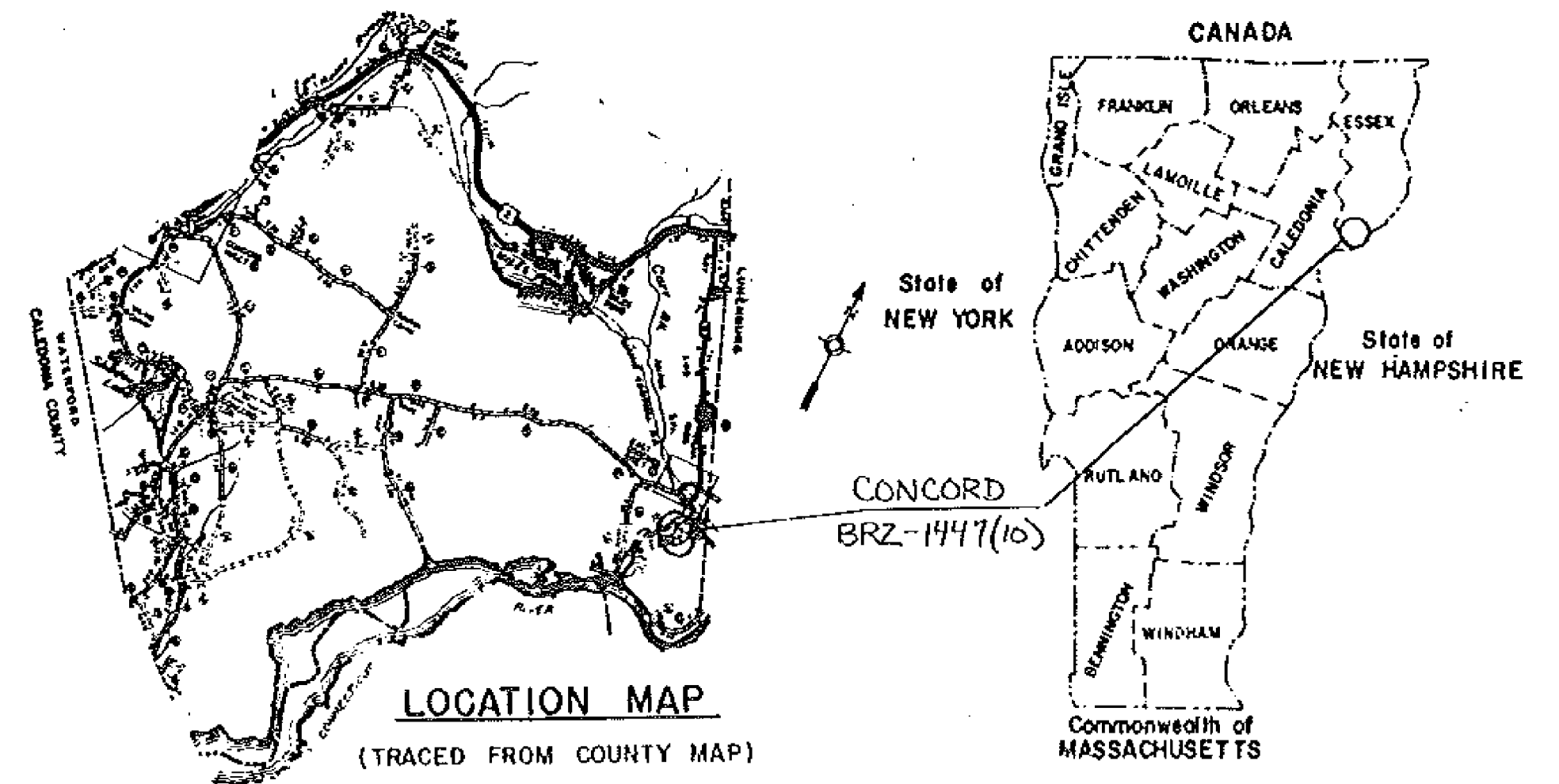

CONVENTIONAL SIGNS

- COUNTY LINE
- TOWN LINE
- LIMITS OF ACCESS
- POINT OF ACCESS
- FENCE LINE
- STONE WALL
- TRAVELED WAY
- GUARD RAIL
- RAILROAD
- SURVEY LINE
- CULVERT
- POWER POLE
- TELEPHONE POLE
- TREES
- CONTROL OF ACCESS
- PROPERTY LINE
- R.O.W TAKING LINE
- SLOPE RIGHTS
- TOP OF CUT
- TOE OF SLOPE

DATUM

VERTICAL	LOCAL
HORIZONTAL	LOCAL

These plans are subject to such engineering changes as may be required by the Federal Highway Administration or the Chief Engineer.

Construction is to be carried on in accordance with these plans and the Standard Specifications for Highway and Bridge Construction dated March, 1976, as approved by the Federal Highway Administration on October 27, 1976 for use on this project, including all subsequent revisions and such revised specifications and special provisions as are incorporated in these plans.

SUBMITTED BY ORDER OF THE STATE TRANSPORTATION BOARD
APPROVED Franklin D. Wood DATE 5-22-85
Chief Engineer

PROJECT CONCORD PROJECT NO. BRZ-1447(10)
SHEET 1 OF 29 SHEETS
SJB 7/21/81