

BRIDGE RAILING, HEAVY DUTY
STEEL BEAM TYPE C
12+03 RT. TO 12+28 RT.
12+08 LT. TO 12+33 LT.

Construct Drive
Sta. 11+45 R+

M.L. POC 12+00.0 =
CHAN. POT 5+00.0
 $\Delta 84^{\circ}43'30''$ LT OF
TANG. TO CURVE AT
12+00.0

EXISTING BRIDGE INFORMATION
ABUTMENTS—LAID UP STONE—2'5" THICK
5-12"X6" I BEAMS, POOR CONDITION

GUARD RAIL, HEAVY DUTY STEEL
BEAM WITH WOOD POSTS, TYPE II
11+66 RT. TO 12+03 RT.
12+28 RT. TO 12+65 RT.
11+83 LT. TO 12+08 LT.
12+33 LT. TO 12+70 LT.

DATE
BY
CHECKED
DATE
BY
CHECKED
PLAN
SCALE
NOTE BOOK
NO.

DATE
BY
CHECKED
DATE
BY
CHECKED
PROFILE
SCALE
NOTE BOOK
NO.

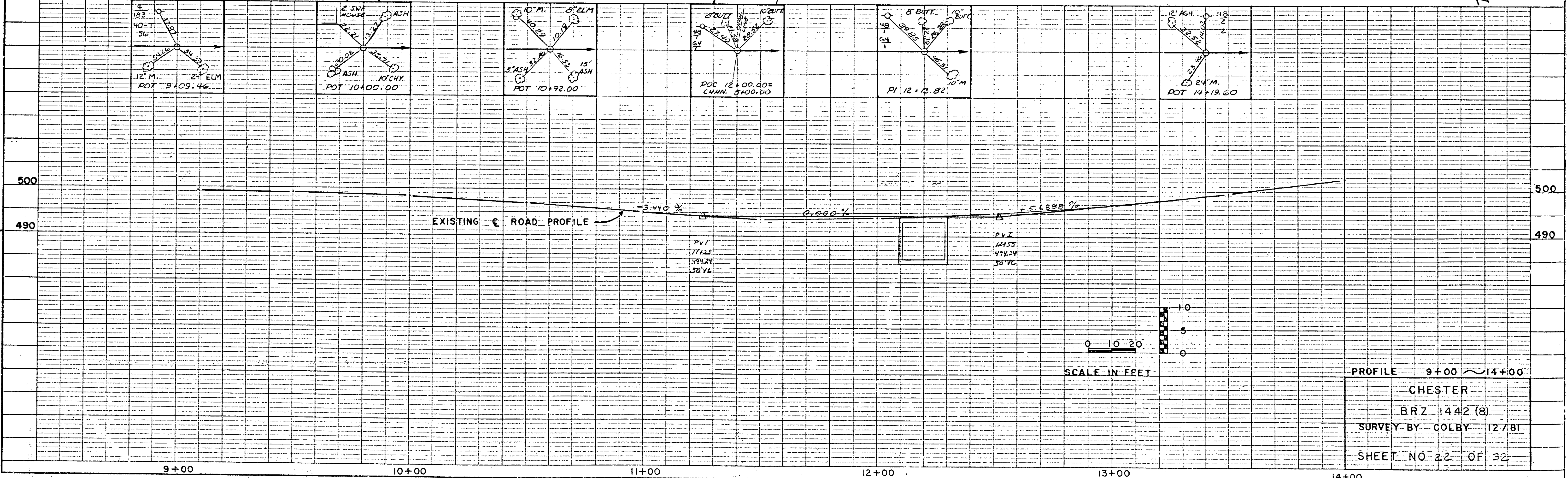
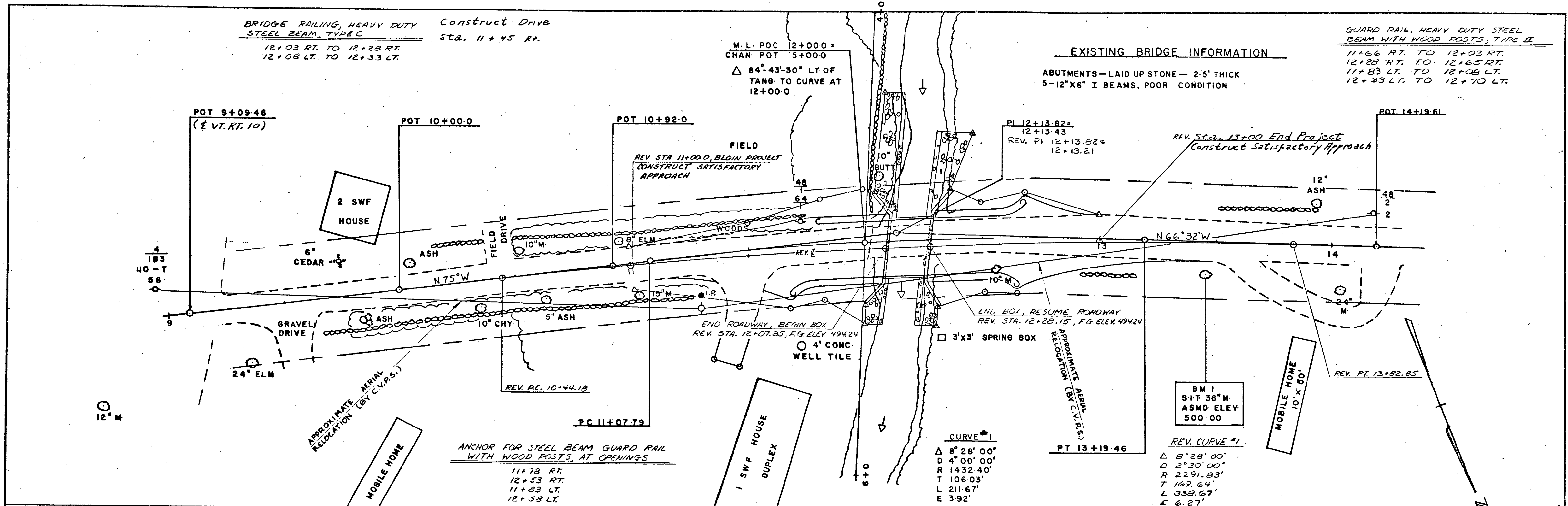

PROFILE 9+00 ~ 14+00
CHESTER
BRZ 1442 (8)
SURVEY BY COLBY 12/81
SHEET NO 22 OF 32