

INDEX OF SHEETS

STATE OF VERMONT AGENCY OF TRANSPORTATION



PROPOSED IMPROVEMENT BRIDGE PROJECT

TOWN OF CHESTER
COUNTY OF WINDSOR

ROUTE NO: T.H. 57, CLASS 3 BRIDGE NO: 69

PROJECT LOCATION: BEGINNING AT THE INTERSECTION OF VT. RTE. 11 AND T.H. 57, APPROXIMATELY 2.5 MILES FROM THE CHESTER-ANDOVER TOWN LINE, & EXTENDING 0.038 MILES ON T.H. 57.

PROJECT DESCRIPTION: REMOVAL OF EXISTING STRUCTURE, CONSTRUCTION OF A NEW PRESTRESSED VOIDED SLAB BRIDGE AND RELATED ROADWAY AND CHANNEL WORK.

LENGTH OF STRUCTURE: 46.00 FEET
LENGTH OF PARTICIPATION ROADWAY: 154.00 FEET
LENGTH OF NON-PARTICIPATION ROADWAY: N.A. FEET
LENGTH OF PROJECT: 200.00 FEET

TRAFFIC DATA

1982	ADT
1992	20
1992	25
DESIGN SPEED = 20 MPH	

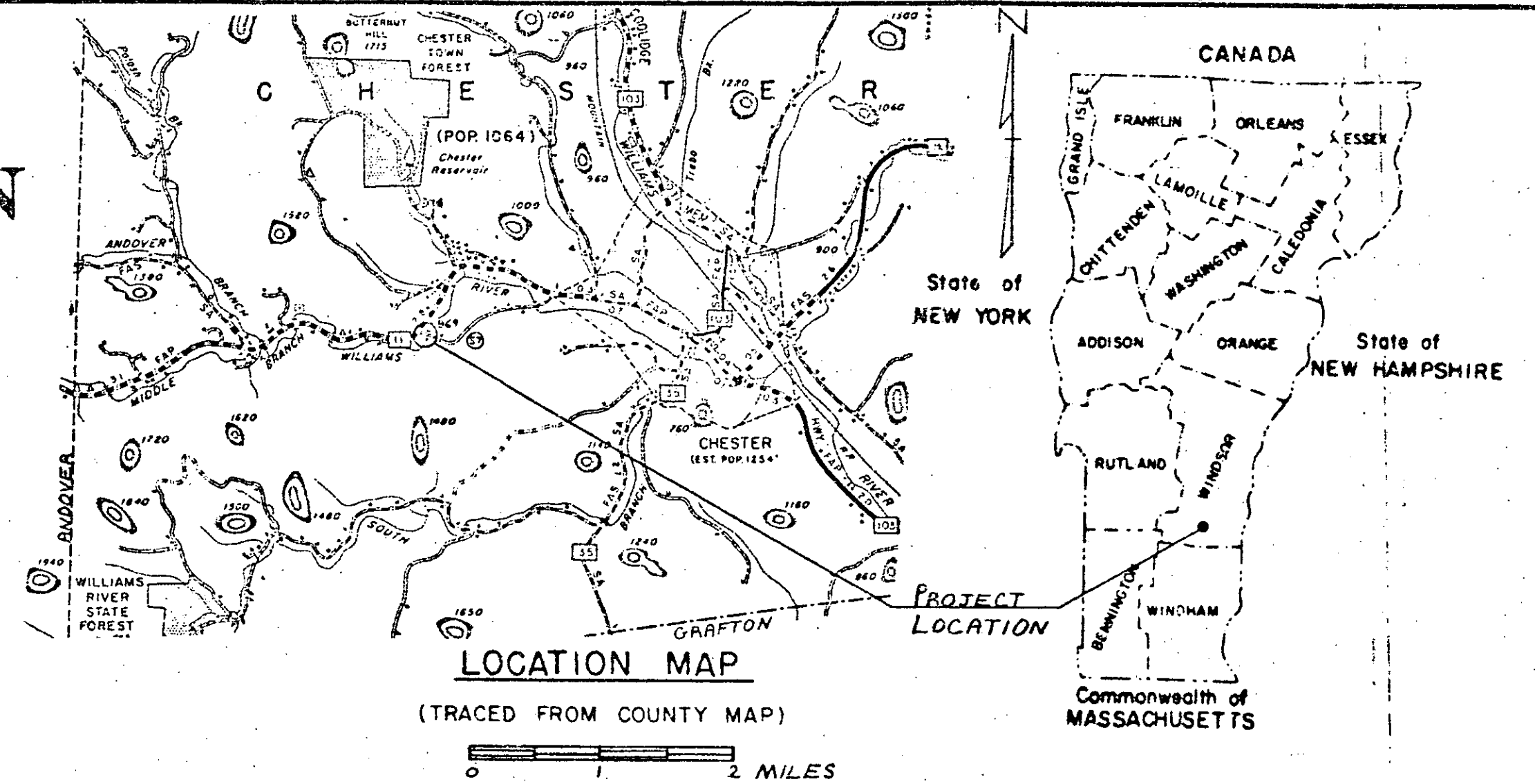

GENERAL NOTES

- SEE STD. ECB-DI-75 FOR ADDITIONAL GENERAL NOTES.
- DESIGN LOADING IS HS-20.
- THE ONE-WAY TEMPORARY BRIDGE SHALL MEET THE REQUIREMENTS OF SECTION G33, AND THOSE LISTED BELOW. (SEE SHT 5 FOR LOCATION)
- SEEDING, MULCHING, AND OTHER EROSION CONTROL ITEMS SHALL BE SUBSIDIARY TO ALL OTHER CONTRACT ITEMS.
- THE EXISTING STEEL BEAMS SHALL BE STOCKPILED ON THE PROJECT SITE AND REMAIN THE PROPERTY OF THE AGENCY OF TRANSPORTATION, DISTRICT 2.
- WATER REPELLENT SHALL BE APPLIED TO ALL EXPOSED CONCRETE SURFACES EXCEPT BENEATH THE DECK BETWEEN THE DRIP NOTCHES.
- THE EXISTING SUPERSTRUCTURE SHALL BE REMOVED UNDER THE ITEM 'REMOVAL OF EXISTING SUPERSTRUCTURE'.

TEMPORARY BRIDGE REQUIREMENTS

- 20' x 7' BRIDGE, HWBQZB3-67
- THE TEMPORARY BRIDGE SHALL HAVE A CLEAR SPAN OF 20' AT STREAM BED.
- ALL FILL USED FOR CONSTRUCTION OF THE TEMPORARY BRIDGE SHALL BE COARSE GRANULAR MATERIAL, WITH SLOPES PROTECTED WITH STONE FILL. ALL TEMPORARY BRIDGE FILL SHALL BE REMOVED BY THE COMPLETION OF THE PROJECT.

CONVENTIONAL SIGNS

- COUNTY LINE
- TOWN LINE
- LIMITS OF ACCESS
- POINT OF ACCESS
- FENCE LINE
- STONE WALL
- TRAVELED WAY
- GUARD RAIL
- RAILROAD
- SURVEY LINE
- CULVERT
- POWER POLE
- TELEPHONE POLE
- TREES
- CONTROL OF ACCESS
- PROPERTY LINE
- ROW TAKING LINE
- SLOPE RIGHTS
- TOP OF CUT
- TOE OF SLOPE

DATUM

VERTICAL	ASSUMED
HORIZONTAL	N.A.

END SIDELINE STA 6+00
CONSTRUCT SATISFACTORY APPROACH

HYDRAULIC DATA

DRAINAGE AREA = 28.1 SQ. MI.

Q10 = 2700 cfs	HW ELEV. = 497.1
Q25 = 3775 cfs	HW ELEV. = 499.3
Q50 = 4800 cfs	HW ELEV. = 500.9
Q100 = 5775 cfs	HW ELEV. = 501.6

OVERFLOW OCCURS AT Q20 ±
TAILWATER AT Q25 = 7.4'
VELOCITY AT Q25 = 11.5 fps

BEGIN PROJECT M/L 10+00 = CHAN 5+00
Δ = 90° 19' 13" LT.

BEGIN SIDELINE STA 4+00
CONSTRUCT SATISFACTORY APPROACH

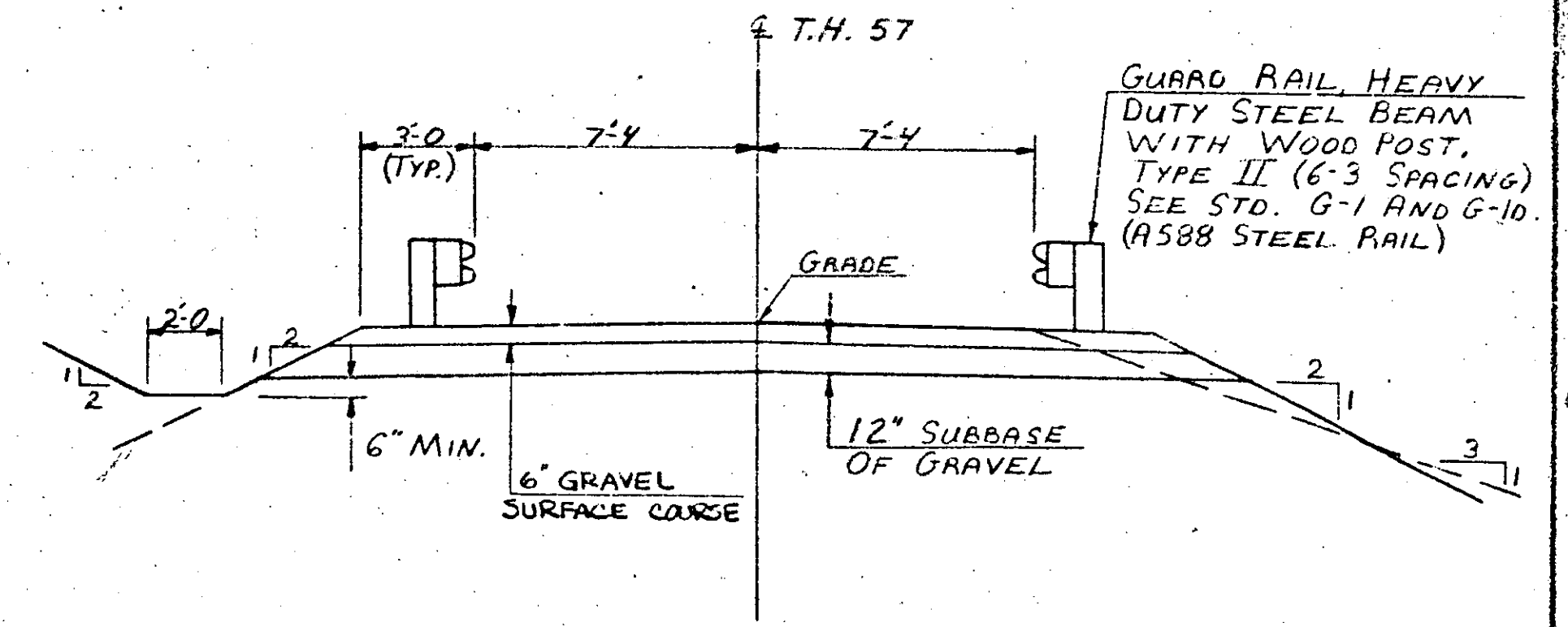
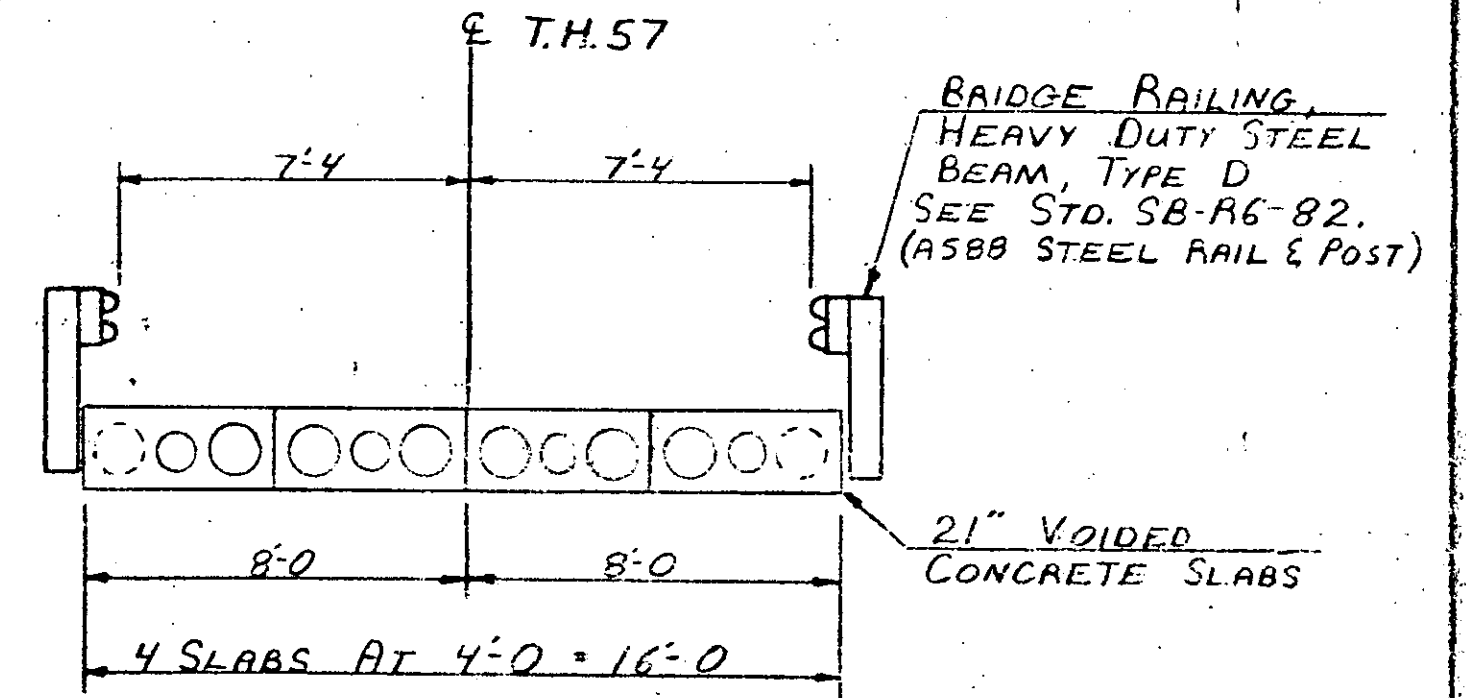
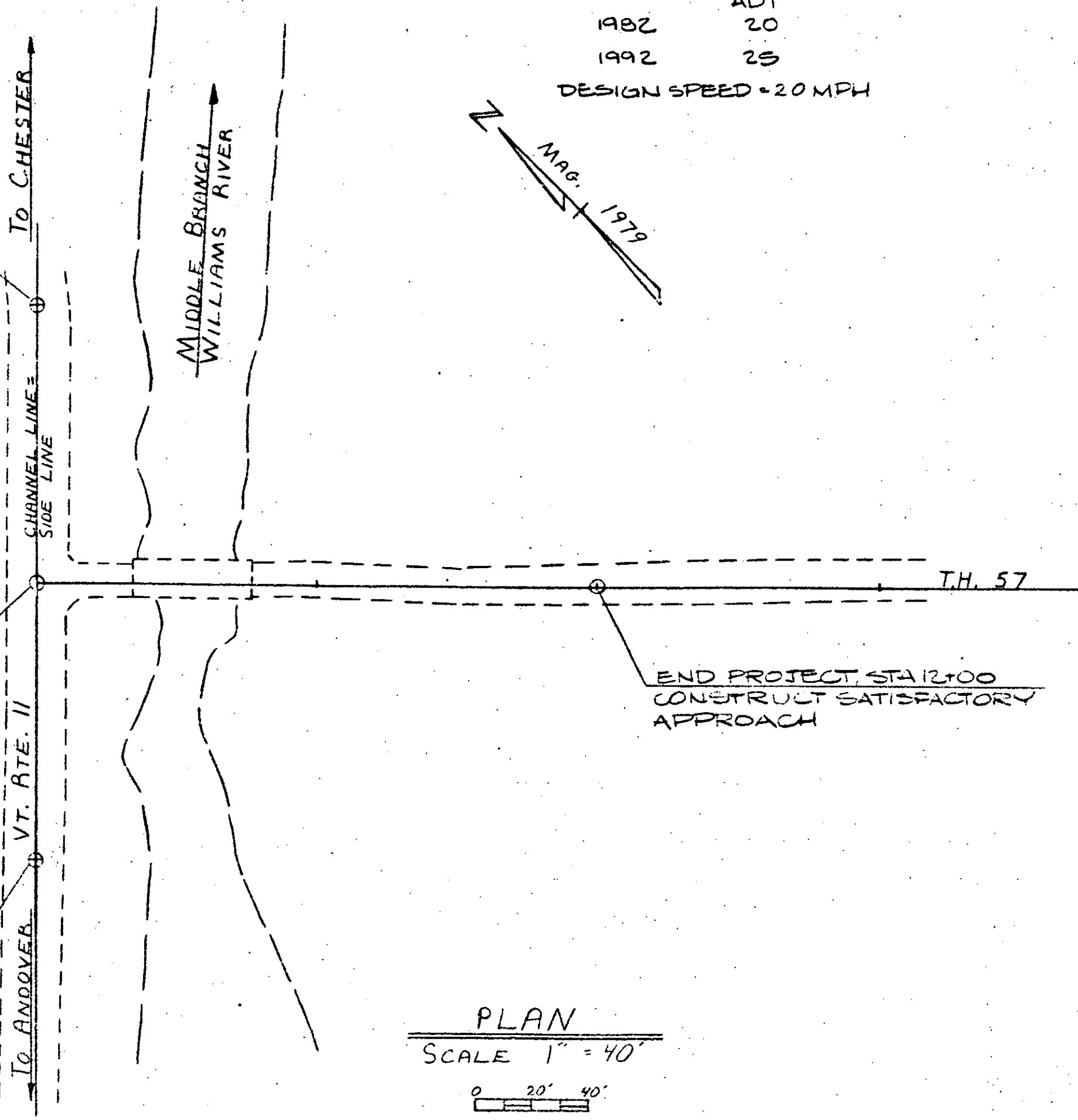

These plans are subject to such engineering changes as may be required by the Federal Highway Administration or the Director of Engineering and Construction.

Construction is to be carried on in accordance with these plans and the Standard Specifications for Highway and Bridge Construction dated March, 1976, as approved by the Federal Highway Administration on October 27, 1976 for use on this project, including all subsequent revisions and such revised specifications and special provisions as are incorporated in these plans.

SUBMITTED BY ORDER OF THE STATE TRANSPORTATION BOARD	
APPROVED	DATE
DIRECTOR OF ENGINEERING AND CONSTRUCTION	
PROJECT	PROJECT NO.
CHESTER	BRZ 1442(2)
SHEET 3 OF 32 SHEETS	