

BORING NO. B-1

DEPTH	BLOWS ON CASING PENETRATION	SAMPLE NUMBER	MOISTURE	COLOR	LABORATORY CLASSIFICATION OF SOIL
0					No Sample
10	R	81		Gr	No Sample
		57		Wh	A-1-b Gravelly Sand
20	R			Gr	A-4 Sandy Silt
				Gr	A-4 Sandy Silt
				Gr	A-1-b Gravelly Sand
30					Hole stopped at 24.5' in H.P.

ELEV. 1006.7

BOTTOM OF FOOTING EL. 993.00

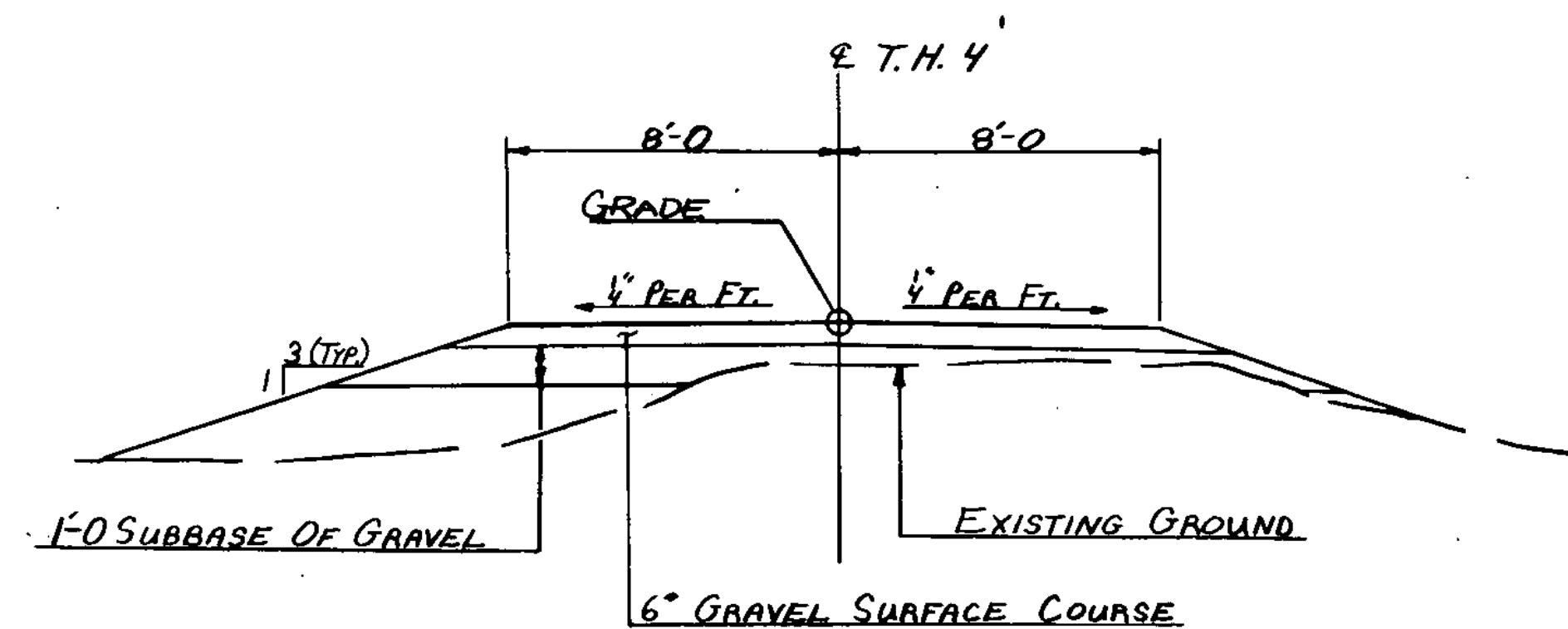
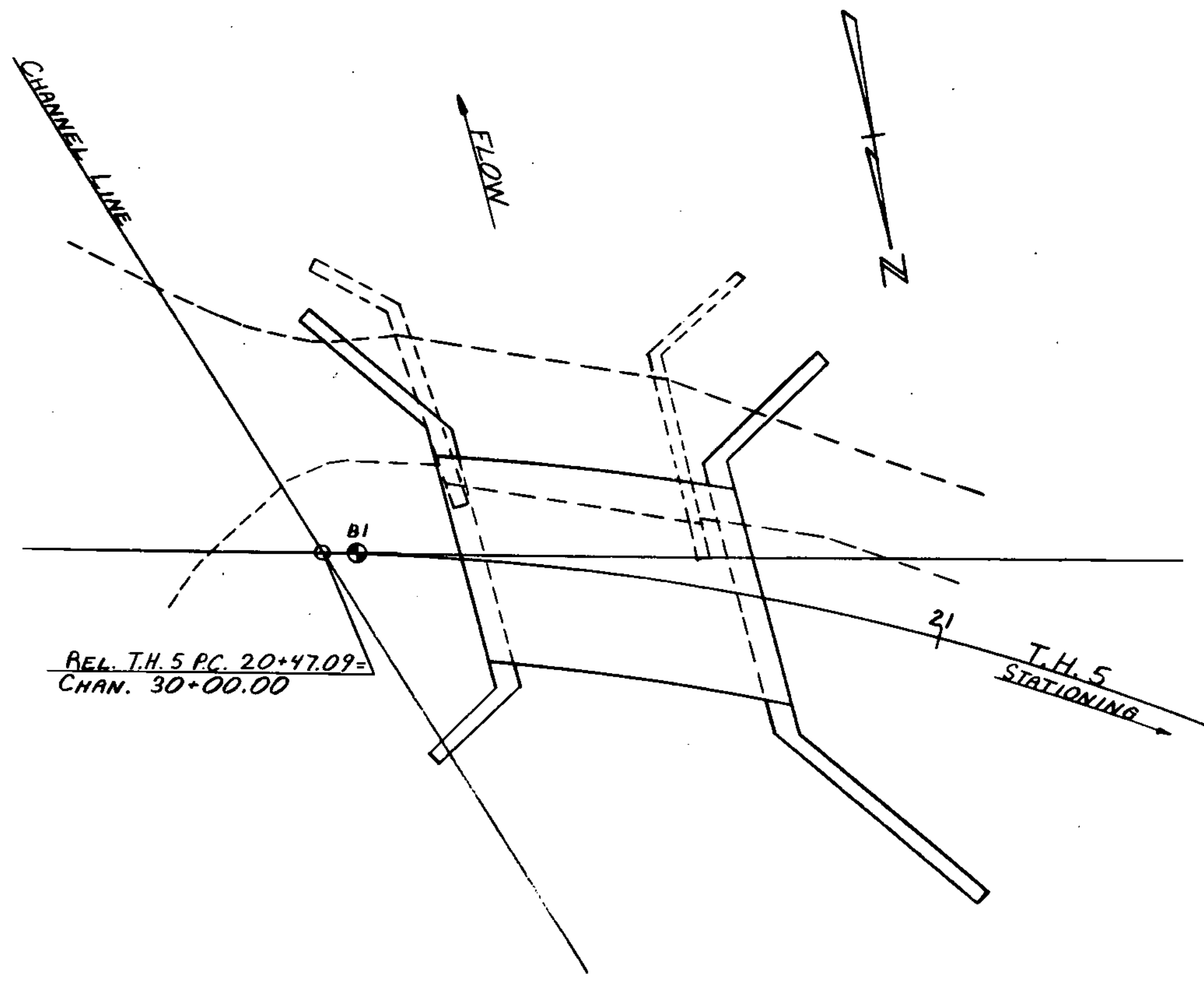

BORING	STATION	OFFSET
B1	20+50	E

BORING NOMENCLATURE

- STANDARD PENETRATION BORINGS
 SAMPLER OUTSIDE DIAMETER 2"
 SAMPLER INSIDE DIAMETER 1 3/8"
 WEIGHT OF HAMMER 140 LBS
 HAMMER FALL 30"
- ⊕ AUGER BORINGS
- ⊙ ROD SOUNDINGS
- UP UNDISTURBED PISTON SAMPLE
- VS FIELD VANE SHEAR SAMPLE

GENERAL NOTES

- THE SUBSURFACE EXPLORATIONS SHOWN HEREON WERE MADE BETWEEN 11-3-82 AND 11-3-82 BY THE VERMONT AGENCY OF TRANSPORTATION.
- SOIL AND ROCK (WHERE ENCOUNTERED) CLASSIFICATION, PROPERTIES AND DESCRIPTIONS ARE BASED ON ENGINEERING INTERPRETATION OF AVAILABLE SUBSURFACE INFORMATION BY THE VERMONT AGENCY OF TRANSPORTATION AND MAY NOT NECESSARILY REFLECT ACTUAL VARIATIONS IN SUBSURFACE CONDITIONS THAT MAY BE ENCOUNTERED BETWEEN INDIVIDUAL BORING OR SAMPLE LOCATIONS.
 - OBSERVED WATER LEVELS AND/OR WATER CONDITIONS INDICATED ARE AS RECORDED AT THE TIME OF EXPLORATION AND MAY VARY ACCORDING TO THE PREVAILING RAINFALL, METHODS OF EXPLORATION AND OTHER FACTORS.
 - SOUND ENGINEERING JUDGEMENT WAS EXERCISED IN PREPARING THE SUBSURFACE INFORMATION PRESENTED HEREON. ANALYSIS AND INTERPRETATION OF SUBSURFACE DATA WAS PERFORMED AND INTENDED FOR AGENCY DESIGN AND ESTIMATE PURPOSES ONLY. PRESENTATION OF THE INFORMATION ON THE PLANS OR ELSEWHERE IS FOR THE PURPOSE OF PROVIDING INTENDED USERS WITH ACCESS TO THE SAME DATA AVAILABLE TO THE AGENCY. THE SUBSURFACE INFORMATION IS PRESENTED IN GOOD FAITH AND IS NOT INTENDED AS A SUBSTITUTE FOR PERSONAL INVESTIGATION, INDEPENDENT INTERPRETATIONS, INDEPENDENT ANALYSIS OR JUDGEMENT OF THE CONTRACTOR.
 - PICTORIAL STRUCTURE DETAILS SHOWN HEREON ARE FOR ILLUSTRATIVE PURPOSES ONLY AND MAY NOT BE INDICATIVE OF THE FINAL DESIGN CONDITIONS SHOWN IN THE CONTRACT PLANS.

STATE OF VERMONT	
AGENCY OF TRANSPORTATION	
TOWN OF MAIDSTONE	Bridge No. 6
HIGHWAY NO. T.H. 5	Log Sta. Surv. Sta. 20+71
T.H. 5 OVER DUTTON BROOK BORING LOGS	
Designed by G. SPILAK	Drawn by D. WILLEY
Checked by A. ELWOOD date 12-84	Bridge Design Supervisor B.S. HAUPT date 11-83
PROJECT MAIDSTONE	PROJECT NO. BRZ 1447(4)
Bridge Sheet No.	Sheet 7 of 31