

GUARD RAIL, H.D. STEEL BEAM W/ WOOD POSTS, TYPE II
 M/L 12+61 Lt ~ M/L 12+87 Rt
 M/L 12+61 Rt ~ M/L 12+87 Lt
 M/L 13+49 Rt ~ TH 4 29+50 Rt
 M/L 13+49 Rt ~ TH 4 31+25 Rt

ANCHORS FOR ST.B.M. GUARD RAIL @ OPENINGS
 M/L 12+64 Lt
 M/L 12+64 Rt
 TH 4 29+53 Rt
 TH 4 31+22 Rt

BRIDGE RAILING, HEAVY DUTY STEEL BEAM
 M/L 12+87 Lt ~ M/L 13+49 Lt
 M/L 12+87 Rt ~ M/L 13+49 Rt

GUARD RAIL, PLANK W/ WOOD POSTS
 S/L 22+28 Lt - Rt
 S/L 23+06 Lt - Rt

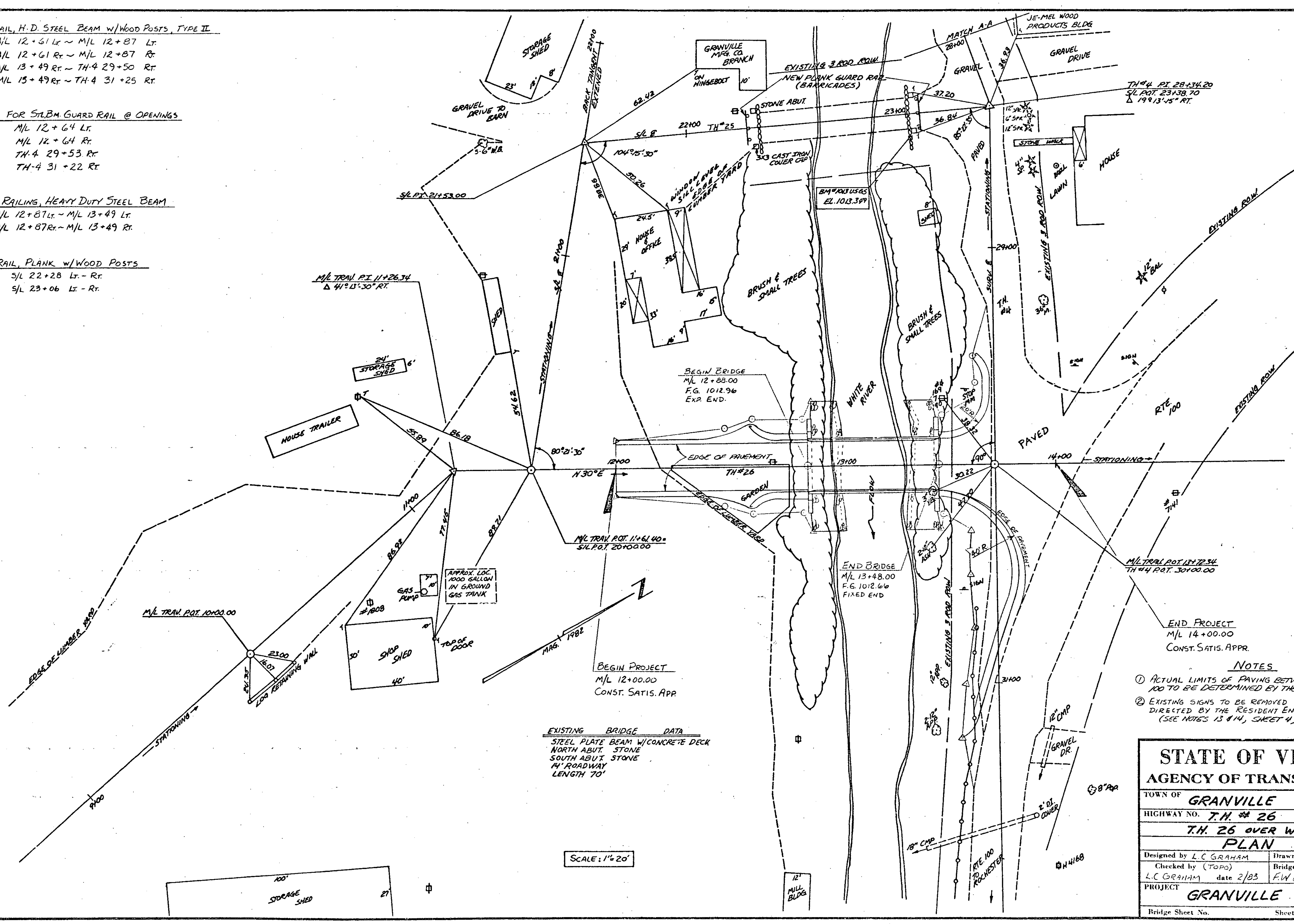

END PROJECT
 M/L 14+00.00
 CONST. SATIS. APPR.

NOTES
 ① ACTUAL LIMITS OF PAVING BETWEEN 13+48 → VT. RTE. 100 TO BE DETERMINED BY THE RESIDENT ENGINEER.
 ② EXISTING SIGNS TO BE REMOVED AND RESET AS DIRECTED BY THE RESIDENT ENGINEER. (SEE NOTES 13 & 14, SHEET 4)

EXISTING BRIDGE DATA
 STEEL PLATE BEAM W/ CONCRETE DECK
 NORTH ABUT. STONE
 SOUTH ABUT. STONE
 4' ROADWAY
 LENGTH 70'

SCALE: 1" = 20'

STATE OF VERMONT	
AGENCY OF TRANSPORTATION	
TOWN OF GRANVILLE	Bridge No. 23
HIGHWAY NO. T.H. # 26	Log Sta. _____
T.H. 26 OVER WHITE RIVER	
PLAN	
Designed by L.C. GRAHAM	Drawn by L.C. GATES
Checked by (TOPO)	Bridge Design Supervisor
L.C. GRAHAM date 2/83	F.W. BOLKUM date 2/83
PROJECT GRANVILLE	PROJECT NO. BR2-1444(9)
Bridge Sheet No. _____	Sheet 2 of 41