

PLATE NO. 1  
 PROJECT NO. 34-1948  
 SHEET NO. 6  
 DATE 12-1-48

PROFILE NO. 1  
 PROJECT NO. 34-1948  
 SHEET NO. 6  
 DATE 12-1-48

PASTURE  
 To Colchester  
 P.O.T. 1+24.5  
 1+33.4  
 1+42.7  
 1+51.6

P.L. = 4.100  
 $\Delta = 3' - 33'' \frac{1}{2}$

STA. 4+95 - 180"  $\phi$  CORE GALK  
 METAL PLATE PIPE ON 20" SKIRM  
 INVERT LENGTH 97' 6", TOP LENGTH 52' 6"  
 ENDS CUT TO FIT SLOPE AND SKIRM

BEGIN PROTECT STA. 1+50  
 CONSTRUCT SATISFACTORY APPROACH

HAVE DRAIN DITCH  
 TO BE PROTECTED  
 Stone Abut.  
 Stone Abut.  
 PROTECT OUTLINE OF ROAD FOR  
 BANK PROTECTION (HEAVY TYPE)  
 2'-0" THICK. 10' INTO STREAM BED AT  
 LEAST 3'-0". SIMILAR AT DOWN  
 STREAM END.

WALTER MUNSON

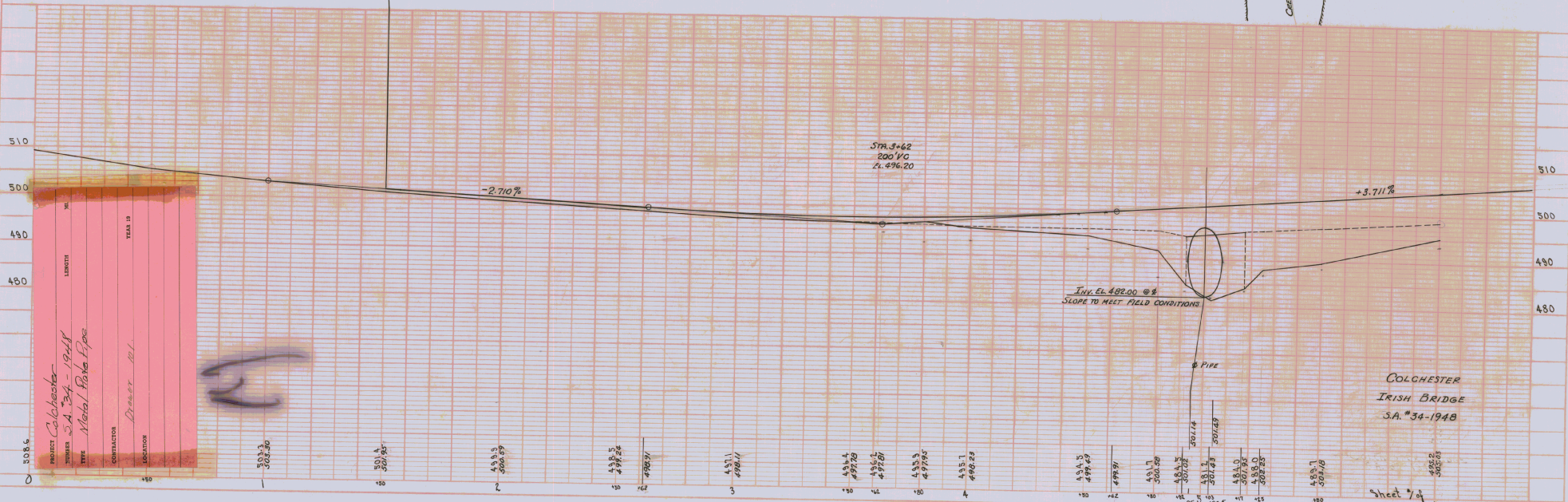

**PLAN**  
 DRAWN BY: W. J. KANE  
 CHECKED BY: W. J. KANE  
 DATE: NOV 1940  
 PROJECT: COLCHESTER IRISH BRIDGE  
 SHEET NO.: 24

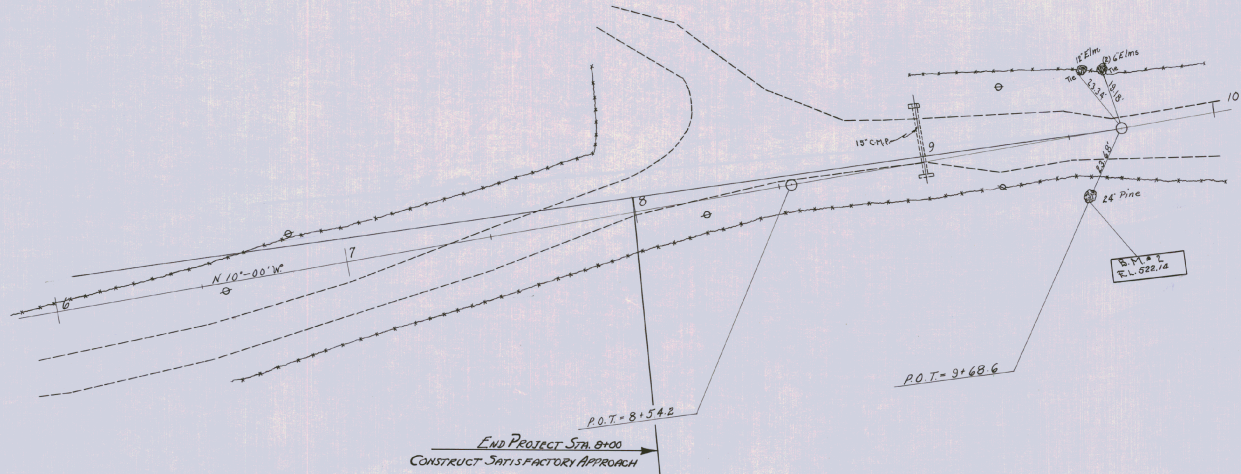

**PROFILE**  
 DRAWN BY: W. J. KANE  
 CHECKED BY: W. J. KANE  
 DATE: NOV 1940  
 PROJECT: COLCHESTER IRISH BRIDGE  
 SHEET NO.: 24

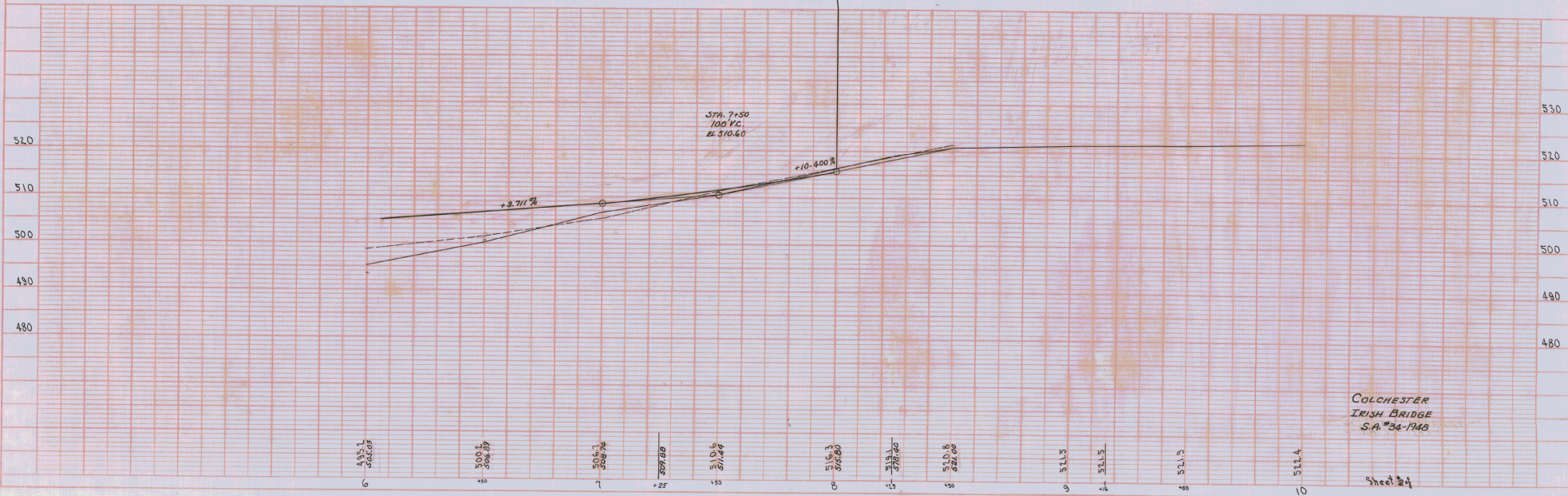

COLCHESTER  
 IRISH BRIDGE  
 S.A. #34-1940

Sheet 24

State of Vermont

COLCHESTER  
 Department of Highways  
 Plan P. No. 54-32-11A8  
 Nov. 19 68

FORM ENG. 1A EARTHWORK SHEET NO.

GRADES		VERTICAL CURVES		VALUES		REVISIONS		GRADES		VERTICAL CURVES		VALUES		REVISIONS	
Computed by	Checked by	Computed by	Checked by	Computed by	Checked by	By	By	Computed by	Checked by	Computed by	Checked by	Computed by	Checked by	By	By
CARRIED FORWARD		CARRIED FORWARD		CARRIED FORWARD		CARRIED FORWARD		CARRIED FORWARD		CARRIED FORWARD		CARRIED FORWARD		CARRIED FORWARD	
COLUMN FOOTINGS		COLUMN FOOTINGS		COLUMN FOOTINGS		COLUMN FOOTINGS		COLUMN FOOTINGS		COLUMN FOOTINGS		COLUMN FOOTINGS		COLUMN FOOTINGS	

V.C.	% Grade	STATION	PROFILE		Correction for Vertical Curve	DIST.	Total Excavation Earth and Rock		Balance and Rock Excavation		Embankment		Shaping Course of Gravel	
			ELEVATION On Grade	On V Curve			AREA	CU. YDS.	AREA	CU. YDS.	AREA	CU. YDS.	AREA	CU. YDS.
		1+00	525.30											
		+50	501.95											
		2+00	500.59											
		+50	499.24											
		+52	498.91		0									
		3+00	497.89	495.11	+2.78		52	1014						
		+50	496.53	497.78	+1.25				18	724				
		+62	496.20	495.81	-0.39									
		+80	496.97	497.95	+1.08		82	3274						
		+100	497.61	498.23	+0.62		62	2444						
		+50	499.47	499.89	+0.42		10	388						
		+62	499.51	499.91	0									
		+80	500.59											
		+92	501.05											
		+100	501.14											
		+108	501.25											
		+105	501.41											
		+117	501.95											
		+125	502.25											
		+50	503.18											
		6+00	505.93											
		+50	506.89											
		7+00	506.74	508.78	0									
		+25	509.62	509.88	+0.26				12.5					
		+50	510.60	511.44	+0.84									
		+75	513.20	515.41	+2.21									
		+100	515.90	519.80	0									
		+125	518.40											
		+50	521.0											

1.54  
 1.18  
 3

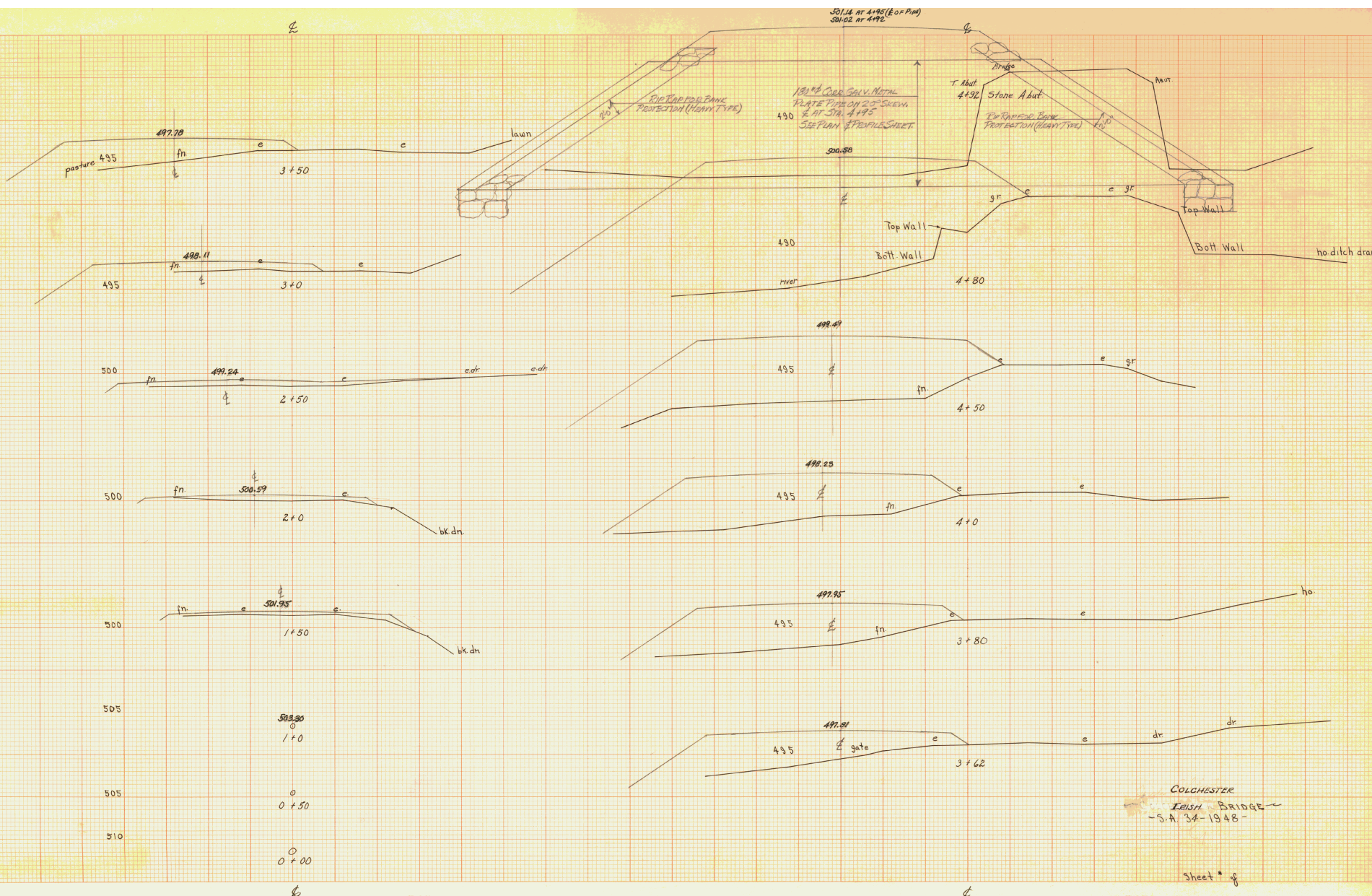

SOL. 16 AT 4+95 (E.O.P. PIP)  
SOL. 02 AT 4+92

1 3/4" CORR. GALV. METAL  
PLATE PIP ON 2" SKEW.  
E. AT STA. 4+95  
SEE PLAN & PROFILE SHEET

Stone Abut  
RIGID FAP FOR BANK PROTECTION (HEAVY TYPE)

COLCHESTER  
IRISH BRIDGE  
- S.A. 34-1948 -

Sheet \* f

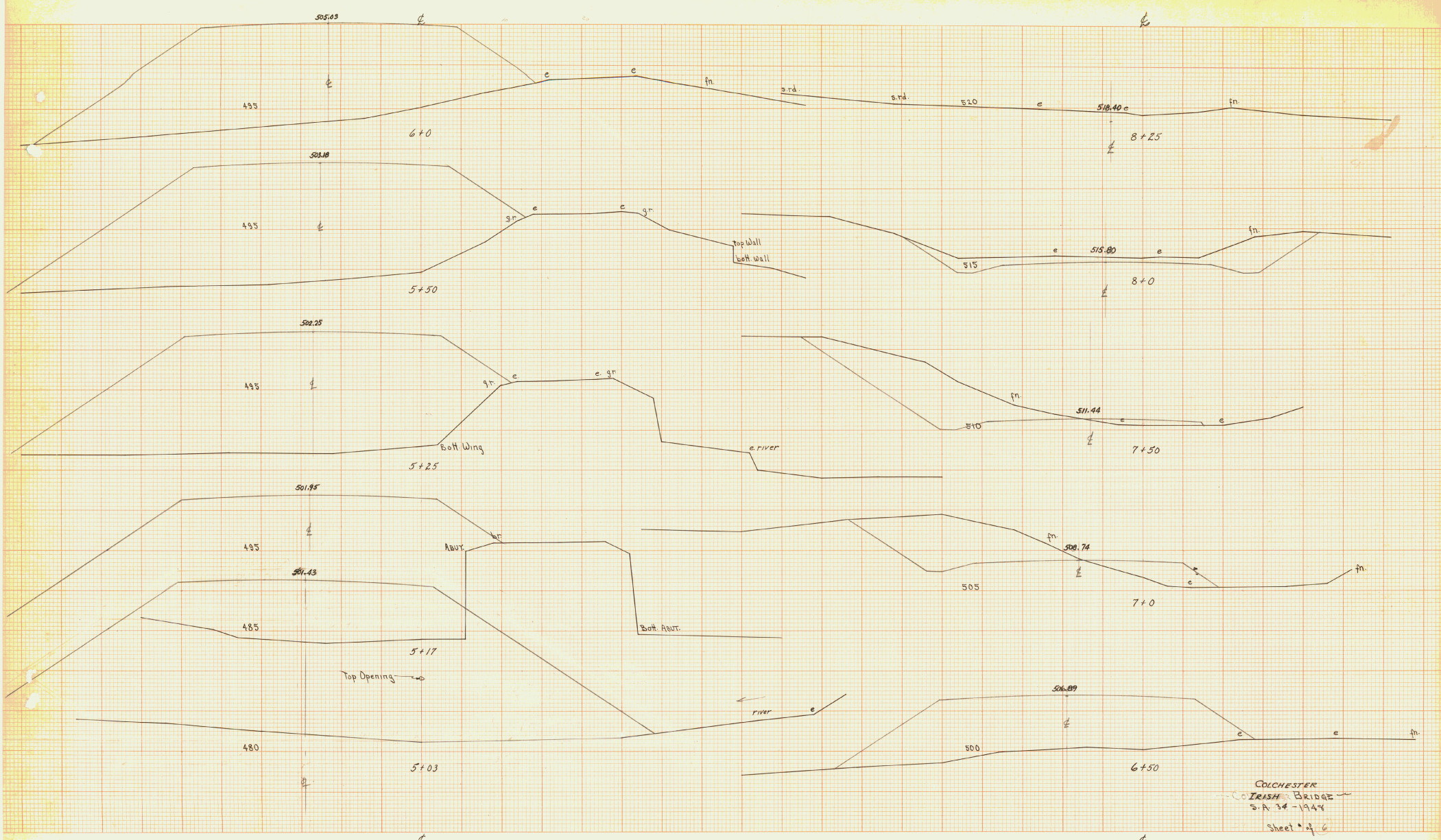

COLCHESTER  
 COLEMAN BRIDGE  
 S.A. 34-1944  
 Sheet # of 6

£

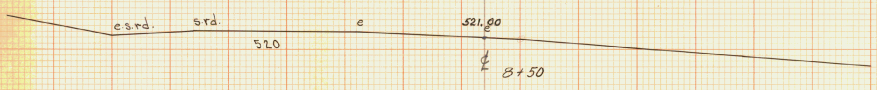
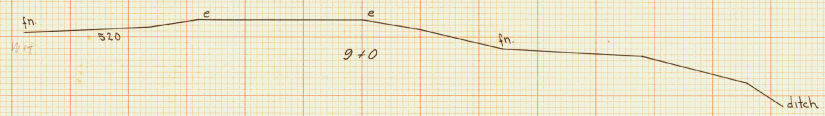
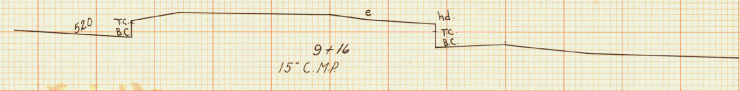
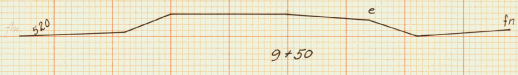
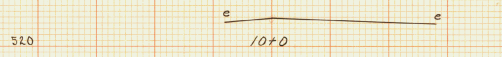

COLCHESTER  
IRISH BRIDGE  
S.A. 34-1948

Sheet # of 6

£