

**NOTES:**

1. MAINTAIN TWO WAY TRAFFIC ON MAIN STREET.
2. MAINTAIN SIDEWALK ACCESS ON THE WEST SIDE OF MAIN STREET.
3. SIDEWALKS ON EAST SIDE OF MAIN STREET SHALL BE CLOSED FROM MERCHANTS ROW TO NORTH OF BRIDGE MAINTAINING ACCESS TO CHURCH'S SIDE DOOR.
4. VEHICLE AND PEDESTRIAN ACCESS TO PRINTER'S ALLEY SHALL BE MAINTAINED.
5. KEEP AS MUCH ON-STREET PARKING ON MAIN STREET AVAILABLE AS POSSIBLE.
6. IF MORE WORK AREA IS REQUIRED ON THE NORTH END OF THE WORK ZONE, CONTRACTOR SHALL PROVIDE ACCESS TO THE ALTERNATIVE CROSSWALK LOCATION USING CHANNELIZING DEVICES WHEN NECESSARY.
7. THE TEMPORARY DOUBLE YELLOW PAVEMENT MARKING LINES SHALL NOT RUN THROUGH THE EXISTING OR ALTERNATIVE CROSSWALK LOCATION.
8. CONTRACTOR SHALL COVER EXISTING CONFLICTING PAVEMENT MARKINGS WITH TEMPORARY PAVEMENT MARKING MASK TAPE TO REDUCE CONFUSION TO THE TRAVELING PUBLIC.
9. FLAGGERS SHALL BE PROVIDED DURING CONSTRUCTION ACTIVITIES TO HELP WITH TRAFFIC FLOW AND PARKING ACCESS.

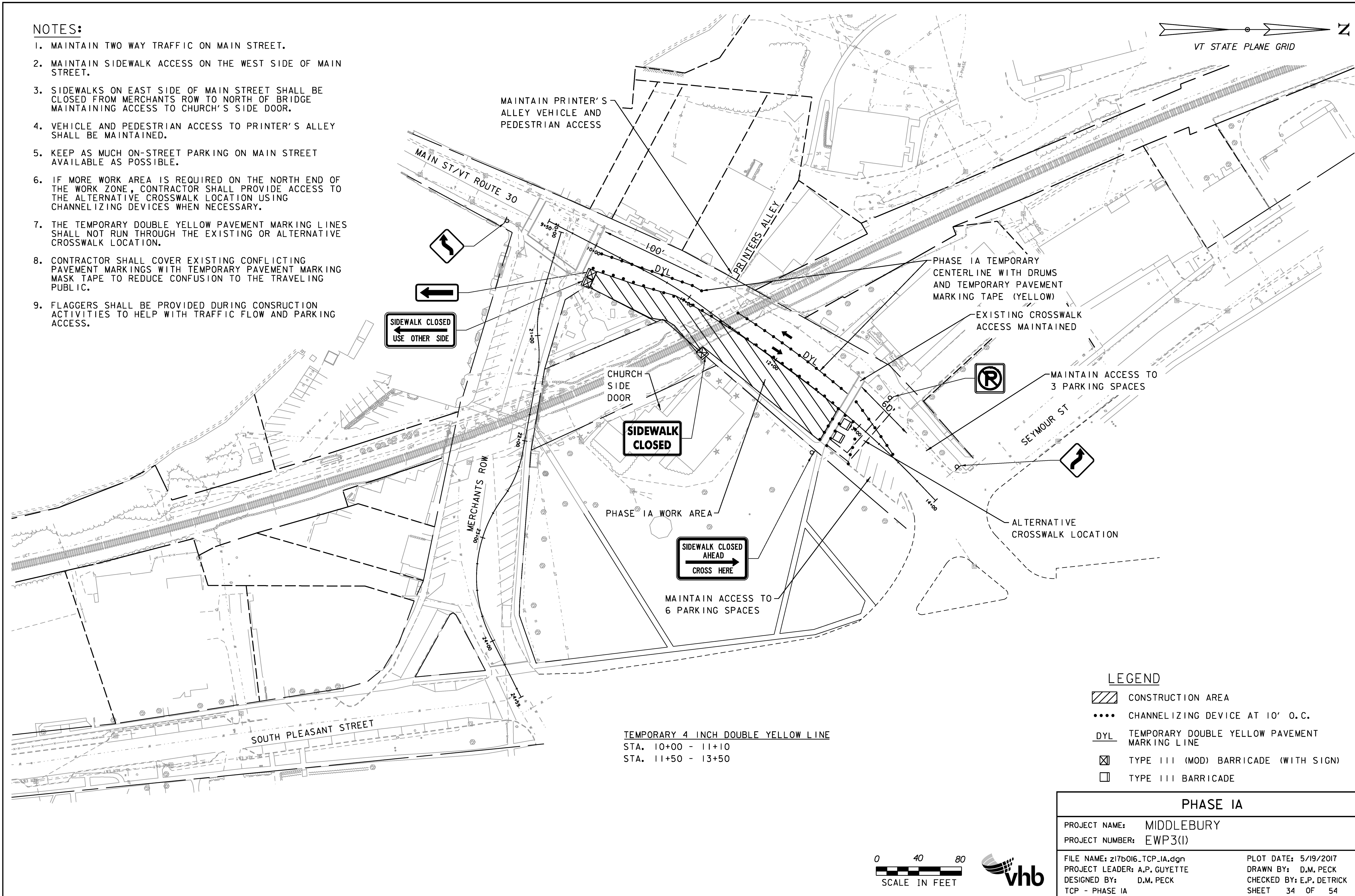

TEMPORARY 4 INCH DOUBLE YELLOW LINE  
 STA. 10+00 - 11+10  
 STA. 11+50 - 13+50

**LEGEND**

- CONSTRUCTION AREA
- CHANNELIZING DEVICE AT 10' O.C.
- TEMPORARY DOUBLE YELLOW PAVEMENT MARKING LINE
- TYPE III (MOD) BARRICADE (WITH SIGN)
- TYPE III BARRICADE

PHASE IA	
PROJECT NAME:	MIDDLEBURY
PROJECT NUMBER:	EWP3(1)
FILE NAME:	z17b016_TCP_IA.dgn
PROJECT LEADER:	A.P. GUYETTE
DESIGNED BY:	D.M. PECK
TCP - PHASE IA	
PLOT DATE:	5/19/2017
DRAWN BY:	D.M. PECK
CHECKED BY:	E.P. DETRICK
SHEET	34 OF 54

