

REMOVING SIGNS
 STA. 10+09, LT
 STA. 11+05, LT
 STA. 11+09, LT
 STA. 11+36, LT
 STA. 11+39, LT
 STA. 11+42, LT (3 SIGNS)
 STA. 11+63, RT
 STA. 12+57, LT

ERECTING SALVAGED SIGNS
 STA. 10+04, LT
 STA. 12+75, RT

BEGIN PROJECT
 MAIN STREET
 STA. 10+00.00

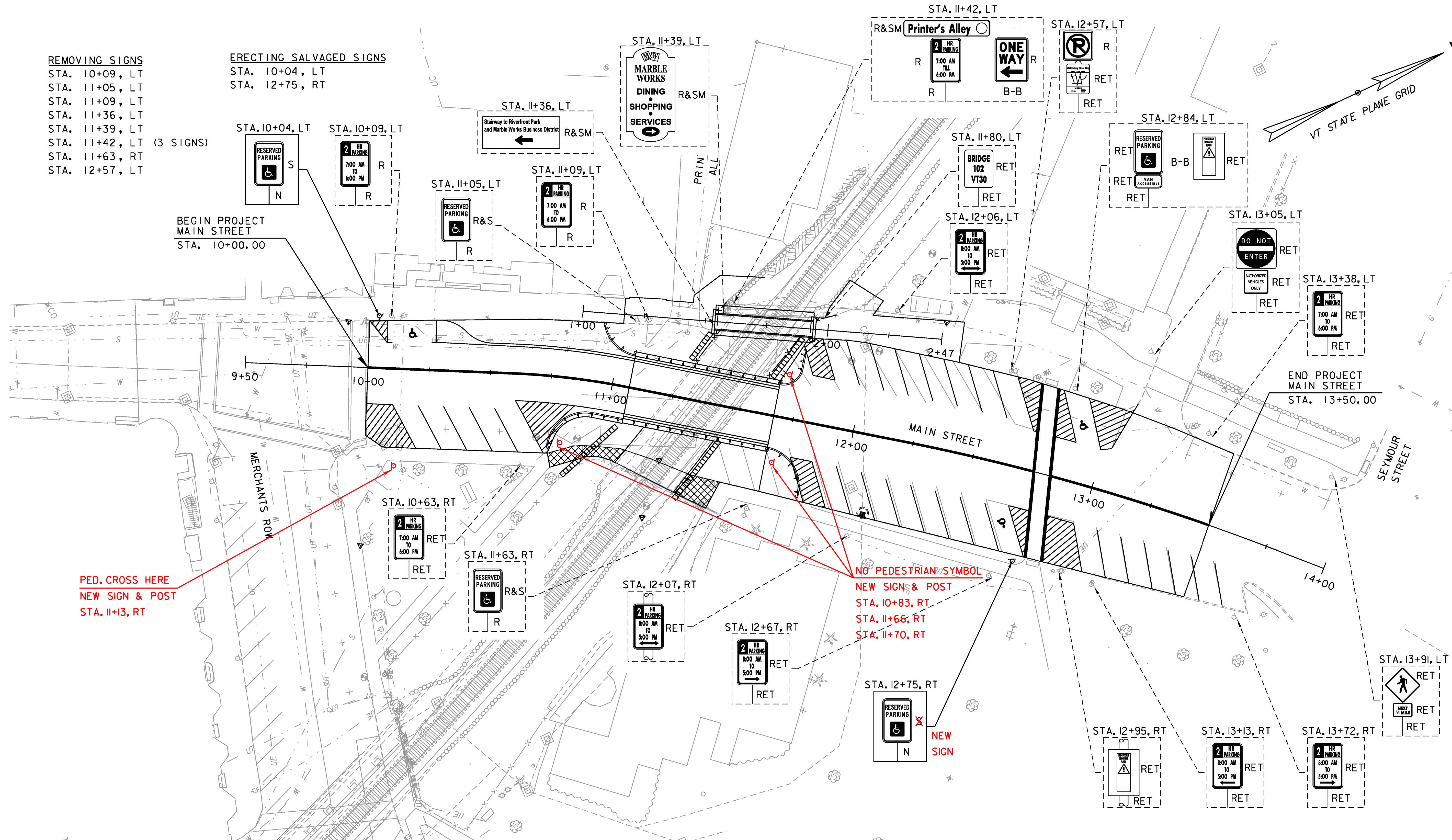
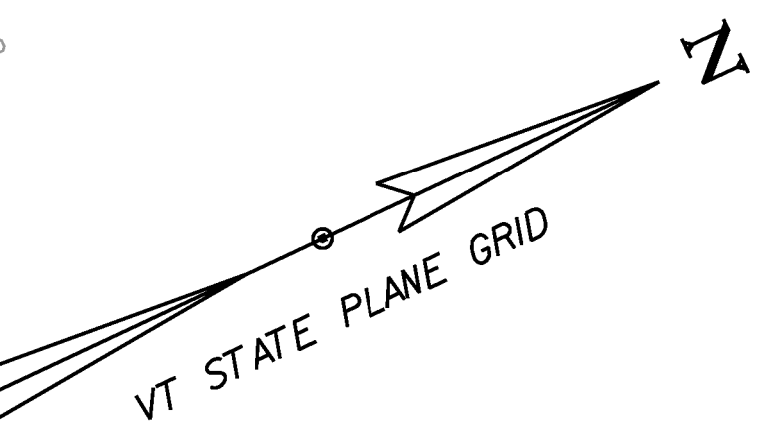

- NOTE**
- SEE MAIN STREET LAYOUT PLAN SHEET FOR ADDITIONAL INFORMATION RELATED TO PAVEMENT MARKINGS.
 - IF A SIGN NOTED AS RETAIN MUST BE REMOVED BY THE CONTRACTOR, THE SIGN SHALL BE REMOVED AND RELOCATED ONCE THE CONSTRUCTION IS CLEAR OF THE SIGN LOCATION. (SUBSIDIARY)

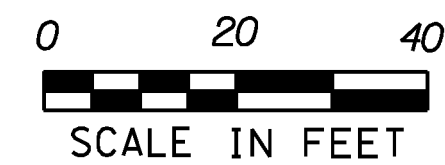

SIGNING LEGEND

N = NEW
 R = REMOVE
 R&S = REMOVE AND SALVAGE
 R&SA = REMOVE AND SALVAGE TO ACTR
 R&SM = REMOVE AND SALVAGE TO TOWN OF MIDDLEBURY
 RET = RETAIN
 S = SALVAGED SIGN
 B-B = BACK TO BACK

PROJECT NAME: MIDDLEBURY
 PROJECT NUMBER: EWP3(I)

FILE NAME: z17b016_BDR_Sign_Main.dgn
 PROJECT LEADER: A.P. GUYETTE
 DESIGNED BY: B.M. ROBERTS
 MAIN STREET SIGNS PLAN SHEET

PLOT DATE: 5/19/2017
 DRAWN BY: B.M. ROBERTS
 CHECKED BY: E.P. DETRICK
 SHEET 24 OF 54

