

EXISTING UTILITY
POLES PROTECT IN
PLACE (NO EXCAVATION
WITHIN THE DENOTED
AREA SURROUNDING POLE)

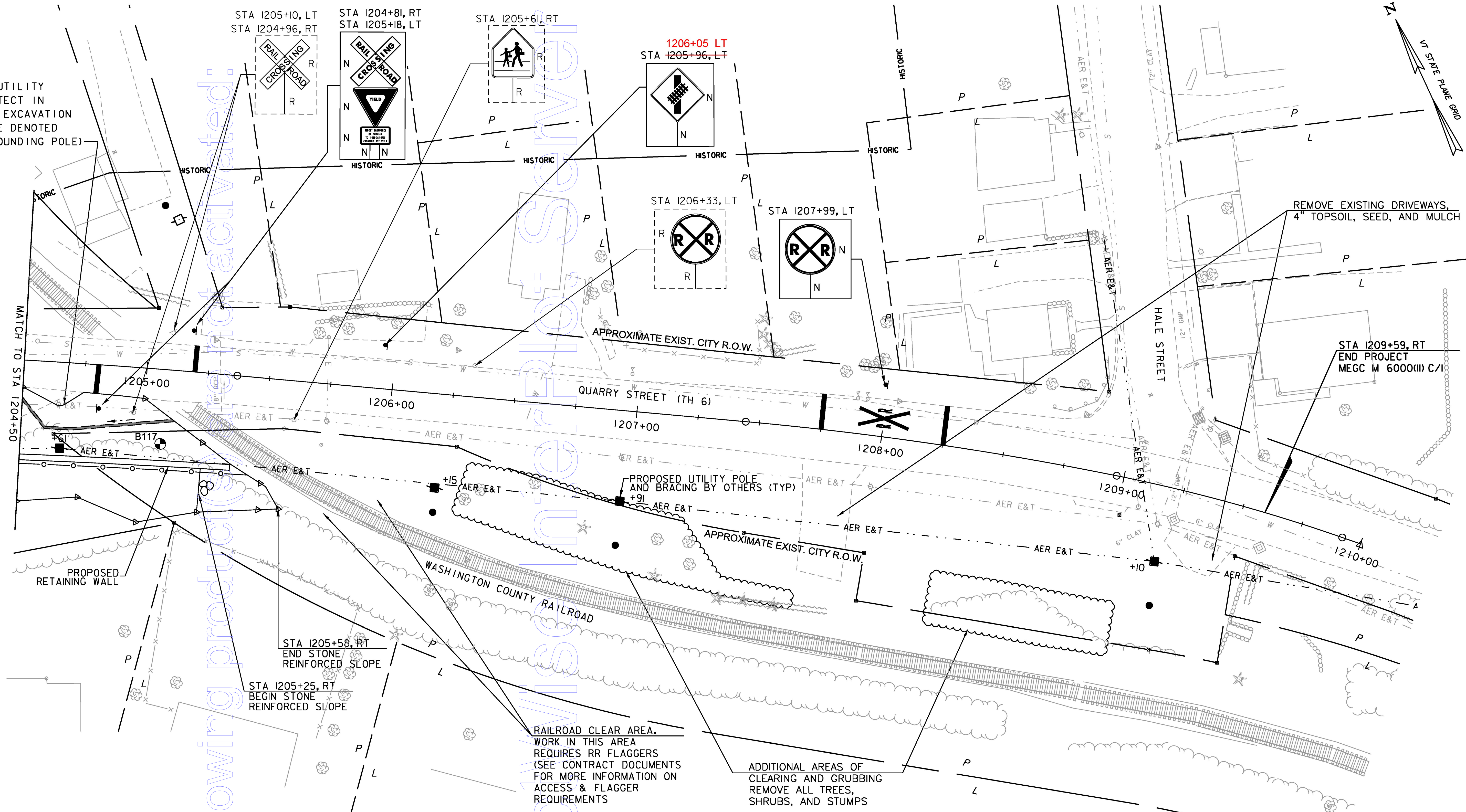

The following product(s) is/are factored:

REMOVING SIGNS
 STA 1204+96, RT
 STA 1205+10, LT
 STA 1205+61, RT
 STA 1206+33, LT

TRAFFIC SIGNS, TYPE A
 STA 1204+81, RT
 STA 1205+18, LT
 STA 1205+96, LT
 STA 1207+99, LT

RAILROAD CROSSING SYMBOL, WATERBORNE PAINT
 STA 1204+50 - 1204+80, RT
 STA 1205+20 - 1208+25, LT

SPECIAL PROVISION (RETAINING WALL)
 STA 1204+50 TO 1205+37, RT

STONE FILL, TYPE II
 STA 1205+25 TO 1205+58, RT

GRUBBING MATERIAL
 STA 1205+25 TO 1205+58, RT

CLEARING & GRUBBING, INCL. INDIVIDUAL TREES & STUMPS
 STA 1204+50 - 1205+58, RT
 STA 1206+28 - 1207+71, RT
 STA 1208+28 - 1209+07, RT

YIELDING MARKER POSTS
 STA 1205+37, RT

CHAIN LINK FENCE, 6 FEET
 STA 1204+50 TO 1205+44, RT

BRACING ASSEMBLY FOR CHAIN-LINK FENCE, 6 FEET
 STA 1205+44, RT

SIGNING LEGEND
 N = NEW SIGN
 R = REMOVE SIGN
 RET = RETAIN SIGN
 R&S = REMOVE AND SALVAGE
 S = SALVAGED SIGN



PROJECT NAME:	BARRE CITY - BARRE TOWN
PROJECT NUMBER:	MEGC M 6000(III)C/1
FILE NAME:	z15d040bdr_gen.dgn
PROJECT LEADER:	A.P. GUYETTE
DESIGNED BY:	D.M. PECK
GENERAL PLAN SHEET (2 OF 2)	
PLOT DATE:	12/2/2016
DRAWN BY:	P.A. MILLER
CHECKED BY:	D.M. PECK
SHEET	16 OF 39