

PITTSFORD

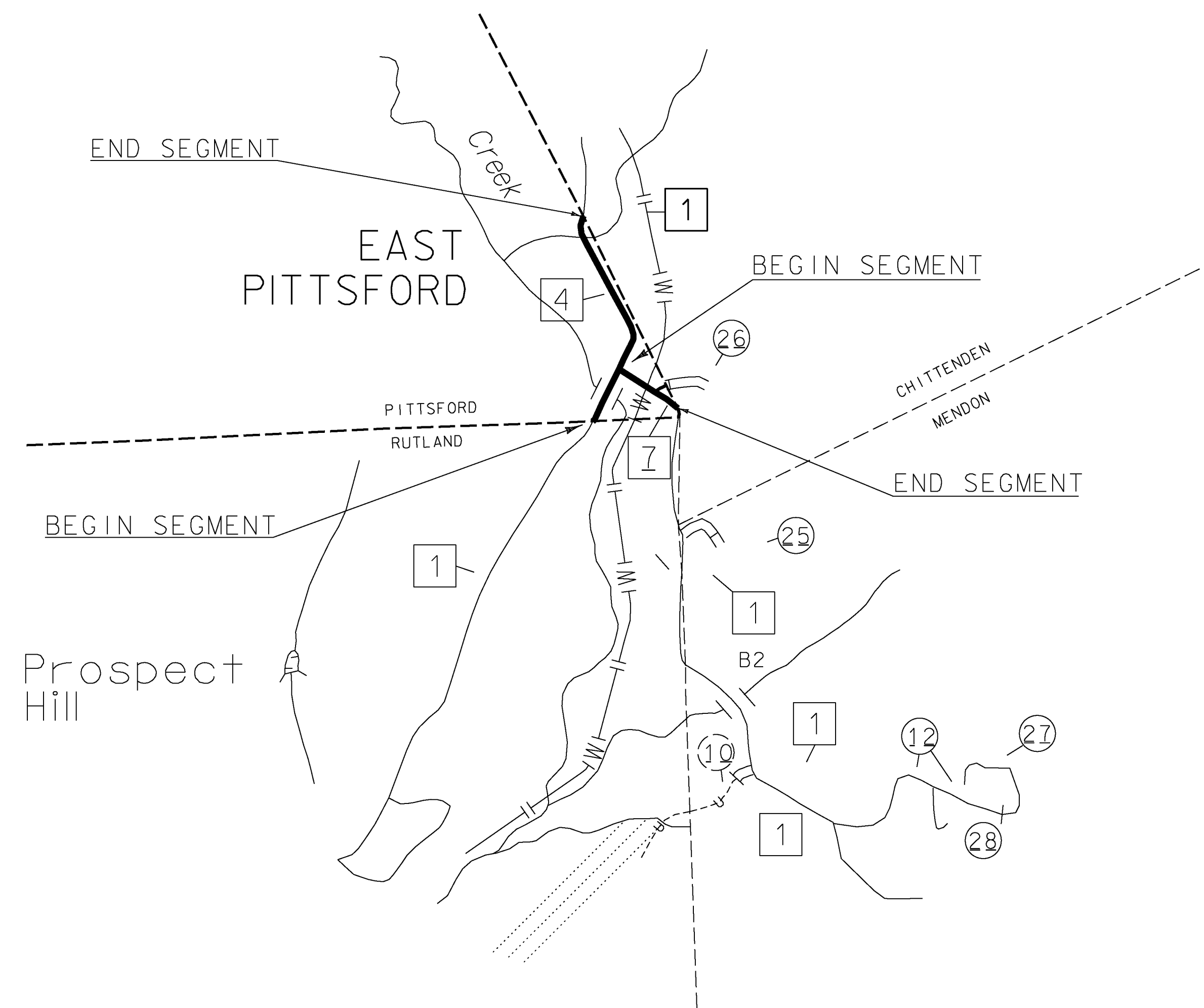

WORK TO BEGIN AT THE RUTLAND/PITTSFORD TOWN LINE ON EAST PITTSFORD ROAD (TH-4) DESIGNATING THIS AS MILE POINT 0.000 AND EXTENDING NORTHERLY IN THE TOWN OF PITTSFORD FOR A DISTANCE OF 0.612 MILES TO A POINT 0.061 MILES NORTH OF POLE # 15T/35/ 71/ 119 (MM 0.551) TO END THIS SEGMENT OF THE PROJECT.

ON ANOTHER ROAD, BEGINNING AT THE INTERSECTION OF EAST PITTSFORD ROAD (TH-4) AND MEADOWLAKE DRIVE (TH-7) DESIGNATING THE POINT AT WHICH THE CENTERLINES OF EACH ROAD INTERSECTS AS MILE POINT 0.000 AND EXTENDING EASTERLY ALONG MEADOWLAKE DRIVE (TH-7) FOR A DISTANCE OF 0.189 MILES TO A POINT 0.082 MILES EAST OF MAILBOX # 85 (MM 0.107) TO END THIS SEGMENT OF THE PROJECT.

TINMOUTH

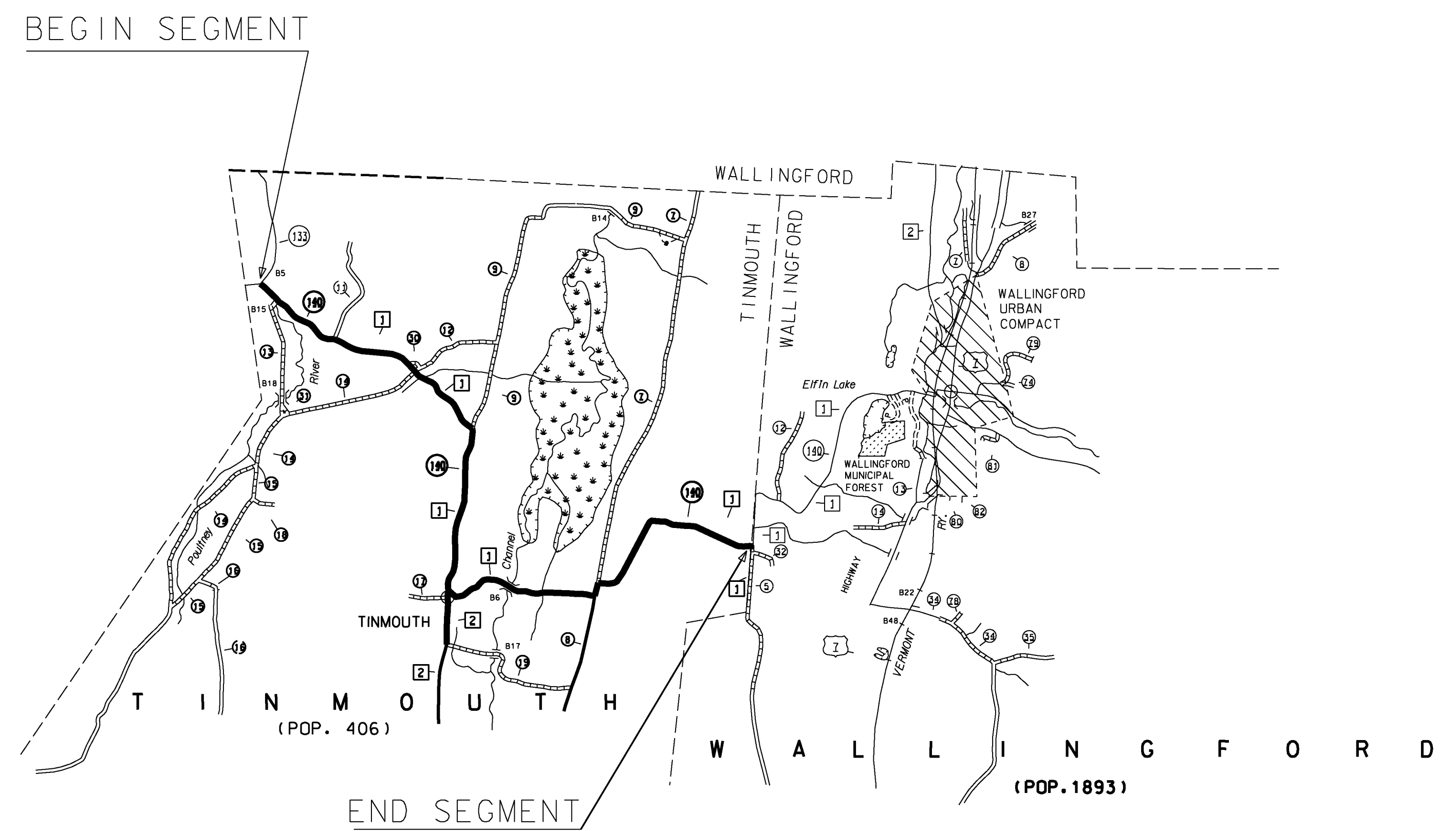

WORK TO BEGIN AT THE INTERSECTION OF SNTH 140 AND VT ROUTE 133 IN THE TOWN OF TINMOUTH, DESIGNATING WHERE THE CENTERLINES OF THESE TWO ROADS INTERSECTS AS MILE POINT 0.000 AND EXTENDING EASTERLY FOR A DISTANCE OF 5.925 MILES TO THE WALLINGFORD/TINMOUTH TOWN LINE AT A POINT 0.058 MILES EAST OF POLE NUMBER VTREL/26 (MM 5.967) TO END THIS SEGMENT OF THE PROJECT.

ON ANOTHER ROAD BEGINNING AT THE INTERSECTION OF SNTH 140 AND MOUNTAIN VIEW ROAD (TH-2) IN THE TOWN OF TINMOUTH DESIGNATING THE CURRENT LOCATION OF BLISS ROAD (TH-17) STREET NAME SIGN, LOCATED 0.040 MILES SOUTH OF POLE # 933/ 1 /CTC/30 (MM 0.040) AS MILE POINT 0.000 AND EXTENDING SOUTHERLY FOR A DISTANCE OF 0.282 MILES TO A POINT 0.068 MILES SOUTH OF POLE # 933/ 4A/63/ 33-1 (MM 0.214) TO END THIS SEGMENT OF THE PROJECT.

PROJECT NAME: STATEWIDE SOUTHWEST REGION	PLOT DATE: 12/20/2013
PROJECT NUMBER: STP HRRR(19)	DRAWN BY: N. PATTIS
FILE NAME: I3k036wrk.dgn	CHECKED BY: B. GROSE
PROJECT LEADER: P. COBURN	SHEET 10 OF 87
DESIGNED BY: N. PATTIS	
SITE MAP SHEET 3	