

# BENNINGTON

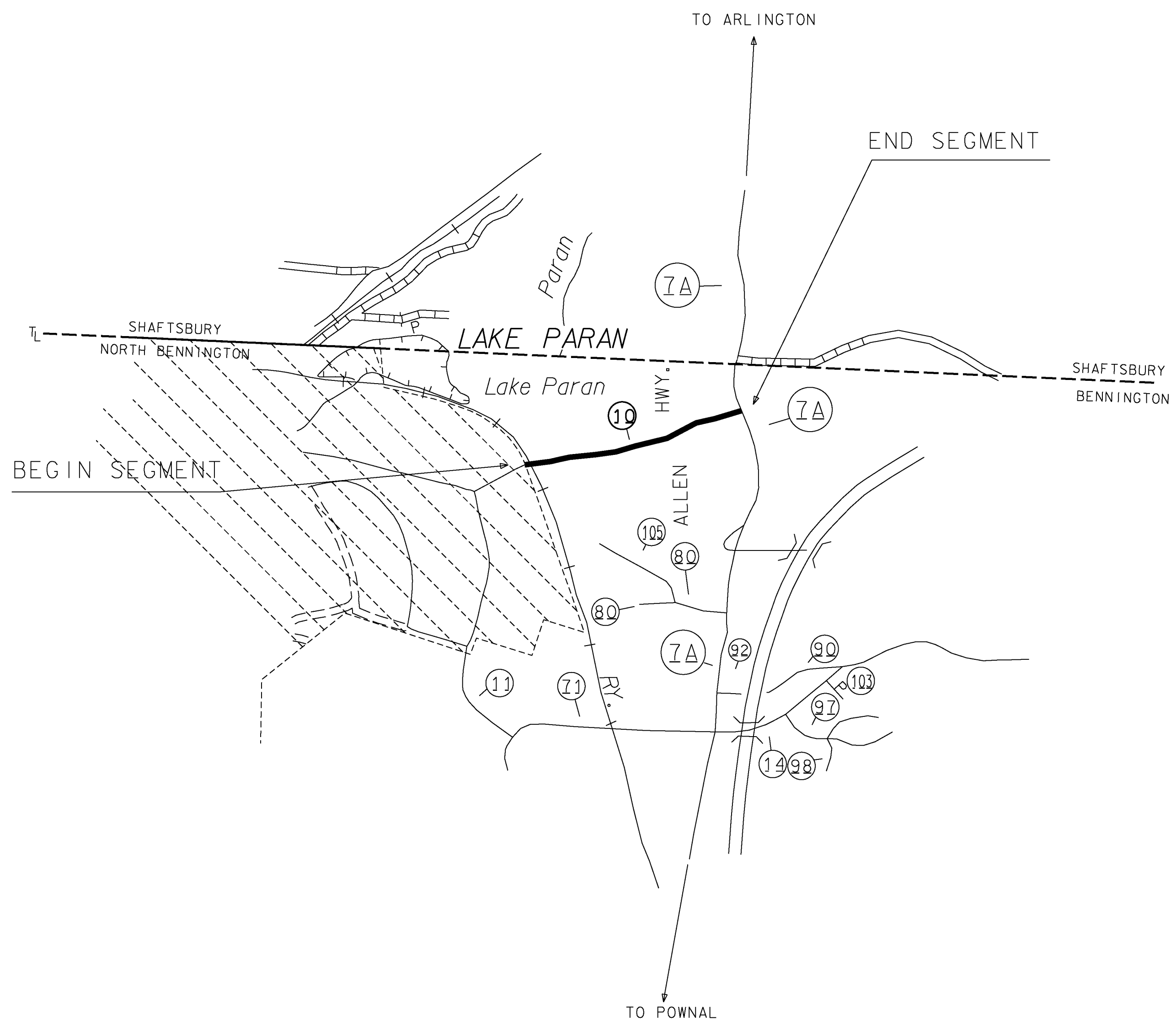

WORK TO BEGIN AT THE BENNINGTON/NORTH BENNINGTON VILLAGE LINE, DESIGNATING THIS AS MILE POINT 0.000 AND EXTENDING EASTERLY ALONG OVERLEA ROAD (TH-10) FOR A DISTANCE OF 0.740 MILES TO A POINT 0.050 MILES EAST OF POLE # 76 / 2 / 2 TO END THIS SEGMENT OF THE PROJECT.

# DORSET

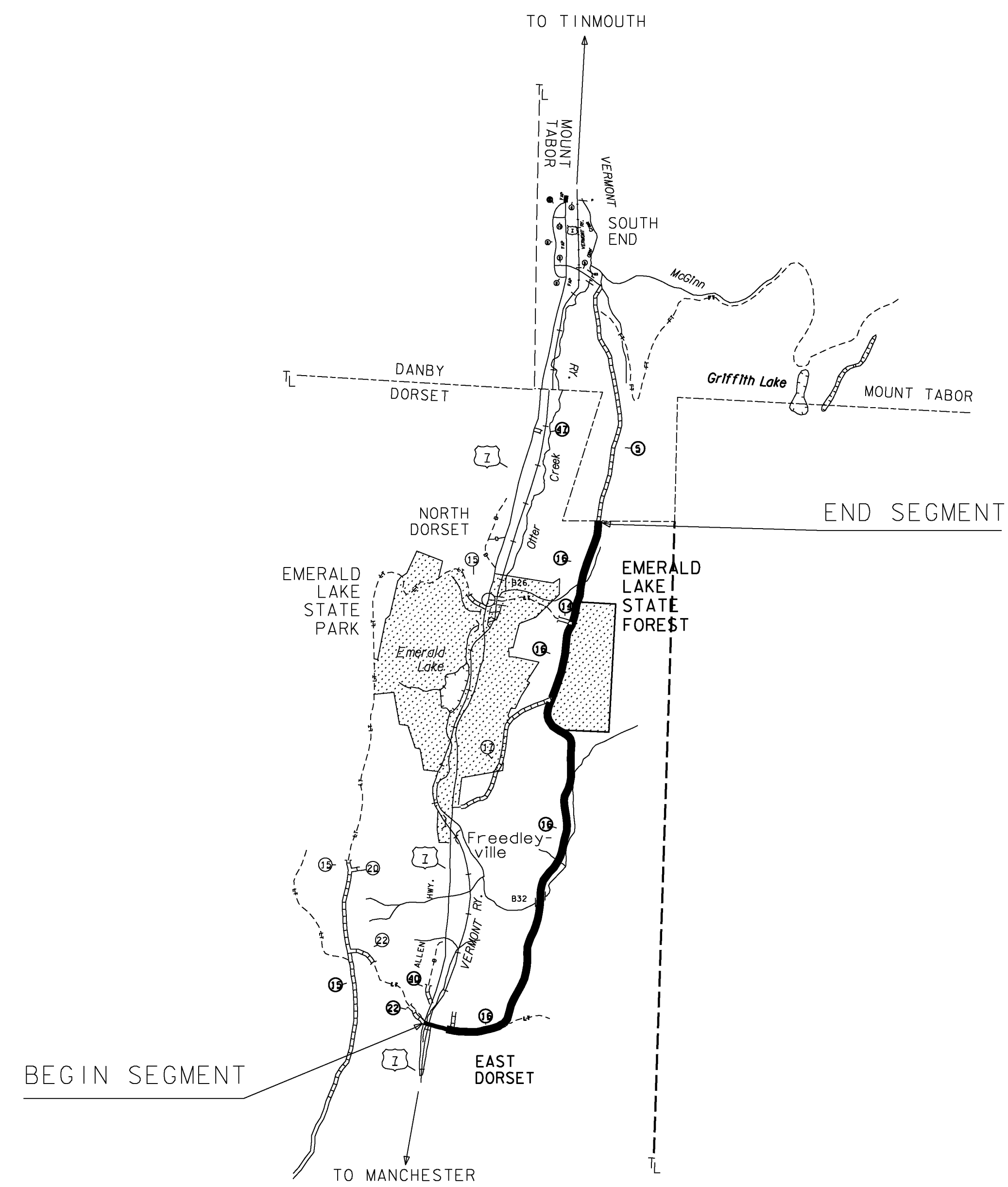

BEGINNING AT THE INTERSECTION OF MAD TOM ROAD (TH-16) AND US ROUTE 7 IN THE VILLAGE OF EAST DORSET, DESIGNATING WHERE THE CENTERLINES OF EACH ROAD INTERSECTS AS MILE POINT 0.000 AND EXTENDING NORTHEASTERLY ALONG MAD TOM ROAD (TH-16) FOR A DISTANCE OF 4.337 MILES TO A POINT 1.147 MILES NORTH OF POLE # 215/NET/22/75 (MM 3.190) TO END THIS SEGMENT OF THE PROJECT.

<b>PROJECT NAME:</b> STATEWIDE SOUTHWEST REGION	
<b>PROJECT NUMBER:</b> STP HRRR(19)	
<b>FILE NAME:</b> I3k036wrk.dgn	<b>PLOT DATE:</b> 12/20/2013
<b>PROJECT LEADER:</b> P. COBURN	<b>DRAWN BY:</b> N. PATTIS
<b>DESIGNED BY:</b> N. PATTIS	<b>CHECKED BY:</b> B. GROSE
<b>SITE MAP SHEET 1</b>	<b>SHEET 8 OF 87</b>