

SAINT ALBANS

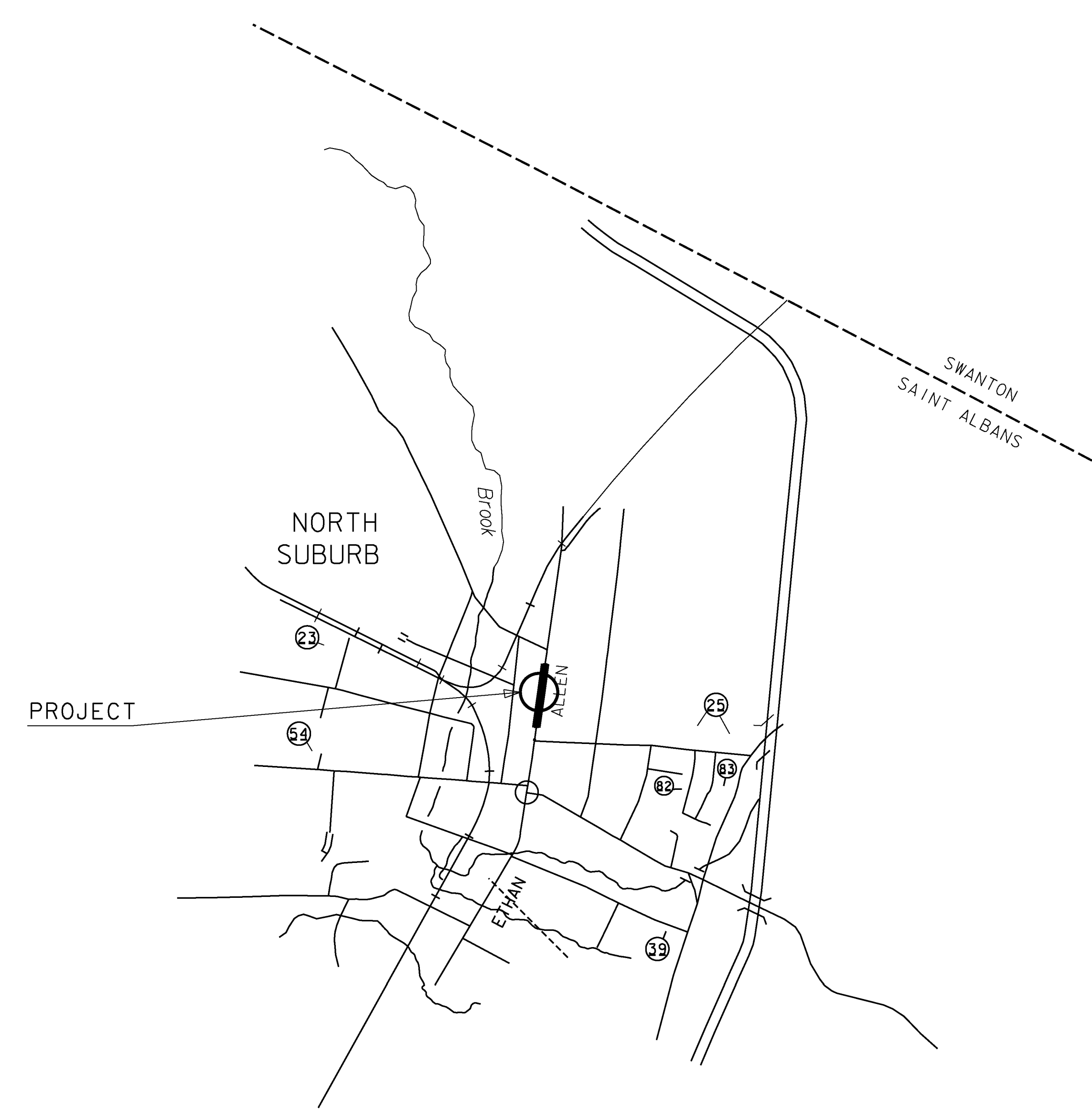

DESIGNATING THE INTERSECTION OF US ROUTE 7 (TH-1) AND HOYT ST (TH-137) IN THE CITY OF ST ALBANS AS MILE MARKER 1.48 AND TRAVELING NORTH ALONG US ROUTE 7 (TH-1) TO A POINT 0.079 MILES NORTH OF THE INTERSECTION OF US ROUTE 7 (TH-1) AND HOYT ST (TH-137), TO MILE MARKER 1.559 (SIGNALIZED INTERSECTION OF US ROUTE 7 AND JC PENNEY DRIVE) WHERE THE WORK IS TO BE DONE.

STOWE

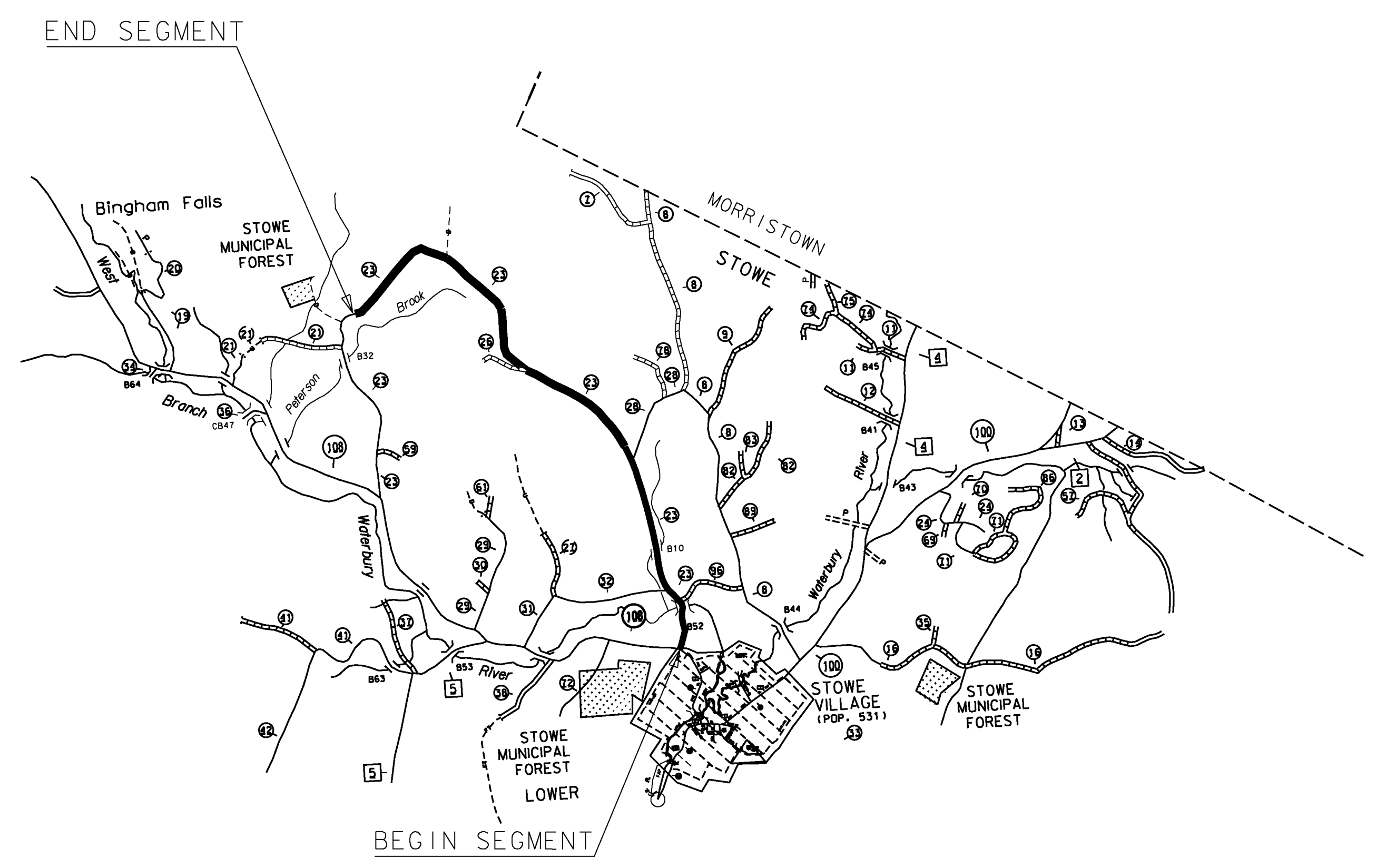

BEGINNING AT THE INTERSECTION OF WEEKS HILL ROAD (TH-23) AND VT ROUTE 108 IN THE TOWN OF STOWE AND DESIGNATING WHERE THE CENTERLINES OF EACH OF THESE ROADS INTERSECT AS MILE MARKER 0.000 AND EXTENDING NORTHERLY ALONG WEEKS HILL ROAD (TH-23) FOR A DISTANCE OF 4.142 MILES TO A POINT 0.249 MILES NORTH OF POLE # 53/ 5 1/2 /53 (MM 3.893) TO END THIS SEGMENT OF THE PROJECT.

PROJECT NAME:	STATEWIDE NORTHWEST REGION
PROJECT NUMBER:	STP HRRR(17)
FILE NAME:	sitemap4.dgn
PROJECT LEADER:	J. DEVLIN
DESIGNED BY:	N. PATTIS
SITE MAP SHEET	4
PLOT DATE:	1/22/2014
DRAWN BY:	N. PATTIS
CHECKED BY:	B. GROSE
SHEET	11 OF 73