

GEORGIA

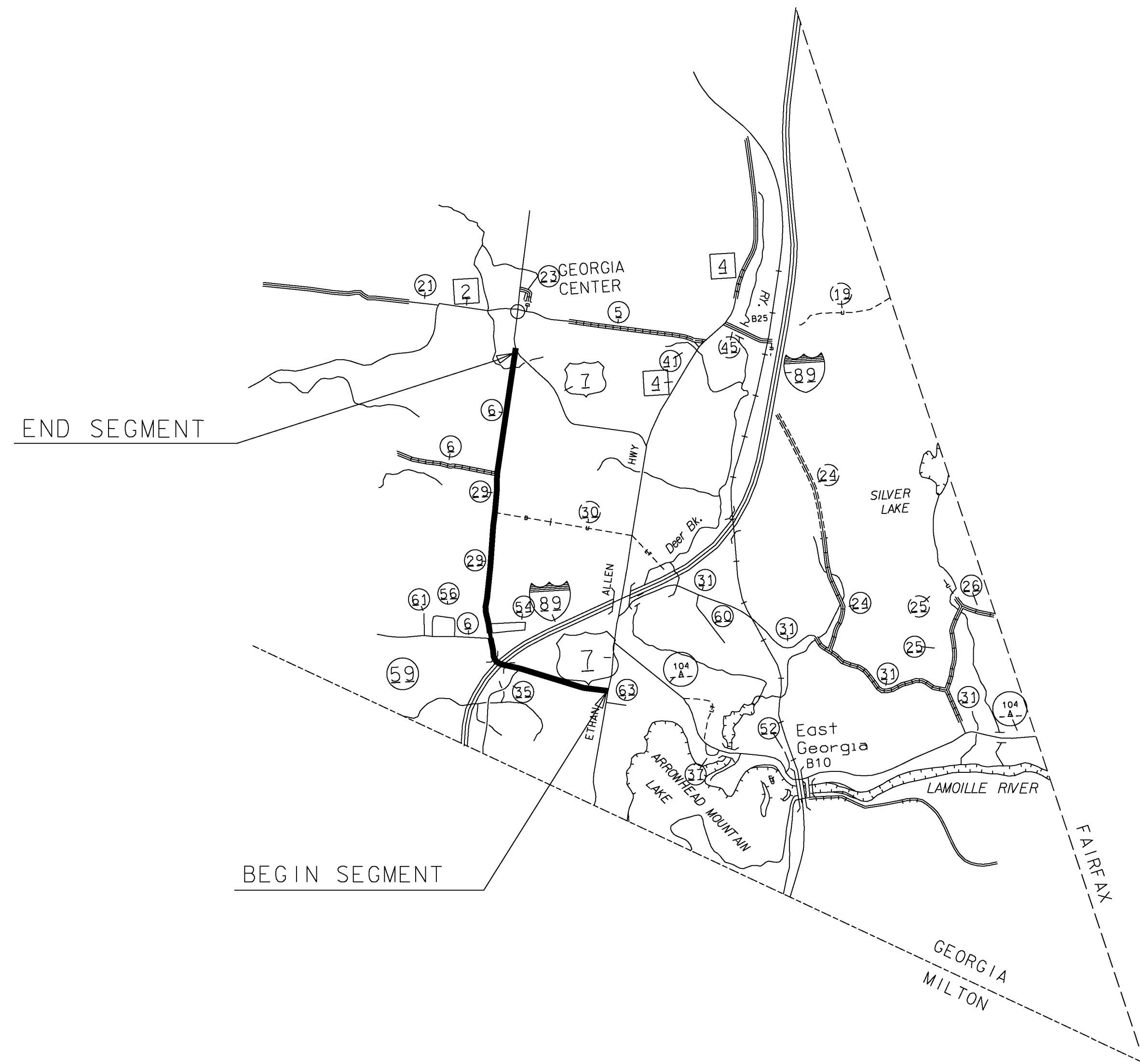

BEGINNING AT THE INTERSECTION OF BALLARD ROAD (TH-29) AND US ROUTE 7, DESIGNATING WHERE THE CENTERLINE OF EACH OF THE ROADS INTERSECTS AS MILE MARKER 0.000 AND EXTENDING NORTHERLY ALONG BALLARD ROAD (TH-29) FOR A DISTANCE OF 2.874 MILES TO A POINT 0.005 MILES NORTH OF POLE # 188A (MM 2.869) TO END THIS SEGMENT OF THE PROJECT.

MILTON

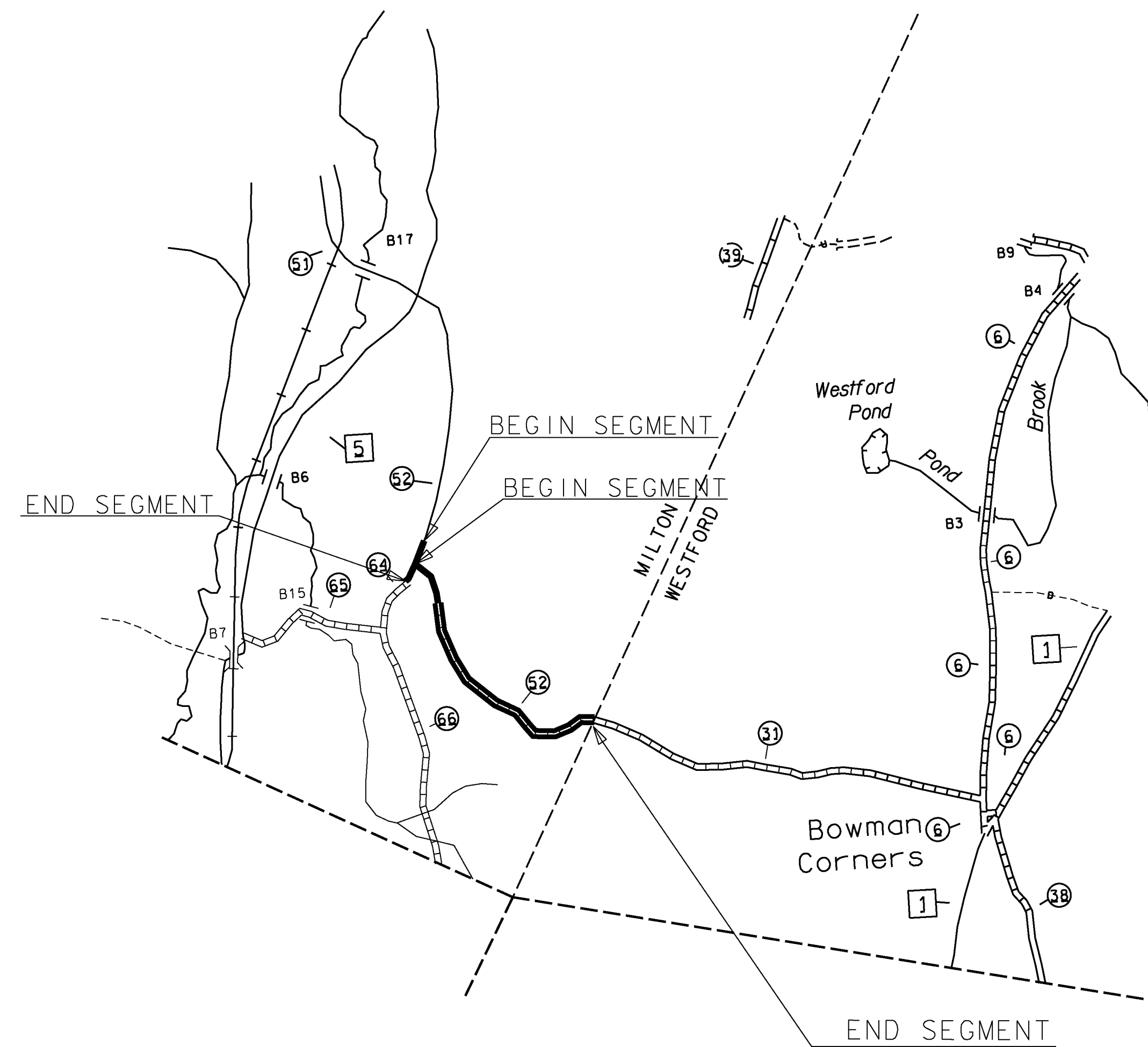

BEGINNING AT THE INTERSECTION OF ROLLIN IRISH ROAD (TH-52) AND DUFFY ROAD (TH-64) IN THE TOWN OF MILTON AND DESIGNATING WHERE THE CENTERLINE OF EACH OF THESE ROADS INTERSECTS AS MILE MARKER 0.000 AND EXTENDING EASTERLY ALONG ROLLIN IRISH ROAD (TH-52) FOR A DISTANCE OF 1.154 MILES TO A POINT 0.005 MILES EAST OF POLE # 87/ 4 / 140 (MM 1.149) TO END THIS SEGMENT OF THE PROJECT.

ON ANOTHER ROAD, BEGINNING AT POLE # 46/ 6 ON DUFFY ROAD (TH-52) IN THE TOWN OF MILTON AND EXTENDING SOUTHERLY ALONG DUFFY ROAD (TH-52) FOR A DISTANCE OF 0.144 MILES TO A POINT 0.086 MILES SOUTH OF POLE # 406/ 4 / 56 (MM 0.058) TO END THIS SEGMENT OF THE PROJECT.

PROJECT NAME:	STATEWIDE NORTHWEST REGION
PROJECT NUMBER:	STP HRRR(17)
FILE NAME:	sitemap2.dgn
PROJECT LEADER:	J. DEVLIN
DESIGNED BY:	N. PATTIS
SITE MAP SHEET	2
PLOT DATE:	1/22/2014
DRAWN BY:	N. PATTIS
CHECKED BY:	B. GROSE
SHEET	9 OF 73