

NEWARK

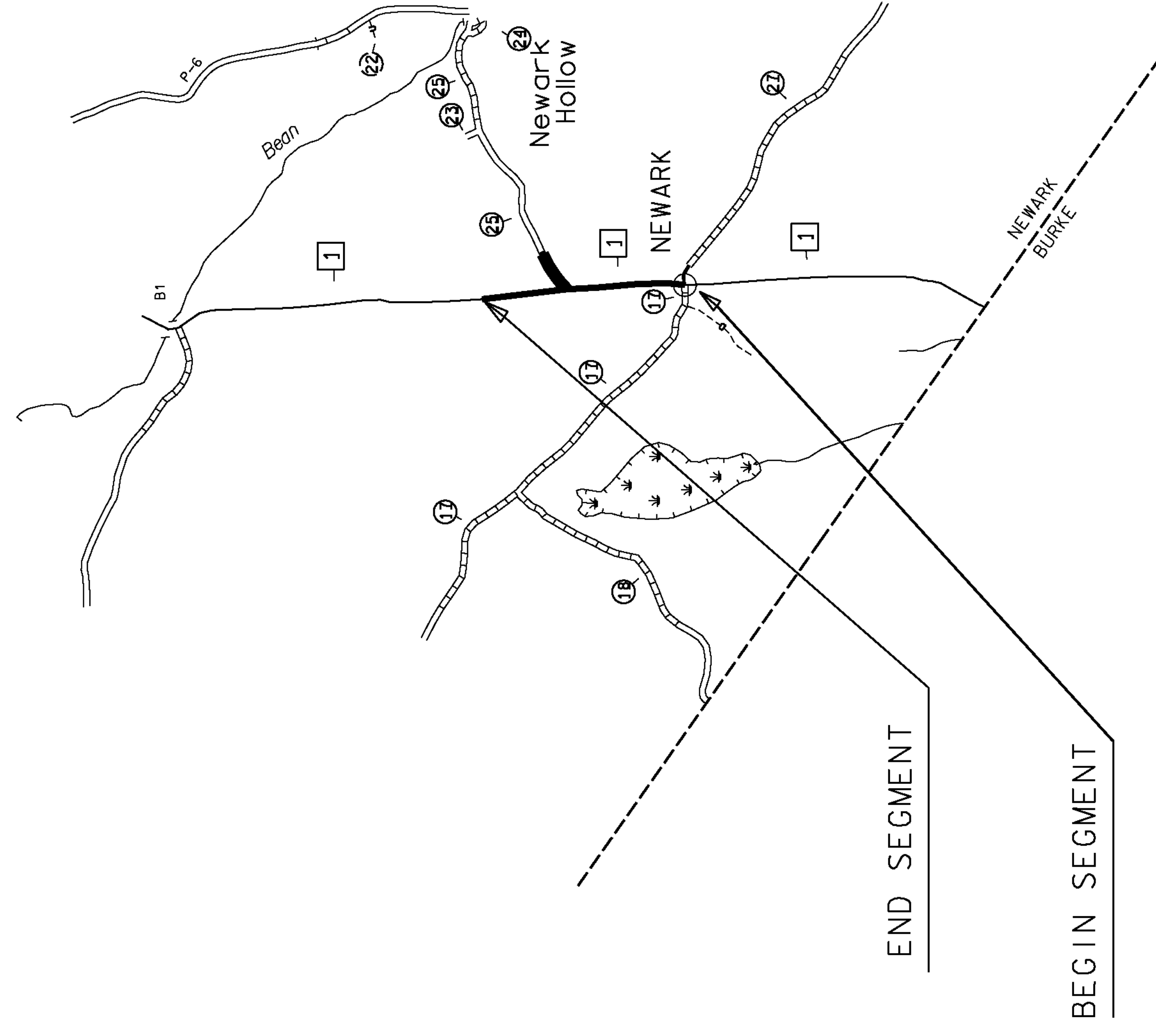

WORK TO BEGIN AT THE INTERSECTION OF NEWARK STREET (TH-1) AND SCHOOLHOUSE ROAD (TH-17) AT MM 1.260 AND CONTINUING NORTHERLY ALONG NEWARK STREET (TH-1) 0.574 MILES TO POLE #88 /134 (MM1.834) TO END THIS SEGMENT OF THE PROJECT.

ALSO WORK TO BEGIN AT THE INTERSECTION OF NEWARK STREET (TH-1) AND HOLLOW ROAD (TH-25) DESIGNATING WHERE THE CENTER OF THESE ROADS INTERSECTS AS MILE MARKER 0.000 AND EXTENDING EASTERLY ALONG HOLLOW ROAD (TH-25) FOR A DISTANCE OF 0.070 MILES TO A POINT 0.024 MILES EAST OF POLE # NET/618 /1 (MM 0.046) TO END THIS SEGMENT OF THE PROJECT.

BEGINNING AT THE INTERSECTION OF SCOTCH HOLLOW ROAD DESIGNATED AS MILE MARKER 0.000 NORTHERLY ALONG LEIGHTON HILL TO A POINT 0.093 MILES NORTHERLY (MM 4.533) TO END THIS SEGMENT OF THE PROJECT.

N

