

CONSTRUCT AGGREGATE SURFACE COURSE
 DRIVES W/ 5'-0" PAVED APRONS
 STA 113+91.0 RT - 19.00' WIDE*
 STA 114+00 LT

REMOVAL AND DISPOSAL OF GUARDRAIL
 STA 114+24.3 RT - 114+52.0 RT
 STA 114+28.2 LT - 114+51.9 LT
 STA 114+81.4 RT - 115+40.1 RT
 STA 114+82.1 LT - 11+45.0 LT

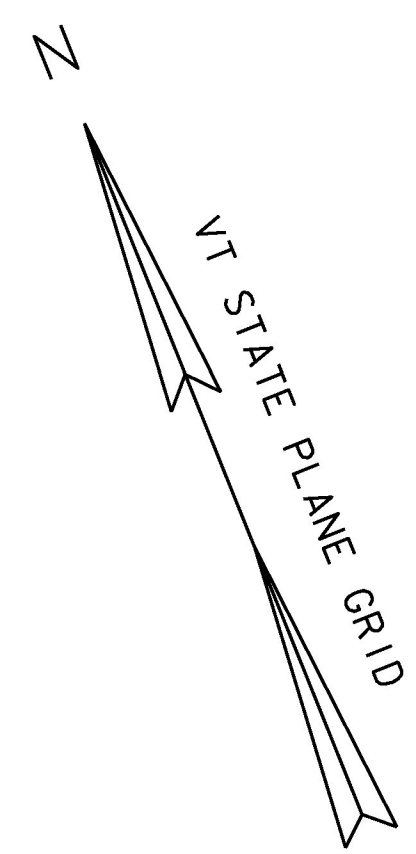
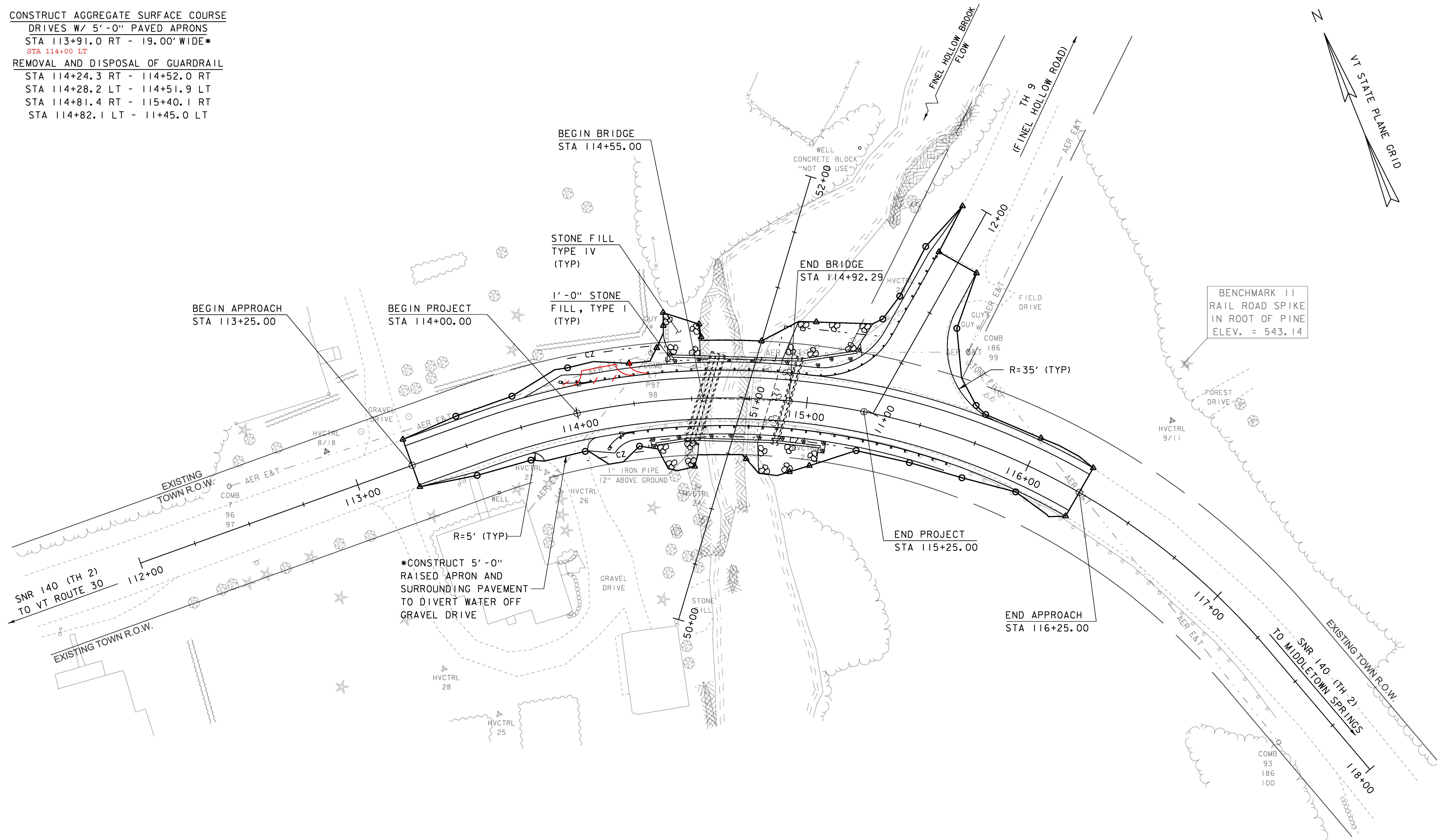

EXISTING BRIDGE INFORMATION
 31' LONG CONCRETE T-BEAM
 BUILT 1900
 23'-4" FASCIA TO FASCIA
 7° SKEW

SCALE 1" = 20'-0"
 20 0 20

PROJECT NAME:	POULTNEY	PLOT DATE:	15-AUG-2018
PROJECT NUMBER:	BF 0138(12)	DRAWN BY:	G. DARGAN
FILE NAME:	s13j276bdr.dgn	CHECKED BY:	G. LAROCHE
PROJECT LEADER:	R. YOUNG	LAYOUT	SHEET 13 OF 46