

**T.R. #2 TRAFFIC CONTROL APPROACH SIGN PACKAGE**

**APPROACH SIGN NOTES:**

1. ALL SIGNS ARE TO BE LOCATED ON THE RIGHT SIDE OF THE ROAD APPROACHING THE CONSTRUCTION AREA UNLESS OTHERWISE NOTED.
2. SIGN SPACING MAY BE ADJUSTED AS NECESSARY AT THE DISCRETION OF THE ENGINEER.

**TRAFFIC CONTROL NOTES:**

1. SEE PROJECT NOTES SHEET FOR ADDITIONAL TRAFFIC CONTROL NOTES.
2. TEMPORARY TRAFFIC BARRIER SHALL BE FURNISHED IN ACCORDANCE WITH SECTION 621 AND WILL BE PAID UNDER CONTRACT PAY ITEM 900.645 SPECIAL PROVISION (TRAFFIC CONTROL, ALL-INCLUSIVE).

**MESSAGES FOR PORTABLE CHANGEABLE MESSAGE SIGNS (PCMS)**

STARTING 2 WEEK (S) PRIOR TO CLOSURE

PHASE 1	<b>BRIDGE CLOSED</b>
	<b>ON CADY'S FALLS ROAD</b> <b>XX/XX/XX - XX/XX/XX</b>
PHASE 2	<b>SEEK ALTERNATE ROUTES</b>

**LEGEND**

	TYPE III BARRICADE
	TEMPORARY TRAFFIC BARRIER

**NOTE:** UTILITY RELOCATIONS SHOWN TO BE COMPLETED BY OTHERS PRIOR TO CONSTRUCTION.

PROJECT NAME:	MORRISTOWN
PROJECT NUMBER:	BF 0239(3)
FILE NAME:	z13j274bdr_+tc.dgn
PROJECT LEADER:	T. KNIGHT
DESIGNED BY:	T. KNIGHT
TRAFFIC CONTROL PLAN	
PLOT DATE:	3/9/2016
DRAWN BY:	J. SOTER
CHECKED BY:	D. YOULEN
SHEET	8 OF 9

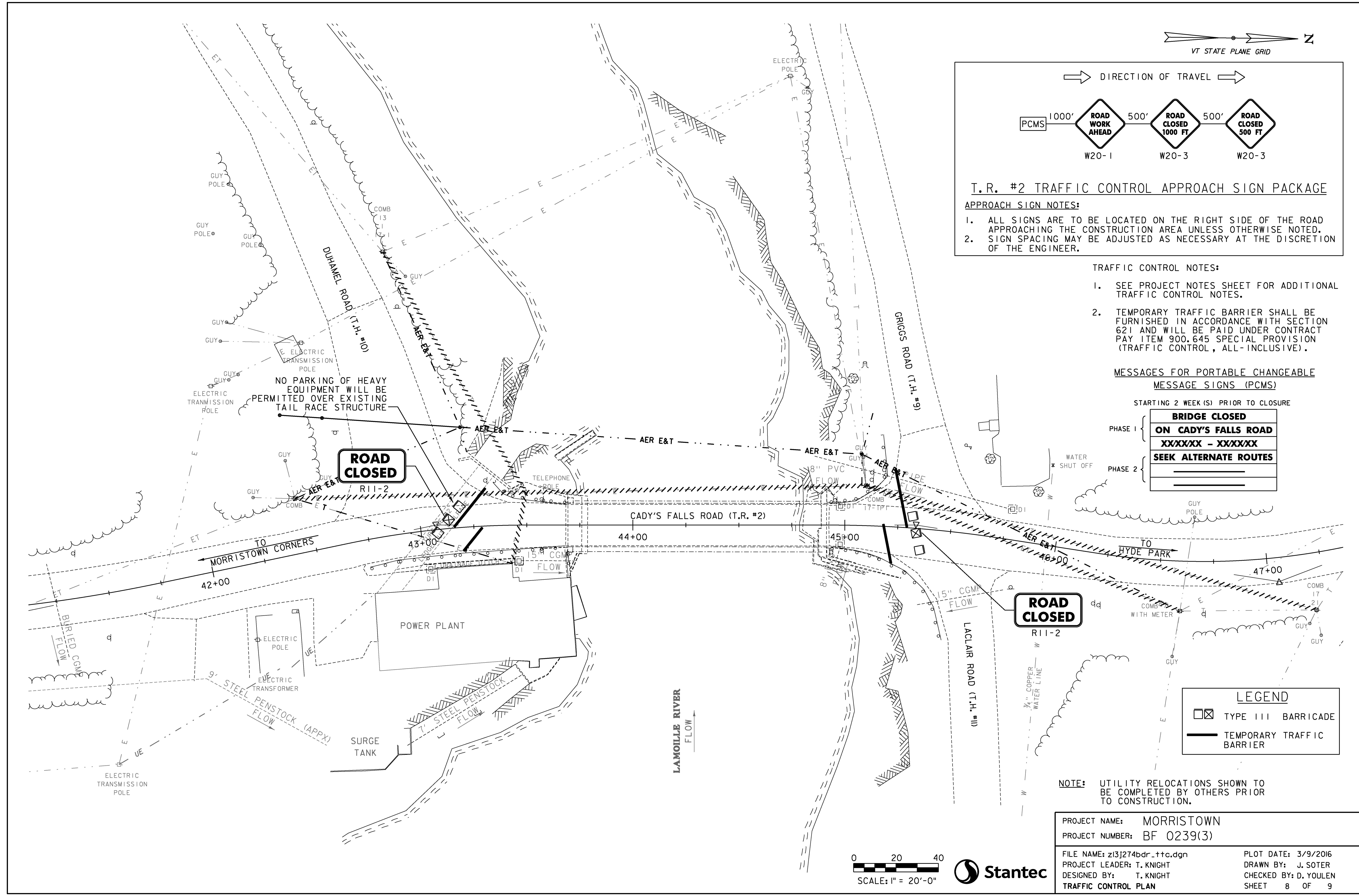

NO PARKING OF HEAVY EQUIPMENT WILL BE PERMITTED OVER EXISTING TAIL RACE STRUCTURE

**ROAD CLOSED**  
R11-2

**ROAD CLOSED**  
R11-2