

R. O. W. PLANS

INDEX OF SHEETS

- 1 TITLE
- 2 LEGEND
- 3 DETAIL
- 4 LAYOUT
- 5 PRELIMINARY INFORMATION SHEET
- 6-7 TYPICALS SECTIONS
- 8 TIE SHEET
- 9 MAINLINE PROFILE & BANKING DIAGRAM
- 10 UTILITY LAYOUT SHEET
- 11 EPSC PLAN

STATE OF VERMONT AGENCY OF TRANSPORTATION

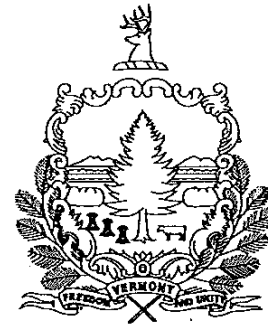

PROPOSED IMPROVEMENT BRIDGE PROJECT

TOWN OF STRAFFORD
COUNTY OF ORANGE

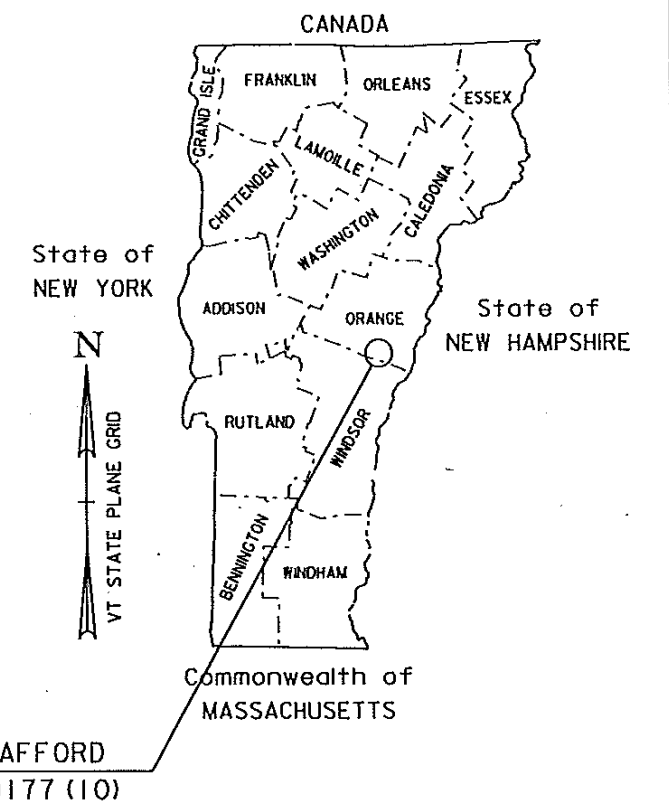
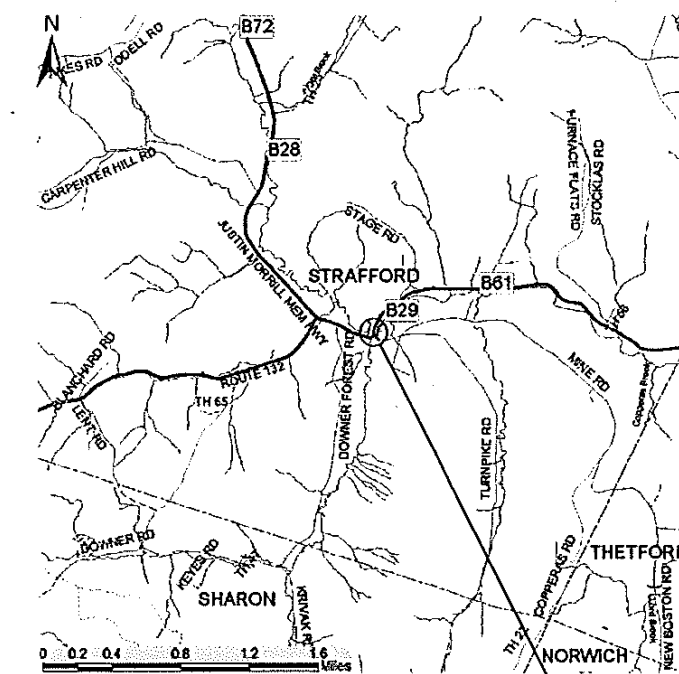

ROUTE NO : FAS 0177 (TH 1), RURAL MAJOR COLLECTOR, CLASS 2 TOWN HIGHWAY BRIDGE NO : 29

PROJECT LOCATION: APPROXIMATELY 0.04 MILES NORTH OF THE INTERSECTION OF TOWN HIGHWAY 1 (FAS 0177) AND TOWN HIGHWAY 4.

PROJECT DESCRIPTION: REMOVAL OF THE EXISTING STRUCTURE AND REPLACEMENT WITH A NEW STRUCTURE.

LENGTH OF STRUCTURE: 58.52 FEET
 LENGTH OF ROADWAY: 241.48 FEET
 LENGTH OF PROJECT: 300.00 FEET
 LENGTH OF ROW PROJECT: 420.91 FEET

BEGIN R.O.W. PROJECT
STRAFFORD BF 0177(10)
STA. 10+91.52, 24.75' LT

END R.O.W. PROJECT
STRAFFORD BF 0177(10)
STA. 15+12.43, 25.11' RT

CONSTRUCTION IS TO BE CARRIED ON IN ACCORDANCE WITH THESE PLANS AND THE STANDARD SPECIFICATIONS FOR CONSTRUCTION DATED 2011, AS APPROVED BY THE FEDERAL HIGHWAY ADMINISTRATION ON JULY 20, 2011 FOR USE ON THIS PROJECT, INCLUDING ALL SUBSEQUENT REVISIONS AND SUCH REVISED SPECIFICATIONS AND SPECIAL PROVISIONS AS ARE INCORPORATED IN THESE PLANS.

QUALITY ASSURANCE PROGRAM : LEVEL 2	
SURVEYED BY :	R. GILMAN
SURVEYED DATE :	04/18/2013
DATUM	
VERTICAL	NAVD88
HORIZONTAL	NAD 83 (2011)

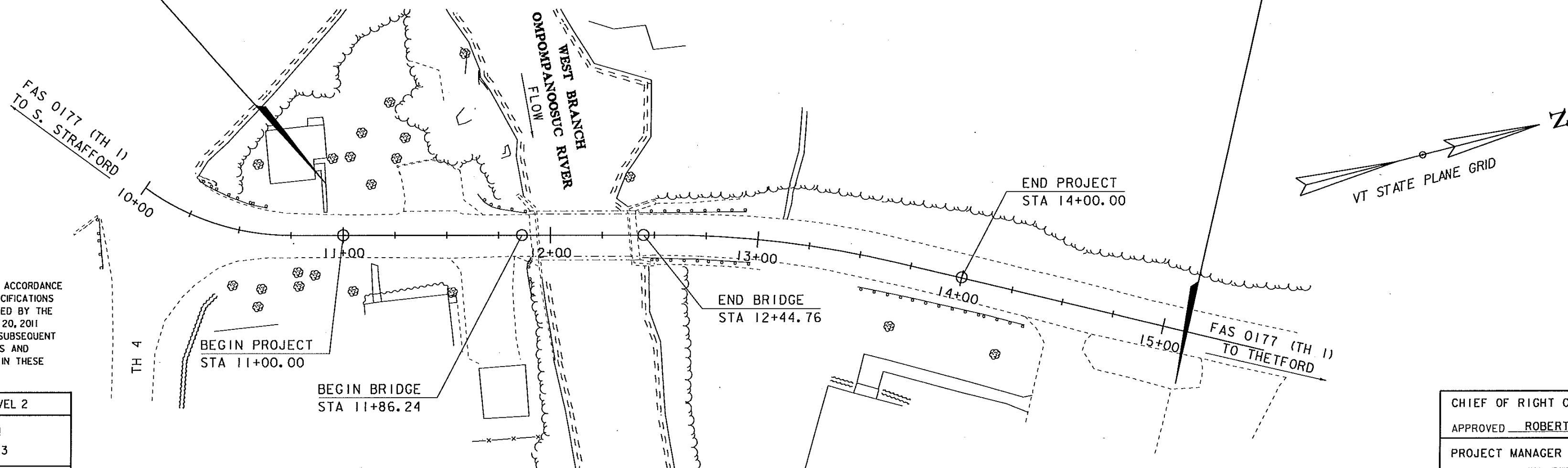

SCALE 1" = 30' - 0"
 30 0 30

ALL DRIVES AS INDICATED ON PLANS ARE SUBJECT TO PERMITS PURSUANT TO TITLE 19 V.S.A. § 1111.

CHIEF OF RIGHT OF WAY	
APPROVED	ROBERT M. WHITE DATE 09-10-15
PROJECT MANAGER : KRISTIN HIGGINS, P.E.	
PROJECT NAME :	STRAFFORD
PROJECT NUMBER :	BF 0177 (10)
SHEET 1 OF 11 SHEETS	