

**MAIN ROAD (TH 1) PROFILE**  
 SCALE 1" = 20' HORIZONTAL  
 1" = 10' VERTICAL

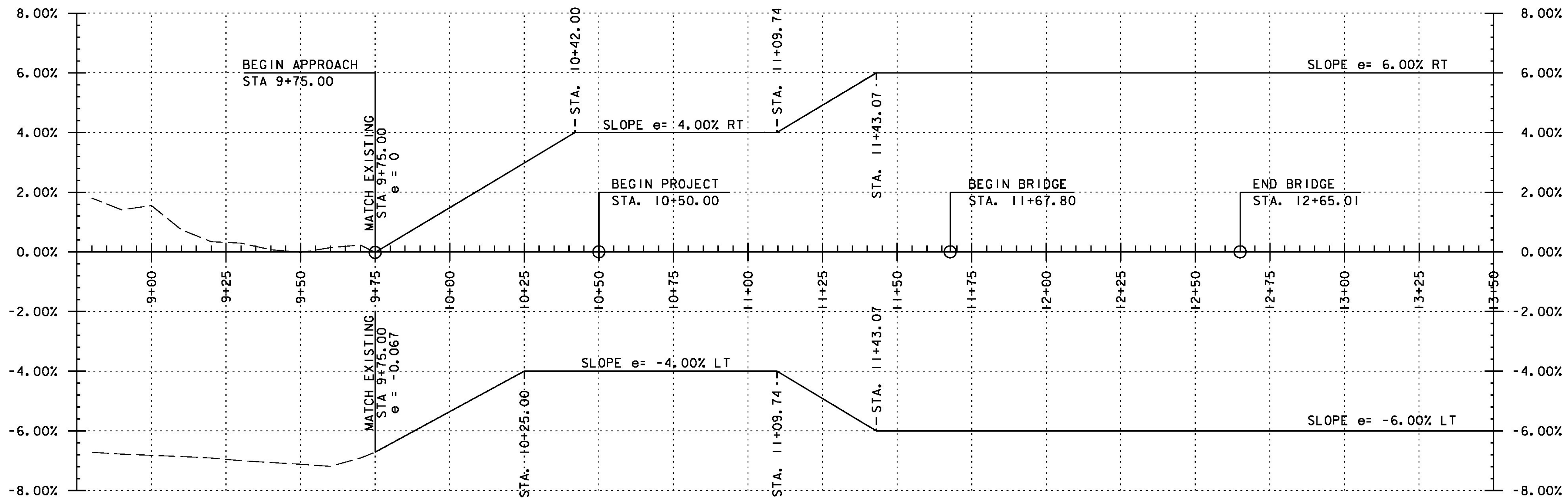

**BANKING DIAGRAM**  
 SCALE HORIZONTAL: 1" = 20'  
 VERTICAL: 1" = 0.02 FT/FT

THE GRADES SHOWN TO THE NEAREST TENTH ARE THE ORIGINAL GROUND ELEVATIONS ALONG THE PROPOSED ALIGNMENT.  
  
 THE GRADES SHOWN TO THE NEAREST HUNDREDTH ARE THE FINISH GRADES ALONG THE PROPOSED ALIGNMENT.

PROJECT NAME:	HUNTINGTON	FILE NAME:	z13j080pro.dgn	PLOT DATE:	8/15/2016
PROJECT NUMBER:	BF 0211(32)	PROJECT LEADER:	S.E. BURBANK	DRAWN BY:	D.M. PECK
		DESIGNED BY:	D.M. PECK	CHECKED BY:	E.F. LAWES
		PROFILE & BANKING DIAGRAM (1 OF 2)		SHEET	15 OF 62

