

REMOVE FENCE
 STA. 11+73 - 12+02, LT
CONSTRUCT DRIVE WITH
13' PAVED APRON
 STA. 10+13 - 10+74, LT
LIMITS OF COLD PLANING
 STA. 9+75 - 10+25, LT & RT
 STA. 14+75 - 15+25, LT & RT

SPECIAL PROVISION
(RETAINING WALL)
 STA. 12+76 - 12+98, LT
REMOVAL AND DISPOSAL
OF GUARDRAIL
 STA. 11+09 - 11+96, LT
 STA. 11+41 - 11+75, RT
 STA. 12+38 - 12+62, RT
 STA. 12+60 - 13+71, LT

MANUFACTURED TERMINAL
SECTION, TANGENT
 STA. 10+81 - 10+95, RT
 STA. 10+89 - 11+03, LT
 STA. 13+28 - 13+42, RT
 STA. 14+00 - 14+14, LT
BOX BEAM GUARDRAIL
 STA. 10+95 - 11+31, RT
 STA. 11+03 - 11+39, LT
 STA. 12+92 - 13+28, RT
 STA. 13+03 - 14+00, LT
STONE FILL, TYPE I
 STA. 11+51 - 11+86, RT
 STA. 11+60 - 12+07, LT
 STA. 12+34 - 12+75, RT
 STA. 12+78 - 13+75, LT

GUARDRAIL APPROACH SECTION,
GALVANIZED 3 RAIL BOX BEAM
 STA. 11+31 - 11+63, RT
 STA. 11+39 - 11+71, LT
 STA. 12+60 - 12+92, RT
 STA. 12+71 - 13+03, LT
BRIDGE RAILING,
GALVANIZED 3 RAIL BOX BEAM
 STA. 11+63 - 12+60, RT
 STA. 11+71 - 12+71, LT

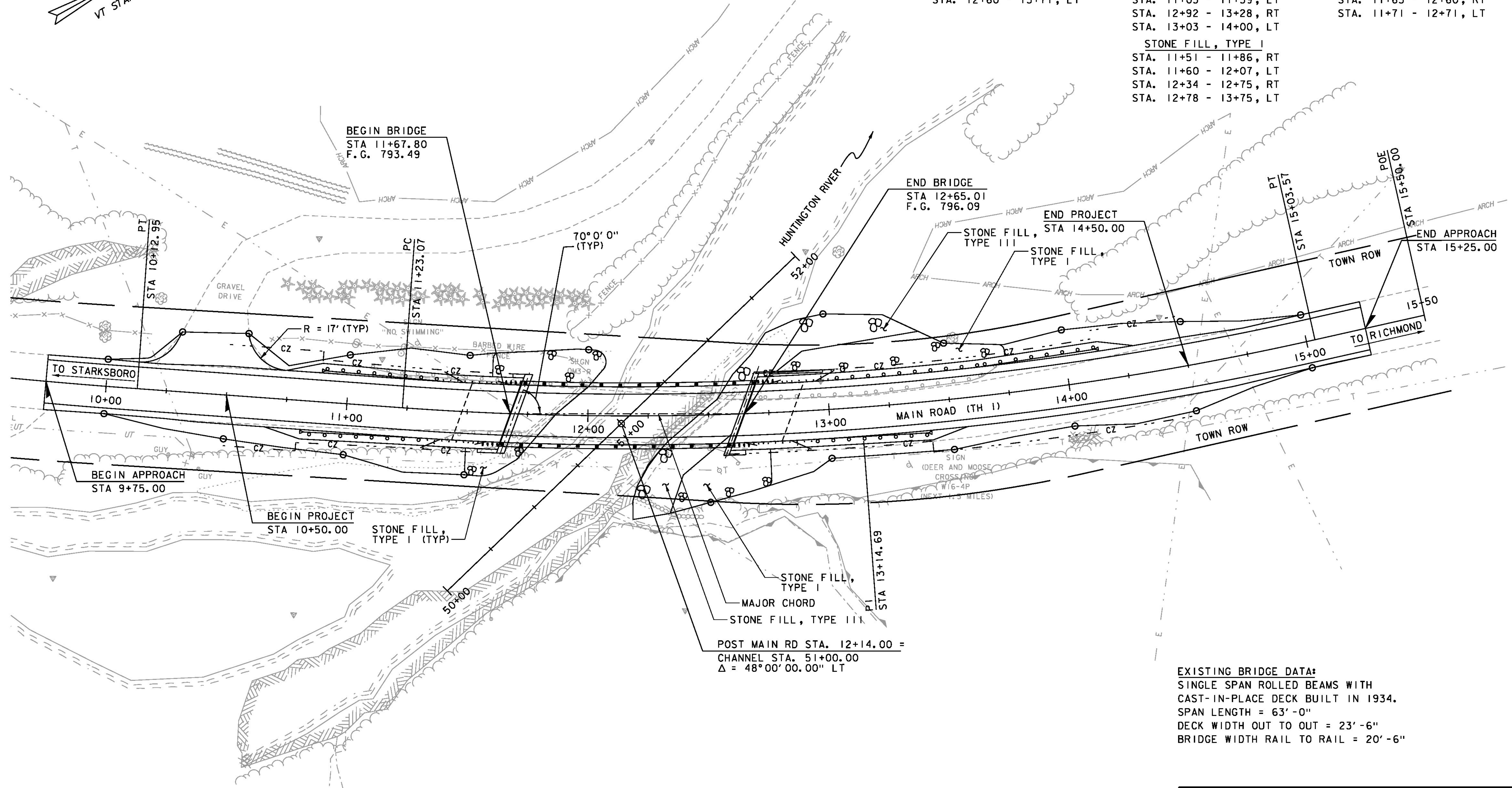

LAYOUT
 SCALE 1" = 20'-0"
 20 0 20

EXISTING BRIDGE DATA:
 SINGLE SPAN ROLLED BEAMS WITH
 CAST-IN-PLACE DECK BUILT IN 1934.
 SPAN LENGTH = 63'-0"
 DECK WIDTH OUT TO OUT = 23'-6"
 BRIDGE WIDTH RAIL TO RAIL = 20'-6"

PROJECT NAME:	HUNTINGTON	PLOT DATE:	8/15/2016
PROJECT NUMBER:	BF 0211(32)	DRAWN BY:	J.D. KEENER
FILE NAME:	z13J080bdr_nul.dgn	CHECKED BY:	S.E. BURBANK
PROJECT LEADER:	S.E. BURBANK	LAYOUT SHEET	SHEET 14 OF 62
DESIGNED BY:	J.D. KEENER		

