

ITEM 900.645 RECONSTRUCT RAIL-HIGHWAY CROSSING (AARDOT#85I-364Y)
 ASPHALT AND RUBBER GRADE CROSSING SURFACE
 STA 4886+20.06 - STA 4886+48.58
 TRACK SURFACING RAISE TO 2.5" SUPERELEVATION
 STA 4885+75 - STA 4887+00
 TRANSITION FROM EXISTING (1.5") SUPERELEVATION TO 2.5" SUPERELEVATION
 STA 4885+10 - STA 4885+75
 TRANSITION FROM 2.5" TO 1.5" SUPERELEVATION
 STA 4887+00 - STA 4887+65
 78' - 115# GRADE CROSSING TRACK PANEL
 CONTINUOUS RAIL THROUGH CROSSING
 STA 4885+95 - STA 4886+73
 6" GALVANIZED STEEL UNDERDRAIN
 STA 4885+92 - STA 4886+82 LT
 4" GALVANIZED STEEL CONDUIT
 STA 4886+23 - STA 4886+45 LT
 STA 4886+23 - STA 4886+45 RT

ITEM 900.645 RAIL-HIGHWAY ACTIVE WARNING SYSTEM
 FLASHERS AND GATES
 STA 3+25 AND STA 3+56
 OFFSET FROM RAIL CL: 19.5 LF
 SIGNAL CABINET
 STA 4886+89 - STA 4887+01
 OFFSET FROM RAIL CL: 12 LF

CAMPGROUND ROAD DOT CROSSING NUMBER 85I364Y

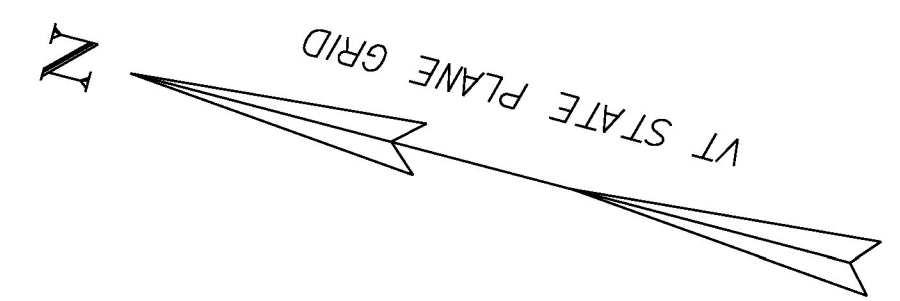

RR CURVE (1)
 DELTA = 12° 49' 58"
 D = 2° 01' 18"
 R = 2834.05'
 T = 318.71'
 L = 634.76'
 E = 17.86'

LIMITS OF CROSSING
 3+27
 3+55

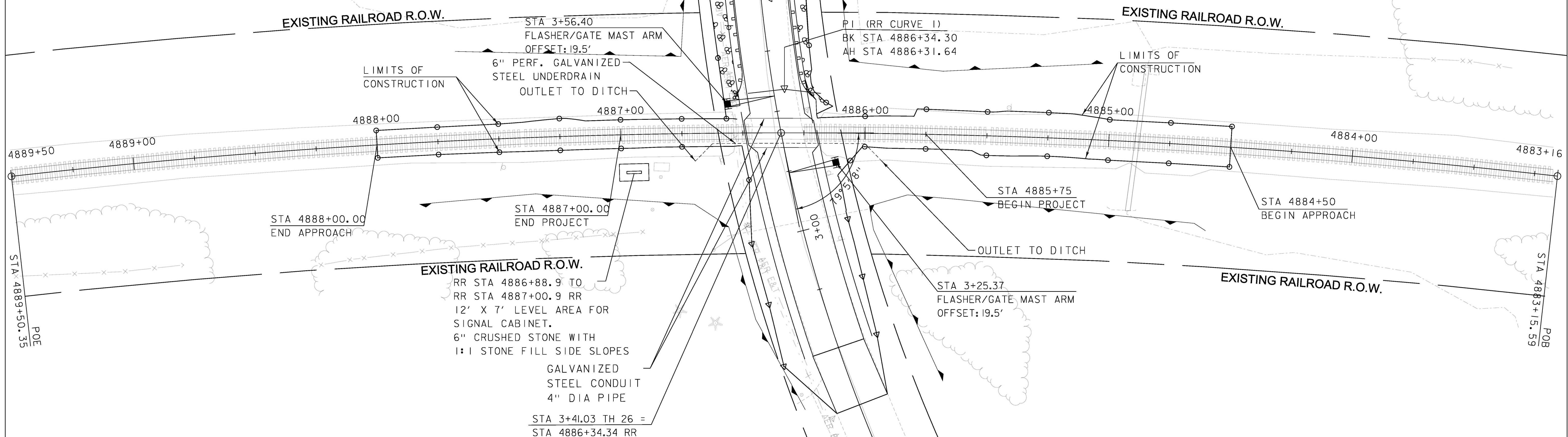

US DOT NO. 85I364Y

NOTES:

1. FOR LIMITS OF TYPES OF RAILROAD RECONSTRUCTION, SEE RAILROAD TYPICAL SECTIONS SHEET 6.
2. FOR RAILROAD PROFILE SEE SHEET 15.
3. FOR RAILROAD GEOMETRY DATA SEE SHEET 12.
4. CONTRACTOR SHALL VERIFY THAT POST FOR FLASHER AND GATES IS 12' MIN. FROM CENTERLINE OF TRACK.
5. CONTRACTOR SHALL VERIFY THAT CROSSING GATES WHEN LOWERED ARE MINIMUM OF 12' FROM CENTERLINE OF TRACK.
6. CONTRACTOR TO PROTECT EXISTING BURIED COMMUNICATIONS CABLE IN PLACE.
7. LOCATION OF POWER SUPPLY CONDUITS AND SIGNAL CONDUITS TO BE DETERMINED IN FIELD. SEPARATE PAYMENT WILL NOT BE MADE FOR THIS WORK, BUT SHALL BE INCIDENTAL TO ITEM 900.645 SPECIAL PROVISION (RAIL-HIGHWAY CROSSING ACTIVE WARNING SYSTEM) (AARDOT 85I-364Y).
8. POWER SERVICE FOR SIGNAL CABINET SHALL BE CONSTRUCTED WITHIN EXISTING R.O.W. AND OUTSIDE ANY KNOWN WETLAND LIMITS.

SCALE 1" = 20'-0"
 20 0 20



PROJECT NAME: NEW HAVEN	PLOT DATE: 2/15/2017
PROJECT NUMBER: STP 2035 (19)	DRAWN BY: W. TSE
FILE NAME: z13g606bdr.dgn	CHECKED BY: R. O'BLENIS
DESIGNED BY: W. TSE	SHEET 14 OF 42
RAILROAD LAYOUT SHEET	