

GPS/NGS CONTROL POINTS

MIDDLEBURY CORS ARP

PID DL2744
 N = 546895.22
 E = 1468689.98
 ELLIP HEIGHT = 315.05

STATION IS A GPS CONTINUOUSLY OPERATING REFERENCE STATION. STATION IS THE ANTENNA REFERENCE POINT OF THE GPS ANTENNA. LOCATED AT THE MIDDLEBURY MIDDLE SCHOOL IN MIDDLEBURY, VERMONT. THE MONUMENT IS ATTACHED TO A 3 STORY CONCRETE/BRICK BUILDING WITH A 10 FT CONCRETE FOUNDATION BUILT IN 1996. MAST IS A TWO INCH DIA GALV PIPE THAT IS 120 INCHES LONG AND HAS A SMALL CIRCULAR LEVELING DEVICE WELDED TO THE TOP. THE MAST IS WELDED TO 3 OUTRIGGERS AND MOUNTING PLATES ARE WELDED TO THE END OF EACH OUTRIGGER. EACH MOUNTING PLATE CONTAINS 4 ATTACHMENT POINTS CONSISTING OF 1/2 INCH DIA HOLES. ATTACHMENTS ARE EITHER MADE BY THROUGH BOLTING WITH WITH 1/2 INCH STAINLESS STEEL ROD, WASHERS, AND NUTS OR 1/2 INCH STAINLESS STEEL LAGS WITH LEAD ANCHORS. THE TOP PLATE IS SECURED WITH ONE THROUGH BOLT AND 3 ANCHORS. THE MIDDLE PLATE IS SECURED WITH 2 THROUGH BOLTS AND 2 ANCHORS. THE BOTTOM PLATE IS SECURED WITH 2 THROUGH BOLTS AND 2 ANCHORS.

V 17

PID PG0794
 N = 577646.02
 E = 1461042.84
 ELEV. = 326.96

RECOVERY NOTE BY VERMONT GEODETIC SURVEY 1996 (CHR). GENERAL LOCATION, NEW HAVEN, VT. TO REACH FROM THE INTERSECTION OF U.S. ROUTE 7 AND VT ROUTE 17 EAST IN NEW HAVEN JUNCTION GO SOUTH ALONG U.S. ROUTE 7 FOR 2.5 MI (4.0 KM) TO THE INTERSECTION OF CAMPGROUND ROAD RIGHT. TURN RIGHT AND GO WEST ALONG CAMPGROUND ROAD FOR 0.3 MI (0.5 KM) TO THE INTERSECTION OF THE VERMONT RAILWAY. PARK VEHICLE AND WALK SOUTH ALONG THE RAILROAD FOR ABOUT 143 M (469.2 FT) TO THE SITE OF THE MARK ON THE RIGHT. THE MARK IS SET IN THE TOP OF A 15 CM SQUARE CONCRETE MONUMENT WHICH PROJECTS ABOUT 0.2 M (0.7 FT) ABOVE GROUND SURFACE. IT IS 142.6 M (467.8 FT) SOUTH OF THE INTERSECTION OF CAMPGROUND ROAD, 7.7 M (25.3 FT) WEST OF THE WEST RAIL, 3.8 M (12.5 FT) EAST OF THE RIGHT OF WAY FENCE, AND 0.3 M (1.0 FT) SOUTHEAST OF A METAL WITNESS POST.

TRAVERSE TIES

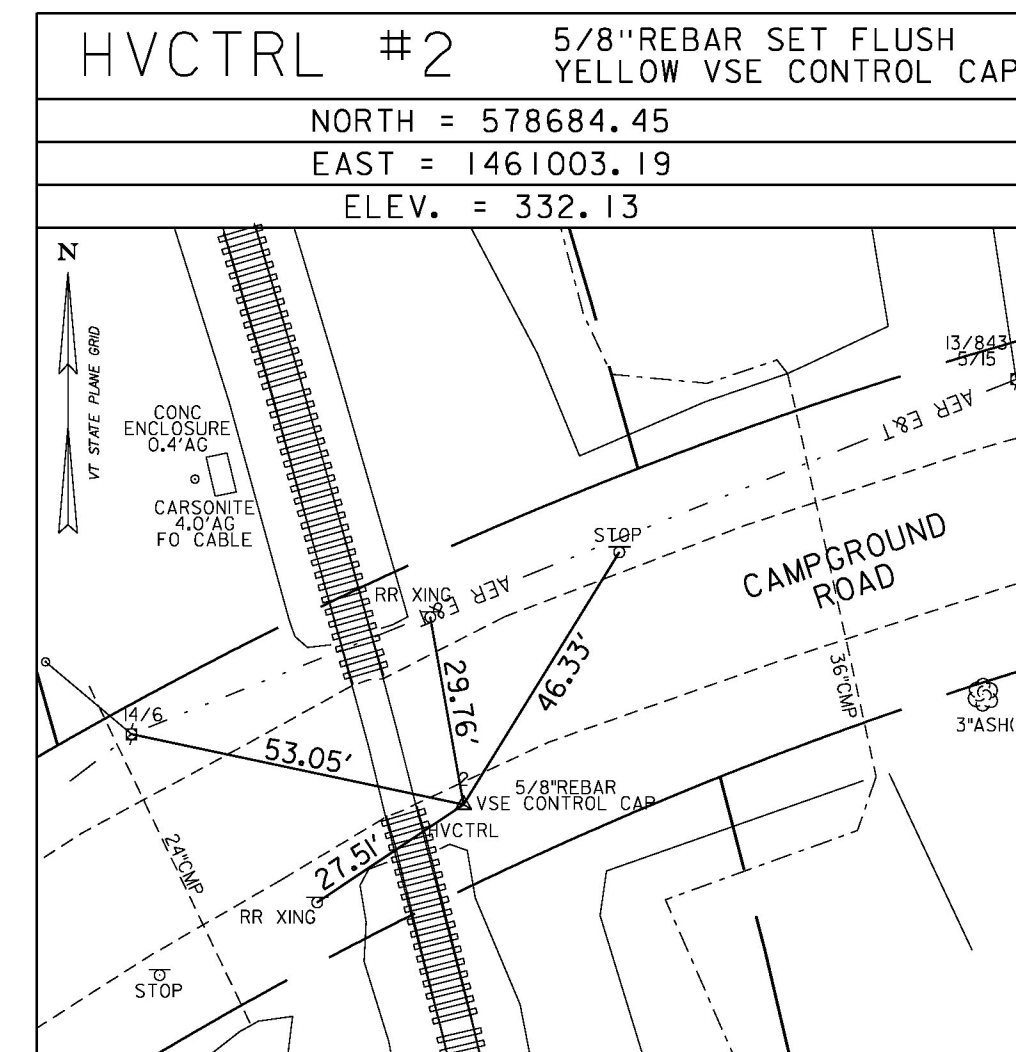
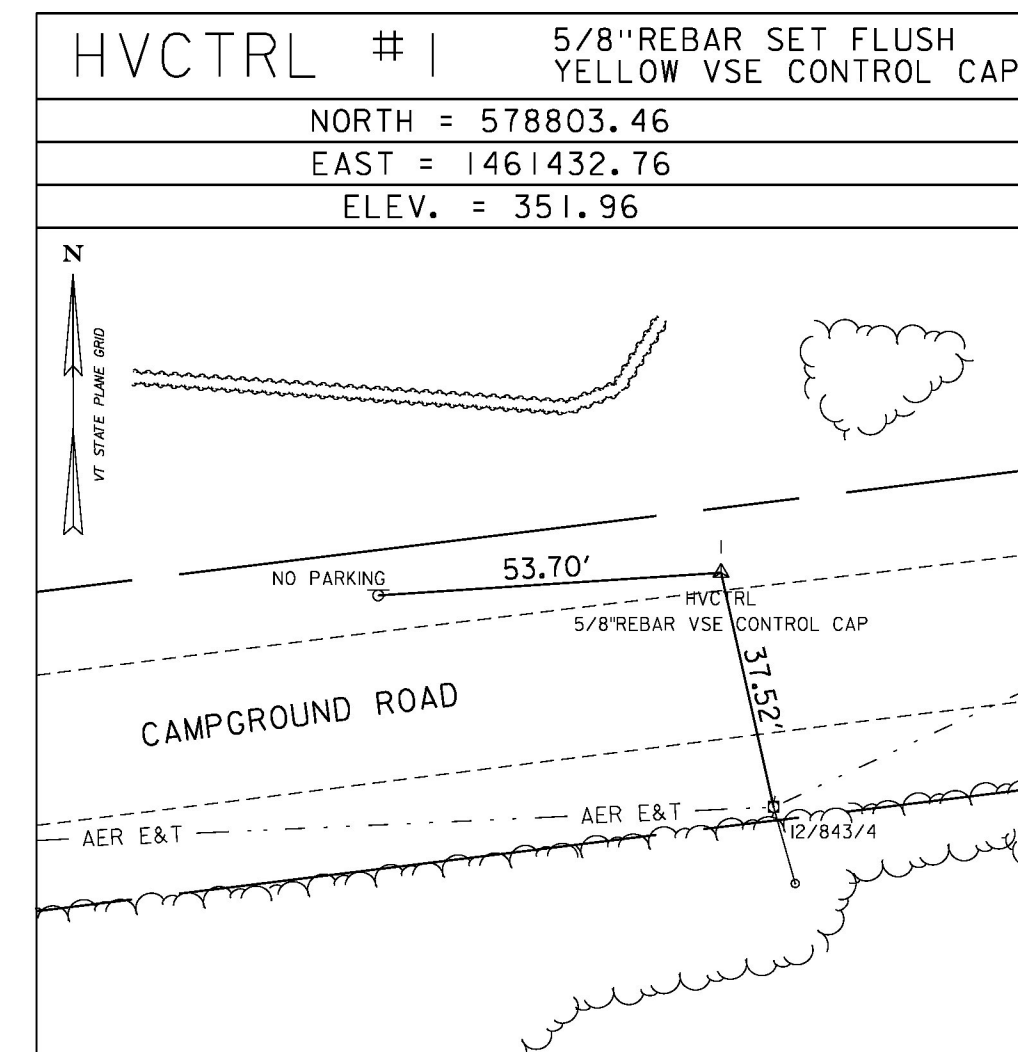

* SURVEY COMPLETED: FEBRUARY 8, 2016 BY VSE, R. GAUVIN-PC, T. YEFCHAK

ALIGNMENT TIES

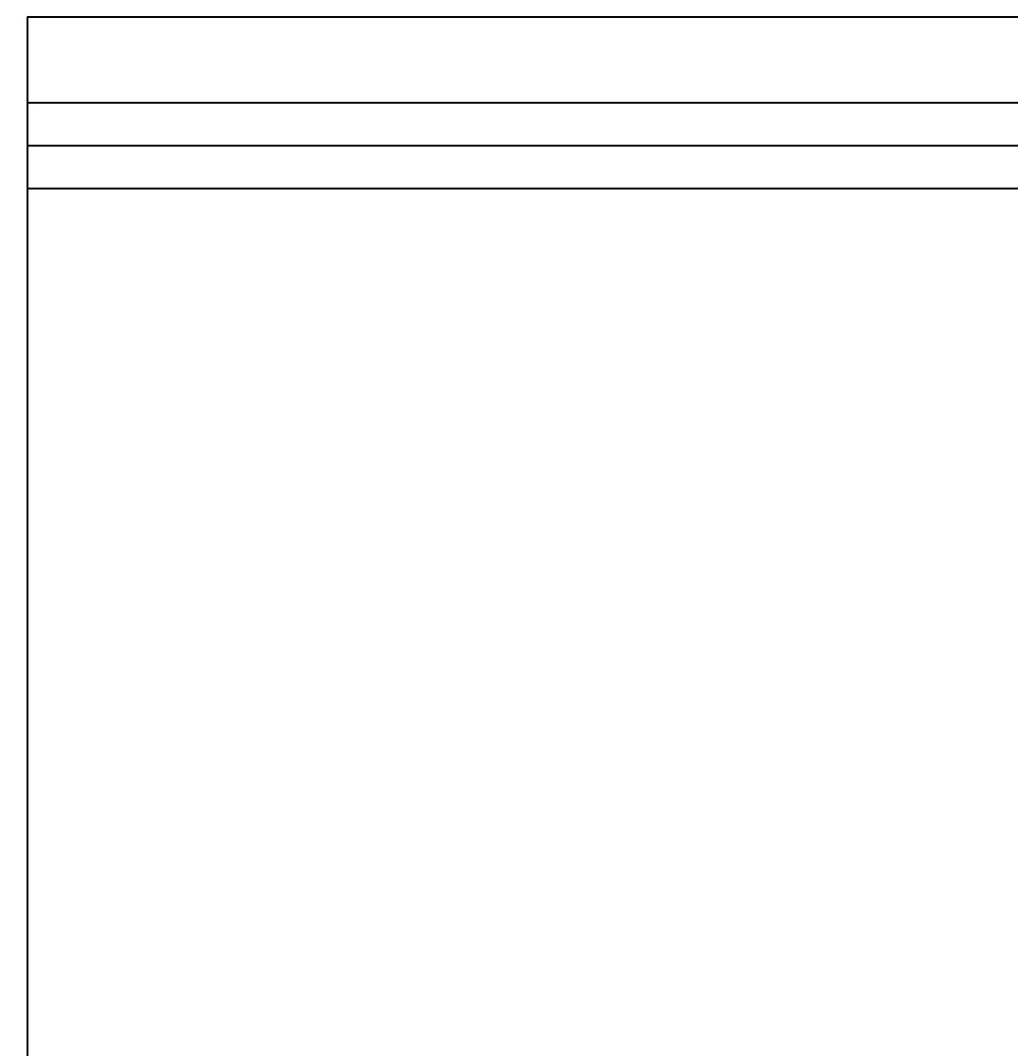
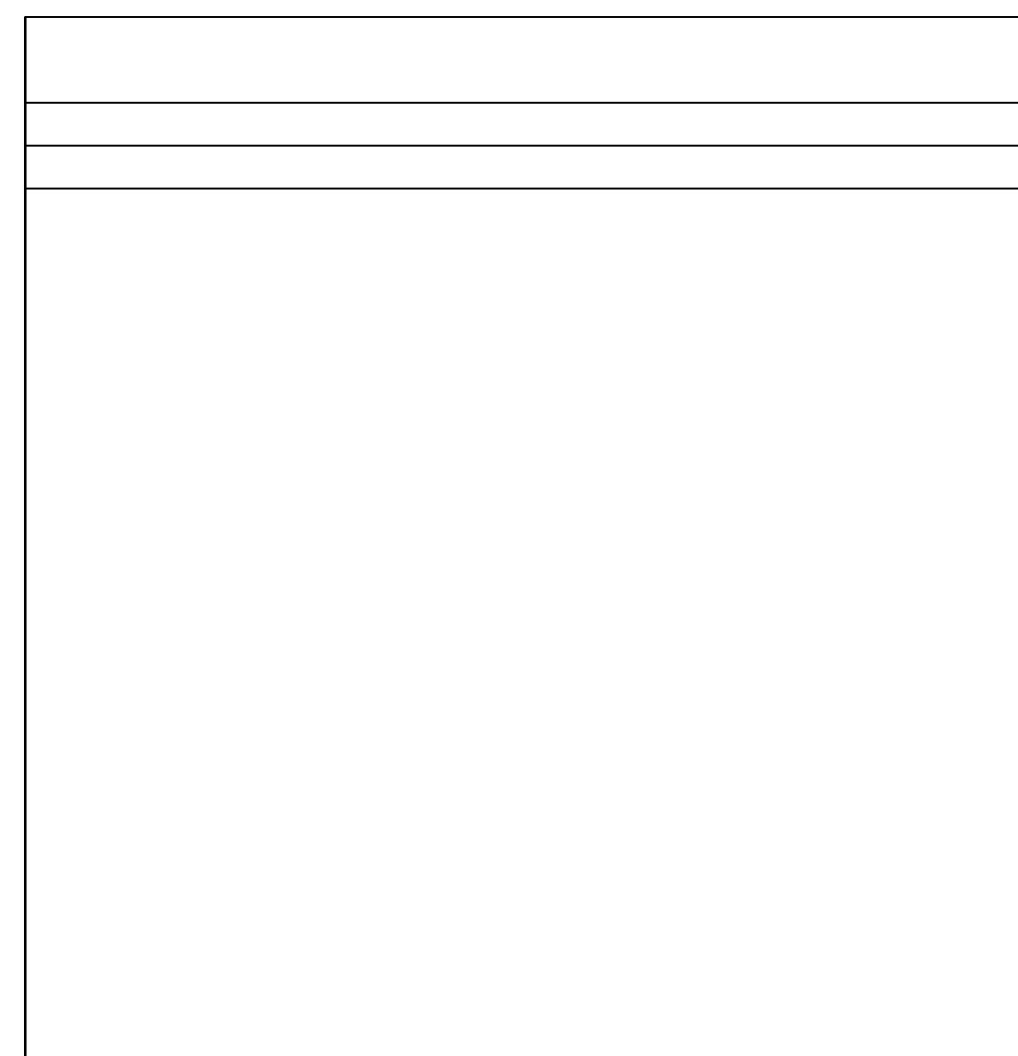

DATUM
 VERTICAL NAVD 88 FT
 HORIZONTAL NAD 83 (2011) sFT
 ADJUSTMENT N/A



PROJECT NAME: NEW HAVEN
 PROJECT NUMBER: STP 2035 (19)

FILE NAME: z13g606+1.dgn
 PROJECT LEADER: R. O'BLENIS
 DESIGNED BY: W. TSE
 SURVEY TIE SHEET

PLOT DATE: 2/15/2017
 DRAWN BY: W. TSE
 CHECKED BY: R. O'BLENIS
 SHEET 7 OF 42