

ENOSBURG

END PROJECT

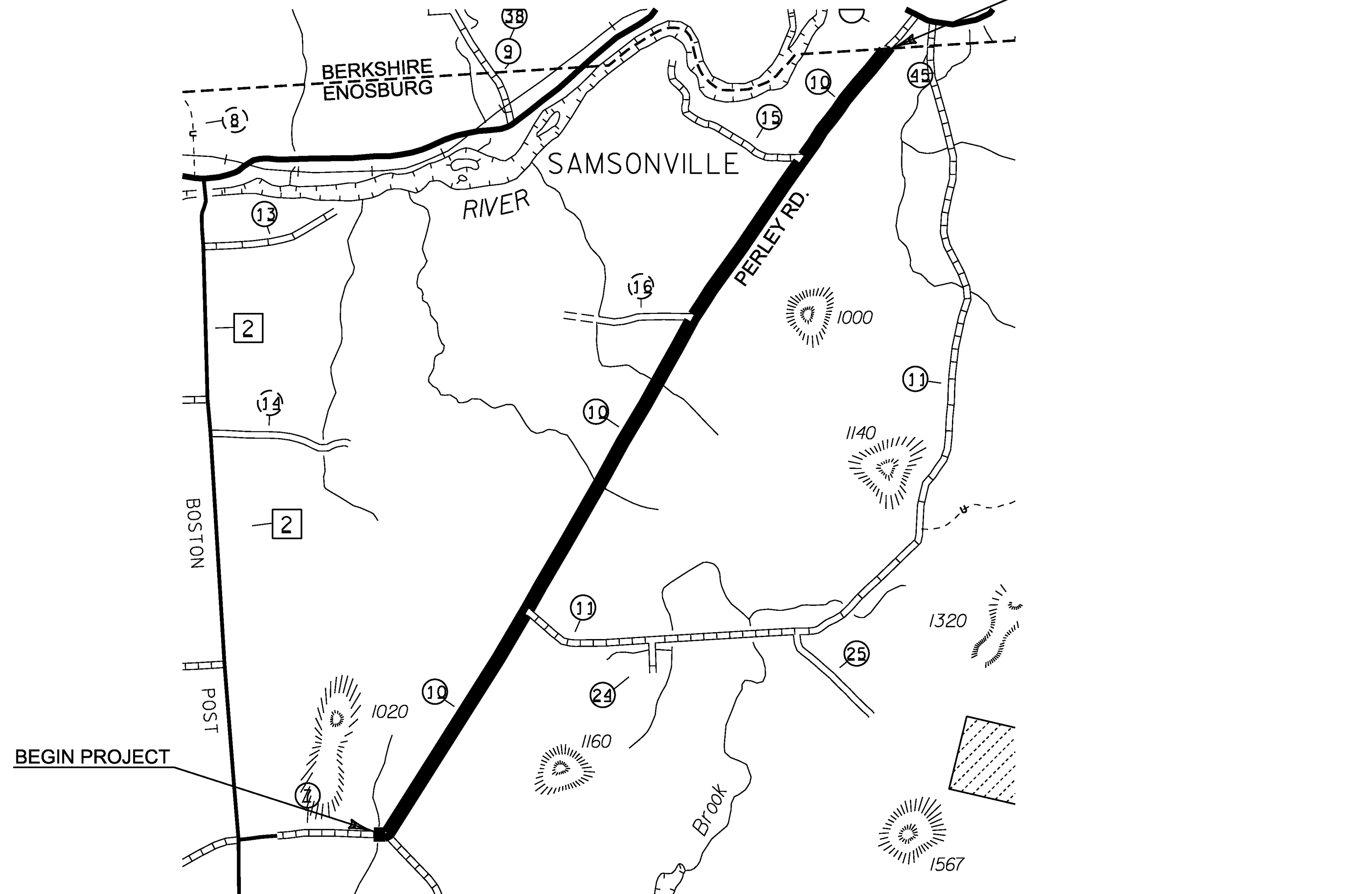

WORK TO BEGIN AT A POINT 0.045 MILES WEST OF PERLEY ROAD (TH-1) ALONG NICHOLS ROAD (TH-22) IN THE TOWN OF ENOSBURG, DESIGNATING THIS LOCATION ADJACENT TO POLE # 18/139 AS MILE MARKER 0.000 AND EXTENDING NORTHERLY ALONG PERLEY ROAD (TH-1) FOR A DISTANCE OF 3.595 MILES TO THE ENOSBURG--BERKSHIRE TOWNLINE TO CONCLUDE THIS SEGMENT OF THIS PROJECT.

SHELDON / HIGHGATE / FRANKLIN

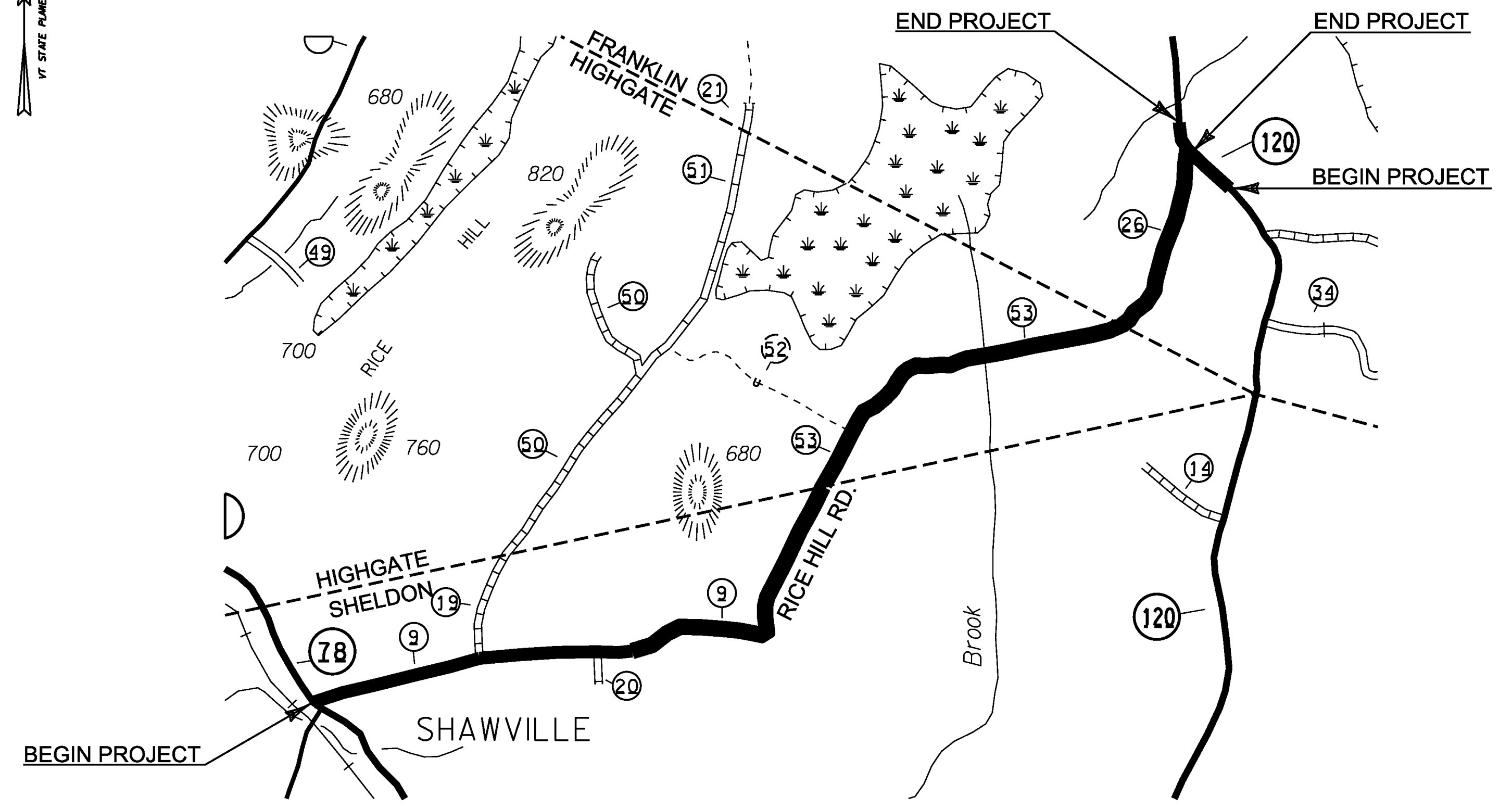

BEGINNING AT THE INTERSECTION OF VT ROUTE 78 AND RICE HILL ROAD (TH-9) IN THE TOWN OF SHELDON, DESIGNATING WHERE THE CENTERLINE OF EACH OF THESE ROADS INTERSECTS EACH OTHER AS MILE MARKER 0.000 AND EXTENDING EASTERLY ALONG RICE HILL ROAD (TH-9) FOR A DISTANCE OF 3.986 MILES TO THE INTERSECTION OF RICE HILL ROAD (TH-9) AND VT ROUTE 120 IN THE TOWN OF FRANKLIN TO CONCLUDE THIS SEGMENT OF THIS PROJECT.

WALTHAM / FERRISBURGH / NEW HAVEN / BRISTOL

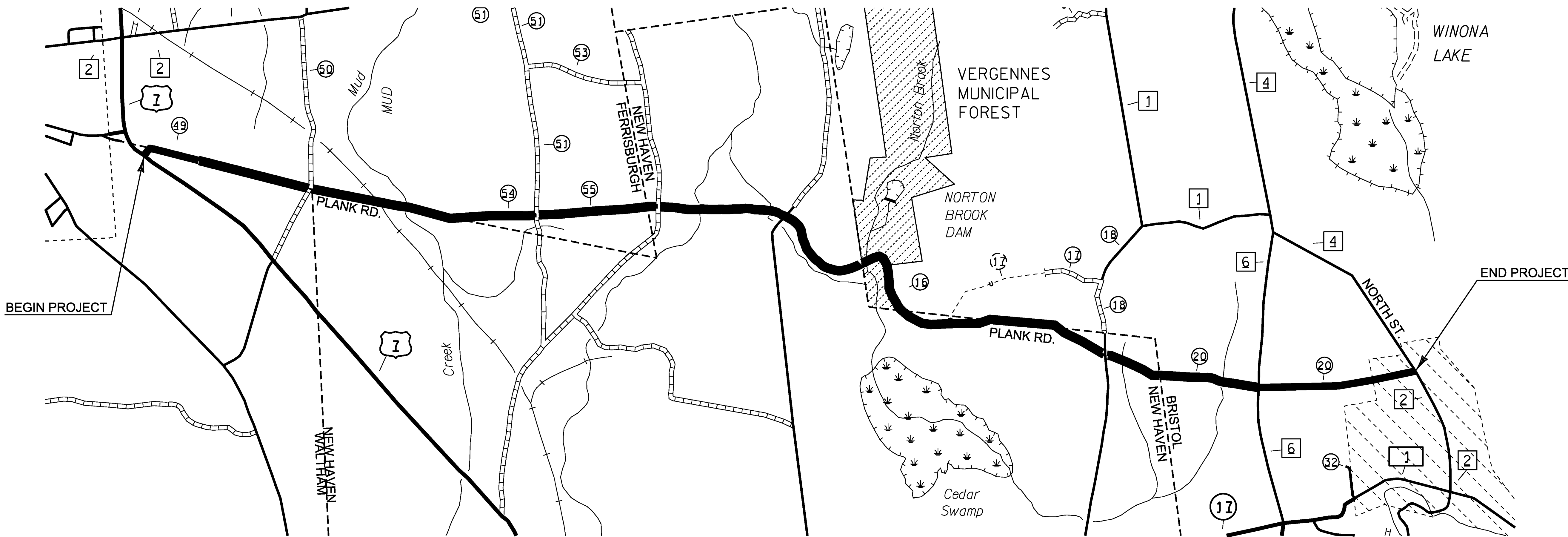

BEGINNING AT THE INTERSECTION OF US ROUTE 7 AND PLANK ROAD (TH-3) IN THE TOWN OF WALTHAM, DESIGNATING WHERE THE CENTERLINE OF EACH OF THESE ROADS INTERSECTS EACH OTHER AS MILE MARKER 0.000 AND EXTENDING EASTERLY ALONG PLANK ROAD (TH-3) FOR A DISTANCE OF 8.187 MILES TO THE INTERSECTION OF NORTH STREET (TH-4), IN THE TOWN OF BRISTOL, TO CONCLUDE THIS SEGMENT OF THIS PROJECT.

PROJECT NAME: STATEWIDE NORTHWEST REGION
PROJECT NUMBER: STP HRRR(13)

FILE NAME: I2K020wrk.dgn
PROJECT LEADER: JLS
DESIGNED BY: NLA
LOCATIONS MAPS SHEET 3

PLOT DATE: 16-JUL-2012
DRAWN BY: TDS
CHECKED BY: NLA
SHEET II OF 107

NOT TO SCALE