

1 NON-MARK FACE ELEVATION
 AB2.1 3/8" = 1'-0"

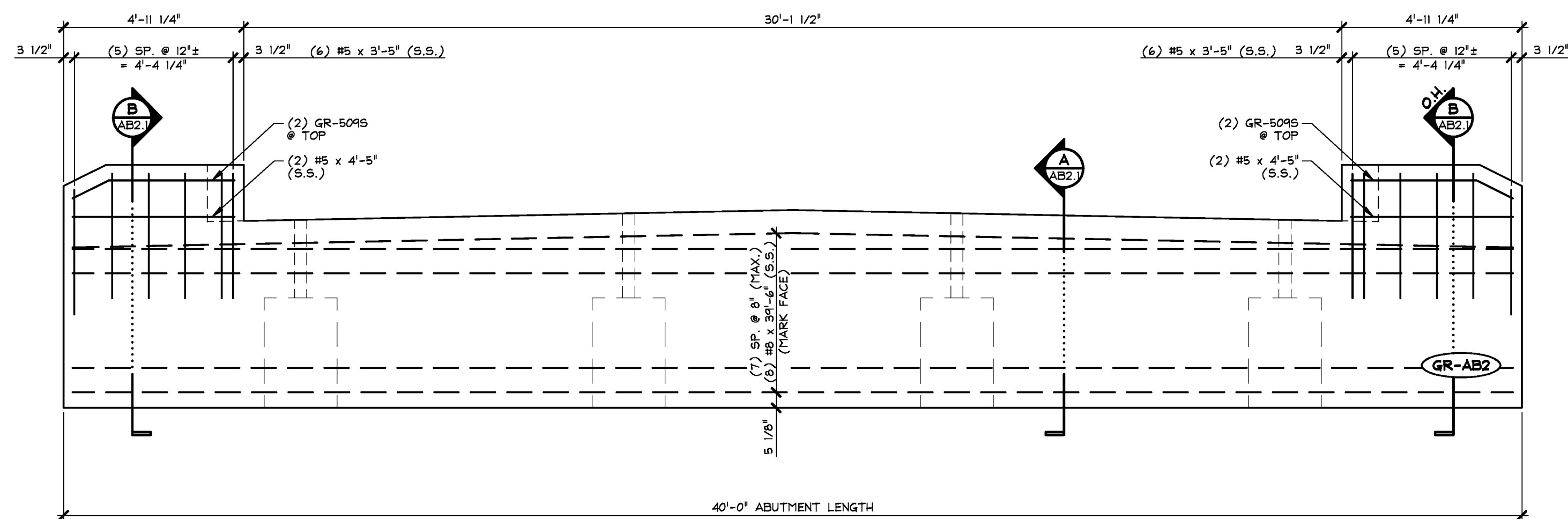

2 MARK FACE ELEVATION
 AB2.1 SEE NON-MARK ELEVATION FOR REINFORCING NOT SHOWN 3/8" = 1'-0"

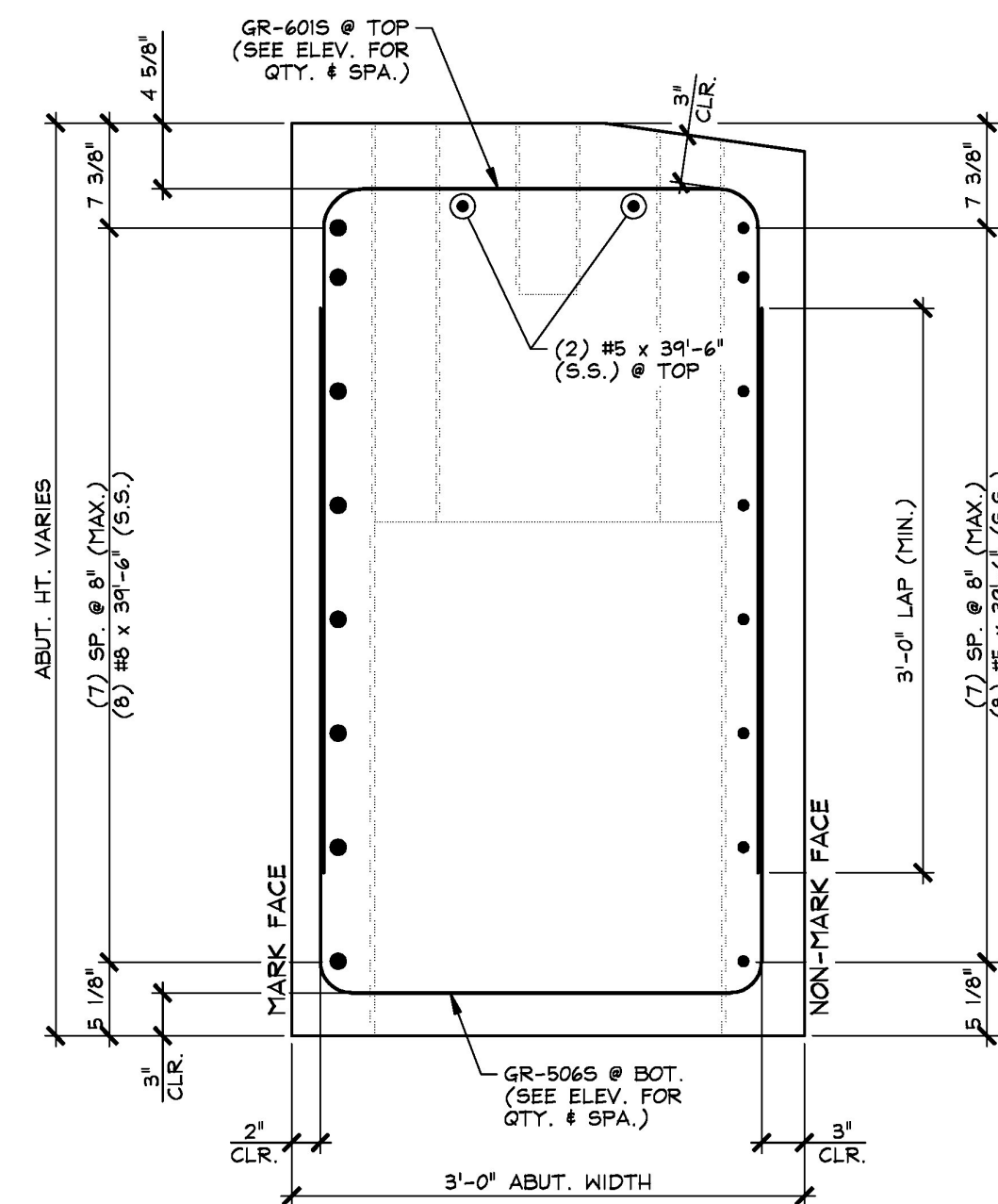

A SECTION
 AB2.1 1" = 1'-0"

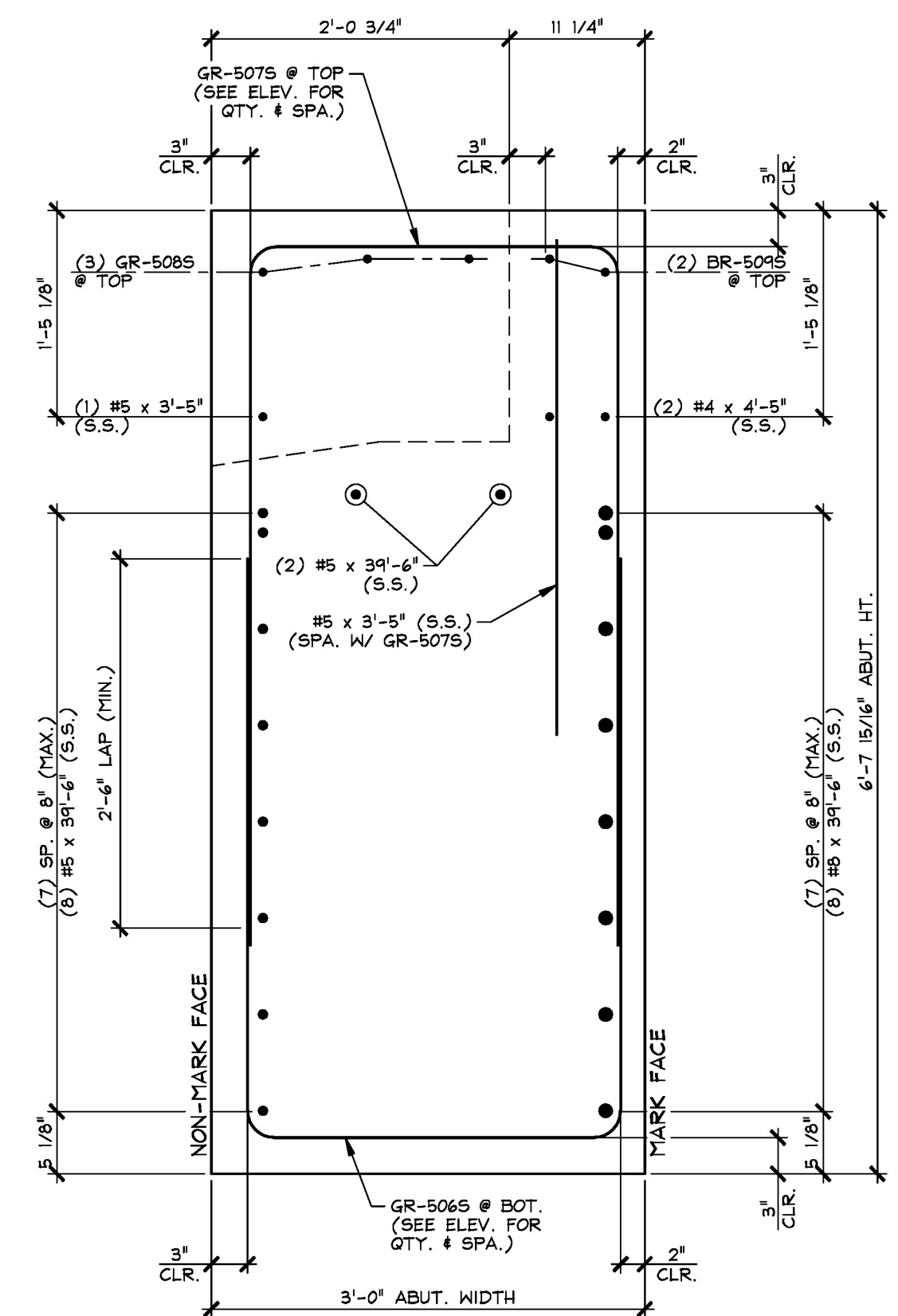

B SECTION
 AB2.1 1" = 1'-0"

SHOP NOTE:
 SEE DIMENSIONAL DETAILS FOR REQUIRED #5 PROJECTING BARS.

MARK: GR-AB2 QTY.: 1			
MATERIAL LIST / ABUTMENT			
ITEM	MARK	DESCRIPTION	QTY.
1	GR-5065	#5 BENT BAR (STAINLESS STEEL)	36
2	GR-5075	#5 BENT BAR (STAINLESS STEEL)	10
3	GR-5085	#5 BENT BAR (STAINLESS STEEL)	6
4	GR-5095	#5 BENT BAR (STAINLESS STEEL)	4
5		#5 x 3'-6" (STAINLESS STEEL)	10
6		#5 x 3'-5" (STAINLESS STEEL)	14
7		#5 x 4'-5" (STAINLESS STEEL)	4
8			
9			
10	GR-6015	#6 BENT BAR (STAINLESS STEEL)	65
11			
12		#5 x 3'-6" (STAINLESS STEEL)	8
13			
14			
15			

T.Y. LIN INTERNATIONAL
 THE STAMPED DOCUMENTS ARE HEREBY:
 _____ APPROVED
 _____ APPROVED AS NOTED
 _____ REVISE AND RESUBMIT
 SEE TRANSMITTAL FOR ADDITIONAL INFORMATION AS APPLICABLE.
 THIS REVIEW IS FOR GENERAL CONFORMANCE WITH DESIGN CONCEPT ONLY. ANY DEVIATION FROM THE PLANS OR SPECIFICATIONS NOT CLEARLY NOTED BY THE CONTRACTOR HAS NOT BEEN REVIEWED. REVIEW BY THE ENGINEER SHALL NOT RELIEVE THE CONTRACTOR OF THE CONTRACTUAL RESPONSIBILITY FOR ANY ERRORS OR DEVIATION FROM THE CONTRACT REQUIREMENTS.
 JOSH OLUND January 25, 2017
 REVIEWER DATE

APPROVAL STAMP:	J.P. CARRARA & SONS INC. Precast & Prestress Manufacturer 244 GAGE ST., MIDDLEBURY, VERMONT 05750 Phone: (802)388-6361 Fax: (802)388-9010	J.P. SICARD, INC. CONTRACTOR BARTON, VERMONT
	STATE OF VERMONT AGENCY OF TRANSPORTATION COUNTY OF ORLEANS	
	VILLAGE OF BARTON TH 2 (GLOVER ROAD), RURAL MAJOR COLLECTOR BRIDGE NO.: 20 PROJECT NO.: BHF 0286(5)	
PRECAST ABUTMENT REINFORCING DETAILS		DATE: NOV. 18, 2016 SCALE: NOTED CHKD: A.S. DFTM: B.L. JOB NO: 23498-016 DWG. NO: AB2.1 GLOVER ROAD

Vermont Agency of Transportation
RECEIVED
 CK'D BY T.Y. Lin International OK'D BY J. Olund
 January 24, 2017
 RESUBMIT No Approved
 BY D. Bonneau DATE 01/25/17