

F:\VT-Bridges\2016-16 BartonGlover Road\Glover-AB1-1.dwg, 1/4/2017 4:40:18 PM

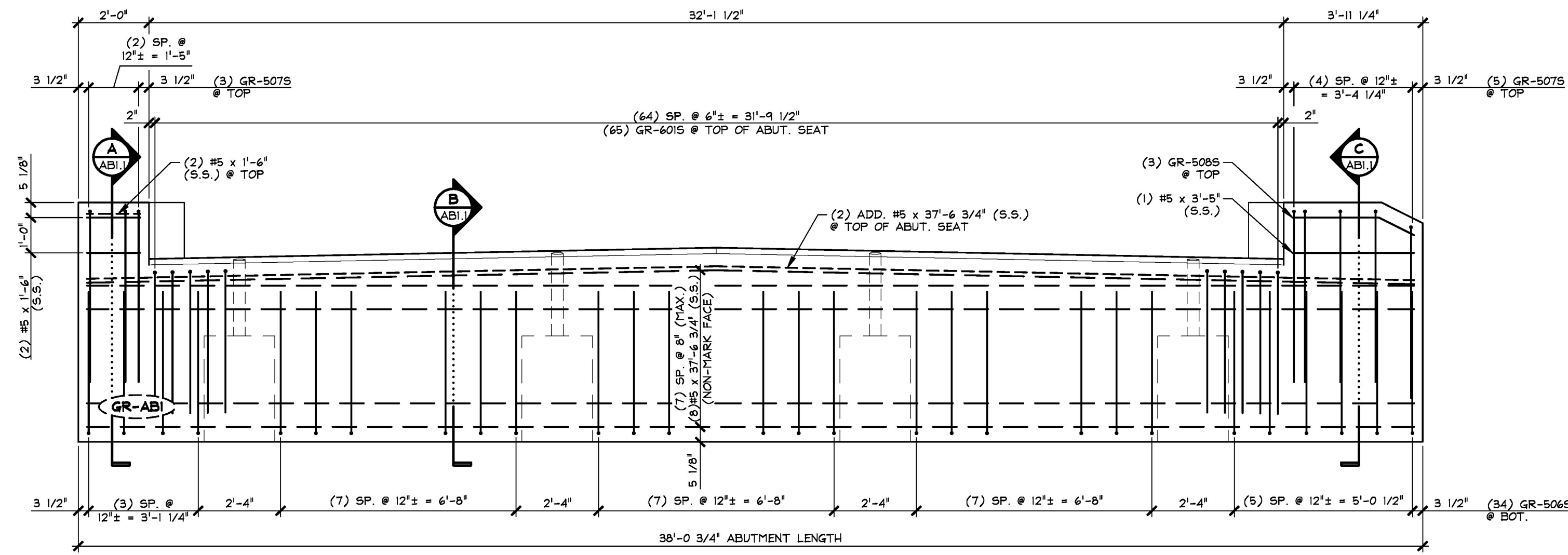

1 NON-MARK FACE ELEVATION
3/8" = 1'-0"

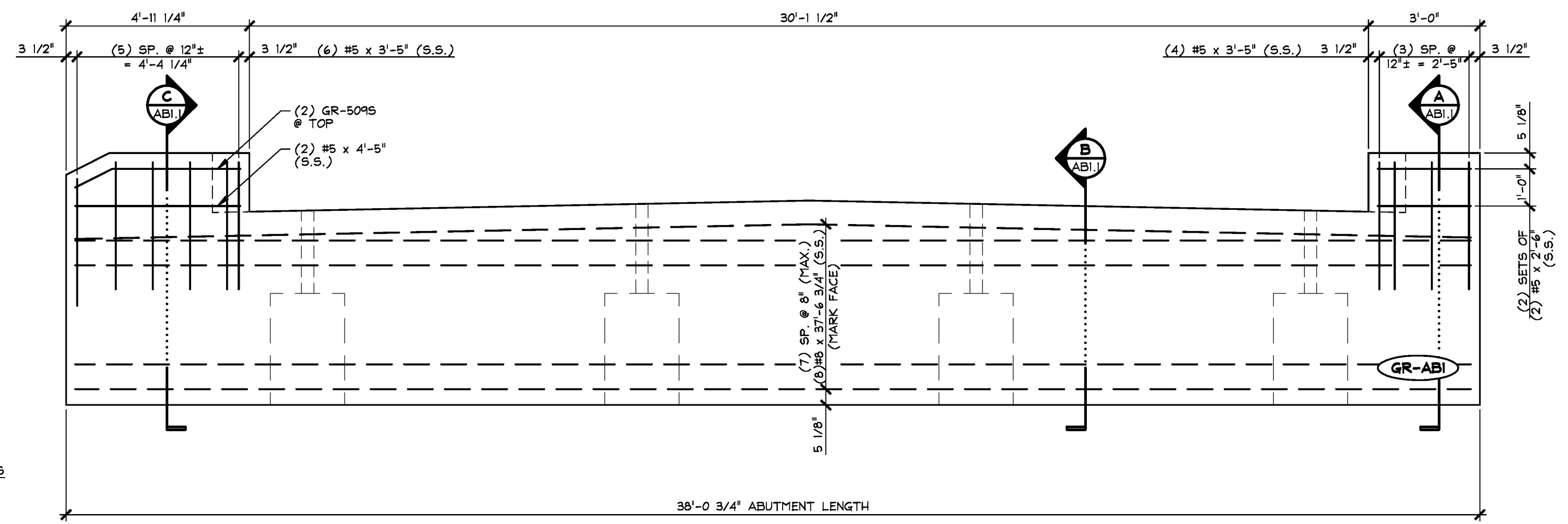

2 MARK FACE ELEVATION
3/8" = 1'-0"
SEE NON-MARK ELEVATION FOR REINFORCING NOT SHOWN

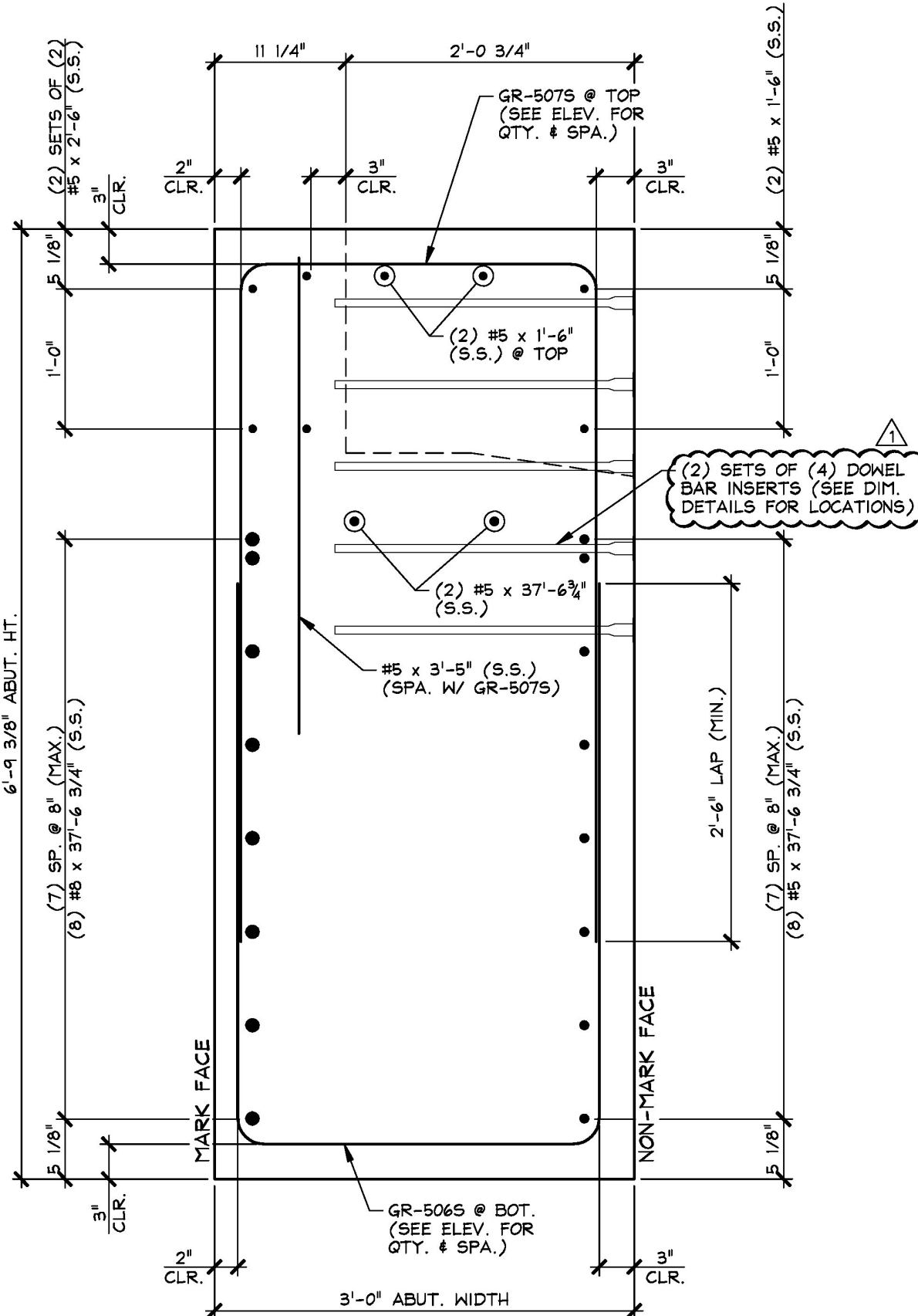

A SECTION
1" = 1'-0"

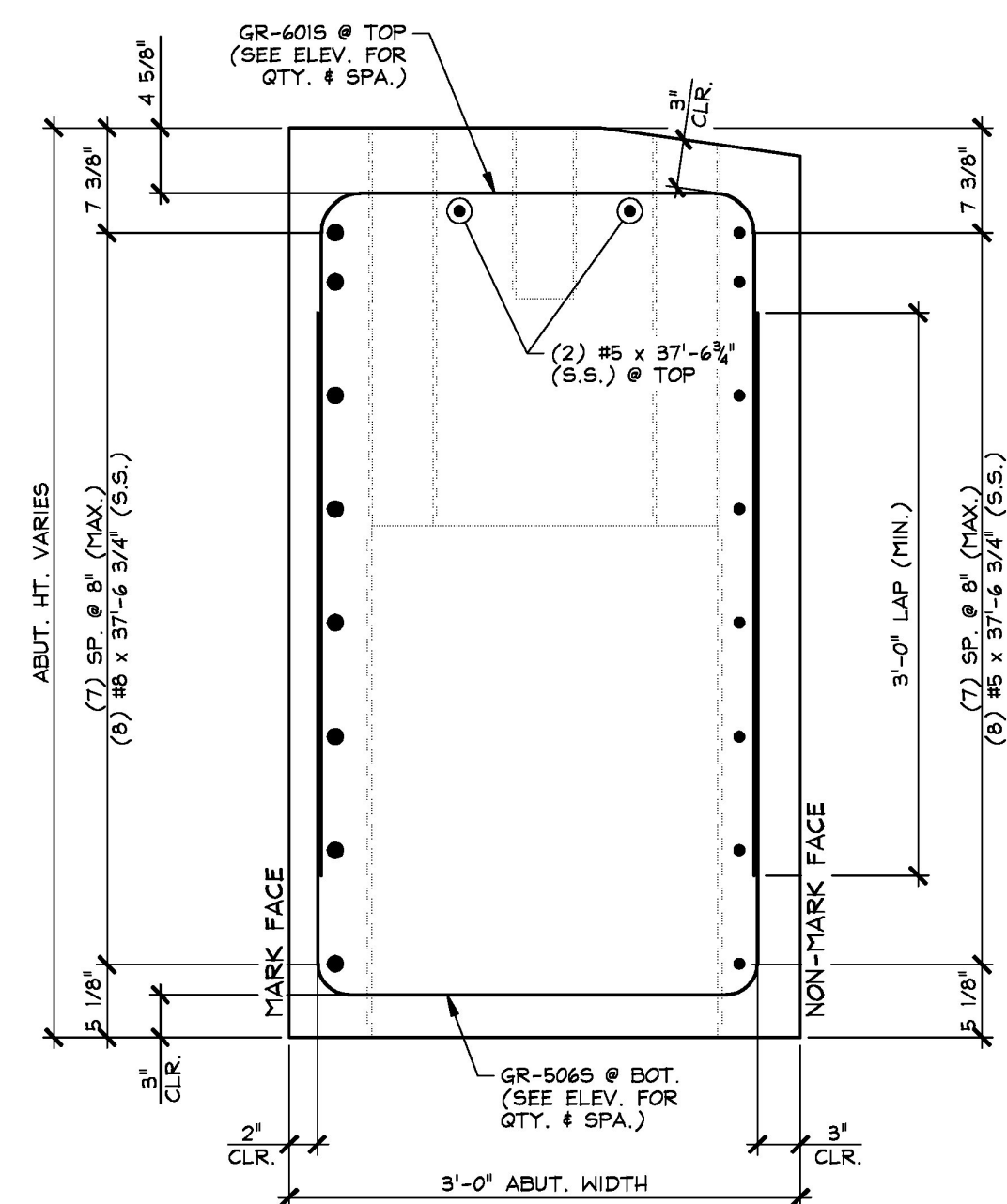

B SECTION
1" = 1'-0"

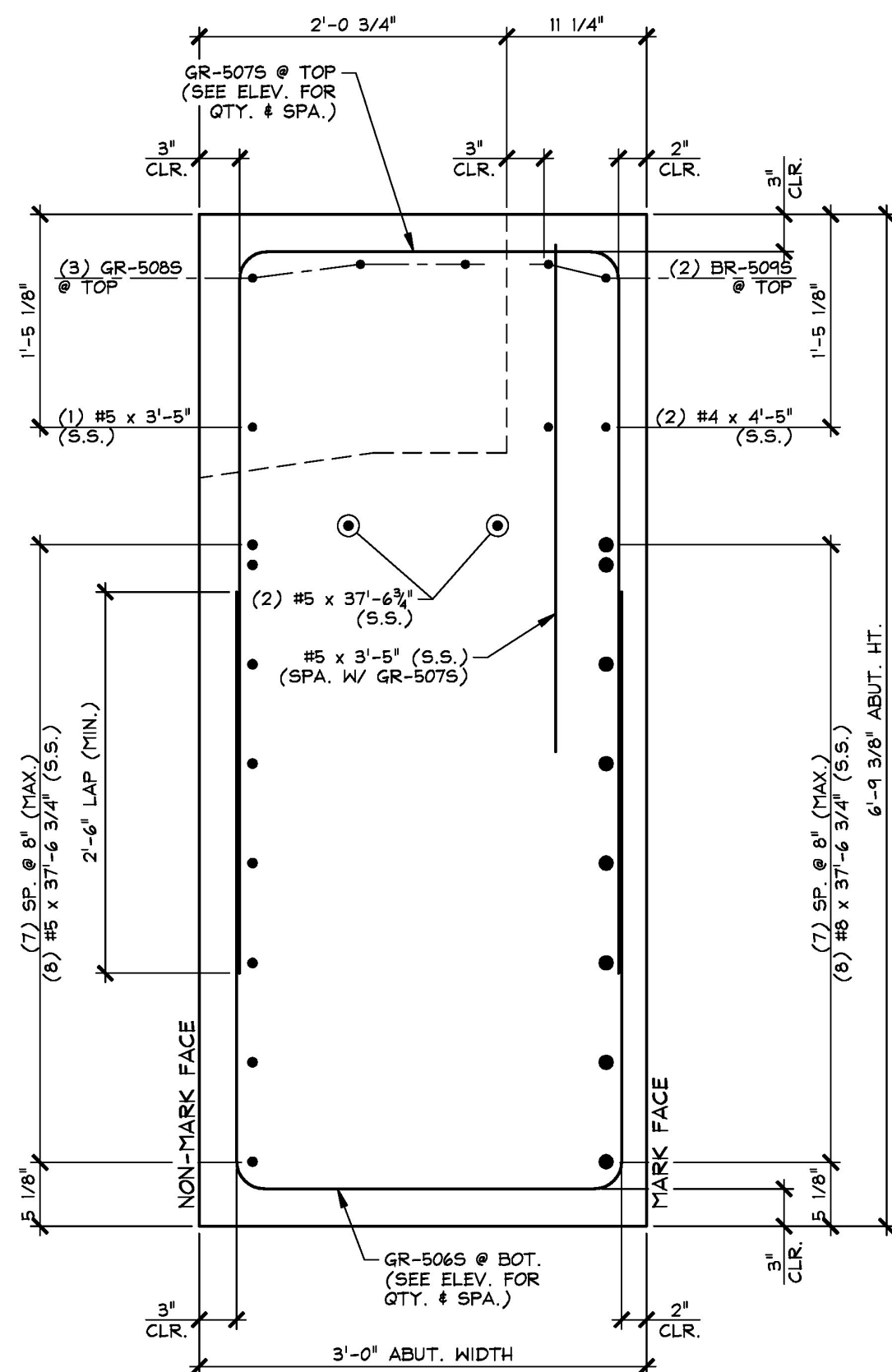

C SECTION
1" = 1'-0"

T.Y. LIN INTERNATIONAL
THE STAMPED DOCUMENTS ARE HEREBY:
 ✓ APPROVED
 ✓ APPROVED AS NOTED
 ✓ REVISE AND RESUBMIT
 SEE TRANSMITTAL FOR ADDITIONAL INFORMATION AS APPLICABLE.
 THIS REVIEW IS FOR GENERAL CONFORMANCE WITH DESIGN CONCEPT ONLY. ANY DEVIATION FROM THE PLANS OR SPECIFICATIONS NOT CLEARLY NOTED BY THE CONTRACTOR HAS NOT BEEN REVIEWED. REVIEW BY THE ENGINEER SHALL NOT RELIEVE THE CONTRACTOR OF THE CONTRACTUAL RESPONSIBILITY FOR ANY ERRORS OR DEVIATION FROM THE CONTRACT REQUIREMENTS.
 JOSH LUND, REVIEWER, January 25, 2017

1-3-17 REVISED AS NOTED

APPROVAL STAMP:

J.P. CARRARA & SONS INC.
Precast & Prestress Manufacturer
244 GAGE ST., MIDDLEBURY, VERMONT 05750 Phone: (802)388-6361 Fax: (802)388-9010
STATE OF VERMONT AGENCY OF TRANSPORTATION
COUNTY OF ORLEANS
 VILLAGE OF BARTON
TH 2 (GLOVER ROAD), RURAL MAJOR COLLECTOR
BRIDGE NO.: 20 PROJECT NO.: BHF 0286(5)
PRECAST ABUTMENT REINFORCING DETAILS

J.P. SICARD, INC.
CONTRACTOR
BARTON, VERMONT
 DATE: NOV. 18, 2016
 SCALE: NOTED
 CHKD: A.S. DFTM: B.L.
 JOB NO: 23498-016
 DWG. NO: **AB1.1**
GLOVER ROAD

Vermont Agency of Transportation
RECEIVED
 CK'D BY T.Y. Lin International OK'D BY J. Olund
 January 24, 2017
 RESUBMIT No Approved
 By D. Bonnaeu DATE 01/25/17

SHOP NOTE:
SEE DIMENSIONAL DETAILS FOR REQUIRED MECHANICAL BAR SPlicERS (MK-GR6) AND #8 PROJECTING BARS.

MARK: **GR-AB1** QTY.: 1

MATERIAL LIST / ABUTMENT			
ITEM	MARK	DESCRIPTION	QTY.
1	GR-5065	#5 BENT BAR (STAINLESS STEEL)	34
2	GR-5075	#5 BENT BAR (STAINLESS STEEL)	8
3	GR-5085	#5 BENT BAR (STAINLESS STEEL)	3
4	GR-5095	#5 BENT BAR (STAINLESS STEEL)	2
5	#5 x 37'-6 3/4"	(STAINLESS STEEL)	10
6	#5 x 1'-6"	(STAINLESS STEEL)	4
7	#5 x 3'-5"	(STAINLESS STEEL)	11
8			
9	#5 x 4'-5"	(STAINLESS STEEL)	2
10	#5 x 2'-6"	(STAINLESS STEEL)	4
11			
12	GR-6015	#6 BENT BAR (STAINLESS STEEL)	65
13			
14	#8 x 37'-6 3/4"	(STAINLESS STEEL)	8
15			