

		(12D)	1.25 Py	1.5 Py
5/8"-11unc	#4	6"	15,000	18,000
3/4"-10unc	#5	7-1/2"	26,250	27,900
7/8"-9unc	#6	9"	33,000	39,600
1"-8unc	#7	10-1/2"	45,000	54,000
1-1/8"-8unc	#8	12"	59,250	71,100

Table 5, "Reinforcing Steel Data", shows the ASTM Standards for reinforcing bars.

**Table 5: ASTM Standard Rebar Data**

Bar Size	Designation Weight (lbs. Per ft)	Nominal Diameter	
		Diameter (in)	Cross-Section Area (sq. in.)
#4	0.668	0.500	0.20
#5	1.043	0.625	0.31
#6	1.502	0.750	0.44
#7	2.044	0.875	0.60
#8	2.670	1.000	0.79
#9	3.400	1.128	1.00
#10	4.303	1.270	1.27
#11	5.313	1.410	1.56

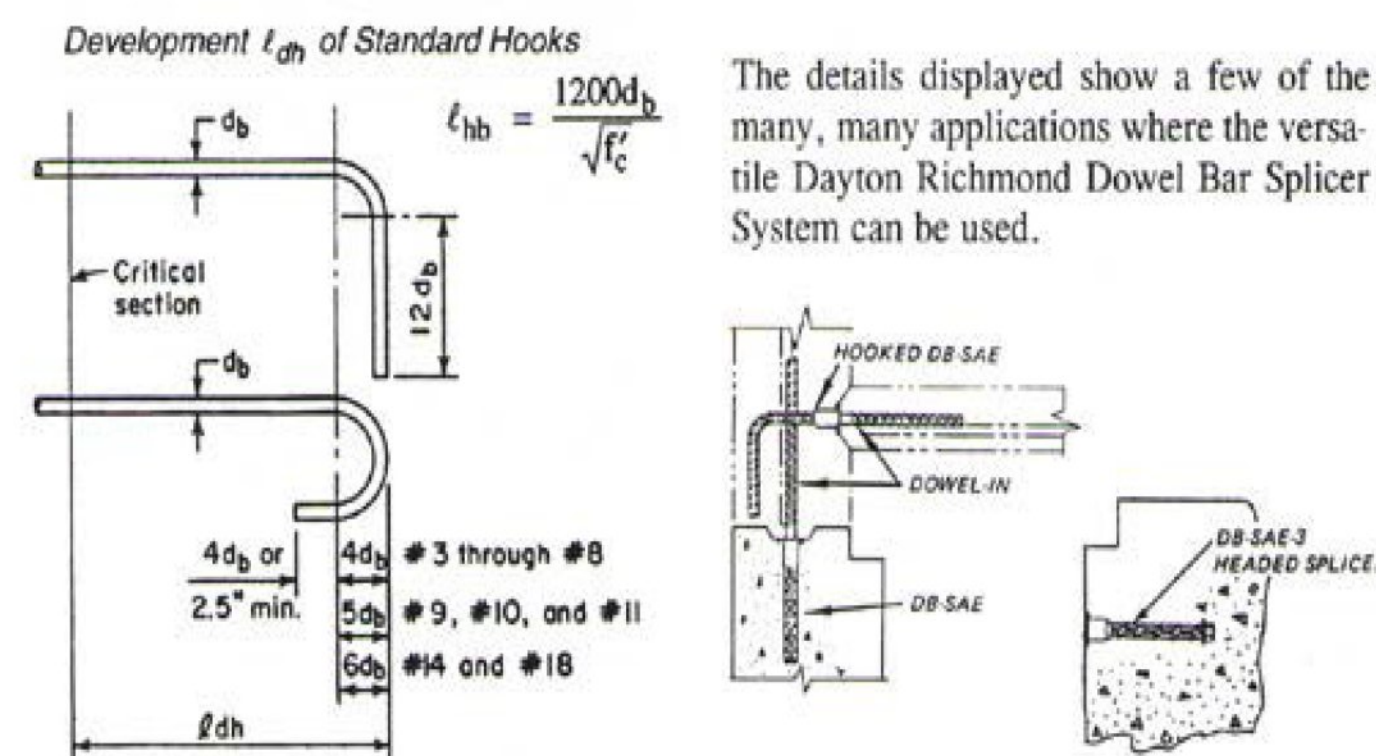

**DOWEL-IN (DI)**  
 Give Quantity, bar size (should be equivalent to rebar being substituted for on