

4 INCH WHITE LINE (4" WL)
 31+20.00 - 32+30.00, LT
 31+20.00 - 32+30.00, RT
 61+05.50 - 61+23.14, LT
 61+70.79 - 62+80.75, LT

4 INCH YELLOW LINE (4" YL)
 32+00.00 - 32+20.00 (DOUBLE CENTERLINE)
 61+06.96 - 61+30.00, (DOUBLE CENTERLINE)
 61+70.00 - 62+75.00 (DOUBLE CENTERLINE)

24 INCH STOP BAR
 32+19.00, RT (11.36 FT)

REMOVAL OF EXISTING PAVEMENT MARKINGS
 61+30.00 - 62+18.87, RT (29.62 SF)
 61+84.50 - 62+12.78, LT (10.01 SF)
 61+84.50 - 62+18.87, LT (11.46 SF)
 62+65.96 - 62+93.40, LT (9.50 SF)

LETTER OR SYMBOL
 32+05.91, RT (STOP)

REMOVING SIGNS
 30+96, LT (2 SIGNS)
 31+27, LT (1 SIGN)
 32+02, LT (1 SIGN)
 32+13, LT (2 SIGNS)

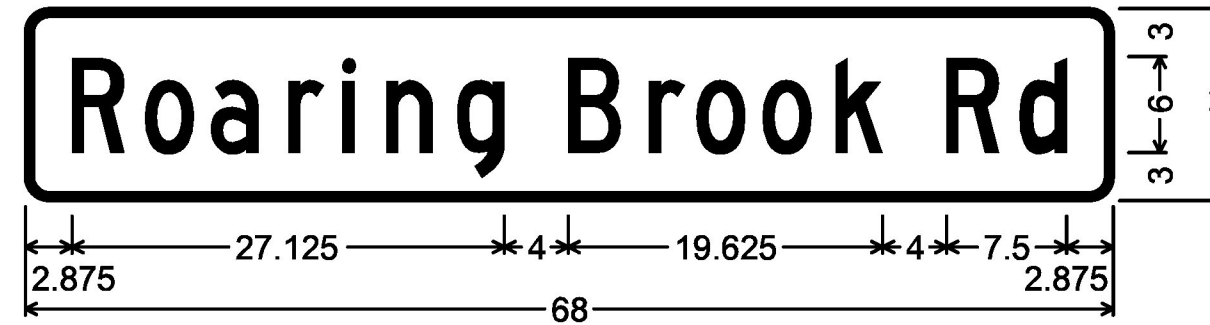
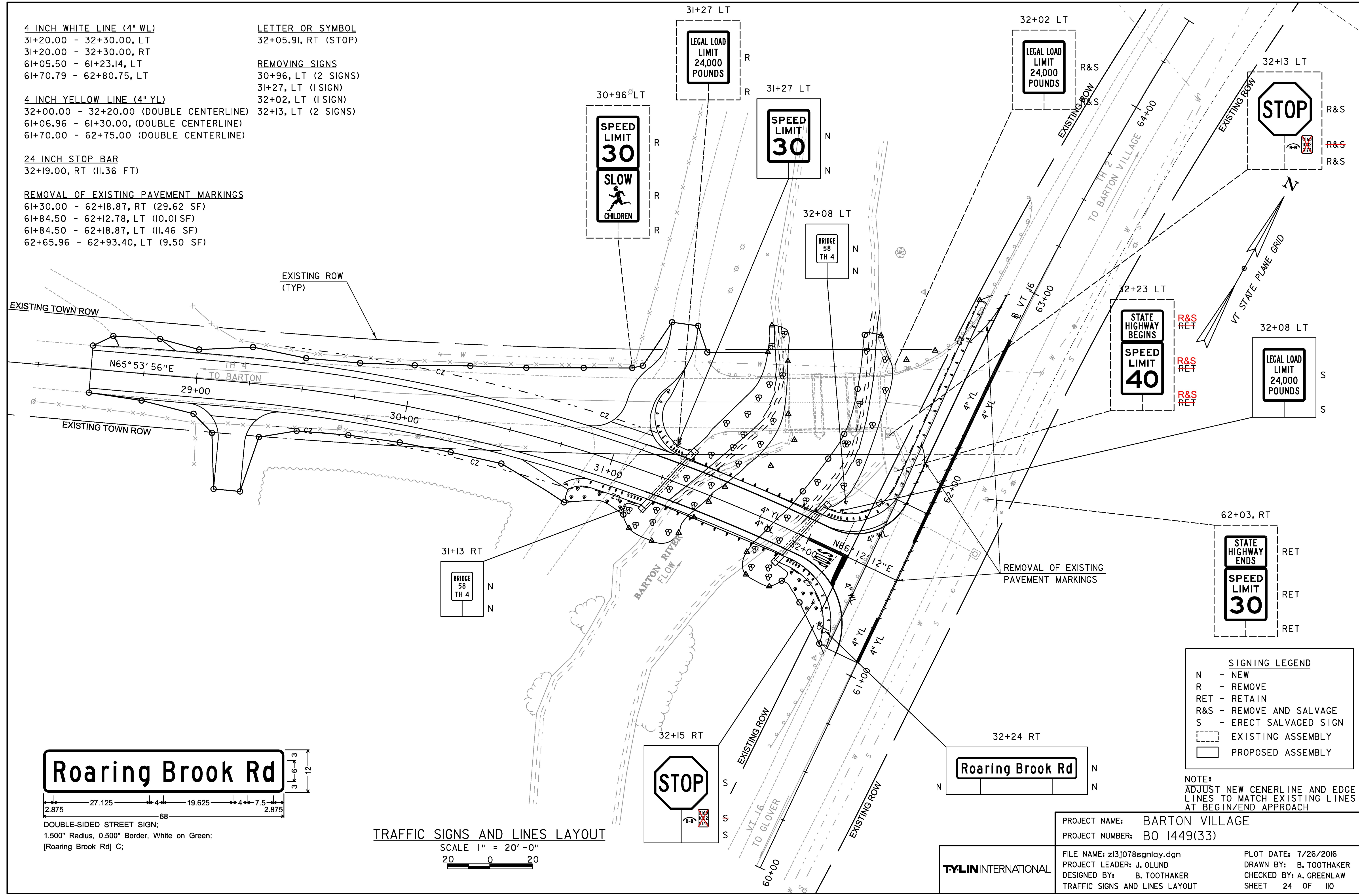

DOUBLE-SIDED STREET SIGN;
 1.500" Radius, 0.500" Border, White on Green;
 [Roaring Brook Rd] C;

TRAFFIC SIGNS AND LINES LAYOUT
 SCALE 1" = 20'-0"
 20 0 20

SIGNING LEGEND

N	- NEW
R	- REMOVE
RET	- RETAIN
R&S	- REMOVE AND SALVAGE
S	- ERECT SALVAGED SIGN
	- EXISTING ASSEMBLY
	- PROPOSED ASSEMBLY

NOTE:
 ADJUST NEW CENTERLINE AND EDGE LINES TO MATCH EXISTING LINES AT BEGIN/END APPROACH

PROJECT NAME:	BARTON VILLAGE
PROJECT NUMBER:	BO 1449(33)
FILE NAME:	z13j078sgnlay.dgn
PROJECT LEADER:	J. OLUND
DESIGNED BY:	B. TOOTHAKER
TRAFFIC SIGNS AND LINES LAYOUT	
PLOT DATE:	7/26/2016
DRAWN BY:	B. TOOTHAKER
CHECKED BY:	A. GREENLAW
SHEET	24 OF 110

TYLININTERNATIONAL