

**1 CURTAIN WALL DIMENSIONAL ELEVATION**  
 NB2.1 VOL.: 2.17 cy WT.: 4.40 T 3/4" = 1'-0"

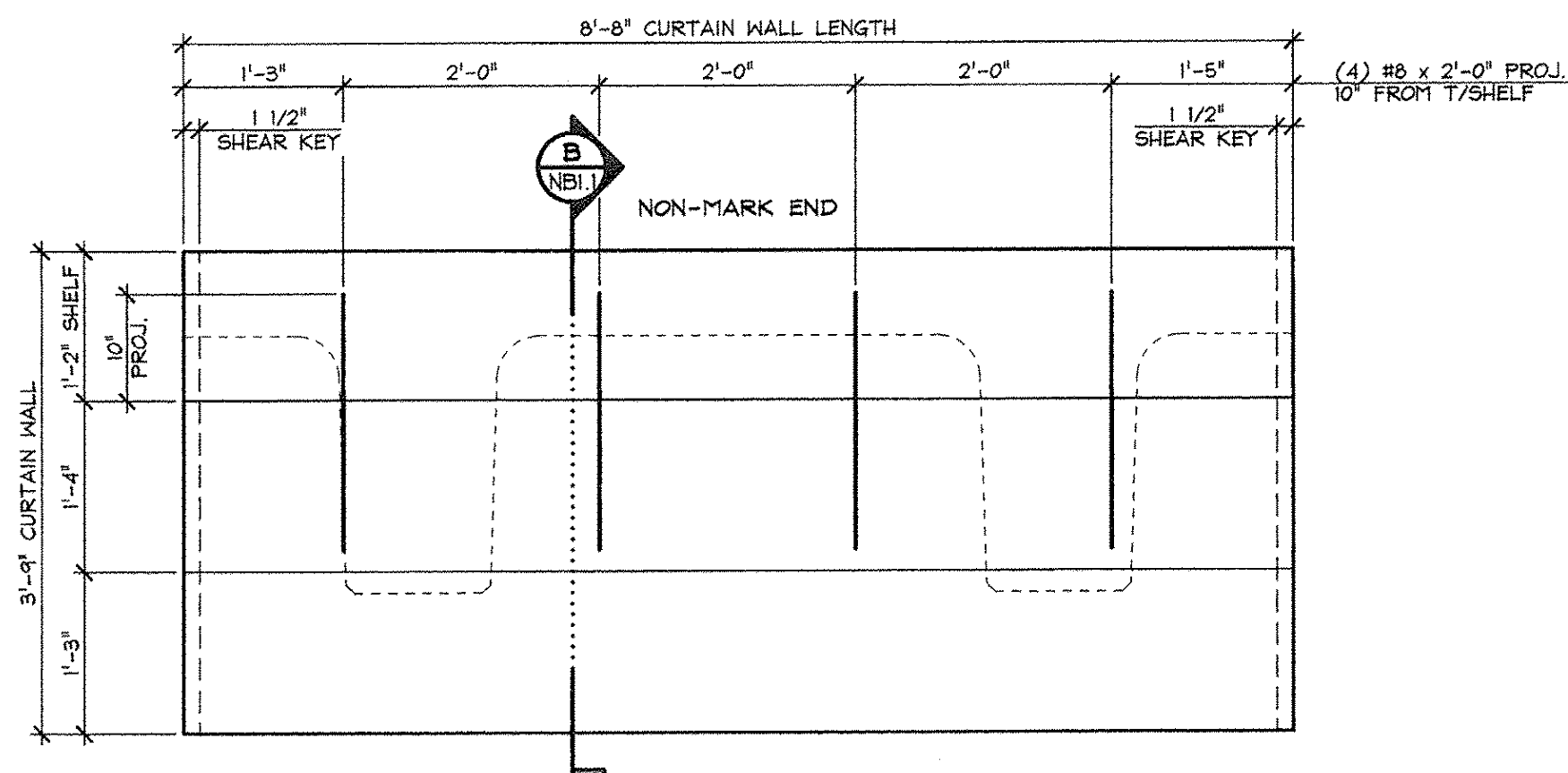

**3 CURTAIN WALL DIMENSIONAL ELEVATION**  
 NB2.1 VOL.: 2.17 cy WT.: 4.40 T 3/4" = 1'-0"

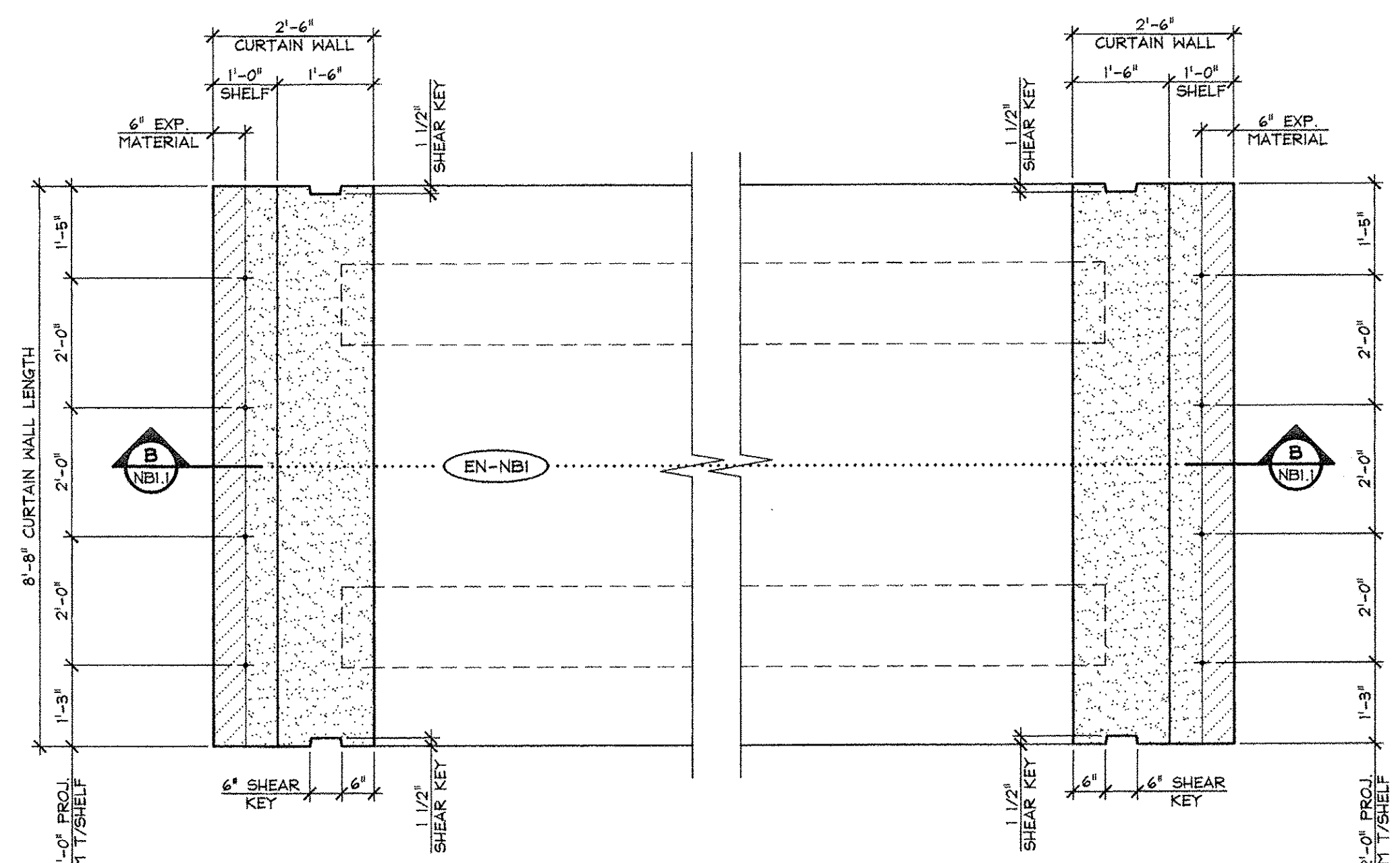

**5 CURTAIN WALL DIMENSIONAL PLAN**  
 NB2.1 1/2" = 1'-0"

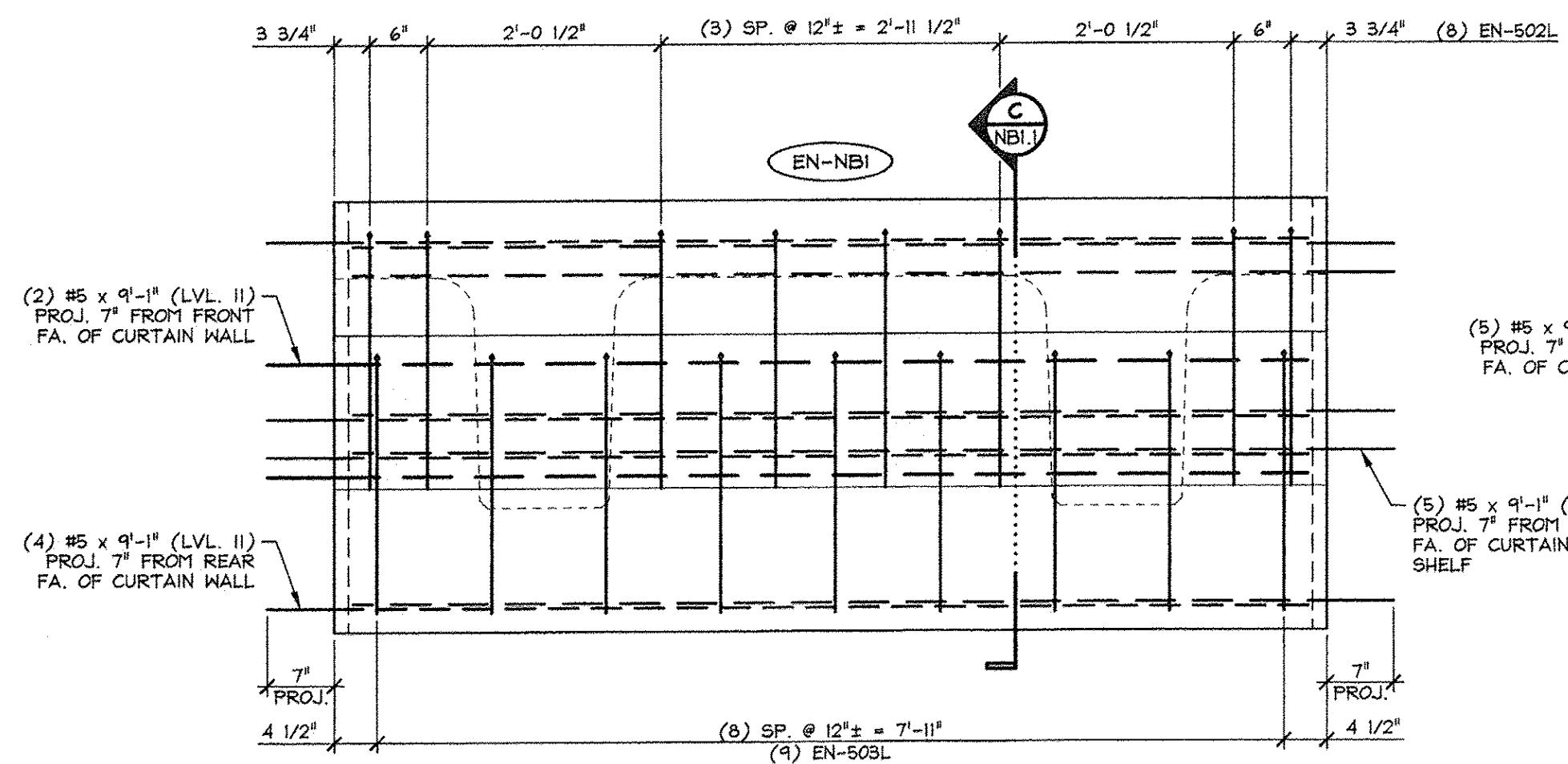

**2 CURTAIN WALL REINFORCING ELEVATION**  
 NB2.1 3/4" = 1'-0"

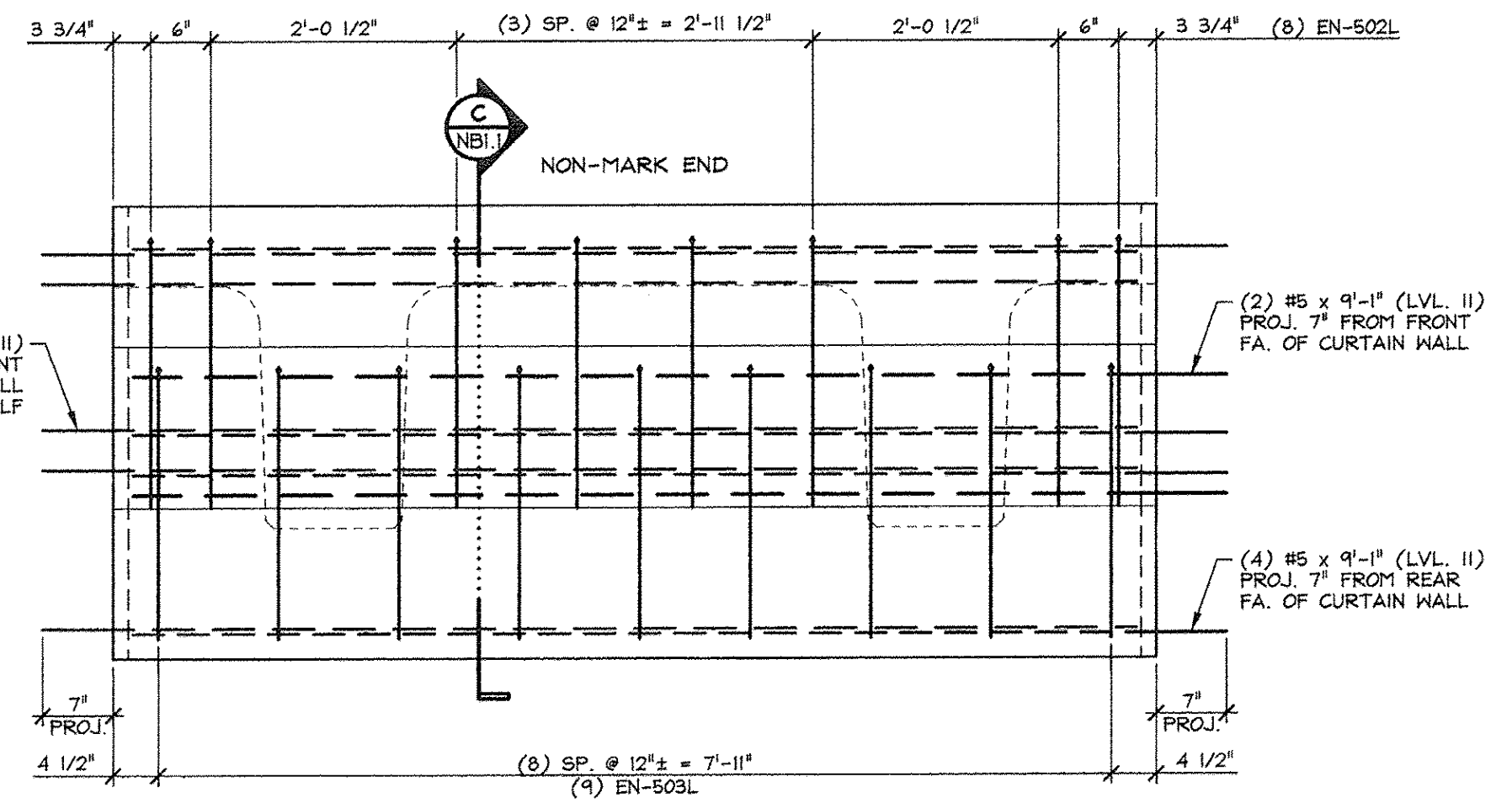

**4 CURTAIN WALL REINFORCING ELEVATION**  
 NB2.1 3/4" = 1'-0"

56.25 T = NEXT BEAM  
 4.40 T = CURTAIN WALL (MARK END)  
 4.40 T = CURTAIN WALL (NON-MARK END)  
 65.1 T = TOTAL BEAM WT.

ISSUED FOR PRODUCTION  
 APR 09 2014  
 J.P. CARRARA & SONS, INC.  
 MIDDLEBURY, VT 05753

MARK: EN-NB1 QTY.: 1

MATERIAL LIST / CURTAIN WALL				
ITEM	MARK	DESCRIPTION	QTY./CURTAIN WALL	
			MARK END	NON-MARK END
1	SH-502L	#5 BENT BAR (LEVEL II, DUAL COATED)	8	8
2	SH-503L	#5 BENT BAR (LEVEL II, DUAL COATED)	9	9
3				
4		#5 x 9'-1" (LVL. II, DUAL COATED)	11	11
5				
6				
7				
8		#8 x 2'-0" (LEVEL II, DUAL COATED)	4	4
9				
10				

APPROVED: Approval of drawings and/or procedures indicates concurrence with the information presented and does not relieve the Contractor or Fabricator of compliance with all specifications and code requirements	
APPROVED AS NOTED	
REVISE AND RESUBMIT	
NOT REVIEWED	
Date: 4-11-2014	
By: James Hyslop	

Vermont Agency of Transportation  
**RECEIVED**  
 ON: April 9, 2014  
 and Checked for  
**CONFORMANCE**  
 BY: Rob Young DATE: 04/14/2014

**J.P. CARRARA & SONS INC.** Precast & Prestress Manufacturer  
 244 OSGE ST., MIDDLEBURY, VERMONT 05753 Phone: (802)389-6361 Fax: (802)389-9010

**A.L. ST. ONGE CONTRACTOR, INC.** CONTRACTOR  
 MONTGOMERY CENTER, VERMONT

**STATE OF VERMONT AGENCY OF TRANSPORTATION** COUNTY OF FRANKLIN  
 DATE: JAN. 27, 2014  
 SCALE: NOTED

**TOWN OF ENOSBURG**  
 BOSTON POST ROAD T.H.2 CLASS 2  
 BRIDGE NO.: 4B PROJECT NO.: BRO 1448(40)  
 CHKD: M.W. DFTM: B.L.  
 JOB NO: 23418-013

**PRECAST CURTAIN WALL DETAILS** DWG. NO: NB2.1

This review of Stantec Consulting Services Inc. is for the sole purpose of ascertaining conformance with the general design concept. This review shall not mean that Stantec Consulting Services Inc approves the detail design inherent in the shop drawings, responsibility for which shall remain with the Contractor. Submitting same, and such review shall not relieve the Contractor of his responsibility for errors or omissions in the shop drawing or of his responsibility for meeting all requirements of the Contract Documents. The contractor is responsible for dimensions to be confirmed and correlated at the job site, for information that pertains solely to the fabrication processes or to techniques of construction and installation and for coordination of the work of all subcontractors.