

**ITEM 646.21 - 4 INCH YELLOW LINE (DOUBLE CENTERLINE)**

STA. 10+00.0 - 12+25.0, LT. & RT.  
 STA. 13+00.0 - 13+50.0, LT. & RT.

**ITEM 646.26 - 24 INCH STOP BAR**

STA. 12+47.0 - 12+65.0, 43' LT.  
 STA. 12+50.0 - 12+70.0, 43' RT.

**ITEM 675.50 - REMOVING SIGNS**

AS SHOWN - 2

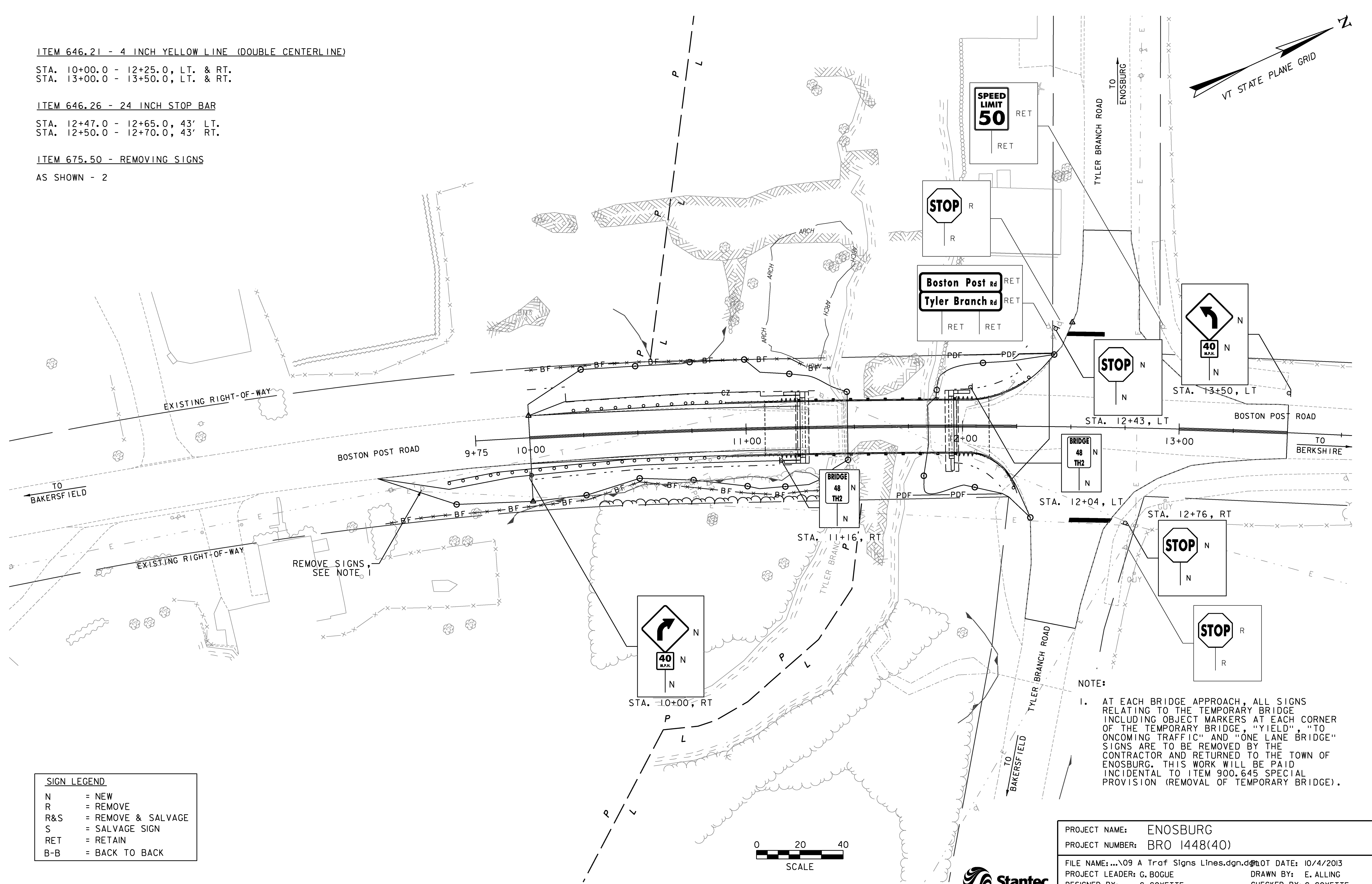
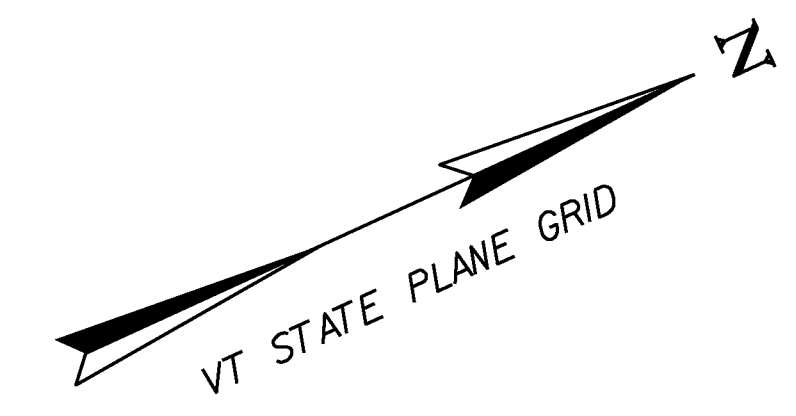

SIGN LEGEND	
N	= NEW
R	= REMOVE
R&S	= REMOVE & SALVAGE
S	= SALVAGE SIGN
RET	= RETAIN
B-B	= BACK TO BACK

NOTE:  
 1. AT EACH BRIDGE APPROACH, ALL SIGNS RELATING TO THE TEMPORARY BRIDGE INCLUDING OBJECT MARKERS AT EACH CORNER OF THE TEMPORARY BRIDGE, "YIELD", "TO ONCOMING TRAFFIC" AND "ONE LANE BRIDGE" SIGNS ARE TO BE REMOVED BY THE CONTRACTOR AND RETURNED TO THE TOWN OF ENOSBURG. THIS WORK WILL BE PAID INCIDENTAL TO ITEM 900.645 SPECIAL PROVISION (REMOVAL OF TEMPORARY BRIDGE).

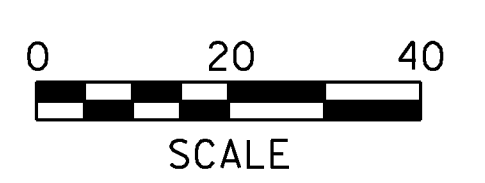

PROJECT NAME: ENOSBURG  
 PROJECT NUMBER: BRO 1448(40)  
 FILE NAME: ...09 A Traf Signs Lines.dgn.d\DOT DATE: 10/4/2013  
 PROJECT LEADER: G. BOGUE DRAWN BY: E. ALLING  
 DESIGNED BY: G. GOYETTE CHECKED BY: G. GOYETTE  
**TRAFFIC SIGNS AND LINES LAYOUT - TSL 1 SHEET 14 OF 46**

