

STATE OF VERMONT AGENCY OF TRANSPORTATION

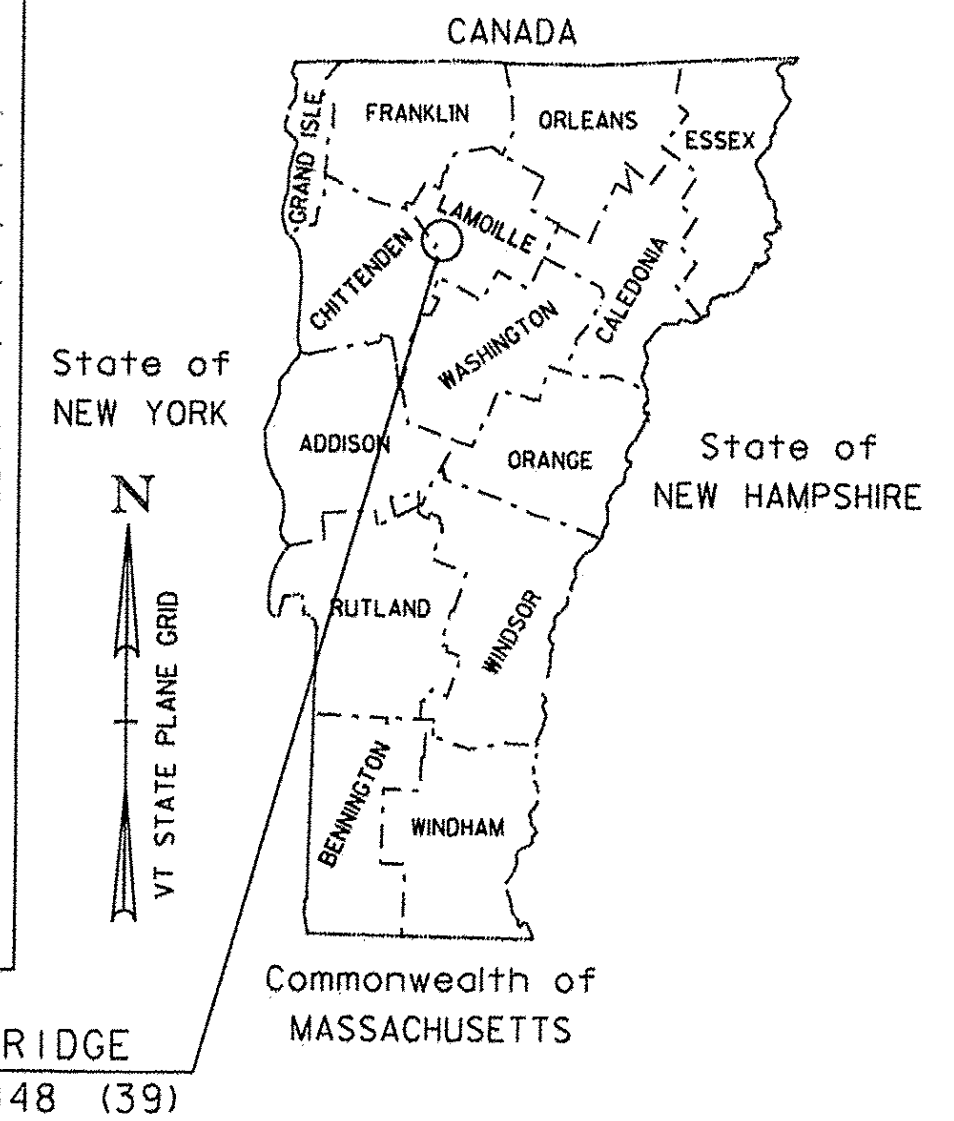

PROPOSED IMPROVEMENT BRIDGE PROJECT TOWN OF CAMBRIDGE COUNTY OF LAMOILLE

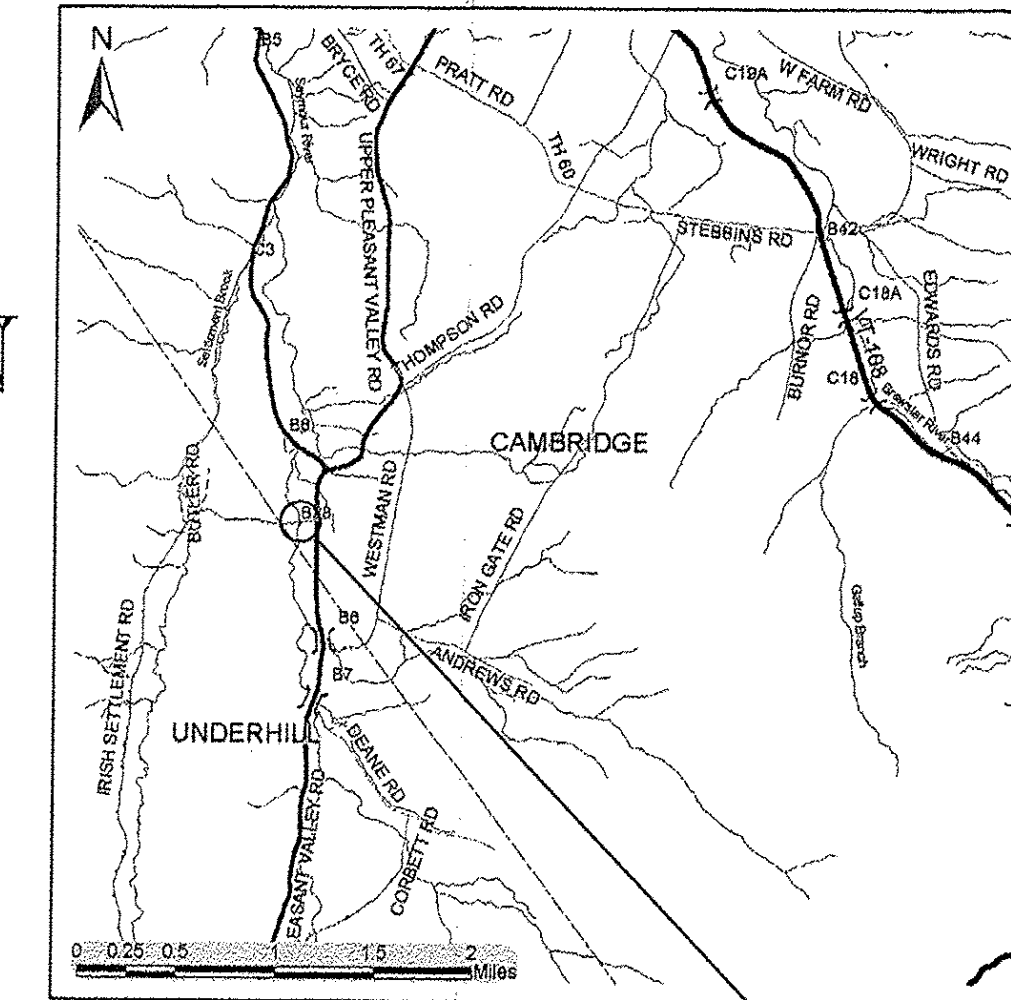

RECORD PLANS	
CONTRACTOR:	BLOW & COTE INC. - MORRISVILLE, VT
RESIDENT ENGINEER:	GREG WILCOX
CONSTRUCTION BEGAN:	MAY 18, 2015
CONSTRUCTION COMPLETE:	AUGUST 19, 2015
RECORD PLANS BY:	GREG WILCOX & KEVIN KING
I HEREBY CERTIFY THAT ALL THE CONSTRUCTION REQUIRED BY THIS SET OF DRAWINGS HAS BEEN ACCOMPLISHED AS INDICATED HEREIN.	
BY:	RESIDENT ENGINEER
DATE:	5-17-16
NOTE: Any further information concerning final quantities, amounts or other details relative to this project may be found at Central Files in the electronic archives.	

ROUTE NO : TOWN HIGHWAY 46 (IRISH SETTLEMENT ROAD), CLASS 3 TOWN HIGHWAY
BRIDGE NO : 28

PROJECT LOCATION: 0.1 MILES WEST OF JUNCTION WITH TOWN HIGHWAY 1 (PLEASANT VALLEY ROAD)

PROJECT DESCRIPTION: REPLACEMENT OF BRIDGE 28 WITH A NEW PRECAST CONCRETE STRUCTURE WITH RELATED APPROACH AND CHANNEL WORK.

LENGTH OF STRUCTURE: 60.66 FEET
LENGTH OF ROADWAY: 89.34 FEET
LENGTH OF PROJECT: 150.00 FEET

CONSTRUCTION IS TO BE CARRIED ON IN ACCORDANCE WITH THESE PLANS AND THE STANDARD SPECIFICATIONS FOR CONSTRUCTION DATED 2011, AS APPROVED BY THE FEDERAL HIGHWAY ADMINISTRATION ON JULY 20, 2011 FOR USE ON THIS PROJECT, INCLUDING ALL SUBSEQUENT REVISIONS AND SUCH REVISED SPECIFICATIONS AND SPECIAL PROVISIONS AS ARE INCORPORATED IN THESE PLANS.

QUALITY ASSURANCE PROGRAM : LEVEL 2	
SURVEYED BY :	L. ORVIS
SURVEYED DATE :	04-24-2012
DATUM	
VERTICAL	NAVD88
HORIZONTAL	NAD83 (2007)

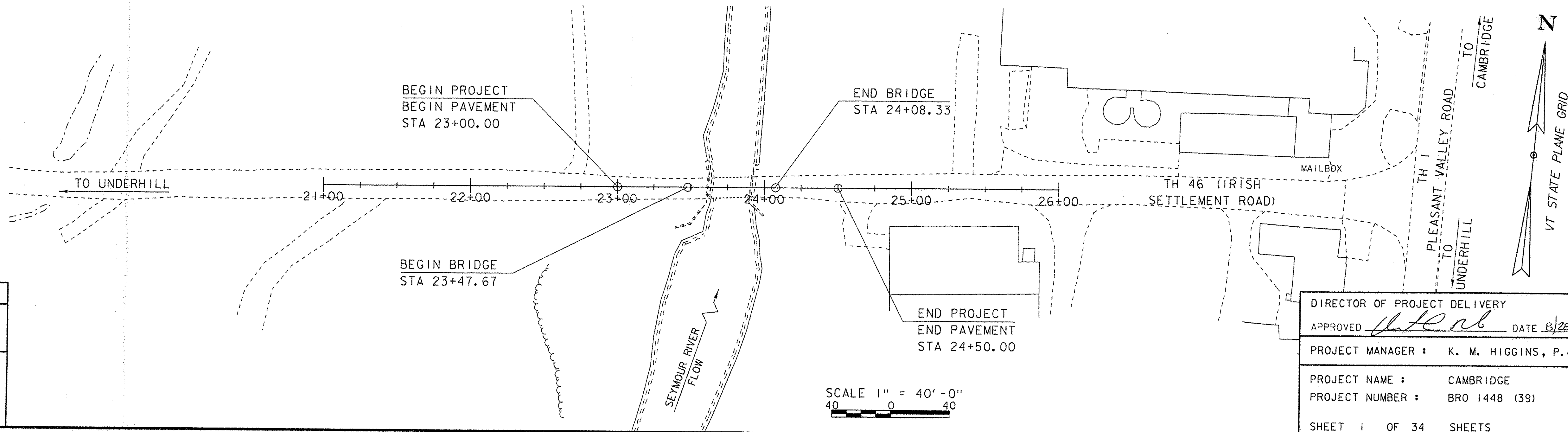

SCALE 1" = 40'-0"
40 0 40

DIRECTOR OF PROJECT DELIVERY	
APPROVED:	DATE 8/28/2014
PROJECT MANAGER : K. M. HIGGINS, P.E.	
PROJECT NAME : CAMBRIDGE	
PROJECT NUMBER : BRO 1448 (39)	
SHEET 1 OF 34 SHEETS	