

ITEM 646.410 - DURABLE 4 INCH YELLOW LINE  
 STA. 14+50.0 - 18+75, LT. & RT. (DOUBLE CENTERLINE)

ITEM 675.50 - REMOVING SIGNS  
 AS SHOWN - 4

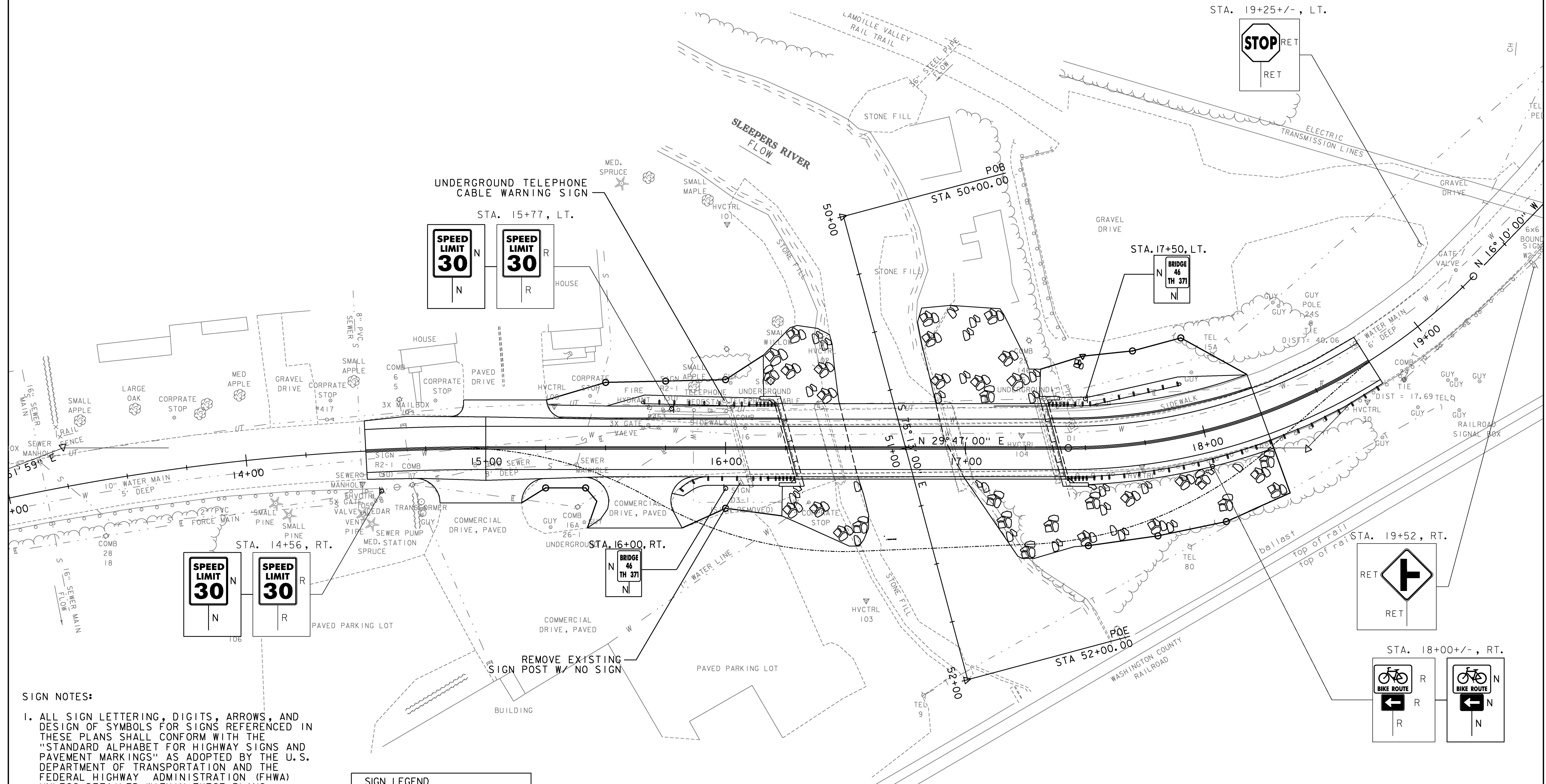
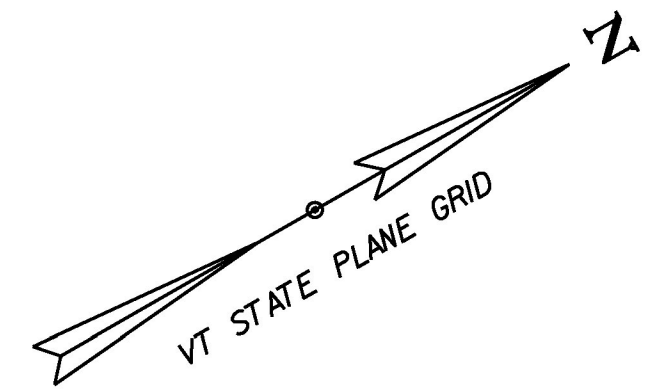

**SIGN NOTES:**

1. ALL SIGN LETTERING, DIGITS, ARROWS, AND DESIGN OF SYMBOLS FOR SIGNS REFERENCED IN THESE PLANS SHALL CONFORM WITH THE "STANDARD ALPHABET FOR HIGHWAY SIGNS AND PAVEMENT MARKINGS" AS ADOPTED BY THE U.S. DEPARTMENT OF TRANSPORTATION AND THE FEDERAL HIGHWAY ADMINISTRATION (FHWA) UNLESS DETAILED WITHIN THESE PLANS.
2. ALL COLORS SHALL CONFORM WITH THE STANDARD COLORS ADOPTED BY THE AMERICAN ASSOCIATION OF STATE HIGHWAY AND TRANSPORTATION OFFICIALS (AASHTO) AND APPROVED BY FHWA UNLESS OTHERWISE NOTED.
3. ALL SHEETING SHALL BE TYPE III MINIMUM.

SIGN LEGEND	
N	= NEW
R	= REMOVE
R&S	= REMOVE & SALVAGE
S	= SALVAGE SIGN
RET	= RETAIN
B-B	= BACK TO BACK

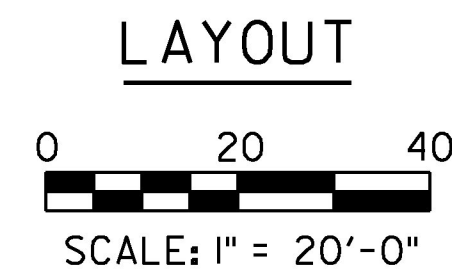

PROJECT NAME: ST JOHNSBURY	
PROJECT NUMBER: BRO 1447(30)	
FILE NAME: z12j164bdr.dgn	PLOT DATE: 9/30/2016
PROJECT LEADER: M. CHENETTE	DRAWN BY: D. BARNES
DESIGNED BY: I. MAYNARD	CHECKED BY: G. SANTY
<b>SIGNING &amp; PAVEMENT MARKINGS PLAN</b>	SHEET 19 OF 76

