

SANITARY SEWER
ITEM 604.42 CHANGING ELEVATION OF SEWER MANHOLES

STA 15+38, RT.

WATER
ITEM 629.20 ADJUST ELEVATION OF VALVE BOX

STA 15+66, LT.
STA 15+68, LT.
STA 15+72, LT

ITEM 629.29. RELOCATE HYDRANT

STA 15+62, LT.

ITEM 900.620, SPECIAL PROVISION
(MANUAL AIR RELEASE, ALL INCLUSIVE)

STA 17+65, LT.

ITEM 900.620, SPECIAL PROVISION
(GATE VALVE WITH VALVE BOX, ALL INCLUSIVE) (10")

STA 15+90, LT.
STA 18+05, LT.

ITEM 900.620, SPECIAL PROVISION
(TAPPING SLEEVE AND VALVE WITH
VALVE BOX, ALL INCLUSIVE) (10" X 10")

STA 15+85, LT.
STA 18+10, LT.

ITEM 900.640, SPECIAL PROVISION
(DUCTILE IRON PIPE, CEMENT LINED,
ALL INCLUSIVE) (6")

STA 15+68, 10' LT. - STA 15+69, 21' LT.

ITEM 900.640, SPECIAL PROVISION
(DUCTILE IRON PIPE, CEMENT LINED,
ALL INCLUSIVE) (10")

STA 15+90, LT. - STA 16+01, LT.
STA 17+63, LT. - STA 18+05, LT.

ITEM 900.645, SPECIAL PROVISION
(WATER MAIN ON BRIDGE) (10")

STA 16+01, LT. - STA 17+63, LT.

PERMANENT WATER MAIN RELOCATION NOTES:

1. ALL PERMANENT DUCTILE IRON WATER MAIN PIPE SHALL BE CLASS 52.
2. PERMANENT DUCTILE IRON WATER MAIN PIPE FOR BRIDGE CROSSING SHALL BE RESTRAINED JOINT PIPE.
3. ALL PERMANENT DUCTILE IRON PIPE INSTALLED UNDER THE PERMANENT BRIDGE, WITHIN STEEL SLEEVES LOCATED BENEATH THE BRIDGE APPROACH SLABS, INCLUDING VERTICAL TRANSITIONS INTO AND OUT OF THE SLEEVES, SHALL BE PRE-INSULATED WITH 3" OF URETHANE INSULATION.

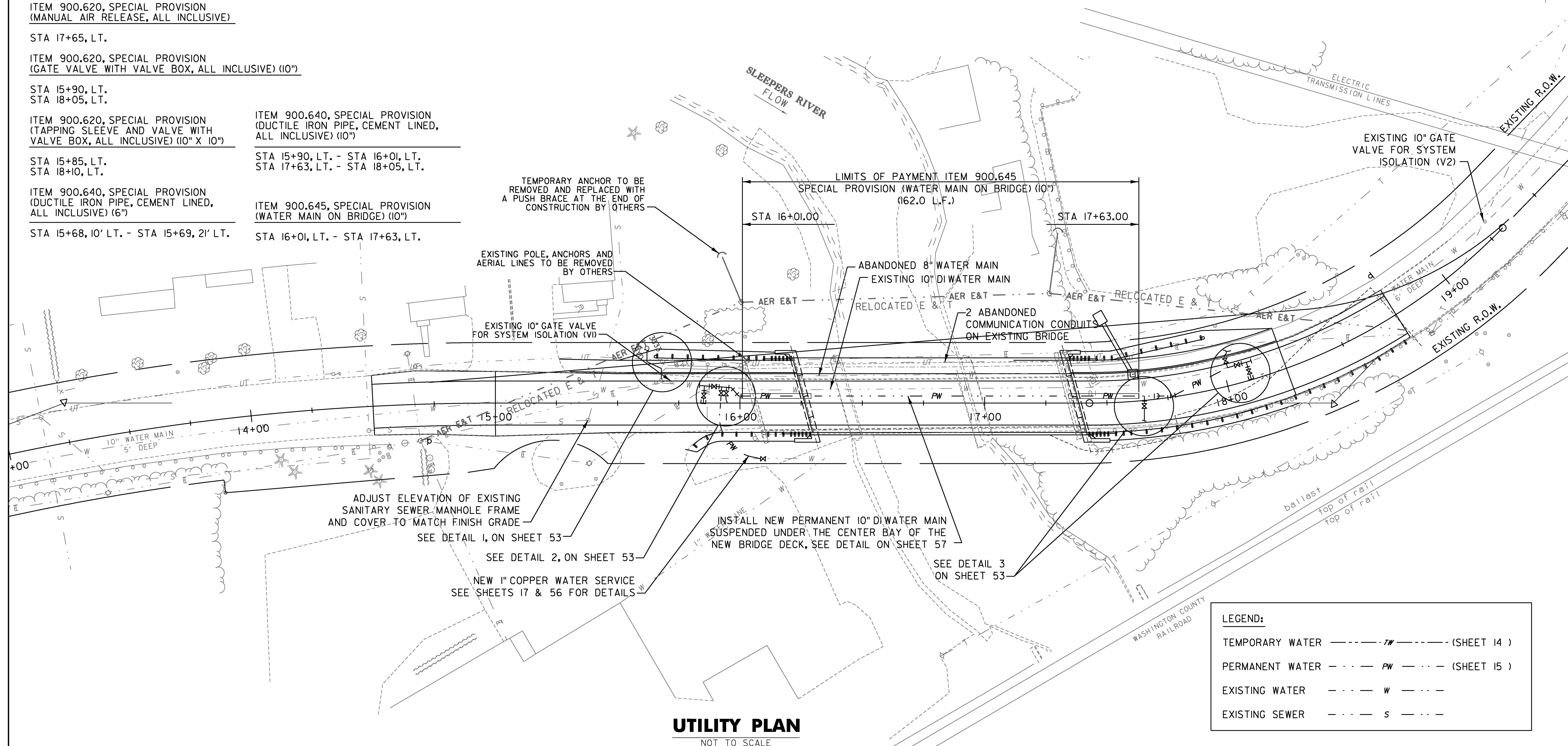
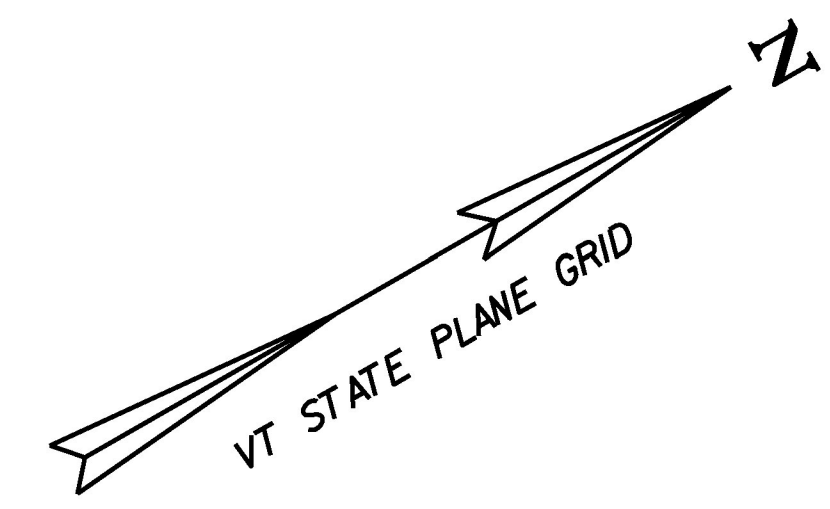

UTILITY PLAN
NOT TO SCALE

LEGEND:	
TEMPORARY WATER	-----TW----- (SHEET 14)
PERMANENT WATER	-----PW----- (SHEET 15)
EXISTING WATER	-----W-----
EXISTING SEWER	-----S-----

PROJECT NAME:	ST JOHNSBURY
PROJECT NUMBER:	BRO 1447(30)
FILE NAME:	z12j164bdr_u+11.dgn
PROJECT LEADER:	M. CHENETTE
DESIGNED BY:	D. CAMPBELL
UTILITY PLAN	
PLOT DATE:	9/30/2016
DRAWN BY:	H. HARRINGTON
CHECKED BY:	G. SANTY
SHEET	18 OF 76

