

PLAN VIEW IN FORM

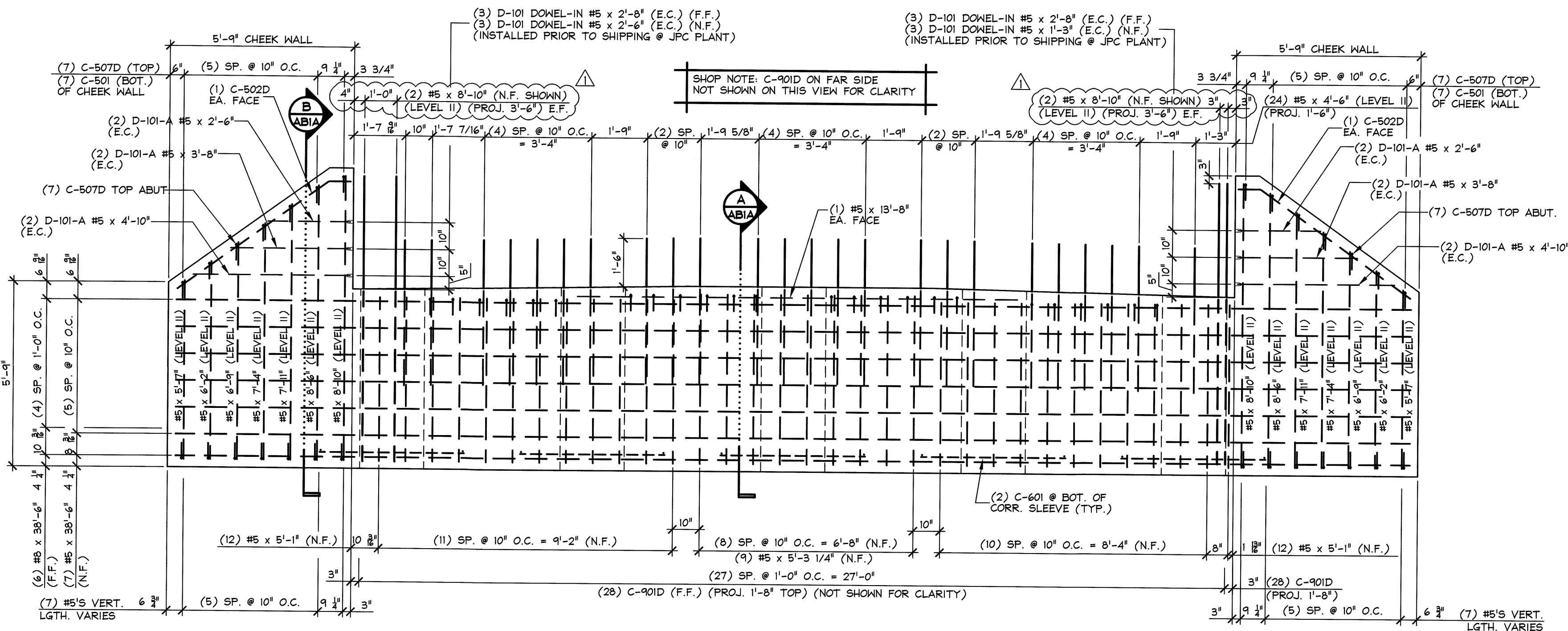

NON MARK FACE ELEVATION

1 ABUTMENT REINFORCING DETAILS
ABIA
3/8" = 1'-0"

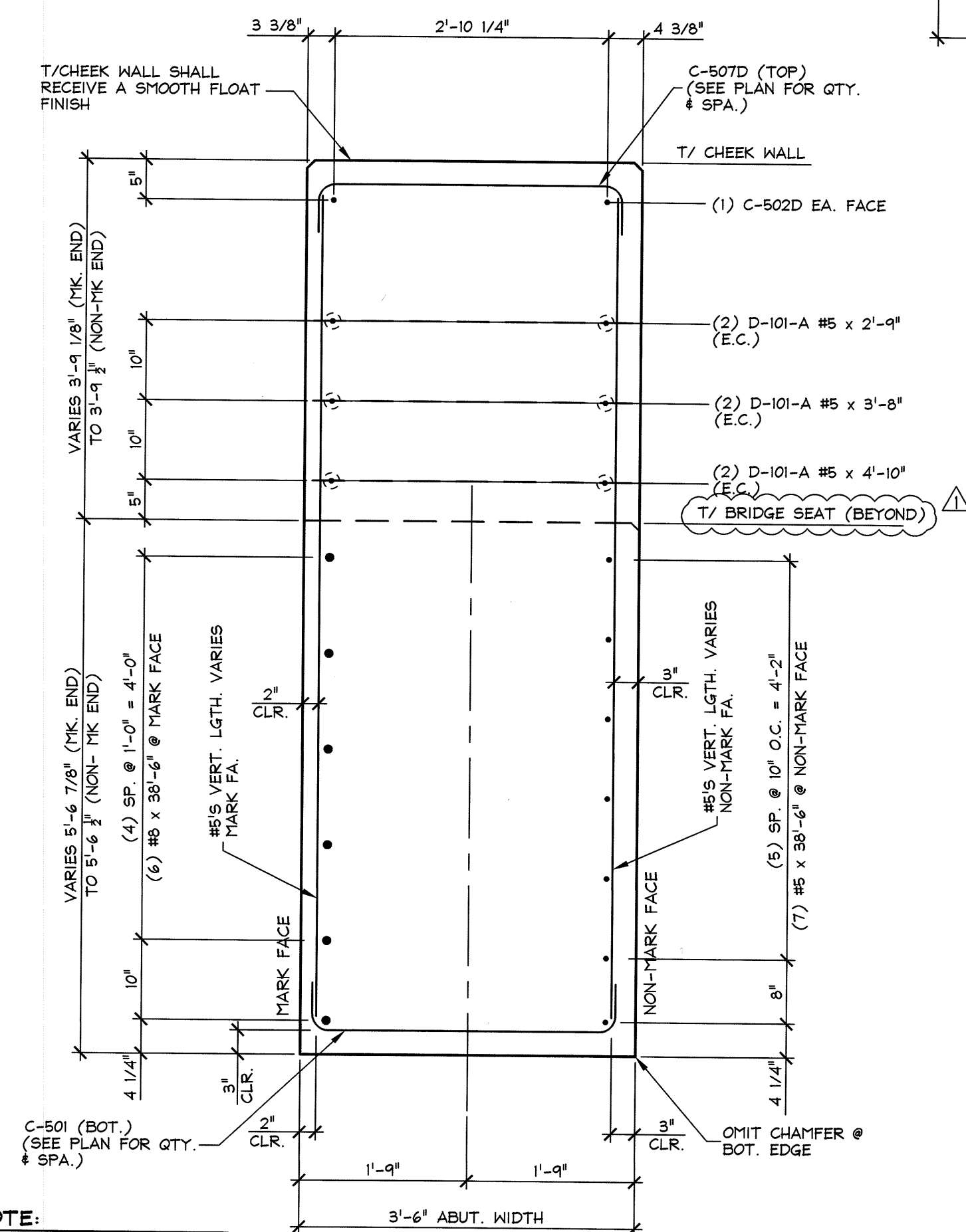

SHOP NOTE:
ALL EDGES OF ABUTMENT SHALL
RECEIVE A 1" CHAMFER (U.N.O.)

B ABUTMENT SECTION
ABIA (C-ABI)
3/4" = 1'-0"

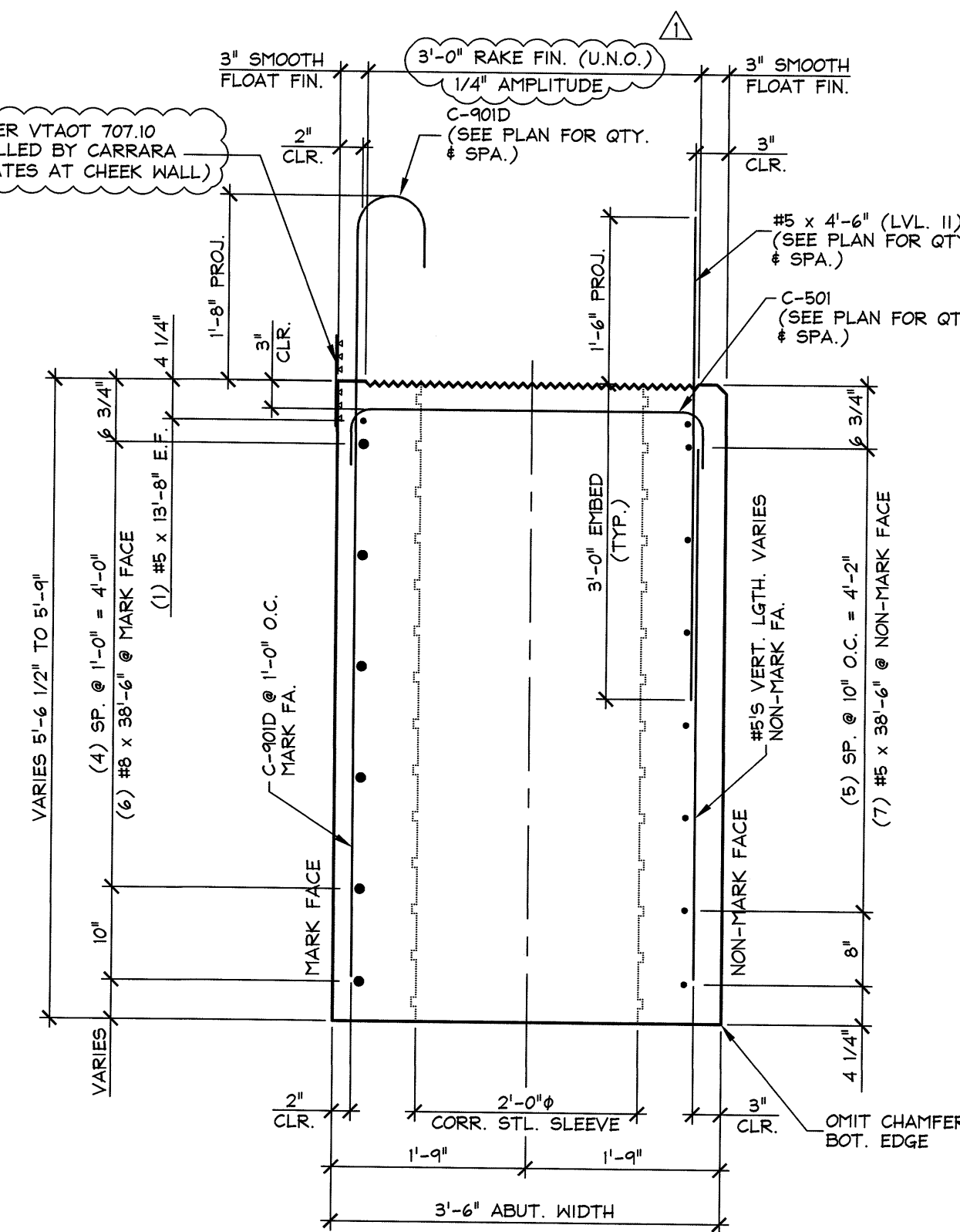

A ABUTMENT SECTION
ABIA (C-ABI)
3/4" = 1'-0"

SHOP NOTE:
ALL EDGES OF ABUTMENT SHALL
RECEIVE A 1" CHAMFER (U.N.O.)

MARK: C-ABI QTY.: 1 WT.: 57.71 T VOL.: 28.50 cy

MATERIAL LIST / ABUTMENT			
ITEM	MARK	DESCRIPTION	QTY.
1		DAYTON D-101-A #5 x 2'-6" (EPOXY COATED)	4
2		DAYTON D-101-A #5 x 3'-8" (EPOXY COATED)	4
3		DAYTON D-101-A #5 x 4'-10" (EPOXY COATED)	4
4			
5		DAYTON D-101 DOWEL-IN #5 x 2'-8" (EPOXY COATED)	6
6		DAYTON D-101 DOWEL-IN #5 x 2'-6" (EPOXY COATED)	3
7		DAYTON D-101 DOWEL-IN #5 x 1'-3" (EPOXY COATED)	3
8			
9	C-501	#5 BENT BAR (LEVEL I)	38
10	C-502D	#5 BENT BAR (LEVEL II, DUAL COATED)	4
11	C-507D	#5 BENT BAR (LEVEL II, DUAL COATED)	14
12	C-601	#6 BENT BAR (LEVEL I)	10
13	C-901D	#9 BENT BAR (LEVEL II, DUAL COATED)	25
14		#5 x 38'-6" (LEVEL I)	6
15		#5 x 38'-6" (LEVEL I)	7
16		#5 x 13'-8" (LEVEL I)	2
17		#5 x 8'-10" (LEVEL II, DUAL COATED)	12
18		#5 x 8'-6" (LEVEL II DUAL COATED)	4
19		#5 x 7'-11" (LEVEL II, DUAL COATED)	4
20		#5 x 7'-4" (LEVEL II, DUAL COATED)	4
21		#5 x 6'-9" (LEVEL II, DUAL COATED)	4
22		#5 x 6'-2" (LEVEL II DUAL COATED)	4
23		#5 x 5'-7" (LEVEL II DUAL COATED)	4
24		#5 x 5'-3 1/4" (LEVEL I)	9
25		#5 x 5'-1" (LEVEL I)	24
26		#5 x 4'-6" (LEVEL II, DUAL COATED)	24
27			

3/11/16 REVISED AS PER ENGINEERS COMM. T.D.

APPROVAL STAMP:
Vermont Agency of Transportation
RECEIVED

CK'D BY SC, TM OK'D BY G. Laroche

March 18, 2016

RESUBMIT No Approved
BY K. Higgins DATE 3/28/2016

J.P. CARRARA & SONS INC.
Precast & Prestress Manufacturer
2484 OASE STR., MIDDLEBURY, VERMONT 05753 Phone: (802)388-6361 Fax: (802)388-9010

J.A. McDonald, Inc.
CONTRACTOR
LYNDON CENTER, VERMONT

STATE OF VERMONT AGENCY OF TRANSPORTATION
COUNTY OF RUTLAND

TOWN OF CLARENDON
WALKER MOUNTAIN ROAD, TH #3, RURAL COLLECTOR
BRIDGE NO.: 11 PROJECT NO.: BRO 1443(4B)

DATE: JAN. 8, 2016
SCALE: NOTED
CHKD: DFTM: T.D.
JOB NO: 23476-015

PRECAST ABUTMENT DETAILS
DWG. NO: ABIA