

**NOTES**

1. SEE SHEET 23 FOR NOTES THAT APPLY TO THIS SHEET.

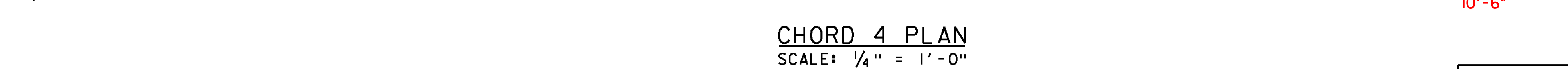
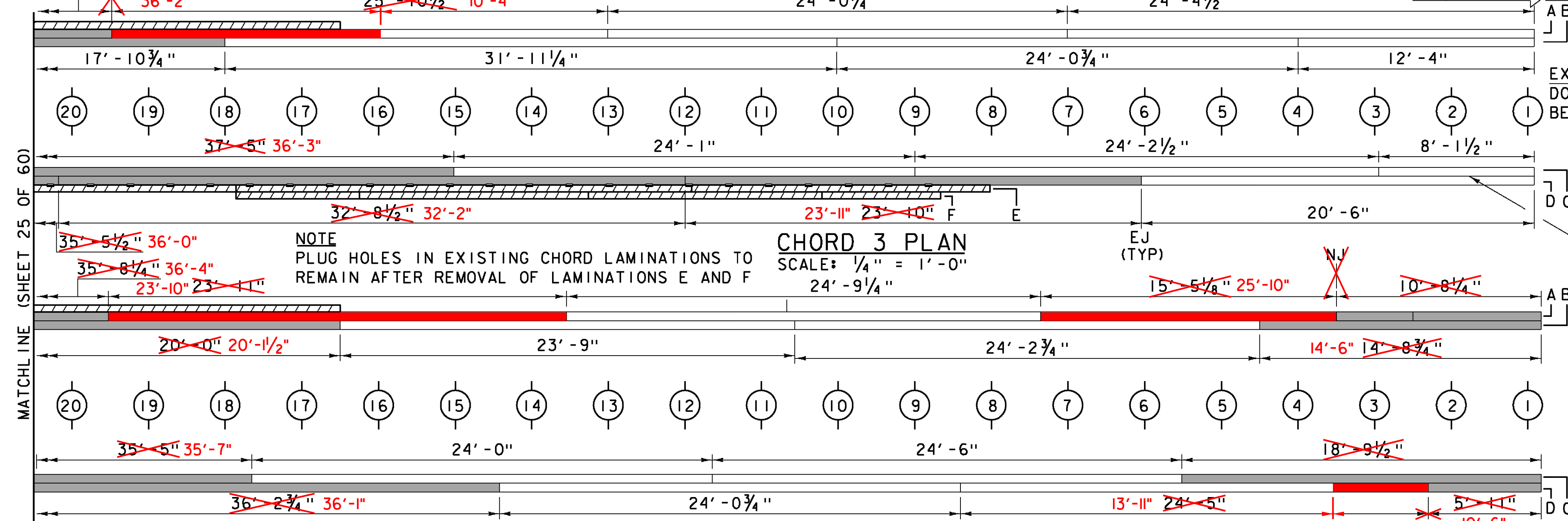
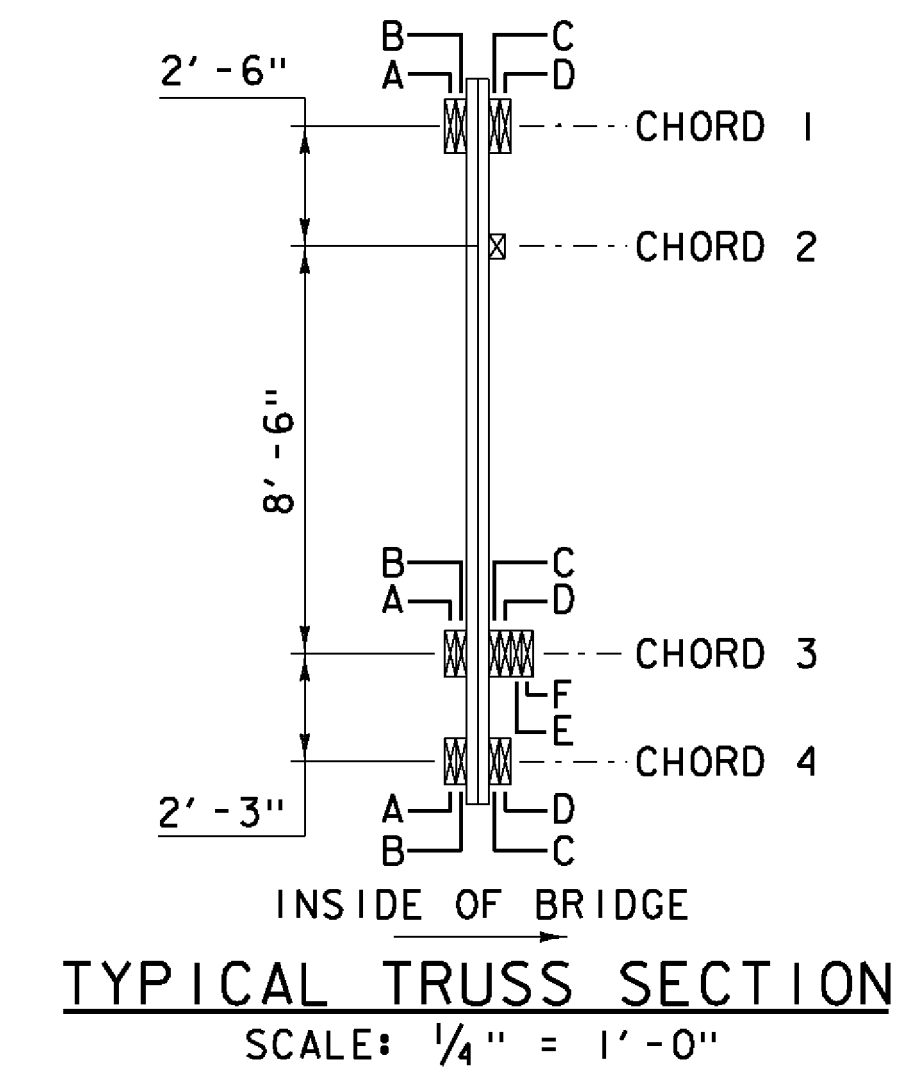
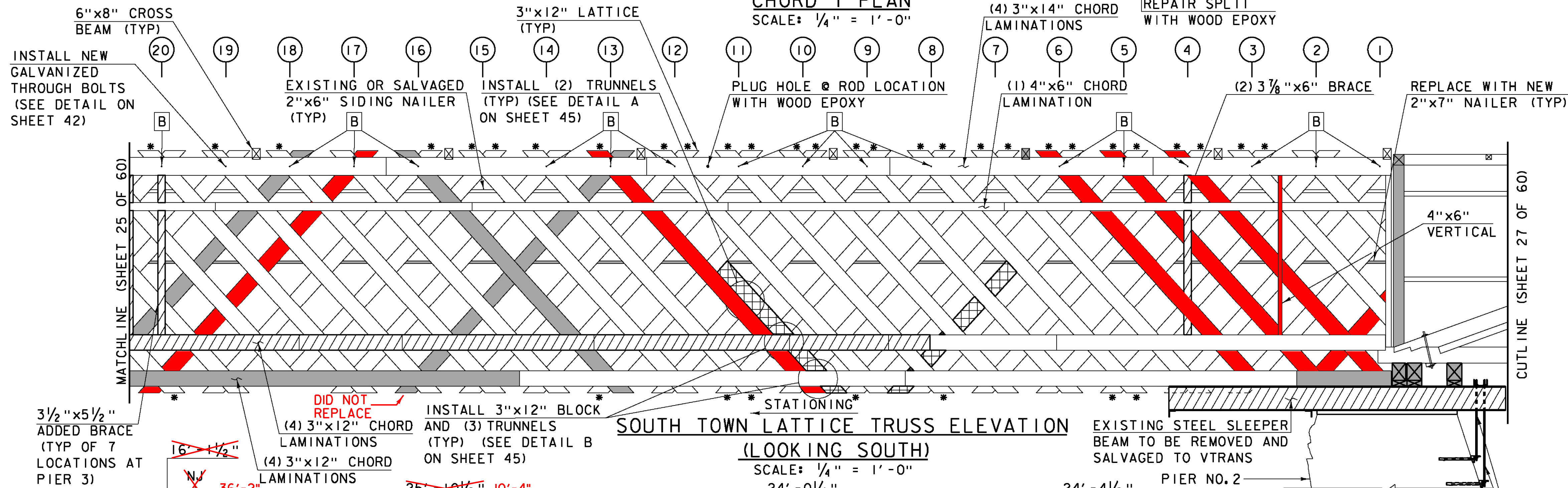

**LEGEND**

- PREDETERMINED MEMBER TO BE REPLACED
- PREDETERMINED MEMBER TO BE REMOVED
- ~~NO~~ **INSTALL** NEW SISTER MEMBER **INSTALLED** (SEE DETAIL A AND DETAIL B ON SHEET 45)
- TRUSS NODE LOCATION
- EXISTING CHORD JOINT
- NEW CHORD JOINT
- DENOTES SPLIT IN LATTICE MEMBER TO BE REPAIRED (SEE DETAILS ON SHEET 42)
- EXISTING THROUGH BOLT (SEE DETAIL ON SHEET 42)

PROJECT NAME: TOWNSHEND

PROJECT NUMBER: STP SCTT(I)

FILE NAME: 904225supll.dgn  
 PROJECT LEADER: M.D.SARGENT  
 DESIGNED BY: J.C.RIPLEY

PLOT DATE: 8/13/2015  
 DRAWN BY: T.A.GELINAS  
 CHECKED BY: S.T.JAMES  
 SHEET 26 OF 60

**Hoyle, Tanner & Associates, Inc.**

HTA PROJECT	MODEL
904225	904225supll

8/13/2015 1:00:25 PM C:\Users\jcr\OneDrive\904225supll.dgn