

NOTES
 1. SEE SHEET 23 FOR NOTES THAT APPLY TO THIS SHEET.

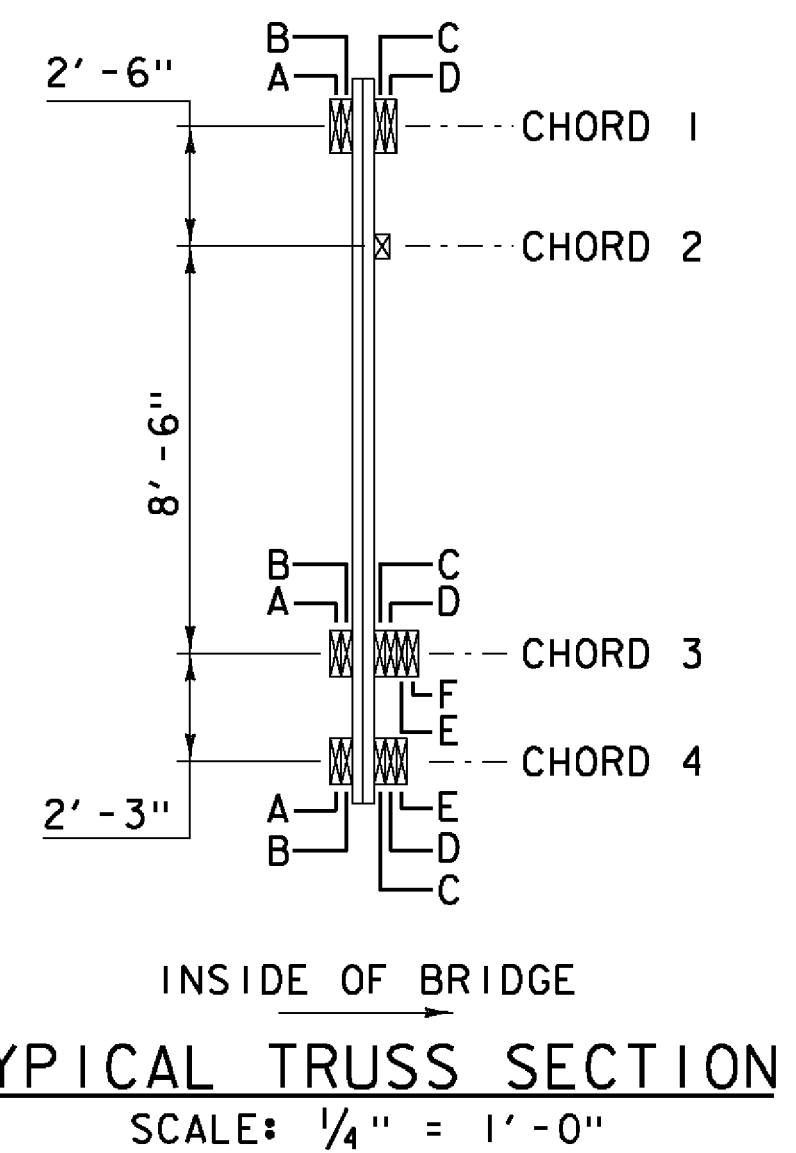

- LEGEND**
- PREDETERMINED MEMBER TO BE REPLACED
 - PREDETERMINED MEMBER TO BE REMOVED
 - INSTALL NEW SISTER MEMBER (SEE DETAIL A AND DETAIL B ON SHEET 45)
 - ⊗ TRUSS NODE LOCATION
 - EJ EXISTING CHORD JOINT
 - NJ NEW CHORD JOINT
 - * DENOTES SPLIT IN LATTICE MEMBER TO BE REPAIRED (SEE DETAILS ON SHEET 42)
 - [B] EXISTING THROUGH BOLT (SEE DETAIL ON SHEET 42)

PROJECT NAME: TOWNSHEND
 PROJECT NUMBER: STP SCTT(I)
 FILE NAME: 904225supl2.dgn
 PROJECT LEADER: M.D.SARGENT
 DESIGNED BY: J.C.RIPLEY
SOUTH TRUSS ELEVATION (1 OF 3)
 PLOT DATE: 8/13/2015
 DRAWN BY: T.A.GELINAS
 CHECKED BY: S.T.JAMES
 SHEET 25 OF 60

Hoyle, Tanner & Associates, Inc.

HTA PROJECT	MODEL
904225	904225supl2

8/13/2015 1:30:42 PM I:\904225\supl2.dgn