

1 ABUTMENT #2 ELEVATION
F3
1/2" = 1'-0"

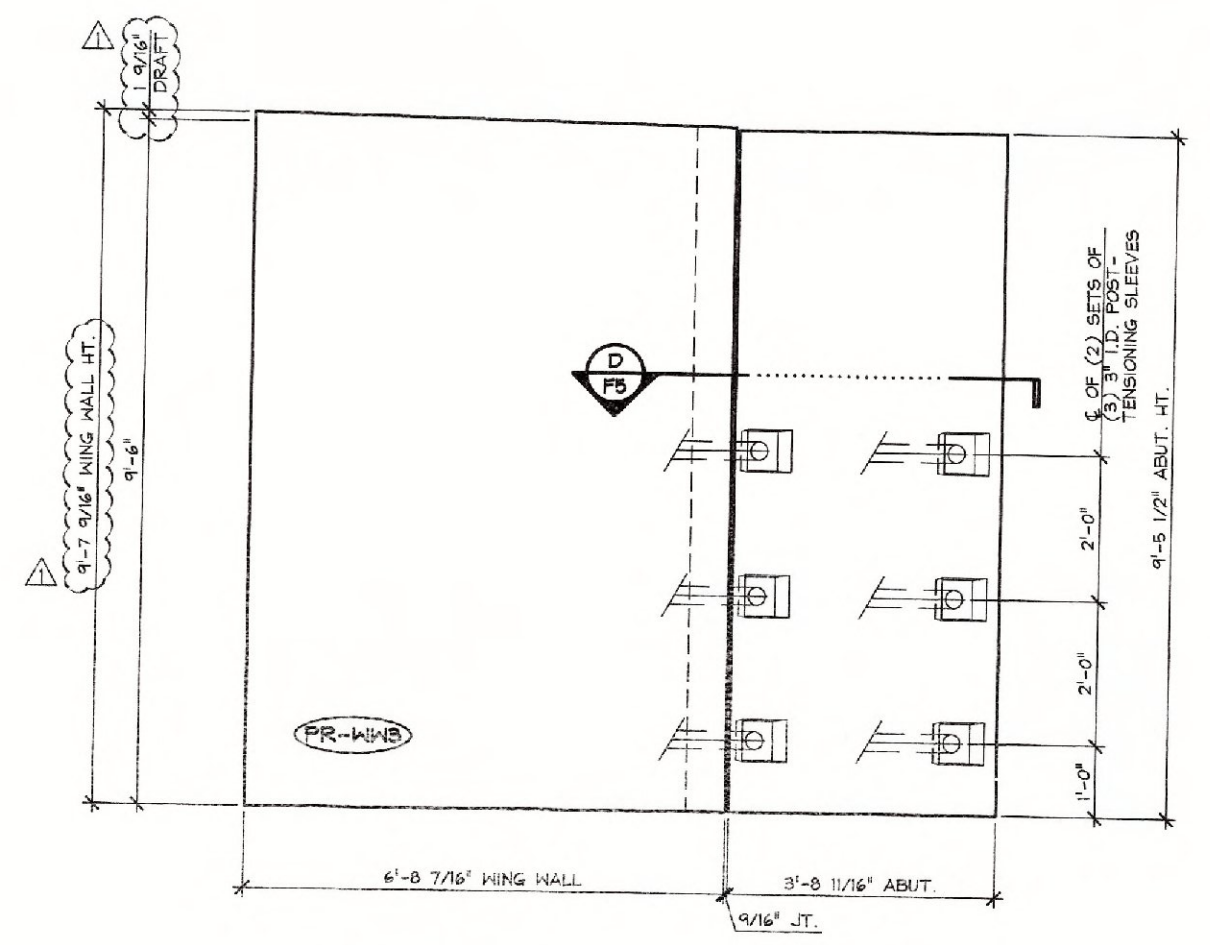

2 WING WALL ELEVATION "PR-WW3"
F3
1/2" = 1'-0"

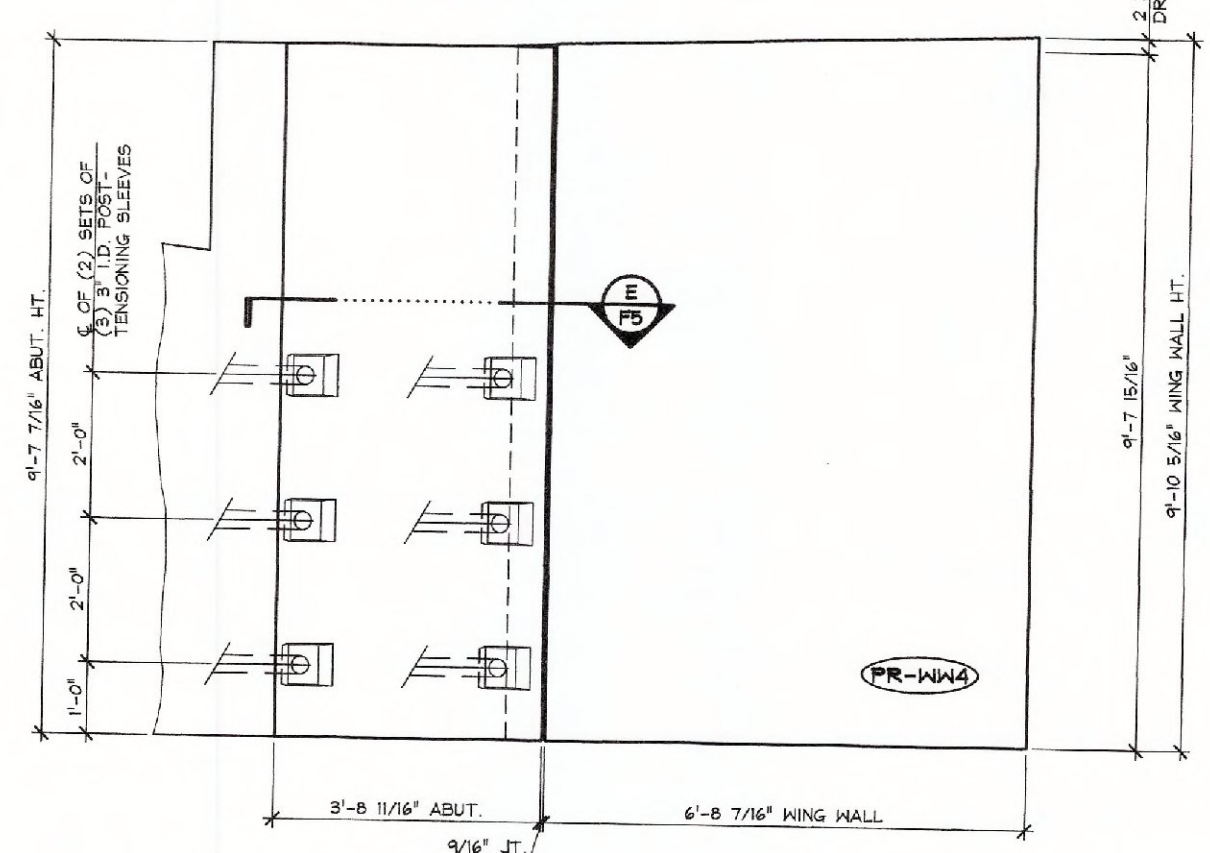

3 WING WALL ELEVATION "PR-WW4"
F3
1/2" = 1'-0"

Vermont Agency of Transportation
RECEIVED
ON: February 19, 2015
and Checked for
CONFORMANCE
BY: T. A. Sumner DATE: 02/25/15

SHOP DRAWING REVIEW
 REVIEWED AS REQUIRED BY THE CONSTRUCTION CONTRACT DOCUMENTS AND APPROVED FOR CONFORMANCE TO THE DESIGN CONCEPT OF THE PROJECT AND GENERAL COMPLIANCE WITH THE DESIGN CONCEPT OF THE PROJECT AND DOCUMENTS. THE CONTRACTOR IS RESPONSIBLE FOR CORRECTING OR CONSULTING WITH THE DESIGNER ON THE SHOP DRAWINGS BEFORE THE REVIEW DOES NOT RELIEVE CONTRACTOR FROM COMPLIANCE WITH REQUIREMENTS OF THE CONTRACT DOCUMENTS AND SPECIFICATIONS. THIS CHECK IS ONLY FOR REVIEW OF GENERAL COMPLIANCE WITH THE DESIGN CONCEPT OF THE PROJECT AND DOCUMENTS. THE CONTRACTOR IS RESPONSIBLE FOR CORRECTING OR CONSULTING WITH THE DESIGNER ON ALL QUANTITIES AND DIMENSIONS. SELECTING UNAPPROVED PRODUCTS AND TECHNIQUES OF CONSTRUCTION. CONTRACTOR SHALL NOTIFY WITHIN 10 DAYS OF ALL OTHER TRADES AND SUBCONTRACTORS THEIR WORK IN A SAFE AND SATISFACTORY MANNER.
 12-0175
 NBC
 2/20/15

2-12-15 REVISED PER VT AOT COMMENTS

APPROVAL STAMP:	J.P. CARRARA & SONS INC. Precast & Prestress Manufacturer 2448 OAK ST., MIDDLEBURY, VERMONT 05752 Phone: (802)338-6191 Fax: (802)338-9010	J.P. SICARD, INC. CONTRACTOR BARTON, VERMONT
STATE OF VERMONT AGENCY OF TRANSPORTATION COUNTY OF ORANGE	TOWN OF RANDOLPH TOWN HIGHWAY 65 (PALMER ROAD) CLASS 3 LOCAL ROAD BRIDGE NO.: 35 PROJECT NO.: BRO 1444(57)	DATE: NOV. 18, 2014 SCALE: NOTED CHKD: B.C. DFTM: B.L. JOB NO: 23449-014
PRECAST ABUTMENT #2 ELEVATIONS	DWG. NO: F3	