

STA 39+50.00
BEGIN APPROACH

SOIL INFORMATION:
BUCKLAND FINE SANDY LOAM,
K = 0.37, VERY STONY,
HIGHLY ERODIBLE
HYDROLOGIC SOIL GROUP: C

STA 40+50.00
BEGIN PROJECT

SOIL INFORMATION:
BUCKLAND FINE SANDY LOAM,
K = 0.37, VERY STONY,
HIGHLY ERODIBLE
HYDROLOGIC SOIL GROUP: C

STA 45+50.00
END PROJECT

STA 46+50.00
END APPROACH

SOIL INFORMATION:
CABOT SILT LOAM, VERY STONY
K = 0.28,
POTENTIALLY HIGHLY ERODIBLE
HYDROLOGIC SOIL GROUP: D

NOTE
SEE SHEET 13 FOR CONVENTIONAL SYMBOLY LEGEND.

PROJECT NAME: BARTON
PROJECT NUMBER: BRO 1449(31)

FILE NAME: IJ068/cos/zlj068bdreroex.dgn PLOT DATE: 12/17/2014
PROJECT LEADER: J. BYATT DRAWN BY: M. HALEY
DESIGNED BY: M. HALEY CHECKED BY: P. SHEDD
EPSC EXISTING PLAN SHEET SHEET 48 OF 52

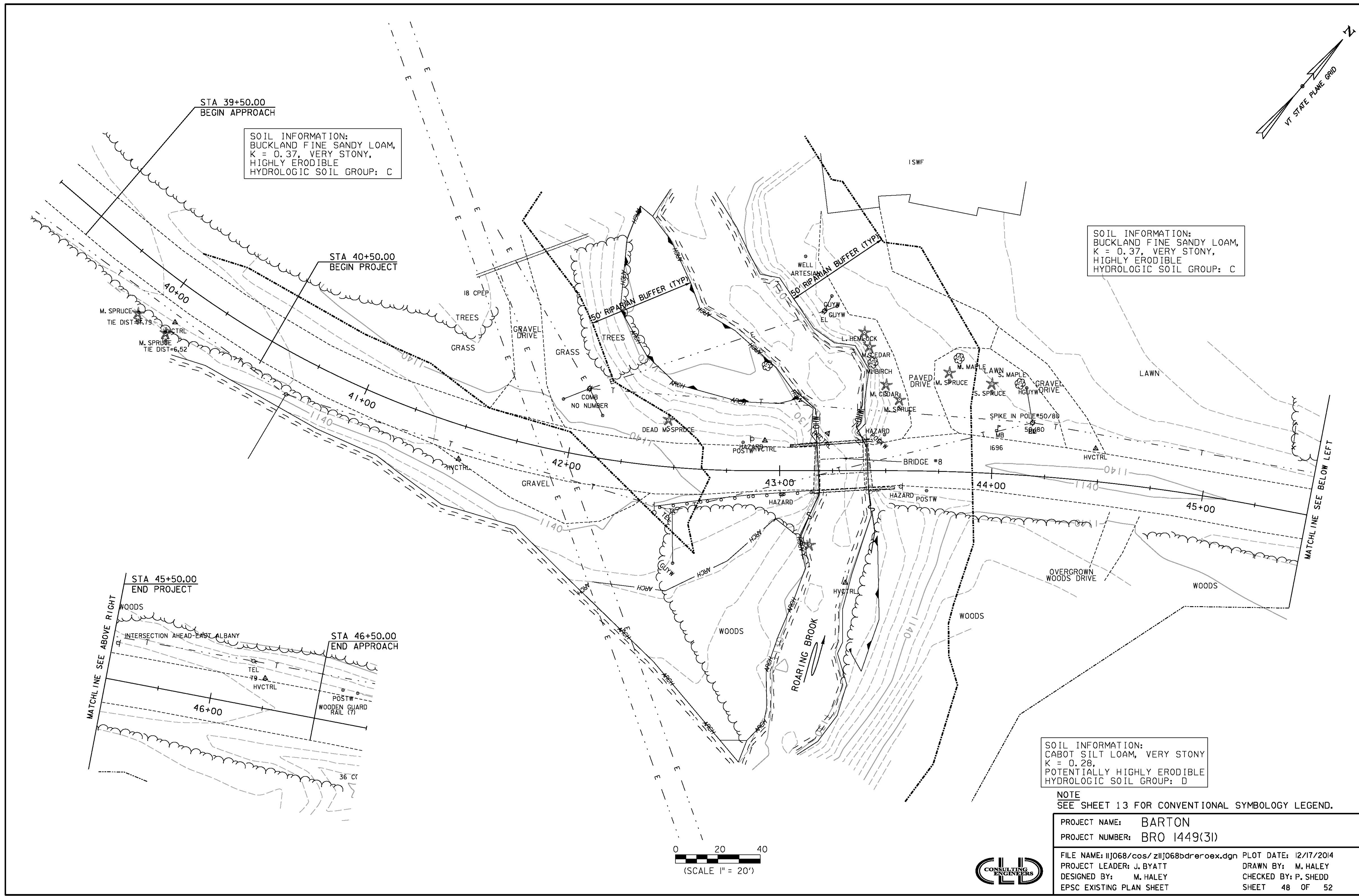
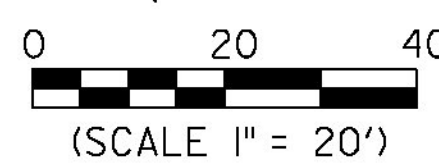

MATCH LINE SEE ABOVE RIGHT

MATCH LINE SEE BELOW LEFT