

### TOWN OF LYNDON



BEGINNING AT THE INTERSECTION OF US ROUTE 5 BROAD STREET (CLASS I) AND CENTER STREET (TH-2) IN THE TOWN OF LYNDON DESIGNATING THE INTERSECTION WHERE THE CENTERLINE OF EACH ROAD INTERSECTS WITH EACH OTHER AS MILE MARKER 0.000 AND EXTENDING 0.673 MILES WESTERLY ALONG CENTER STREET TO THE POINT WHERE KING DRIVE (TH-88) INTERSECTS WITH CENTER STREET.

ALSO ON ANOTHER ROADWAY, BEGINNING AT THE INTERSECTION OF US ROUTE 5 MEMORIAL DRIVE AND BACK CENTER ROAD (TH-10) IN THE TOWN OF LYNDON DESIGNATING THE INTERSECTION WHERE THE CENTERLINE OF EACH ROAD INTERSECTS WITH EACH OTHER AS MILE MARKER 0.000 AND EXTENDING NORTHERLY ALONG BACK CENTER ROAD 1.402 MILES TO A POINT WHERE BACK CENTER ROAD ENDS AND INTERSECTS WITH CENTER STREET. THESE SEGMENTS CONCLUDE THIS PORTION OF THIS PROJECT.

### TOWN OF PLAINFIELD

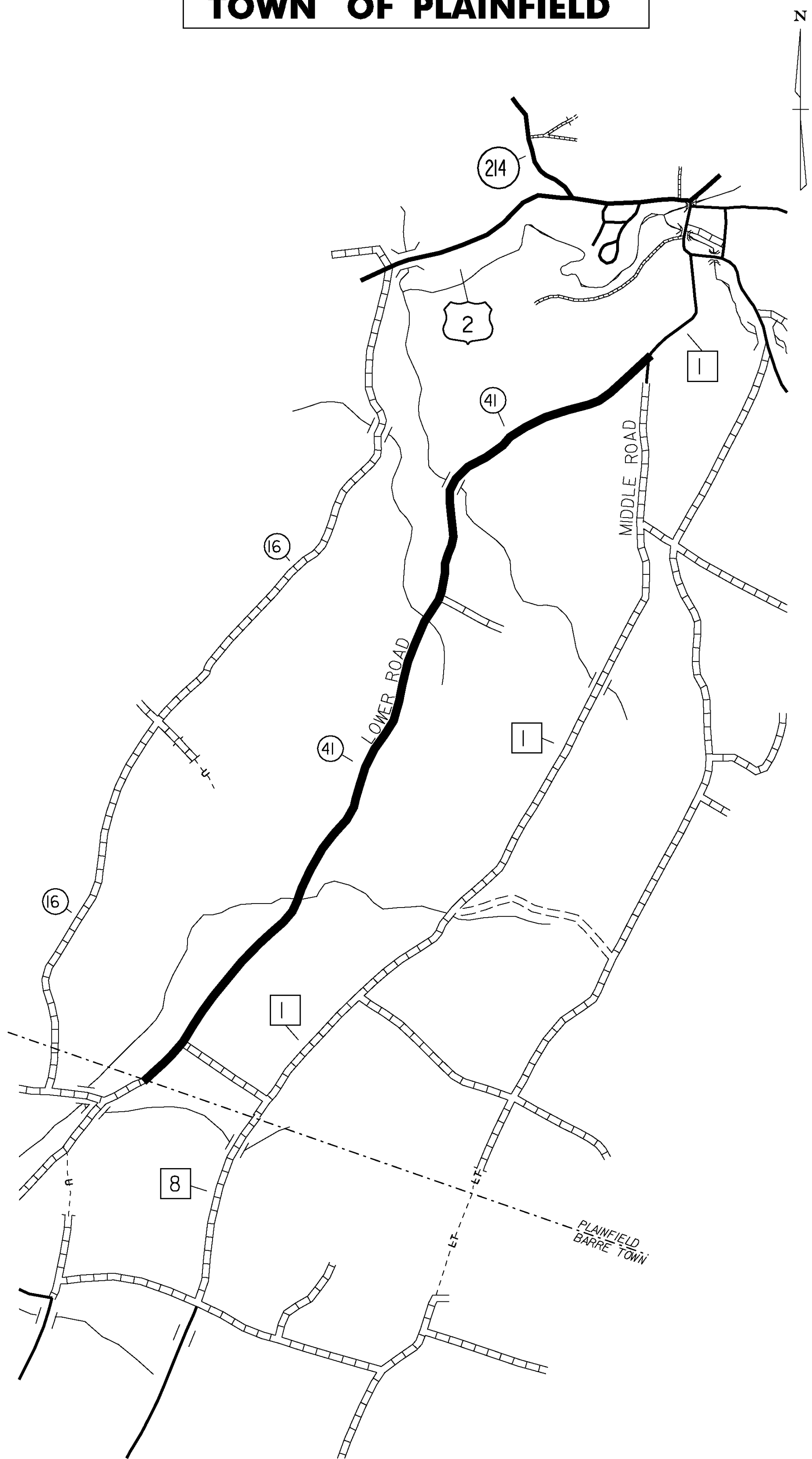

BEGINNING AT THE INTERSECTION OF MIDDLE ROAD (TH-1) AND LOWER ROAD (TH-4) IN THE TOWN OF PLAINFIELD, DESIGNATING WHERE THE CENTERLINE OF EACH ROAD INTERSECTS WITH EACH OTHER AS MILE MARKER 0.000 AND EXTENDING SOUTHWESTERLY ALONG LOWER ROAD FOR A DISTANCE OF 3.500 MILES TO THE PLAINFIELD - BARRE TOWN LINE TO CONCLUDE THIS SEGMENT FOR THIS PROJECT.

### TOWN OF WESTFIELD

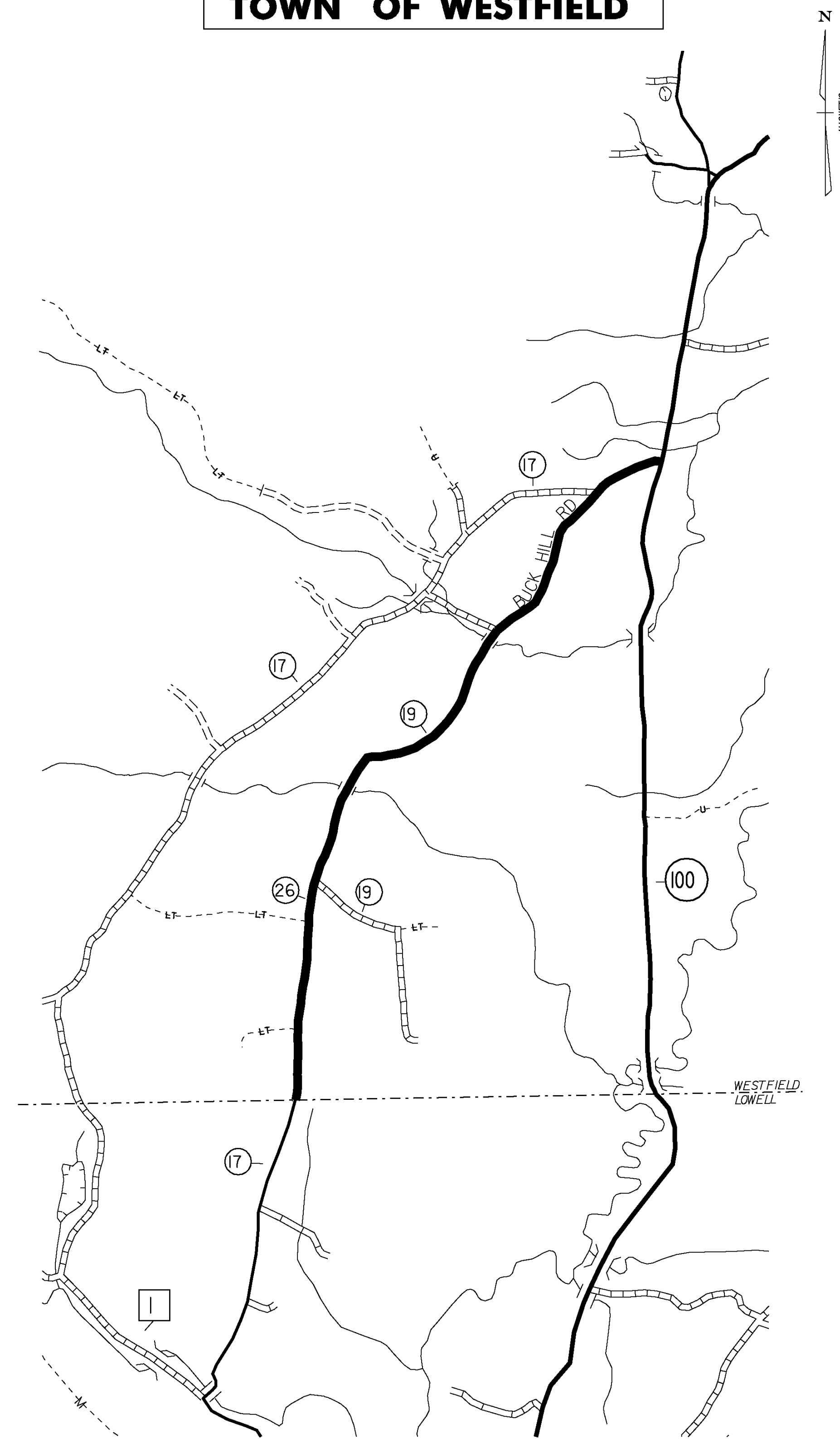

BEGINNING AT THE INTERSECTION OF VT 100 AND BUCK HILL ROAD (TH-19) IN THE TOWN OF WESTFIELD, DESIGNATING WHERE THE CENTERLINE OF EACH ROAD INTERSECTS WITH EACH OTHER AS MILE MARKER 0.000 AND EXTENDING SOUTHWESTERLY ALONG BUCK HILL ROAD FOR A DISTANCE OF 3.300 MILES TO THE WESTFIELD - LOWELL TOWN LINE TO CONCLUDE THIS SEGMENT FOR THIS PROJECT.

**NOT TO SCALE**

PROJECT NAME:	STATEWIDE NORTHEAST REGION	PLOT DATE:	14-MAY-2010
PROJECT NUMBER:	STP HRRR(4)	DRAWN BY:	I. SHEA
FILE NAME:	10K016_wrk.dgn	CHECKED BY:	JLS
PROJECT LEADER:	JLS	LOCATION MAPS 2	SHEET 4 OF 64
DESIGNED BY:	NLA		