

A PRECAST PIER CAP REINFORCING SECTION
PCI.1 @ SPLICE PLATE GIRDER SEGMENT 3/4" = 1'-0"

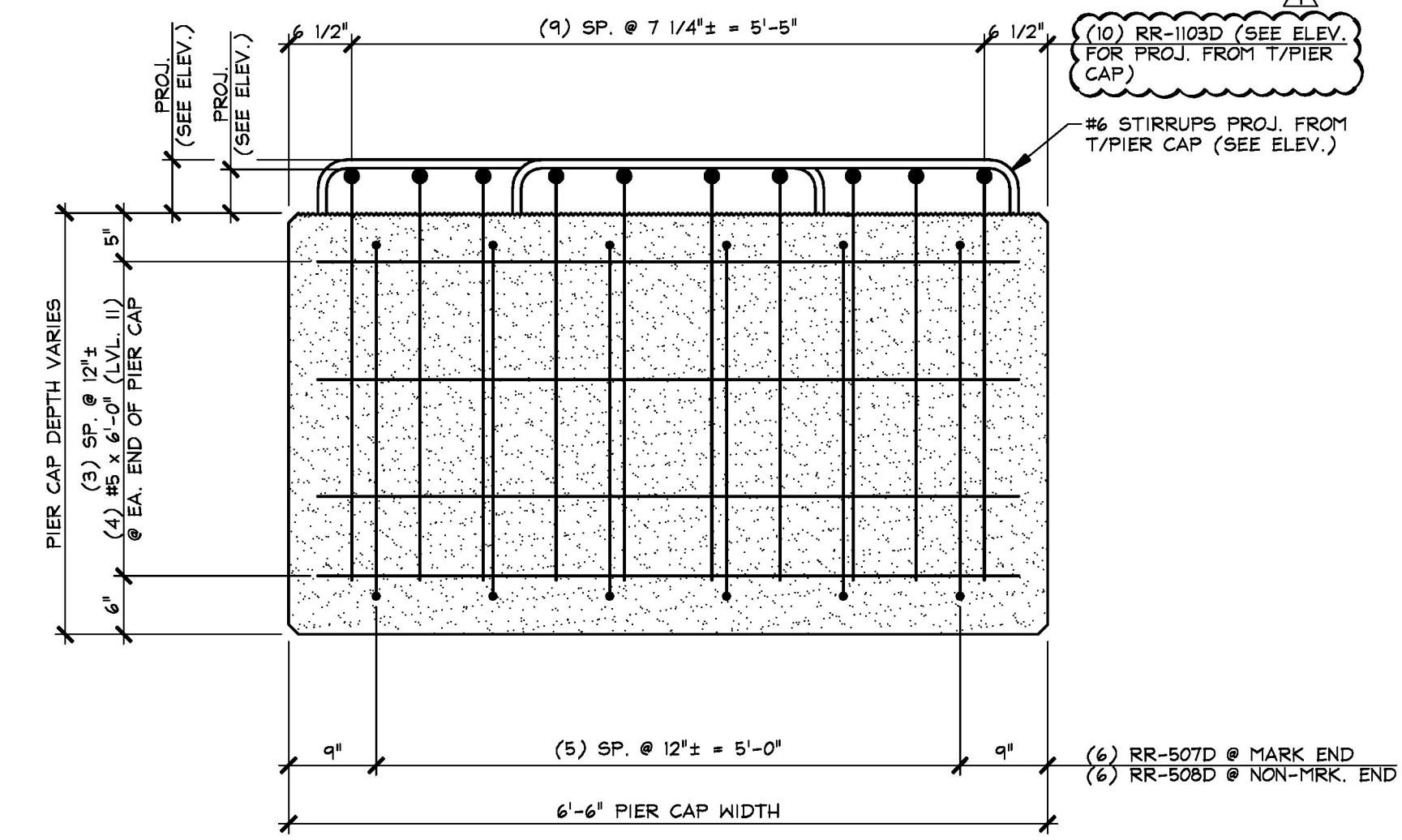

B PRECAST PIER CAP REINFORCING SECTION
PCI.1 @ PIER CAP END 3/4" = 1'-0"

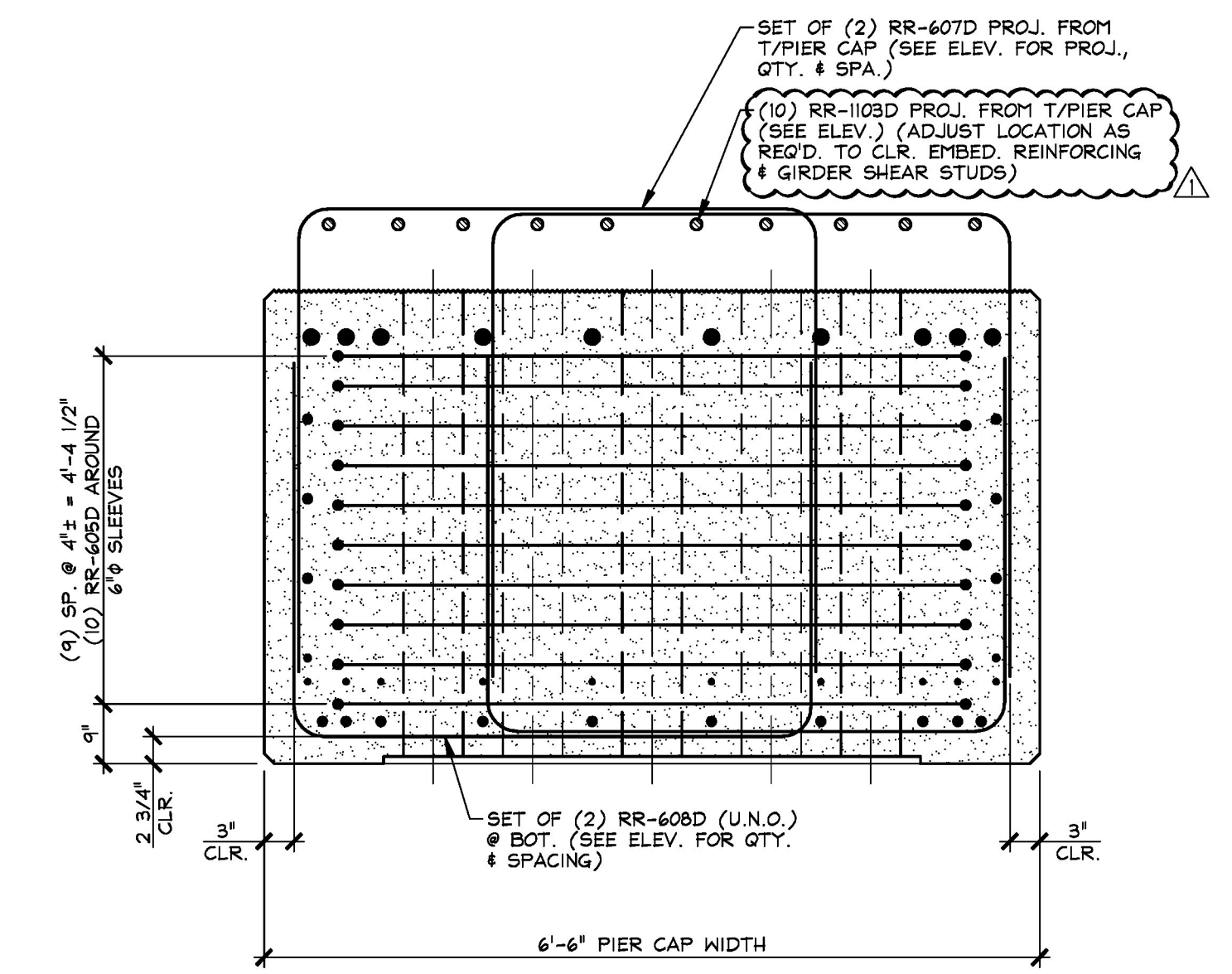

C PRECAST PIER CAP REINFORCING SECTION
PCI.1 @ 6" SLEEVES 3/4" = 1'-0"

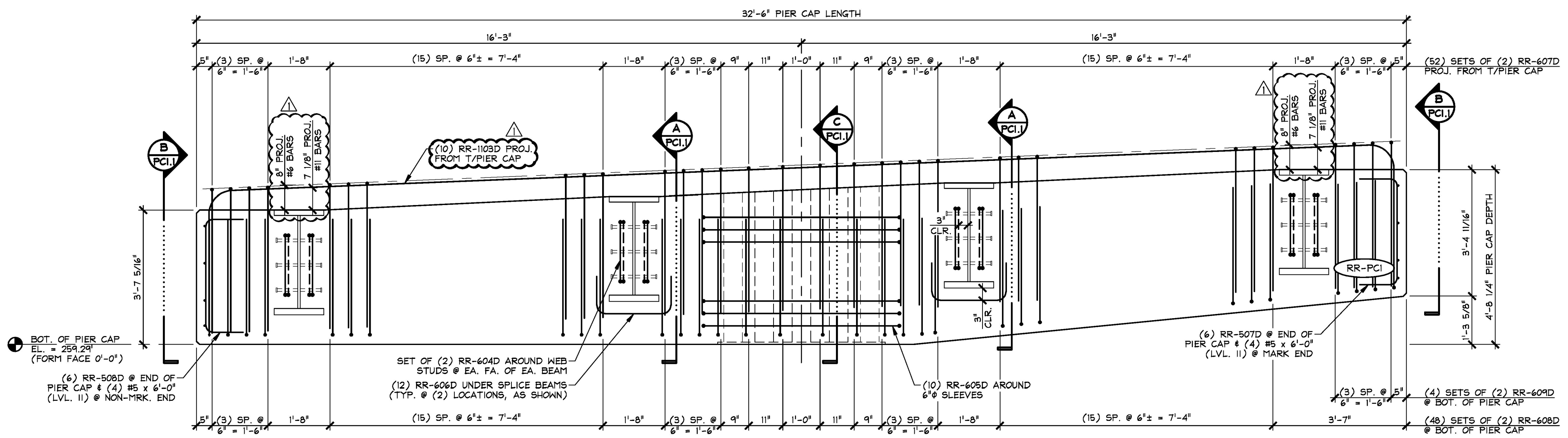

1 PRECAST PIER CAP REINFORCING ELEVATION
PCI.1 STIRRUPS 1/2" = 1'-0"

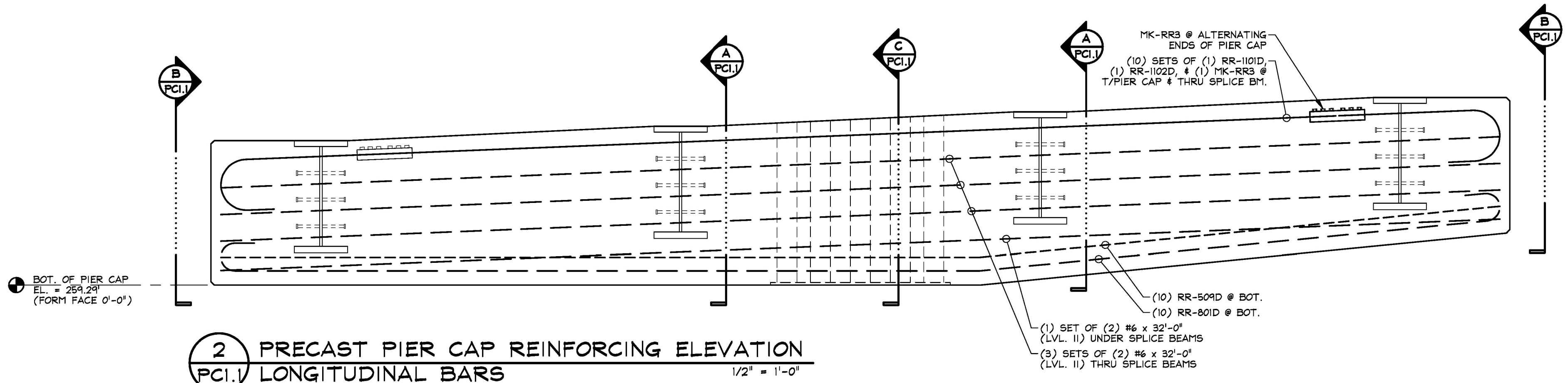

2 PRECAST PIER CAP REINFORCING ELEVATION
PCI.1 LONGITUDINAL BARS 1/2" = 1'-0"

MATERIAL LIST / PIER CAP			
ITEM	MARK	DESCRIPTION	QTY.
1	RR-507D	#5 BENT BAR (LEVEL II, DUAL COATED)	6
2	RR-508D	#5 BENT BAR (LEVEL II, DUAL COATED)	6
3	RR-509D	#5 BENT BAR (LEVEL II, DUAL COATED)	10
4		#5 x 6'-0" (LEVEL II, DUAL COATED)	8
5			
6	RR-604D	#6 BENT BAR (LEVEL II, DUAL COATED)	16
7	RR-605D	#6 BENT BAR (LEVEL II, DUAL COATED)	10
8	RR-606D	#6 BENT BAR (LEVEL II, DUAL COATED)	24
9	RR-607D	#6 BENT BAR (LEVEL II, DUAL COATED)	104
10	RR-608D	#6 BENT BAR (LEVEL II, DUAL COATED)	96
11	RR-609D	#6 BENT BAR (LEVEL II, DUAL COATED)	8
12		#6 x 32'-0" (LEVEL II, DUAL COATED)	8
13			
14	RR-801D	#8 BENT BAR (LEVEL II, DUAL COATED)	10
15			
16	MK-RR3	D-250 BAR-LOCK L-SERIES COUPLER, IIL (EPOXY COATED)	10
17	RR-1101D	#11 BENT BAR (LEVEL II, DUAL COATED)	10
18	RR-1102D	#11 BENT BAR (LEVEL II, DUAL COATED)	10
19	RR-1103D	#11 BENT BAR (LEVEL II, DUAL COATED)	10
20	RR-1104D	#11 BENT BAR (LEVEL II, DUAL COATED)	10

12-2-15 REVISED PER GENERAL CONTRACTOR'S ENGINEER REVIEW

APPROVAL STAMP:	J.P. CARRARA & SONS INC. Precast & Prestress Manufacturer 2464 OSE STR., MIDDLEBURY, VERMONT 05753 Phone: (802)388-6361 Fax: (802)388-9010	CCS CONSTRUCTORS, INC. CONTRACTOR MORRISVILLE, VERMONT
	STATE OF VERMONT AGENCY OF TRANSPORTATION COUNTY OF ADDISON	
	TOWN OF NEW HAVEN T.H. 2 (RIVER ROAD) (CLASS 2 - MAJOR COLLECTOR) BRIDGE NO.: 10 PROJECT NO.: BRP 0183 (1)	
	PRECAST PIER CAP REINFORCING DETAILS	
	DATE: OCT. 15, 2015	
	SCALE: NOTED	
	CHKD: A.S. DFTM: B.L.	
	JOB NO: 23475-015	
	DWG. NO: PCI.1	