

1 PRECAST CONCRETE PIER CAP PLAN
F5
1/2" = 1'-0"

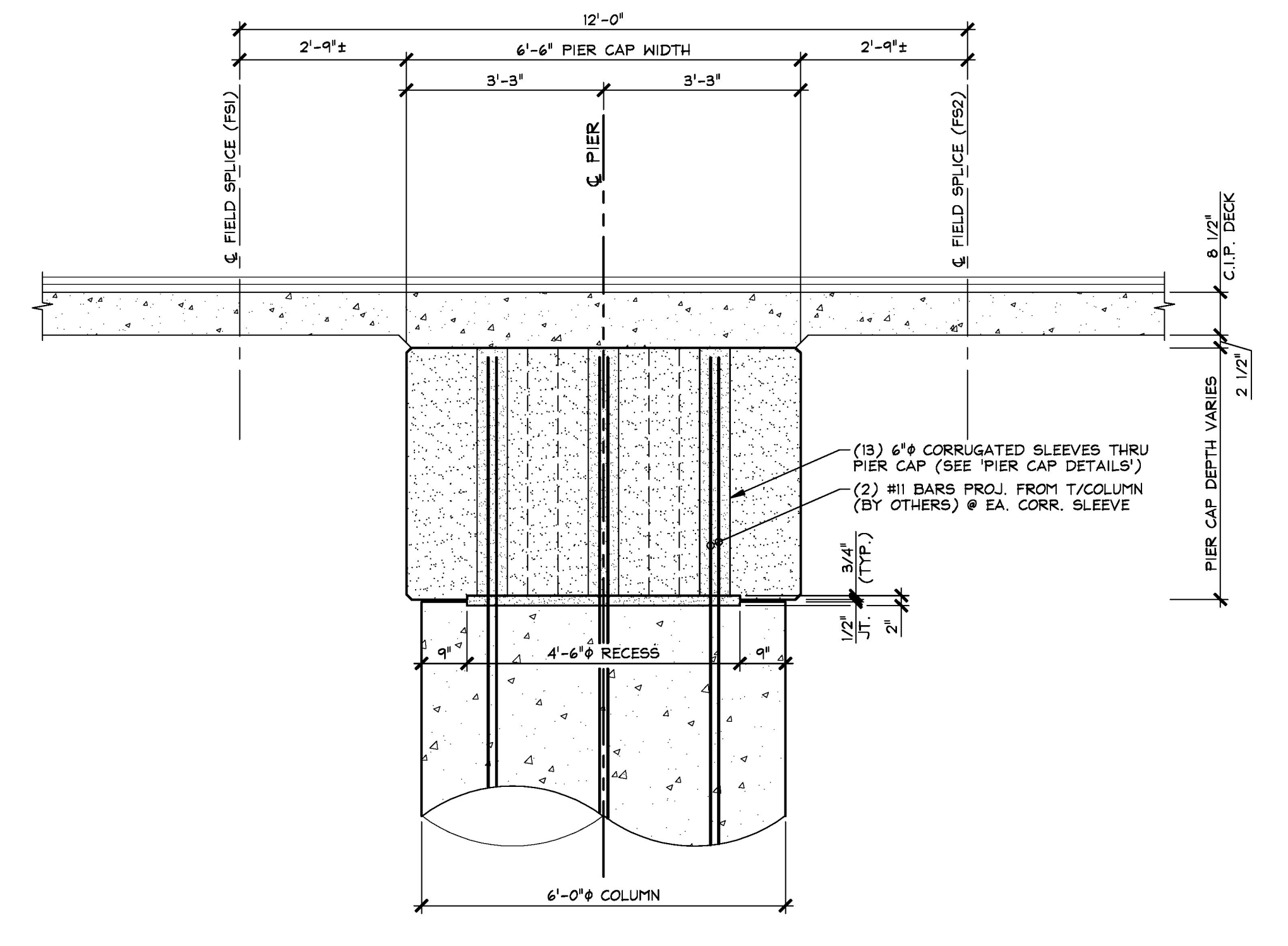

A PIER CAP SECTION AT COLUMN
F5
1/2" = 1'-0"

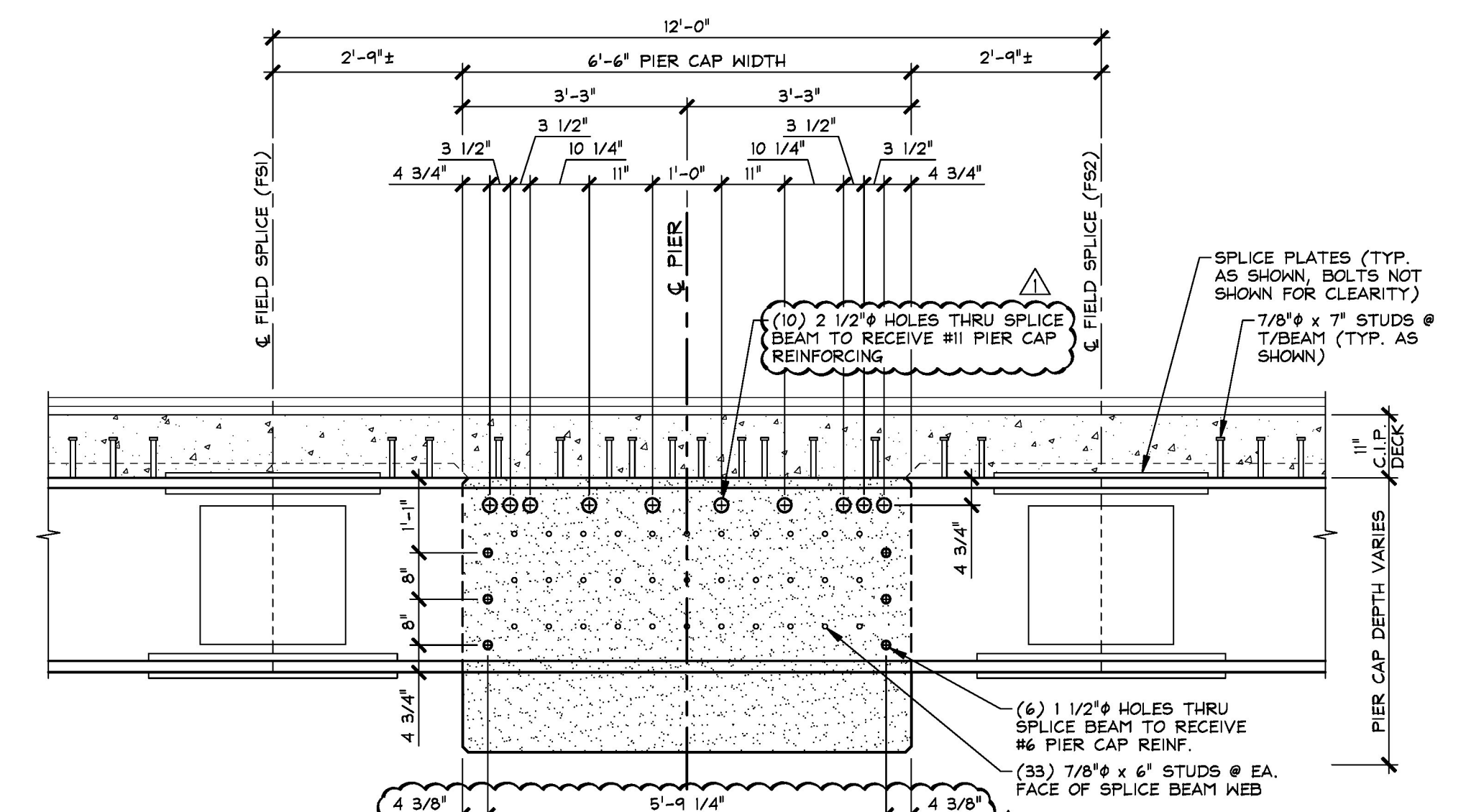

B PIER CAP SECTION SPLICE BEAM
F5
1/2" = 1'-0"

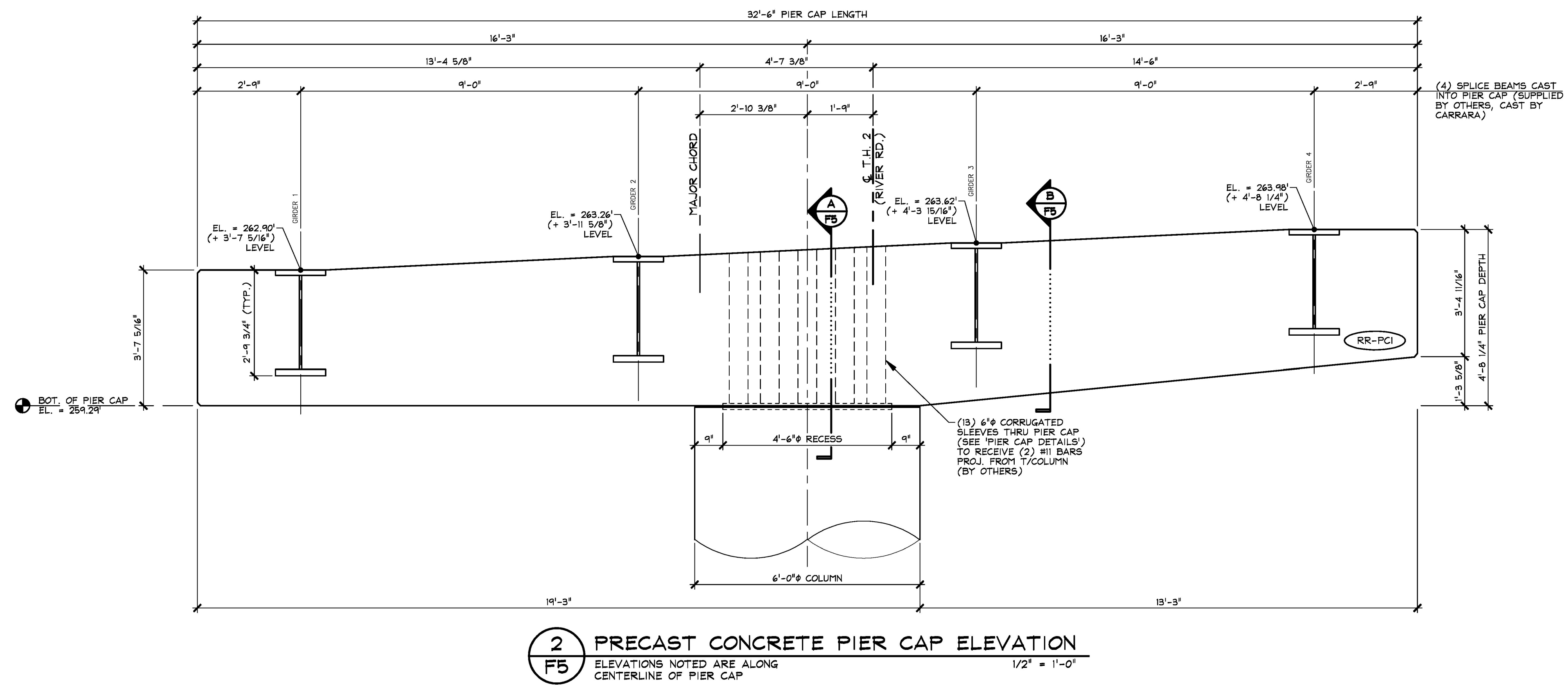

2 PRECAST CONCRETE PIER CAP ELEVATION
F5
ELEVATIONS NOTED ARE ALONG CENTERLINE OF PIER CAP
1/2" = 1'-0"

12-2-15 REVISED PER GENERAL CONTRACTOR'S ENGINEER REVIEW

APPROVAL STAMP:	J.P. CARRARA & SONS INC. Precast & Prestress Manufacturer 2464 OASE STR., MIDDLEBURY, VERMONT 05753 Phone: (802)388-6361 Fax: (802)388-9810	CCS CONSTRUCTORS, INC. CONTRACTOR MORRISVILLE, VERMONT
	STATE OF VERMONT AGENCY OF TRANSPORTATION COUNTY OF ADDISON	DATE: OCT. 15, 2015 SCALE: NOTED
	TOWN OF NEW HAVEN T.H. 2 (RIVER ROAD) (CLASS 2 - MAJOR COLLECTOR) BRIDGE NO.: 10 PROJECT NO.: BRP 0183 (1)	CHKD: A.S. DFTM: B.L. JOB NO: 23475-015
	PRECAST PIER CAP LAYOUT, ELEVATIONS & SECTIONS	DWG. NO: F5