

PILE CAP
 $f'_c = 4000 \text{ PSI}$ $f'_w = 3000 \text{ PSI}$
 $WT = 67.96 \text{ T} = 135.92 \text{ K}$

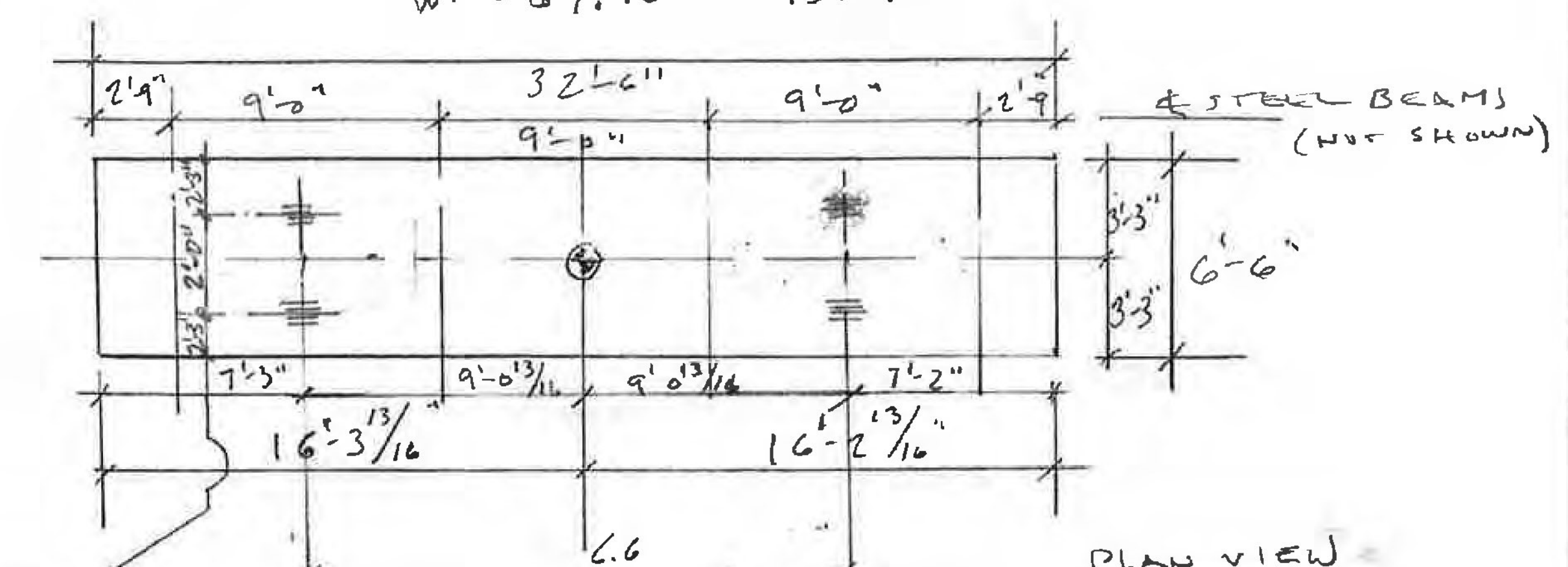

▲
 TWO (4) 0.600" X 270K LIFT
 STRAIN LIFT LOOPS
 #11 EMBL 3'-0"
 $T = 33.98 \text{ K/LOOP}$
 TYP 4 LOC

THESE ARE TWO LIFT LOOPS @ EACH END
 LONG/LIFT LOOPS = $135.92 / 2 \times 2 = 33.98 \text{ K}$

FROM ATTACHED PRODUCT LITERATURE, TABLE 5.2.3 (SEE ASSEMBLY CALL)

USE (A) 0.600" STRAIN LIFT LOOPS, #11 EMBLMENT 3'-0"

$SWL (4:1 S.F.) = 1.1 \times 41 = 45.1 \text{ K} > 33.98 \text{ K}, \text{ O.K.}$

ALSO CHECK USING PCI FIG 6.15.7.1 CASE 6, ATTACHED (SEE ASSEMBLY CALL)

$\phi P_{c1} = 0.85 \times 2.07 \times \sqrt{3000} (78) (92) / 1000 = 892 \text{ K}$; 92" IS DISTANCE BETWEEN FLANGE!

FOR 4:1 S.F.

$SWL = 892 / 4 = 223 \text{ K} > 2 \times 33.98 = 68 \text{ K}, \text{ O.K.}$

NOTE: TOP UP LIFT LOOPS TO BE SUCH THAT A LEVEL PICK CAN BE MADE