

TOWN HIGHWAY 2
CURVE #1
Delta = 44°08'45"
D = 7°50'55"
R = 730.00'
T = 296.02'
L = 562.46'
E = 57.74'
BANKING = 4%

TOWN HIGHWAY 34
CURVE #1
DELTA = 42°44'46"
D = 22°55'06"
R = 250.00'
T = 97.84'
L = 186.52'
E = 18.46'

SIGN DETAILS

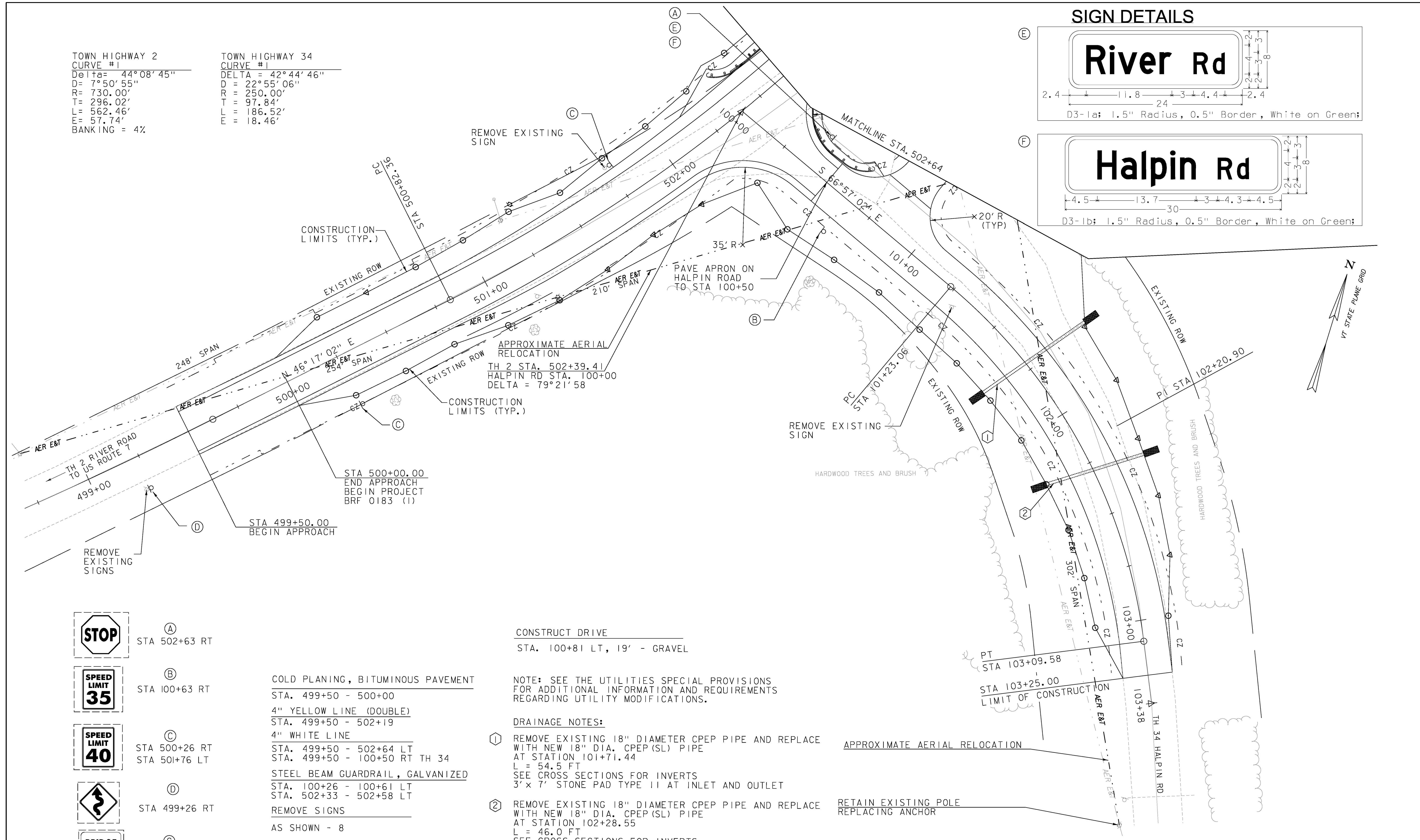
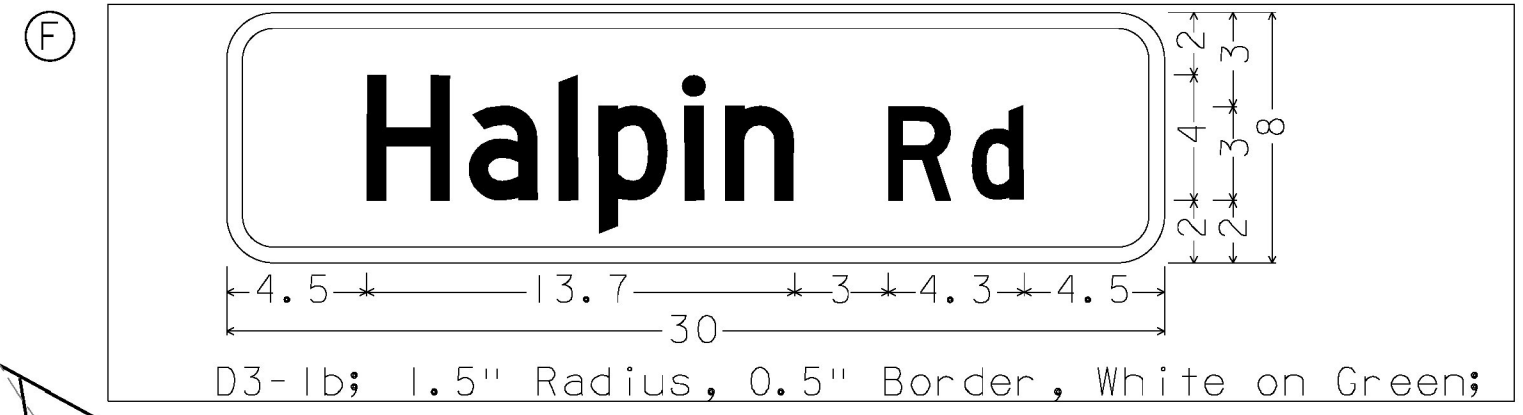
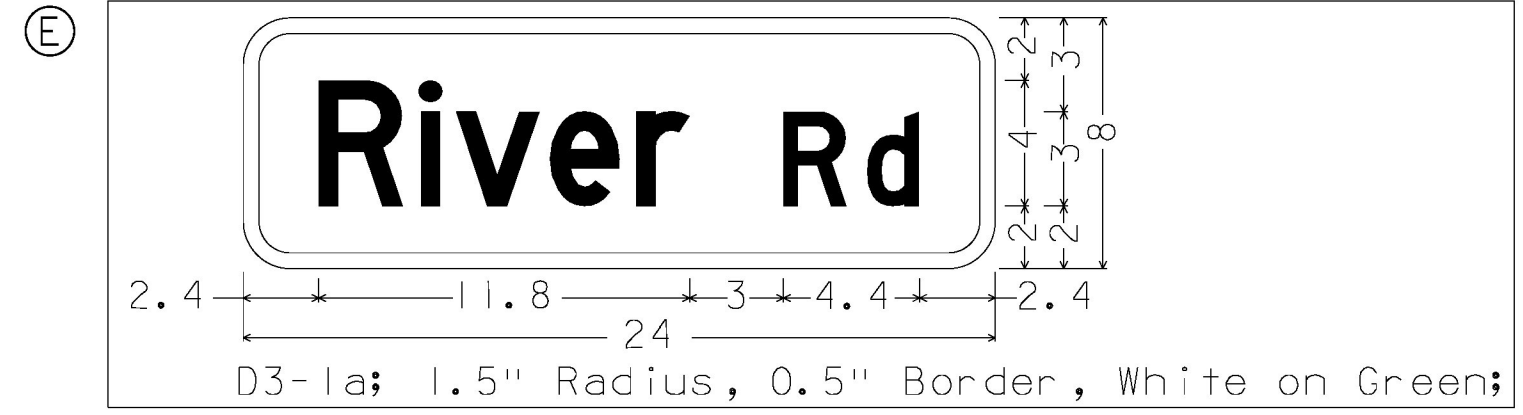

① STA 502+63 RT



② STA 100+63 RT



③ STA 500+26 RT
STA 501+76 LT

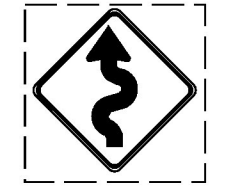

④ STA 499+26 RT

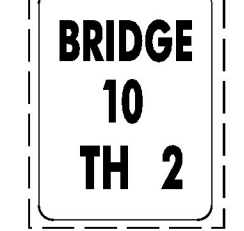

⑤ STA 502+75 RT
STA 504+75 RT

COLD PLANING, BITUMINOUS PAVEMENT
STA. 499+50 - 500+00
4" YELLOW LINE (DOUBLE)
STA. 499+50 - 502+19
4" WHITE LINE
STA. 499+50 - 502+64 LT
STA. 499+50 - 100+50 RT TH 34
STEEL BEAM GUARDRAIL, GALVANIZED
STA. 100+26 - 100+61 LT
STA. 502+33 - 502+58 LT
REMOVE SIGNS
AS SHOWN - 8

CONSTRUCT DRIVE
STA. 100+81 LT, 19' - GRAVEL

NOTE: SEE THE UTILITIES SPECIAL PROVISIONS FOR ADDITIONAL INFORMATION AND REQUIREMENTS REGARDING UTILITY MODIFICATIONS.

DRAINAGE NOTES:

- ① REMOVE EXISTING 18" DIAMETER CPEP PIPE AND REPLACE WITH NEW 18" DIA. CPEP (SL) PIPE AT STATION 101+71.44
L = 54.5 FT
SEE CROSS SECTIONS FOR INVERTS
3' x 7' STONE PAD TYPE II AT INLET AND OUTLET
- ② REMOVE EXISTING 18" DIAMETER CPEP PIPE AND REPLACE WITH NEW 18" DIA. CPEP (SL) PIPE AT STATION 102+28.55
L = 46.0 FT
SEE CROSS SECTIONS FOR INVERTS
3' x 7' STONE PAD TYPE II AT INLET AND OUTLET

APPROXIMATE AERIAL RELOCATION

RETAIN EXISTING POLE REPLACING ANCHOR

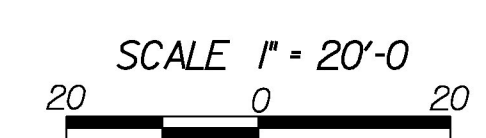

PROJECT NAME: NEW HAVEN
PROJECT NUMBER: BRF 0183 (1)

FILE NAME: z10j070bdr.dgn
PROJECT LEADER: G.K. DONINGTON
DESIGNED BY: P. ARMANO
LAYOUT SHEET (1)

PLOT DATE: 23-JUNE-2015
DRAWN BY: P. ARMANO
CHECKED BY: R. BENJAMIN
SHEET 13 OF 67