

TRAFFIC CONTROL PHASE 1

1. INSTALL TEMPORARY TRAFFIC SIGNS AND BARRELS AS SHOWN.
2. INITIATE AND MAINTAIN SINGLE LANE ALTERNATING ONE-WAY TRAFFIC THROUGHOUT DURATION OF PHASE 1.
3. REMOVE EXISTING POLE AT STA 504+65 RT 21' AND UTILIZE BLASTING AS NECESSARY TO PLACE NEW POLE.
4. FOLLOW MUTCD AND VTRANS STANDARDS WHEN BLASTING.
5. INSTALLATION OF TEMPORARY TRAFFIC SIGNS AND BARRELS, AND REMOVAL OF EXISTING POLE SHALL BE PAID FOR UNDER ITEM 641.10 TRAFFIC CONTROL.

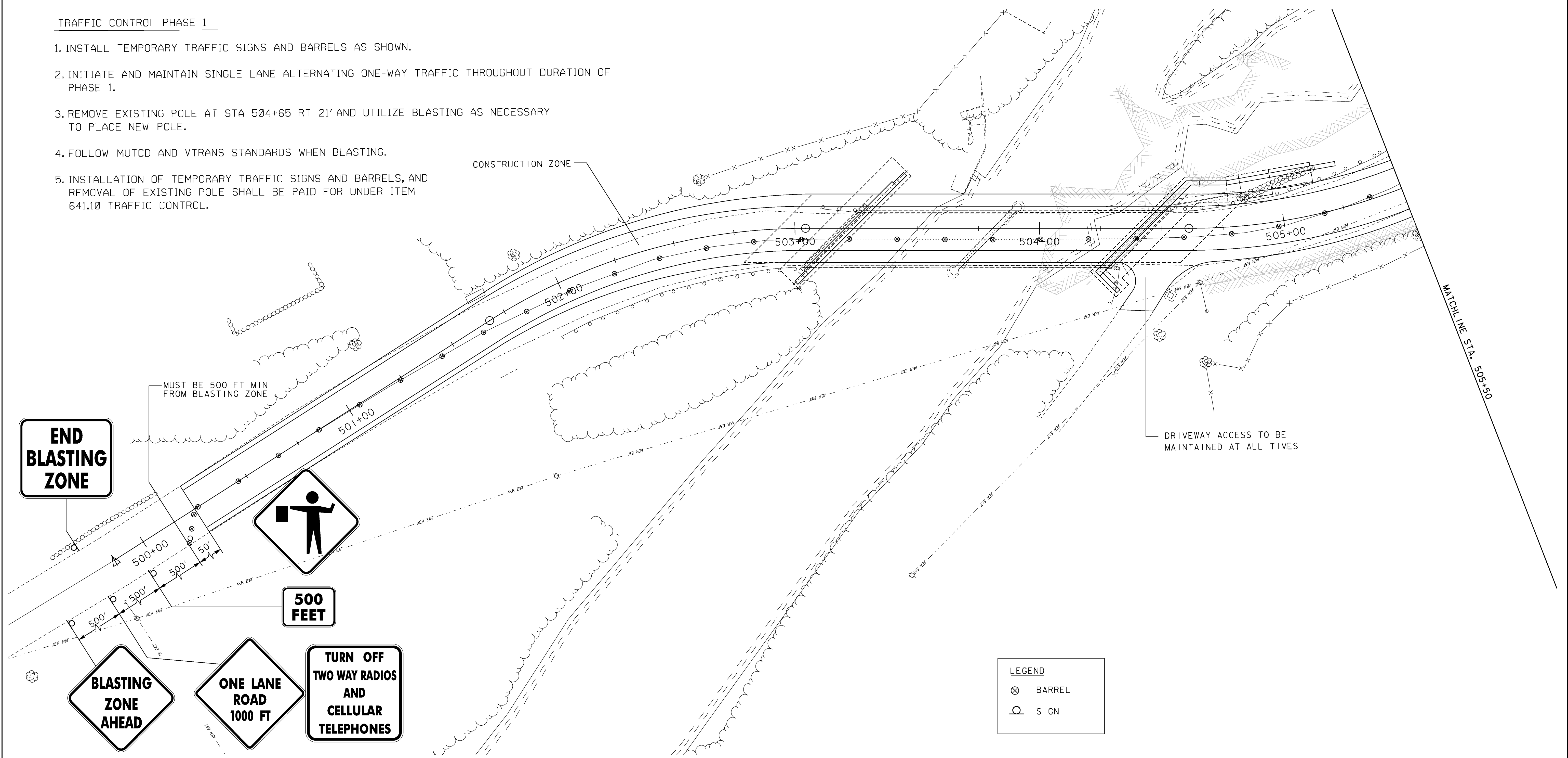

**LEGEND**

- ⊗ BARREL
- SIGN

PROJECT NAME:	LINCOLN	FILE NAME:	z10j066+cs_2d.dgn	PLOT DATE:	8-DEC-2014
PROJECT NUMBER:	BRF 0188 (8)	PROJECT LEADER:	G.K. DONINGTON	DRAWN BY:	J. KHERA
		DESIGNED BY:	J. KHERA	CHECKED BY:	R. BENJAMIN
		TRAFFIC CONTROL PHASE I SHEET I		SHEET 14	OF 62

**PB**  
125 YEARS

**PARSONS BRINCKERHOFF**  
650 ELM STREET  
MANCHESTER, NH 03101