

HALE ROAD (T.H. 10)
 CURVE NO. 1 DATA
 $\Delta = 4^\circ 34' 56.70''$
 $D = 5^\circ 43' 46.48''$
 $R = 1000.00'$
 $T = 40.01'$
 $L = 79.98'$
 $E = 0.80'$
 BANK = NORMAL CROWN

HALE ROAD (T.H. 10)
 CURVE NO. 2 DATA
 $\Delta = 29^\circ 15' 49.39''$
 $D = 47^\circ 44' 47.34''$
 $R = 120.00'$
 $T = 31.33'$
 $L = 61.29'$
 $E = 4.02'$
 BANK = NORMAL CROWN

HALE ROAD (T.H. 10)
 CURVE NO. 3 DATA
 $\Delta = 4^\circ 08' 36.55''$
 $D = 3^\circ 10' 59.16''$
 $R = 1800.00'$
 $T = 65.11'$
 $L = 130.17'$
 $E = 1.18'$
 BANK = NORMAL CROWN

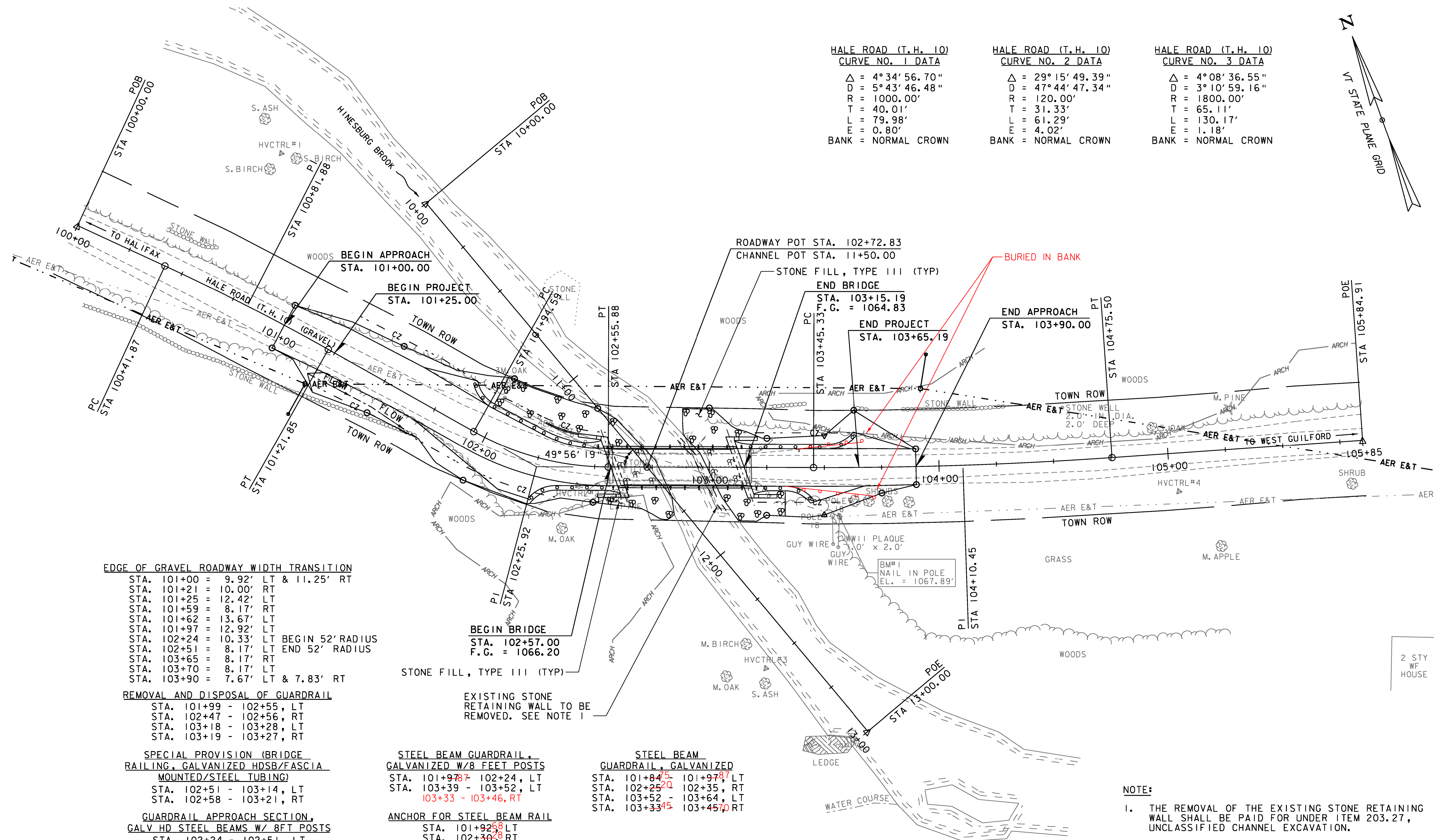
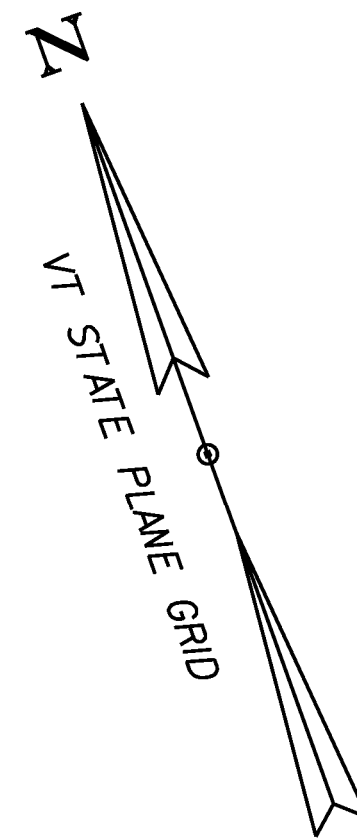

EDGE OF GRAVEL ROADWAY WIDTH TRANSITION

STA. 101+00	=	9.92' LT & 11.25' RT
STA. 101+21	=	10.00' RT
STA. 101+25	=	12.42' LT
STA. 101+59	=	8.17' RT
STA. 101+62	=	13.67' LT
STA. 101+97	=	12.92' LT
STA. 102+24	=	10.33' LT BEGIN 52' RADIUS
STA. 102+51	=	8.17' LT END 52' RADIUS
STA. 103+65	=	8.17' RT
STA. 103+70	=	8.17' LT
STA. 103+90	=	7.67' LT & 7.83' RT

REMOVAL AND DISPOSAL OF GUARDRAIL
 STA. 101+99 - 102+55, LT
 STA. 102+47 - 102+56, RT
 STA. 103+18 - 103+28, LT
 STA. 103+19 - 103+27, RT

SPECIAL PROVISION (BRIDGE RAILING, GALVANIZED HDSB/FASCIA MOUNTED/STEEL TUBING)
 STA. 102+51 - 103+14, LT
 STA. 102+58 - 103+21, RT

GUARDRAIL APPROACH SECTION, GALV HD STEEL BEAMS W/ 8FT POSTS
 STA. 102+24 - 102+51, LT
 STA. 102+35 - 102+58, RT
 STA. 103+14 - 103+39, LT
 STA. 103+21 - 103+33, RT

SPECIAL PROVISION (RETAINING WALL)
 STA. 102+24 - 102+41, LT

STEEL BEAM GUARDRAIL, GALVANIZED W/8 FEET POSTS
 STA. 101+97 - 102+24, LT
 STA. 103+39 - 103+52, LT
 103+33 - 103+46, RT

ANCHOR FOR STEEL BEAM RAIL
 STA. 101+92.68 LT
 STA. 102+30.28 RT
 STA. 103+38.63 RT
 STA. 103+57, LT

STEEL BEAM GUARDRAIL, GALVANIZED
 STA. 101+84.75 - 101+97.87 LT
 STA. 102+25.20 - 102+35, RT
 STA. 103+52 - 103+64, LT
 STA. 103+33.45 - 103+45.70 RT

EXISTING STONE RETAINING WALL TO BE REMOVED. SEE NOTE 1

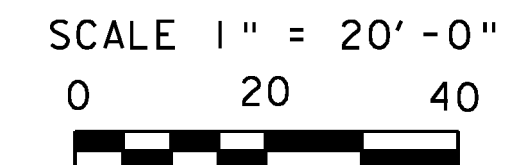

NOTE:
 1. THE REMOVAL OF THE EXISTING STONE RETAINING WALL SHALL BE PAID FOR UNDER ITEM 203.27, UNCLASSIFIED CHANNEL EXCAVATION.

PROJECT NAME:	GUILFORD
PROJECT NUMBER:	BRO 1442(36)
FILE NAME:	z10j064bdr_nul.dgn
PROJECT LEADER:	S.E. BURBANK
DESIGNED BY:	E.A. FIALA
LAYOUT SHEET	
PLOT DATE:	10/2/2013
DRAWN BY:	E.A. FIALA
CHECKED BY:	S.E. BURBANK
SHEET	II OF 42

