

DETOUR (T.H. 12)
CURVE NO. 1 DATA
 $\Delta = 19^{\circ}05'20.51''$
 $D = 43^{\circ}04'46.32''$
 $R = 133.00'$
 $T = 22.36'$
 $L = 44.31'$
 $E = 1.87'$
 BANK = NONE

DETOUR (T.H. 12)
CURVE NO. 2 DATA
 $\Delta = 60^{\circ}21'44.73''$
 $D = 127^{\circ}19'26.24''$
 $R = 45.00'$
 $T = 26.17'$
 $L = 47.41'$
 $E = 7.06'$
 BANK = NONE

DETOUR (T.H. 12)
CURVE NO. 3 DATA
 $\Delta = 38^{\circ}31'27.38''$
 $D = 57^{\circ}17'44.81''$
 $R = 100.00'$
 $T = 34.95'$
 $L = 67.24'$
 $E = 5.93'$
 BANK = NONE

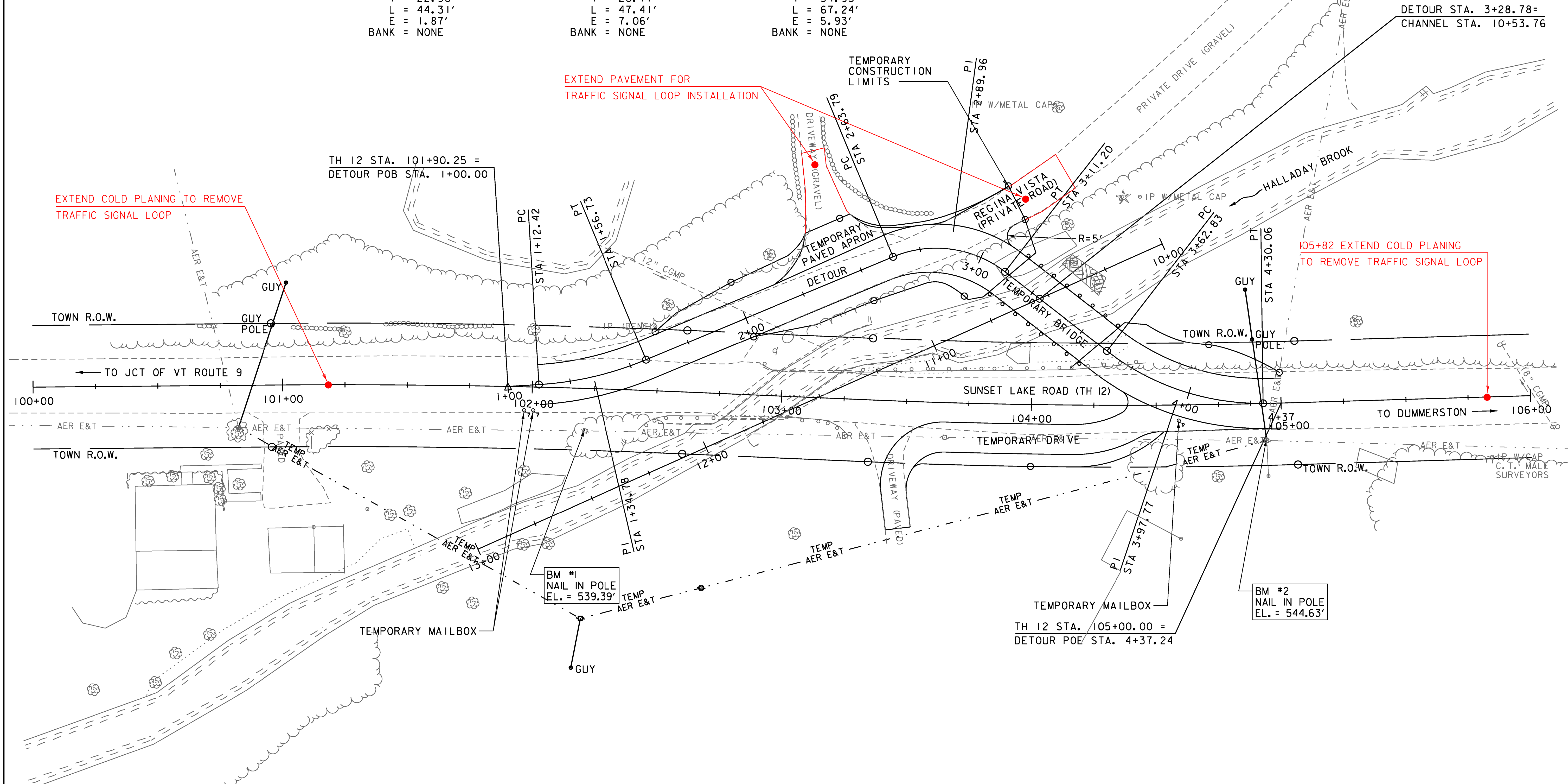

EDGE OF DETOUR PAVEMENT WIDTH TRANSITION

STA. 1+12.42	= 8'-0"	LT & RT
STA. 2+15.42	= 8'-0"	LT
STA. 2+59.66	= 8'-0"	RT
STA. 2+63.79	= 9'-5"	LT
STA. 3+11.20	= 10'-0"	LT
STA. 3+12.95	= 10'-0"	RT
STA. 4+37.22	= 10'-0"	LT & RT

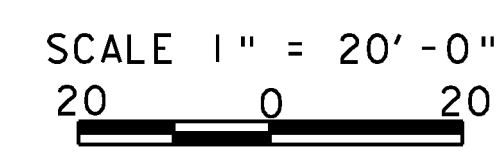

PROJECT NAME:	BRATTLEBORO	PLOT DATE:	10/14/2013
PROJECT NUMBER:	BRO 1442(35)	DRAWN BY:	E.A. FIALA
FILE NAME:	z10j062+cpl.dgn	CHECKED BY:	S.E. BURBANK
PROJECT LEADER:	S.E. BURBANK	TRAFFIC CONTROL PLAN (1 OF 3)	SHEET 16 OF 68

