

CONSTRUCT 11.5' PAVED APRON
STA. 102+69, LT - 41.5' WIDE

CONSTRUCT 12' PAVED DRIVE
STA. 103+59, RT - 12' WIDE

REMOVAL AND DISPOSAL OF GUARDRAIL
STA. 102+43 - 102+73, RT
STA. 102+92 - 102+96, LT
STA. 103+03 - 103+27, RT
STA. 103+31 - 104+46, LT

COLD PLANING, BITUMINOUS PAVEMENT
STA. 101+35 - 101+55, LT & RT
STA. 105+25 - 105+45, LT & RT

SPECIAL PROVISION (BRIDGE
RAILING, GALVANIZED HDSB/FASCIA
MOUNTED/STEEL TUBING)
STA. 102+43 - 103+25, RT
STA. 102+88 - 104+08, LT

GUARDRAIL APPROACH SECTION, GALVANIZED
HD STEEL BEAM W/8 FEET POSTS

STA. 102+18 - 102+43, RT
STA. 102+92, 24.58' LT - 102+88, LT
STA. 104+08 - 104+33, LT
STA. 103+25 - 103+36, RT
RELOCATE MAILBOX, MULTIPLE SUPPORT
STA. 102+39, RT

RELOCATE MAILBOX, SINGLE SUPPORT
STA. 103+83, RT

STEEL BEAM GUARDRAIL,
GALVANIZED W/8 FEET POSTS

STA. 102+12 - 102+18, RT - 103+24
STA. 102+92, 24.58' LT - 103+20, 38.4' LT
STA. 104+33 - 104+63, LT
ANCHOR FOR STEEL BEAM RAIL
STA. 102+06, RT 102+18, RT
STA. 103+25, 40.75' LT
STA. 103+30, RT
STA. 104+69, LT

STEEL BEAM GUARDRAIL, GALV.
~~STA. 102+00 - 102+12, RT~~
~~STA. 103+20, 38.4' LT - 103+34, 44.5' LT~~
~~STA. 103+25 - 103+36, RT~~
~~STA. 104+63 - 104+76, LT~~
STA. 102+07 - 102+18, RT
STA. 103+36 - (2' ON END OF GRASS), RT
STA. 103+24 - 103+34, LT
STA. 104+70 - 104+80, LT

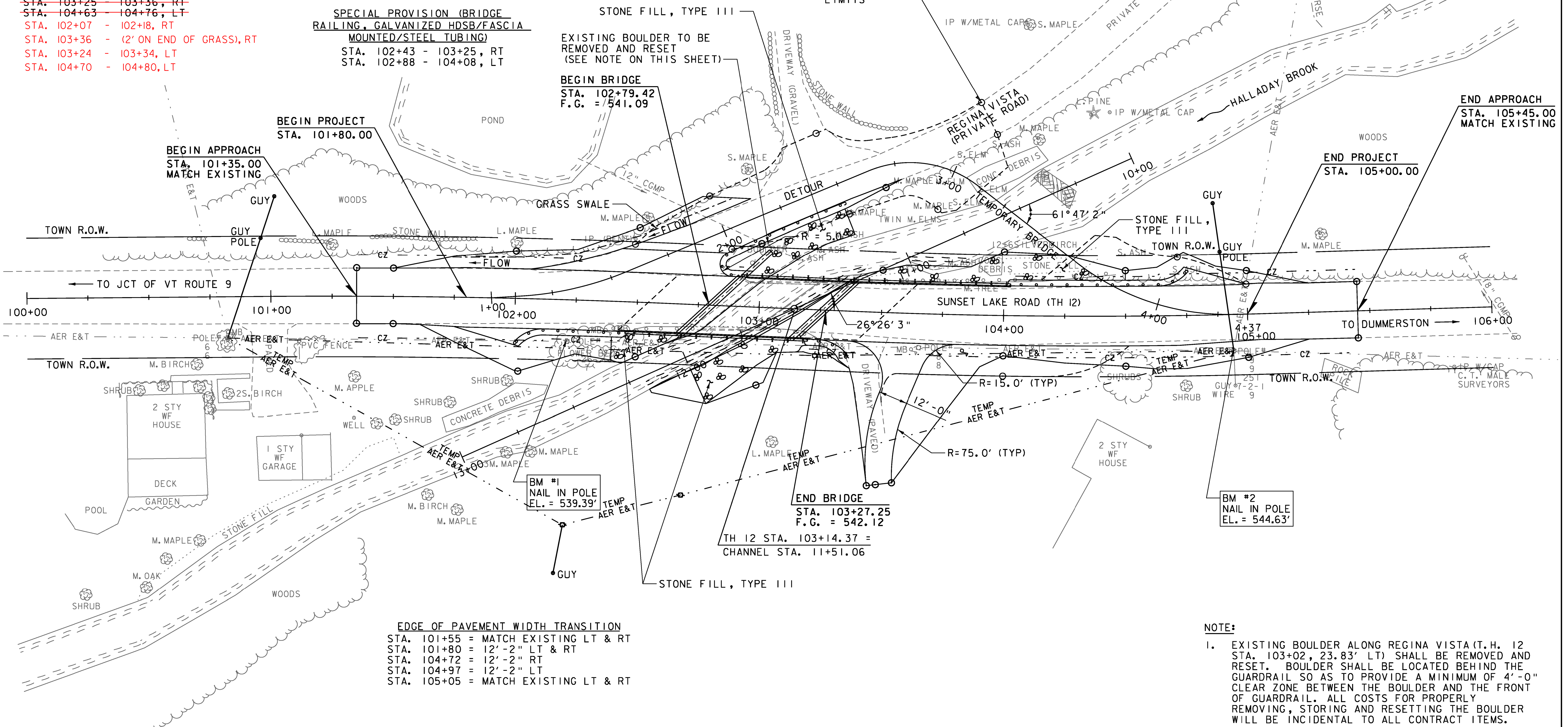

EDGE OF PAVEMENT WIDTH TRANSITION
STA. 101+55 = MATCH EXISTING LT & RT
STA. 101+80 = 12'-2" LT & RT
STA. 104+72 = 12'-2" RT
STA. 104+97 = 12'-2" LT
STA. 105+05 = MATCH EXISTING LT & RT

NOTE:
1. EXISTING BOULDER ALONG REGINA VISTA (T.H. 12 STA. 103+02, 23.83' LT) SHALL BE REMOVED AND RESET. BOULDER SHALL BE LOCATED BEHIND THE GUARDRAIL SO AS TO PROVIDE A MINIMUM OF 4'-0" CLEAR ZONE BETWEEN THE BOULDER AND THE FRONT OF GUARDRAIL. ALL COSTS FOR PROPERLY REMOVING, STORING AND RESETTING THE BOULDER WILL BE INCIDENTAL TO ALL CONTRACT ITEMS.

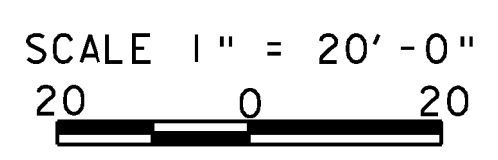

PROJECT NAME:	BATTLEBORO
PROJECT NUMBER:	BRO 1442(35)
FILE NAME:	z10j062bdr_nul.dgn
PROJECT LEADER:	S.E. BURBANK
DESIGNED BY:	S.E. BURBANK
LAYOUT SHEET	
PLOT DATE:	10/14/2013
DRAWN BY:	E.A. FIALA
CHECKED BY:	S.E. BURBANK
SHEET	14 OF 68

