

STATE OF VERMONT AGENCY OF TRANSPORTATION

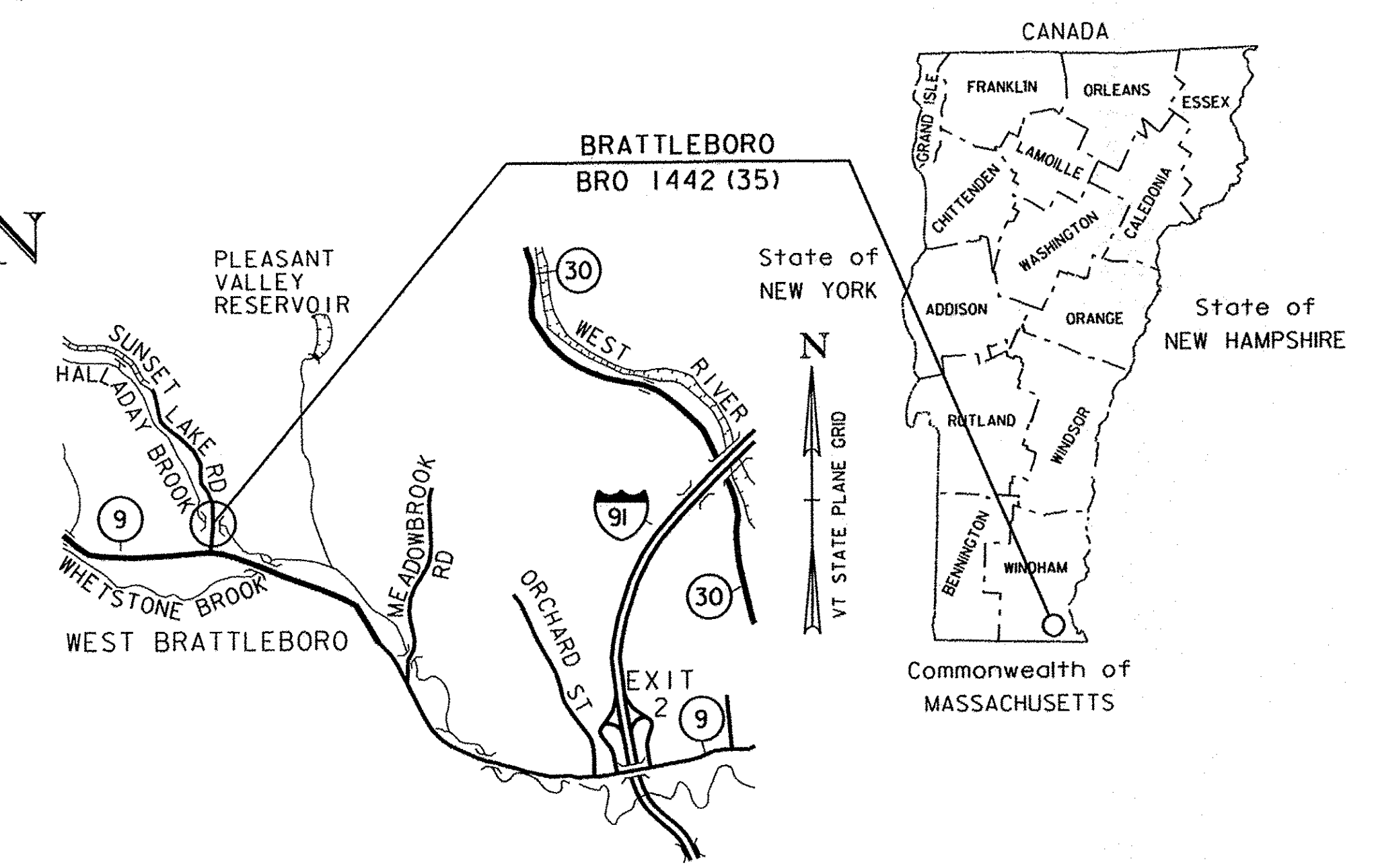

PROPOSED IMPROVEMENT BRIDGE PROJECT TOWN OF BRATTLEBORO COUNTY OF WINDHAM

TH 12, CLASS III (LOCAL ROAD), BRIDGE NO. 7



RECORD PLANS	
CONTRACTOR:	RENAUD BROTHERS, INC. - VERNON, VT
RESIDENT ENGINEER:	FRED ROSS III
CONSTRUCTION BEGAN:	APRIL 14, 2010
CONSTRUCTION COMPLETE:	MAY 21, 2013
RECORD PLANS BY:	FRED ROSS III & KEVIN KING
I HEREBY CERTIFY THAT ALL THE CONSTRUCTION REQUIRED BY THIS SET OF DRAWINGS HAS BEEN ACCOMPLISHED AS INDICATED HEREIN.	
BY	<i>Kevin Gammell, RCE</i> for RESIDENT ENGINEER
DATE	04-08-16
NOTE: Any further information concerning final quantities, amounts or other details relative to this project may be found at Central Files in the electronic archives.	

PROJECT LOCATION: LOCATED IN THE COUNTY OF WINDHAM, TOWN OF BRATTLEBORO, ON SUNSET LAKE ROAD (TH 12); BRIDGE NO. 7 OVER HALLADAY BROOK, APPROXIMATELY 0.20 MILES NORTH OF THE INTERSECTION OF VT 9 AND SUNSET LAKE RD (TH 12).

PROJECT DESCRIPTION: WORK TO BE PERFORMED UNDER THIS PROJECT INCLUDES REMOVAL AND REPLACEMENT OF BRIDGE NO. 7, ON THE EXISTING ALIGNMENT, WITH ASSOCIATED ROADWAY AND CHANNEL WORK.

LENGTH OF ROADWAY: 272.17 FEET
LENGTH OF BRIDGE: 47.83 FEET
LENGTH OF PROJECT: 320.00 FEET

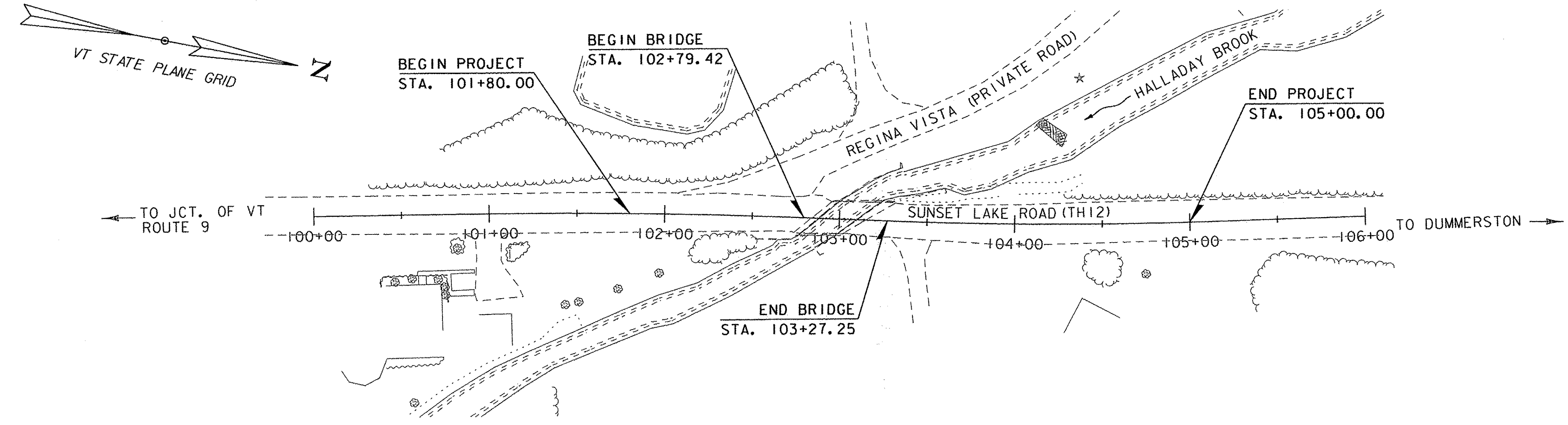

THESE PLANS ARE SUBJECT TO SUCH ENGINEERING CHANGES AS MAY BE REQUIRED BY THE FEDERAL HIGHWAY ADMINISTRATION OR THE DIRECTOR OF PROGRAM DEVELOPMENT.

CONSTRUCTION IS TO BE CARRIED ON IN ACCORDANCE WITH THESE PLANS AND THE STANDARD SPECIFICATIONS FOR CONSTRUCTION DATED 2011, AS APPROVED BY THE FEDERAL HIGHWAY ADMINISTRATION ON JULY 20, 2011 FOR USE ON THIS PROJECT, INCLUDING ALL SUBSEQUENT REVISIONS AND SUCH REVISED SPECIFICATIONS AND SPECIAL PROVISIONS AS ARE INCORPORATED IN THESE PLANS.

QUALITY ASSURANCE PROGRAM : LEVEL 2	
SURVEYED BY :	VHB
SURVEYED DATE :	NOV 2010
DATUM	
VERTICAL	NAVD 88
HORIZONTAL	NAD 83 (07)

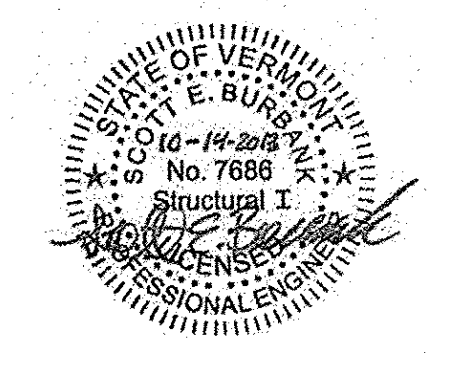
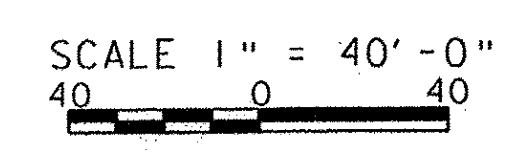

	DIRECTOR OF PROGRAM DEVELOPMENT
	APPROVED <i>Kevin A. Gammell</i> DATE 10/15/13
	PROJECT MANAGER : TODD A. SUMNER, P.E.
	PROJECT NAME : BRATTLEBORO PROJECT NUMBER : BRO 1442 (35)
SHEET 1 OF 68 SHEETS	