

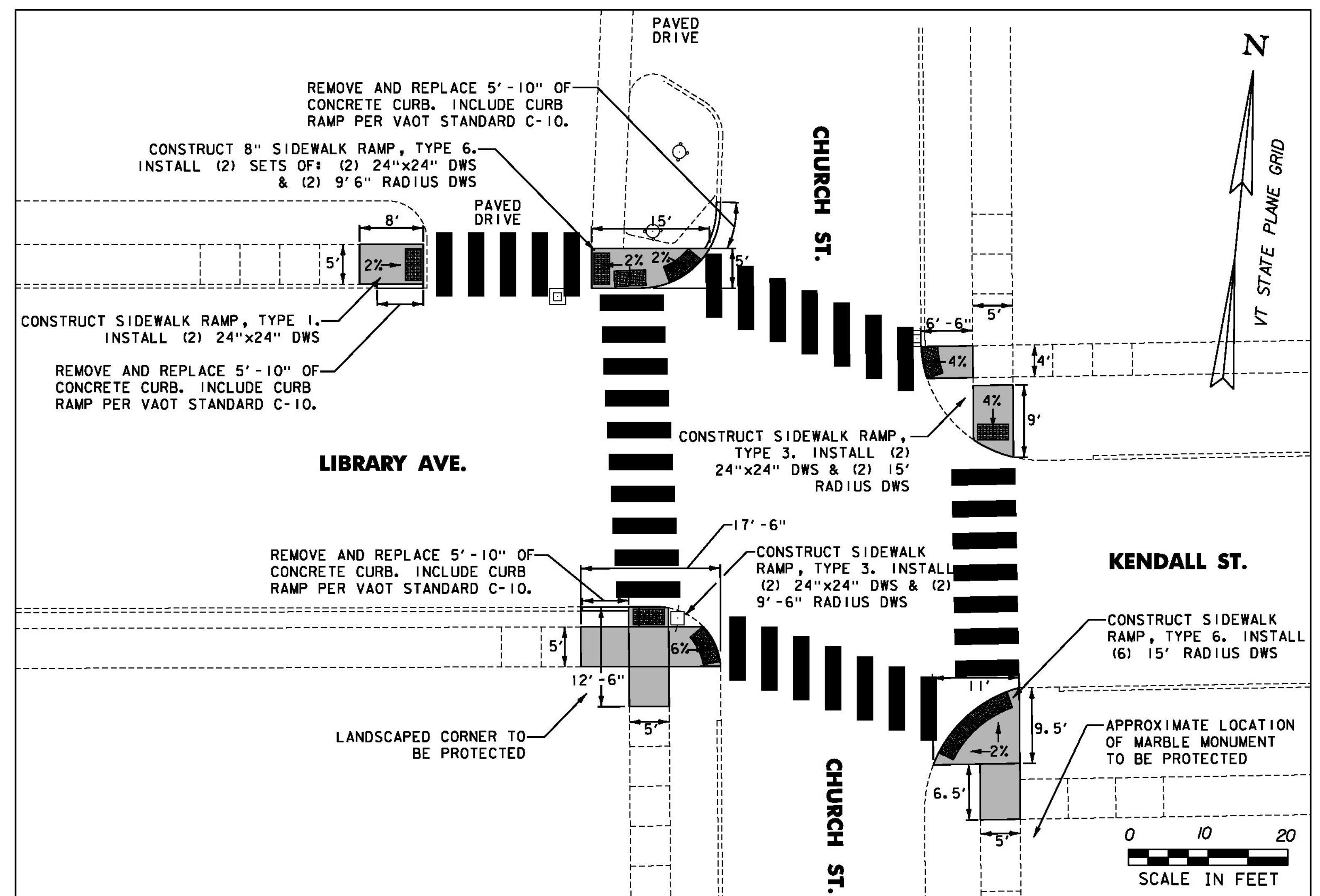

**LIBRARY AVE./ CHESTNUT AVE. CROSSWALKS**  
SCALE: 1"=20'



**LIBRARY AVE./ CHURCH STREET CROSSWALKS**  
SCALE: 1"=20'

**LEGEND**

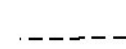
-  REMOVE EXISTING AND CONSTRUCT NEW SIDEWALK AND RAMP
-  DETECTABLE WARNING SURFACE
-  EXISTING CURB, SIDEWALK, OR EDGE OF PAVEMENT

**GENERAL NOTES:**

1. ALL NEW SIDEWALK SECTIONS SHALL BE INSTALLED TO MATCH THE EXISTING SIDEWALK ELEVATION AT THE POINT(S) OF INTERSECTION.
2. ALL NEW SIDEWALK RAMPS SHALL BE INSTALLED AT THE SLOPE INDICATED ON THE DRAWING. RAMP SECTIONS SHALL MATCH THE SIDEWALK ELEVATION AND ROADWAY ELEVATION.
3. SEE NOTES AND DETAILS NDS-1 AND NDS-2 FOR ADDITIONAL INFORMATION.
4. EXISTING TRUNCATED DOMES IN LOCATIONS OF SIDEWALK RAMPS TO BE SALVAGED AND RETURNED TO THE DEPARTMENT OF PUBLIC WORKS. SEE SHEET NDS-1 FOR CONTACT INFORMATION.
5. CURBING SHALL BE REPLACED IN-KIND.

**RUTLAND**

PROJECT NAME: STATEWIDE SRTS PROJECTS  
PROJECT NUMBER: STP SRIN(25)

FILE NAME: ...N2a Rutland Details.dgn PLOT DATE: 1/2/2013  
PROJECT LEADER: G. GOYETTE DRAWN BY: G. BURGMEIER  
DESIGNED BY: K. RICHARDSON CHECKED BY: G. GOYETTE  
RUTLAND D-4 SHEET 16 OF 35

