

TOWN OF ARLINGTON

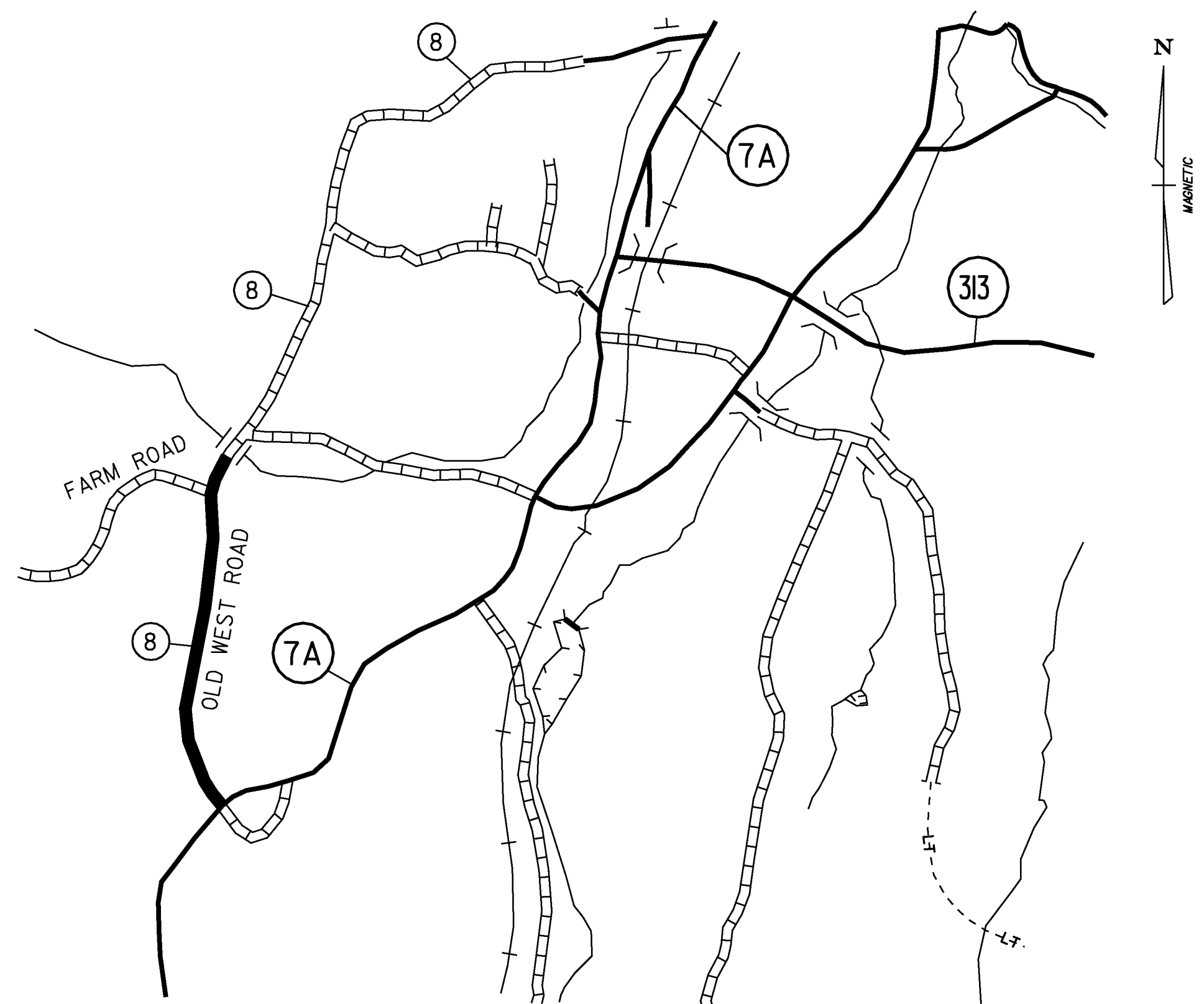

BEGINNING AT THE INTERSECTION OF VT ROUTE 7A AND OLD WEST ROAD (TH-8) IN THE TOWN OF ARLINGTON DESIGNATING WHERE THE CENTERLINE OF EACH ROAD INTERSECTS WITH EACH OTHER AS MILE MARKER 0.000 AND EXTENDING NORTHERLY ALONG OLD WEST ROAD FOR A DISTANCE OF 0.953 MILES TO A POINT 0.055 MILES NORTH OF FARM ROAD TO CONCLUDE THIS SEGMENT FOR THIS PROJECT.

TOWN OF BRIDPORT

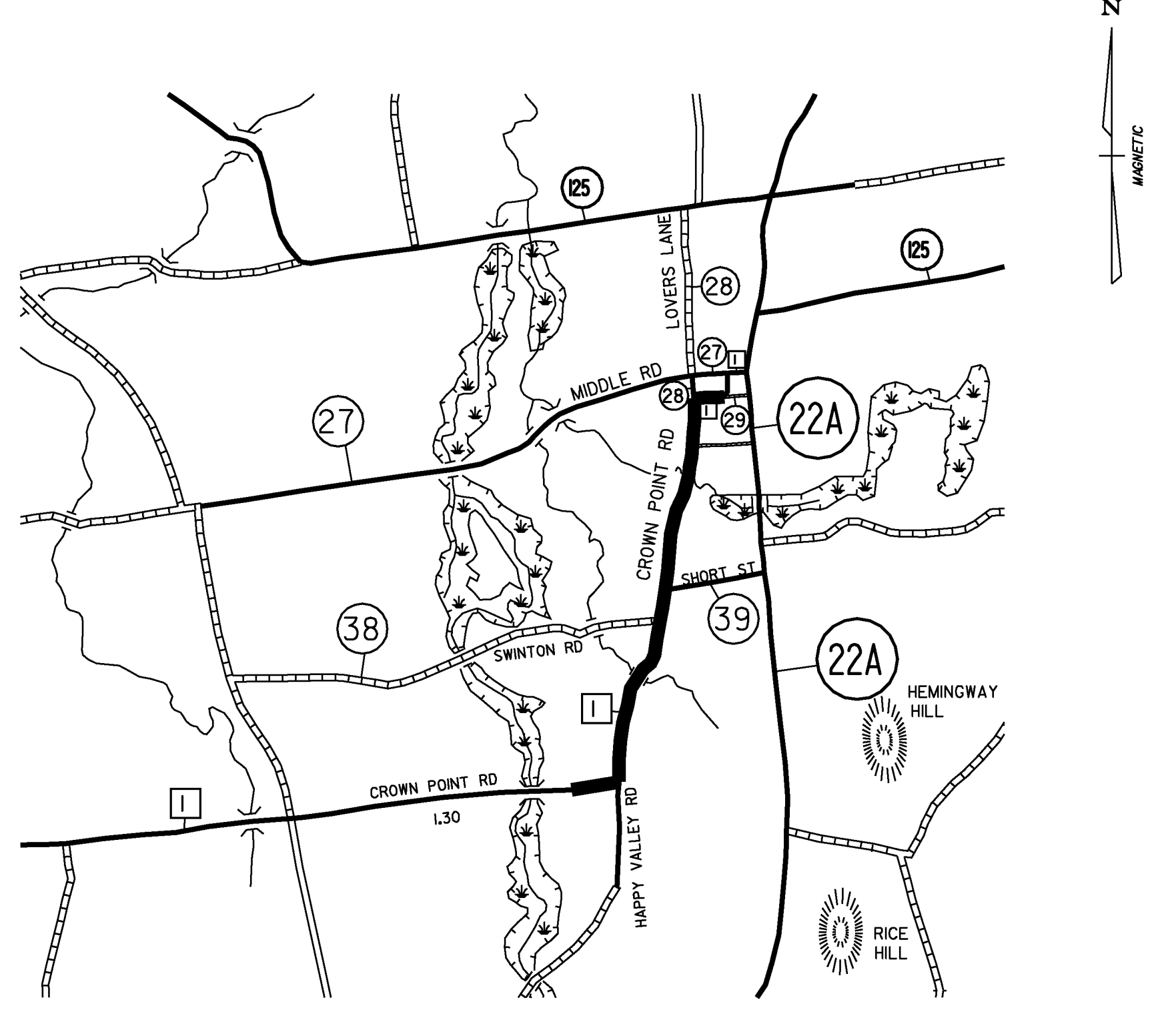

BEGINNING AT THE INTERSECTION OF VT ROUTE 22A (MM 3,075) AND CROWN POINT ROAD (TH-1) IN THE TOWN OF BRIDPORT DESIGNATING WHERE THE CENTERLINE OF EACH ROAD INTERSECTS WITH EACH OTHER AS MILE MARKER 0.000 AND EXTENDING SOUTHWESTERLY ALONG CROWN POINT ROAD TO A POINT 0.195 MILES FROM THE BEGIN POINT (BEGINNING OF WORK) AND THEN TRAVELING FOR A DISTANCE OF 1.630 MILES TO A POINT 0.070 MILES SOUTH OF THE MOST SOUTHERLY LEG OF HAPPY VALLEY ROAD (MM 1.825) TO CONCLUDE THIS SEGMENT FOR THIS PROJECT.

TOWN OF CASTLETON

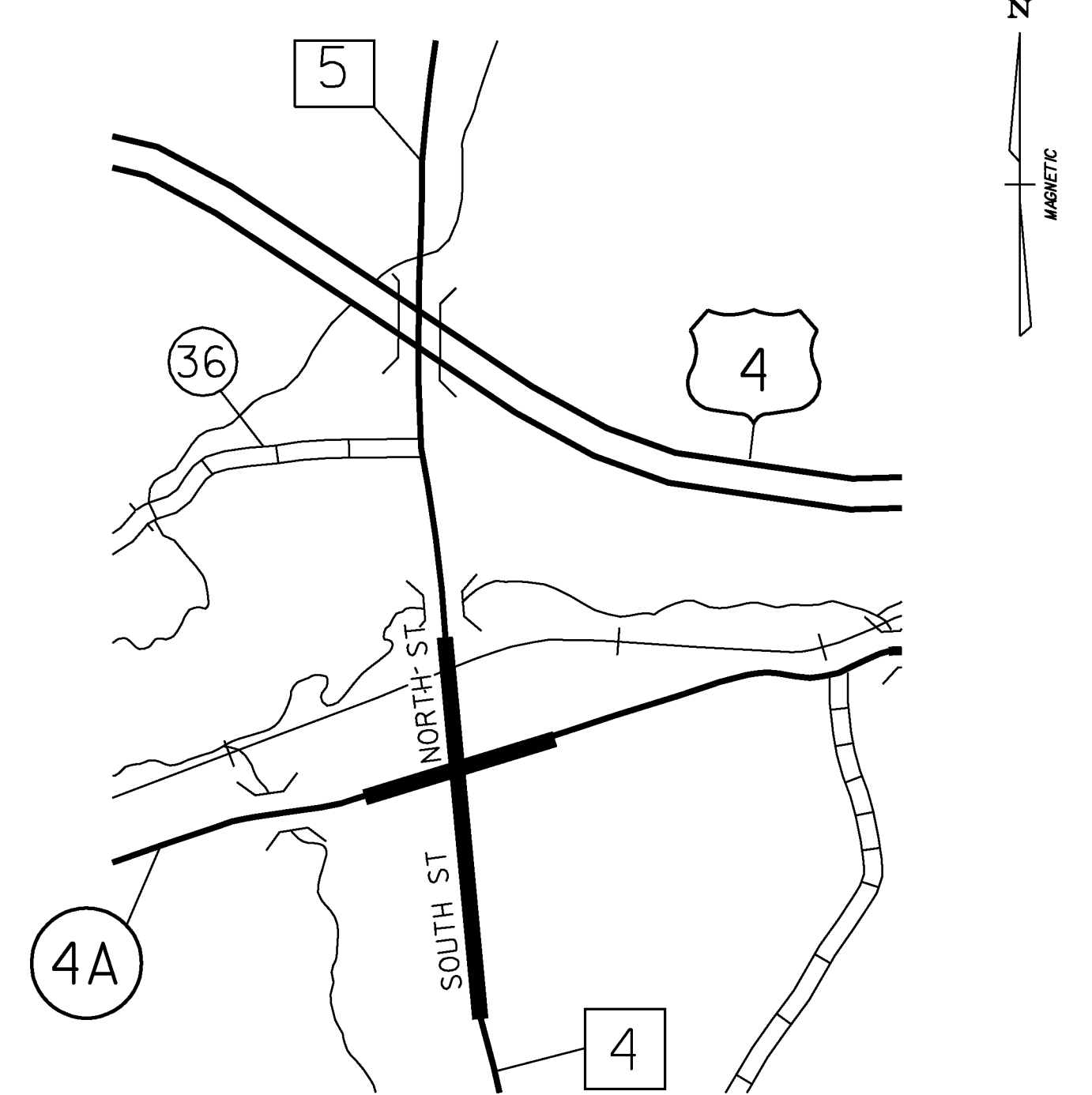

BEGINNING AT A POINT 0.005 MILES WEST OF GLENBROOK ROAD (MM 3,140) ALONG VT ROUTE 4A (CLASS D) IN THE TOWN OF CASTLETON EXTENDING 0.217 MILES EAST TO A POINT 0.014 MILES EAST OF THE INTERSECTION OF SEMINARY STREET (MM 3,338) TO MM 3,352. ON A SEPARATE ROADWAY BEGINNING AT THE INTERSECTION OF VT 4A (MM 3,140) AND NORTH ROAD (TH-5) IN THE TOWN OF CASTLETON DESIGNATING WHERE THE CENTERLINE OF EACH ROAD INTERSECTS WITH EACH OTHER AS MILE MARKER 0.000 AND EXTENDING NORTHERLY ALONG NORTH STREET TO A POINT 0.193 MILES FROM THE BEGINNING POINT, TRAVELING TOWARD BROWN FARM ROAD. ALSO ON ANOTHER ROADWAY, BEGINNING AT THE INTERSECTION OF VT 4A (MM 3,140) AND SOUTH STREET (TH-4) IN THE TOWN OF CASTLETON DESIGNATING INTERSECTION WHERE THE CENTERLINE OF EACH ROAD INTERSECTS WITH EACH OTHER AS MILE MARKER 0.000 AND EXTENDING SOUTHERLY ALONG SOUTH STREET TO A POINT 0.077 MILES FROM THE BEGINNING POINT, TRAVELING TOWARD THE COLLEGE. THESE SEGMENTS CONCLUDE THIS PORTION OF THIS PROJECT.

TOWN OF KILLINGTON

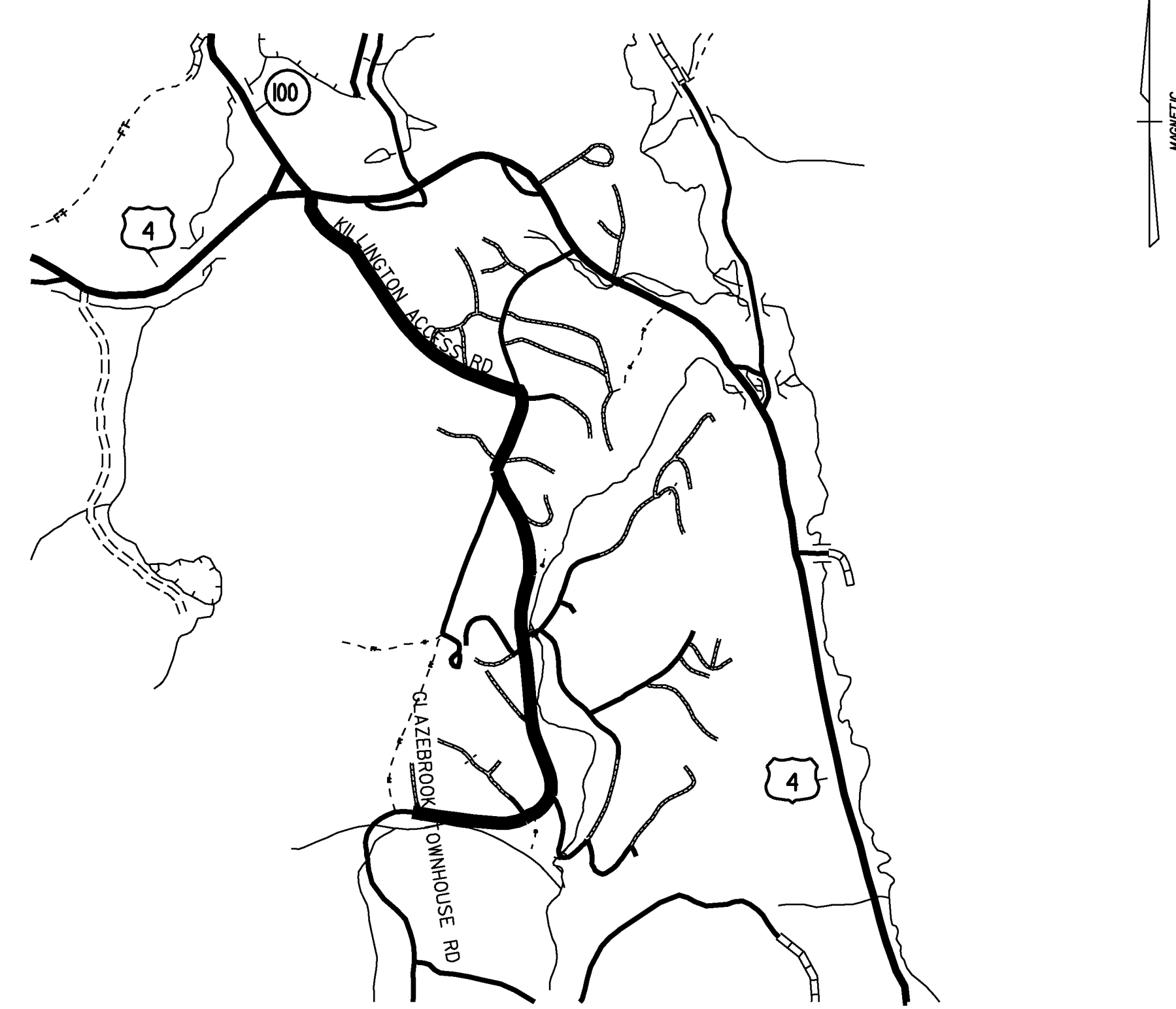

BEGINNING AT THE INTERSECTION OF KILLINGTON ACCESS ROAD (TH-2) AND US ROUTE 4 IN THE TOWN OF KILLINGTON, DESIGNATING WHERE THE CENTERLINE OF EACH ROAD INTERSECTS WITH EACH OTHER AS MILE MARKER 0.000 AND EXTENDING SOUTHERLY ALONG KILLINGTON ACCESS ROAD FOR A DISTANCE OF 3.077 MILES TO A POINT 0.099 MILES SOUTH OF GLAZEBROOK TOWNHOUSE ROAD TO CONCLUDE THIS SEGMENT FOR THIS PROJECT.

TOWN OF MANCHESTER

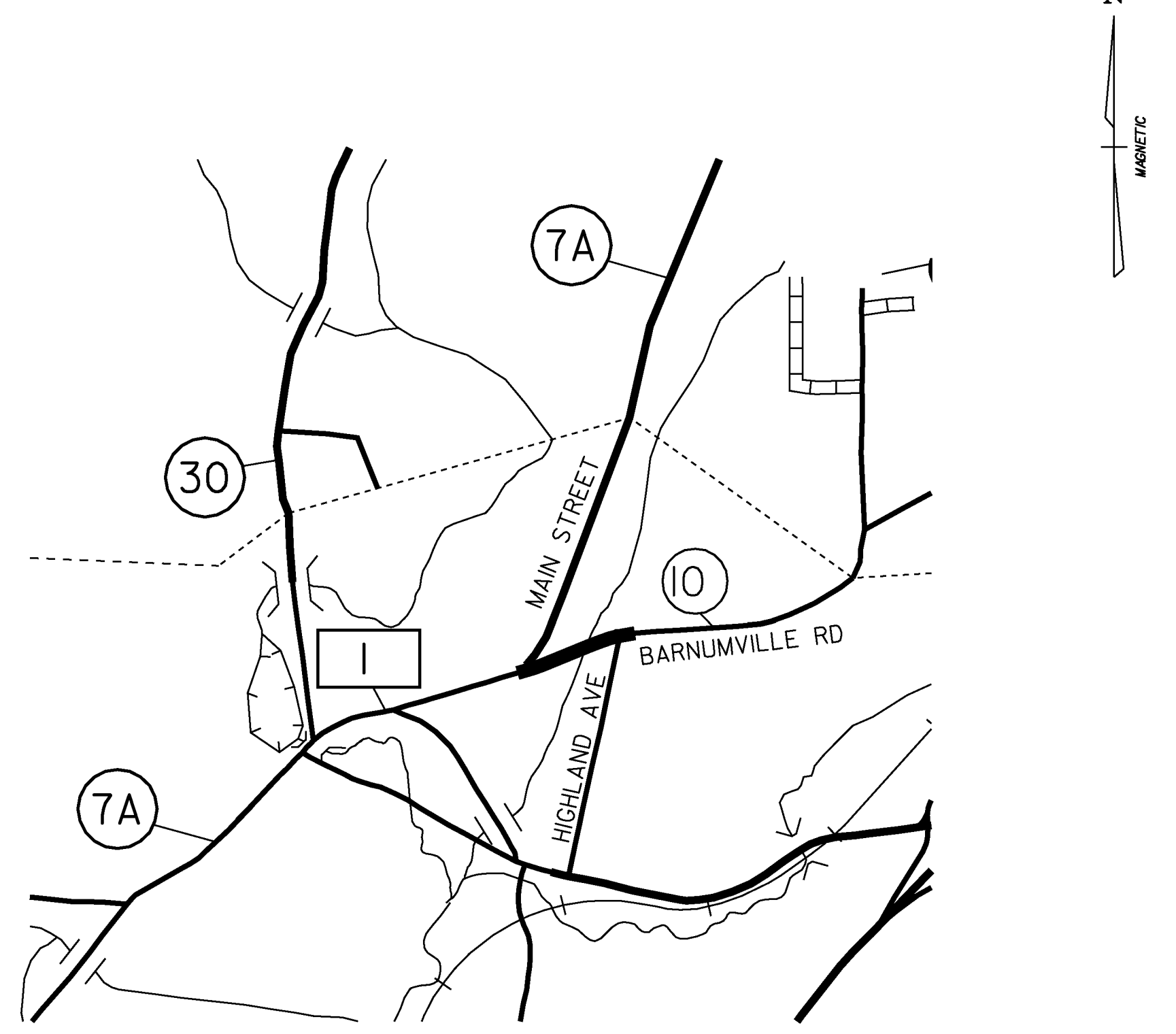

BEGINNING AT THE INTERSECTION OF VT ROUTE 7A AND BARNUMVILLE ROAD (TH-10) IN THE TOWN OF MANCHESTER DESIGNATING WHERE THE CENTERLINE OF EACH ROAD INTERSECTS WITH EACH OTHER AS MILE MARKER 0.000 AND EXTENDING NORTHEASTERLY ALONG BARNUMVILLE ROAD FOR A DISTANCE OF 0.234 MILES TO A POINT 0.038 MILES NORTH OF HIGHLAND AVENUE TO CONCLUDE THIS SEGMENT FOR THIS PROJECT.

NOT TO SCALE

PROJECT NAME:	STATEWIDE SOUTHWEST REGION	
PROJECT NUMBER:	STP HRRR(7)	
FILE NAME:	IOK022.DGN	PLOT DATE:
PROJECT LEADER:	N. AVERY	DRAWN BY:
DESIGNED BY:	N. AVERY	CHECKED BY:
LOCATION MAPS:	1	SHEET
		3 OF 78