

**BILL OF MATERIAL**

MARKS	SHIP TEMP	QTY	MATERIAL	FT	IN	GR	REMARK'S
37B1		ONE	W12x35	25	6 1/8		
		3	R 1/2 x 3	0	11 1/8		SHAPED
37B2		ONE	W12x35	25	6 1/8		
		3	R 1/2 x 3	0	11 1/8		SHAPED
37B3		ONE	W12x35	25	6 1/8		
		3	R 1/2 x 3	0	11 1/8		SHAPED
37B4		ONE	W12x35	25	6 1/8		
		3	R 1/2 x 3	0	11 1/8		SHAPED

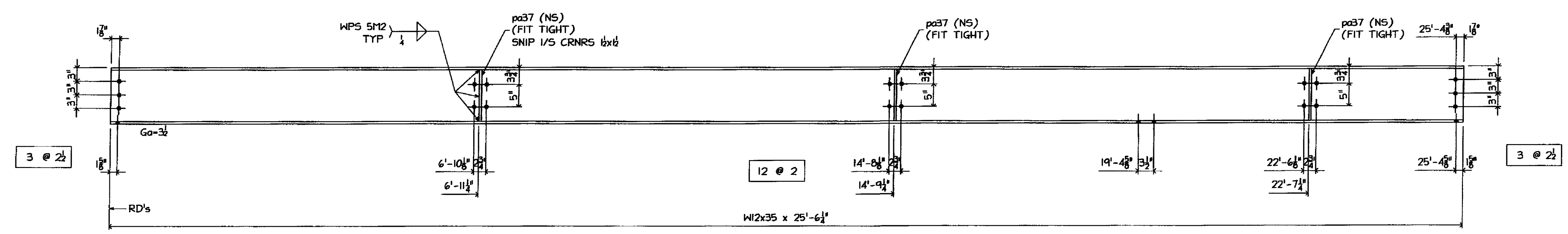

ONE - BEAM - 37B1 (AS SHOWN)  
ONE - BEAM - 37B2 (OPP HAND)

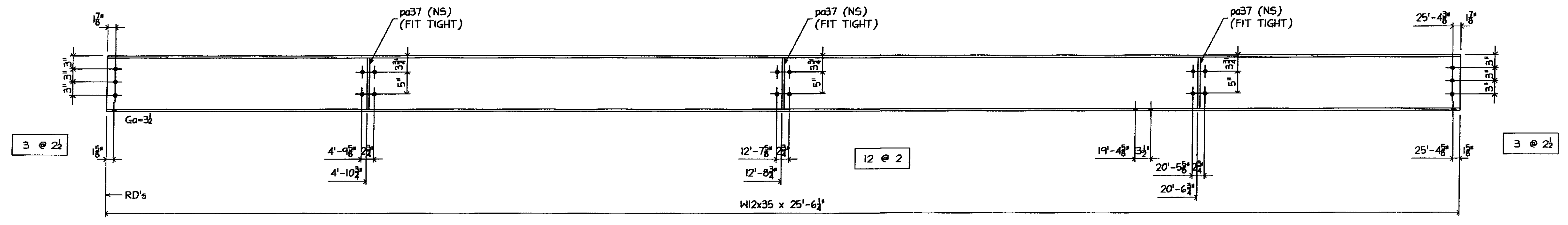

ONE - BEAM - 37B3 (AS SHOWN)  
ONE - BEAM - 37B4 (OPP HAND)

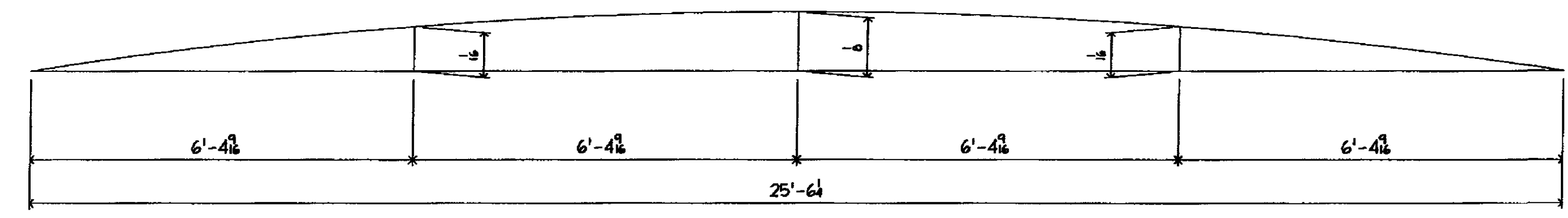

CAMBER DIAGRAM

SHOP DRAWINGS ARE REVIEWED UNLESS NOTED OTHERWISE

NO EXCEPTION TAKEN	
REVISE AS NOTED	
RESUBMISSION NOT REQUIRED	
REVISE AS NOTED	
RESUBMISSION REQUIRED	
REJECTED	

DATE: 3/24/19

SIGNATURE: [Signature]

REVIEW BY STANTEC IS FOR THE SOLE PURPOSE OF ASCERTAINING GENERAL CONFORMITY WITH DESIGN. CONTRACTOR IS RESPONSIBLE FOR DIMENSIONS, FABRICATION AND CONSTRUCTION METHODS, COORDINATION OF SUB-TRADES, DETAIL DESIGN OF COMPONENTS, AND ERRORS OR OMISSIONS ON SHOP DRAWINGS.

**GALVANIZING NOTES:**  
1 ALL WELDS SHALL BE SEALED  
2 VENT AS REQUIRED  
3 COMPLETE FINAL ASSEMBLY OF BOLTED ITEMS AFTER GALVANIZING. WIRE-BRUSH ALL CONTACTING SURFACES TO A DULL-GRAY APPEARANCE PRIOR TO ASSEMBLY

FB THIS DWG  
48- 6φ x 2 (A325 GALV) BOLT w/N4W  
24- 6φ x 2 (A325 GALV) BOLT w/N4W

**MATL:**  
1 ALL MAT'L SHALL CONFORM TO AASHTO M 270/M 270 GRADE 50 (UNLESS NOTED)  
2 'CVN' INDICATES CHARTY 'V' NOTCH TESTED  
3 'FCM' INDICATES 'FRACTURE CRITICAL MEMBER'

**WELD:** E70xx  
**HOLES:** 1/2" UNO  
**PREP:** SSPC-SP8  
**PAINT:** GALVANIZED AND AIR COOLED (NOT QUENCHED) (SEE GALVANIZING NOTES)

3/11/09 PER APPL COMMENTS DATED 3/06/09

**ARC ENTERPRISES, INC.**  
KINGFIELD, MAINE

PROJECT: STATE OF VERMONT - AGENCY OF TRANSPORTATION  
BRIDGE No 31 - RICHMOND, VERMONT

SCALE: NTS APPROVED BY: [Signature] DRAWN BY: KAU  
DATE: 2/18/09 CHKD. BY: CMS-082

BRIDGE # HIGHWAY #1 OVER WINOOSKI RIVER  
SIDEWALK STRINGER DETAILS

T BUCK CONSTRUCTION DWG NO 09-113 - 37